

Manuals+

[Q & A](#) | [Deep Search](#) | [Upload](#)

[manuals.plus](#) /

- › [SOUNDKITS](#) /
- › [SOUNDKITS Double Din Car Stereo User Manual](#)

SOUNDKITS SKT-70B

SOUNDKITS Double Din Car Stereo User Manual

Model: SKT-70B

Brand: SOUNDKITS

1. INTRODUCTION

This manual provides detailed instructions for the installation, operation, and maintenance of your SOUNDKITS Double Din Car Stereo. Please read this manual thoroughly before using the product to ensure proper functionality and safety. This multimedia receiver offers a 7-inch HD capacitive touchscreen, Bluetooth connectivity, phone mirroring, AM/FM radio, and support for various media inputs.



2. WHAT'S IN THE BOX

Verify that all items listed below are included in your package:

- 7 inch Double Din Car Stereo Bluetooth Unit
- Rearview Camera & Backup Camera Cable
- IR Remote & Steering Wheel Control Remote
- Harness & Mounting Kits
- User Manual (this document)



Image 2.1: Illustration of all components included in the product package, such as the stereo unit, rearview camera, remotes, wiring harness, and mounting brackets.

3. PRODUCT FEATURES

- **Seamless Bluetooth Connectivity:** Automatic streaming and hands-free calling with a built-in microphone.
- **Phone Mirroring Option:** Cast your Android (version 11 or below) or iOS (iPhone XR, 8 Plus or below) smartphone screen via USB for navigation, messages, video, and music.
- **High Resolution LCD Display:** 1024*600 HD capacitive touchscreen with brightness adjustment,

supporting 1920 x 1080P video playback.

- **HD Rearview Camera Input:** Includes a backup camera with 19.6ft wire for safe reversing.
- **Multiple Audio Inputs:** USB, SD card, and AUX-in for lossless music playback. Supports MP3 and WMA file formats.
- **AM/FM Radio:** Access 30 preset stations for news, music, and sports.
- **Customizable EQ:** Adjust bass and treble for optimal sound quality.
- **Steering Wheel Control (SWC):** Compatible with existing steering wheel controls for convenient operation.
- **7-Color Backlight:** Customizable bezel color to match your car's interior.
- **Universal Double Din Size:** Compatible with most cars (verify dashboard size before ordering).

4. SETUP AND INSTALLATION

4.1 Physical Dimensions

The stereo unit has universal dimensions of 7" (L) x 3.89" (D) x 2.36" (H). Ensure your dashboard opening is compatible. Aftermarket accessories (dash kit) may be required for a proper fit in some vehicles.

4.2 Wiring Diagram

Refer to the wiring diagram for correct connections. Incorrect wiring can damage the unit or your vehicle's electrical system. The system operates on 12V DC. If your vehicle uses a different voltage, a step-down converter is necessary.

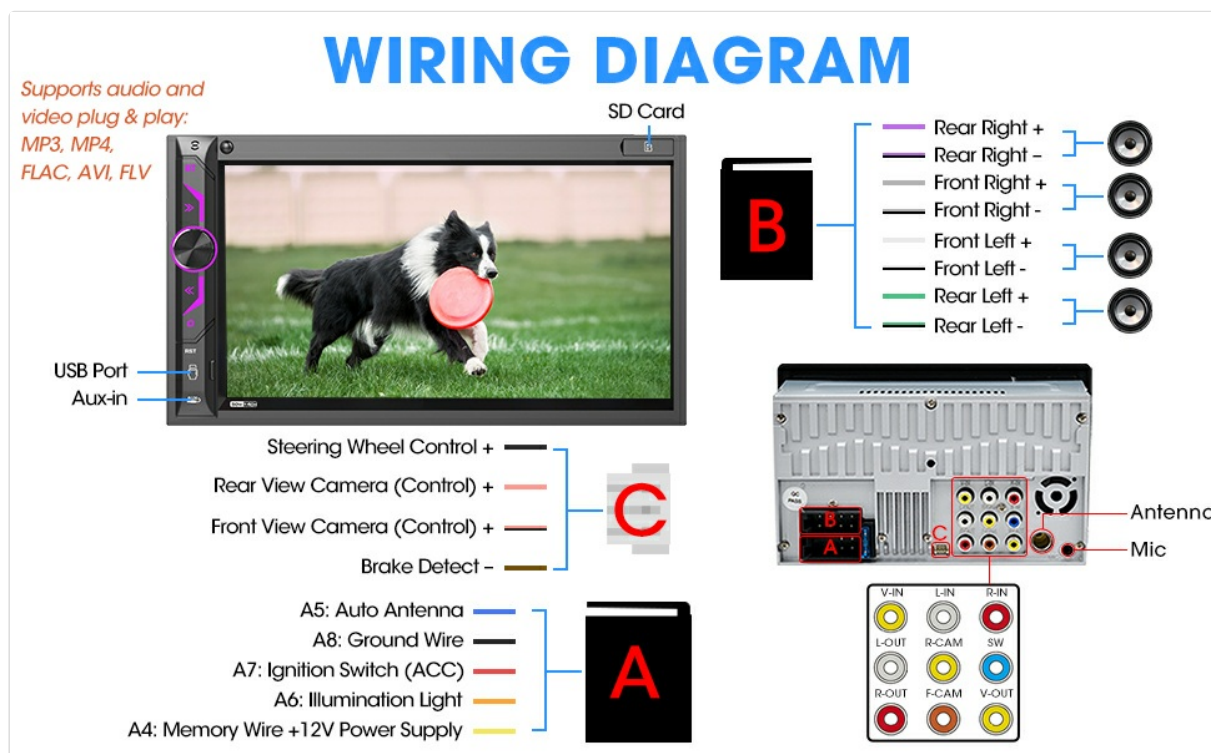

Image 4.1: Detailed wiring diagram showing connections for power, speakers, USB, AUX-in, steering wheel control, and camera inputs.

4.3 Backup Camera Installation

Connect the included rearview camera to the R-CAM port on the stereo. The camera's power wire (red) should connect to the reversing light's positive pole (+12VDC), and the black wire to the negative pole. This ensures the camera activates automatically when the vehicle shifts into reverse.

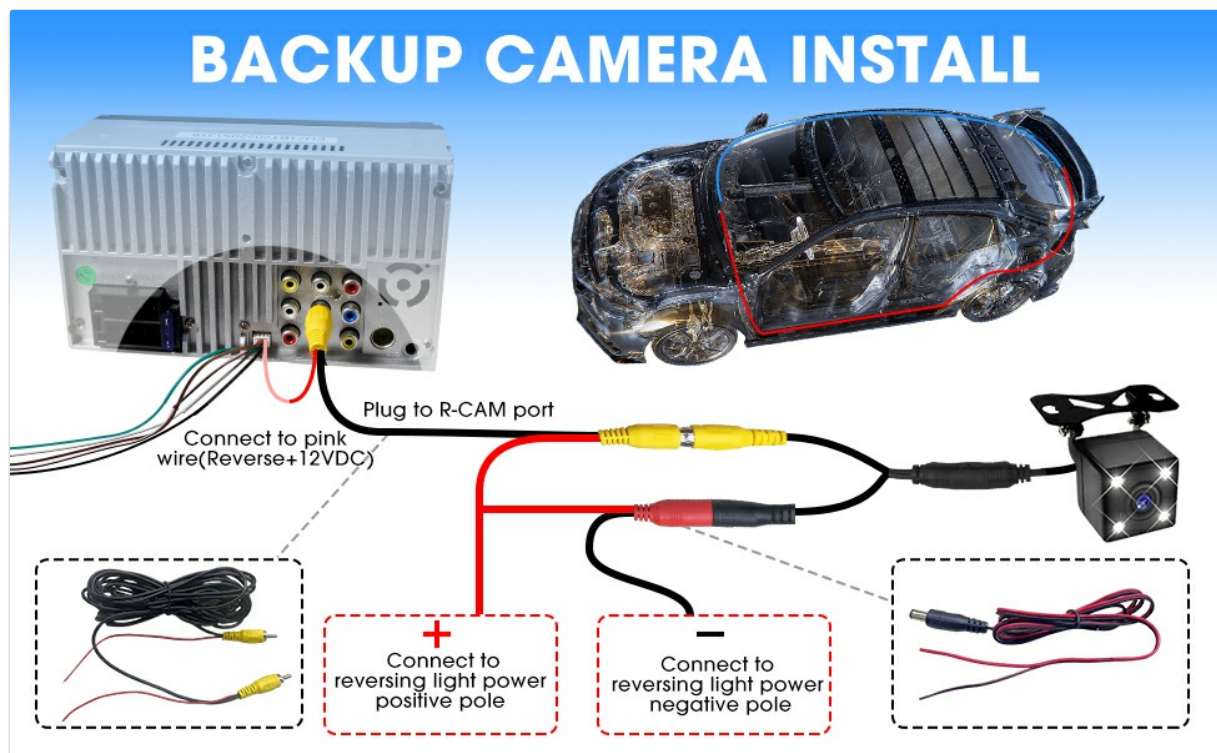

Image 4.2: Visual guide for connecting the backup camera to the car stereo and vehicle's reversing light system.

5. OPERATING INSTRUCTIONS

5.1 Bluetooth Connectivity

To pair your device, navigate to the Bluetooth menu on the stereo. Enable Bluetooth on your smartphone and select the stereo from the list of available devices. Once paired, the stereo will automatically connect to your phone upon startup for hands-free calls and audio streaming.



Image 5.1: Depiction of hands-free calling and audio playback via Bluetooth on the car stereo.

5.2 Phone Mirroring

Connect your smartphone to the stereo via a USB cable. Access the 'Phonelink' or 'Mirrorlink' function on the

stereo. Your phone's screen will be mirrored, allowing access to navigation, videos, and other applications directly on the stereo display. This feature supports iPhone XR, iPhone 8 Plus or below, and Android 11 or below.



Image 5.2: An example of the phone mirroring function displaying a navigation app on the car stereo screen.

5.3 Radio (AM/FM)

Select the 'Radio' icon from the main menu. Use the touchscreen to scan for stations or manually tune to a frequency. You can save up to 30 favorite stations for quick access.

5.4 Media Playback (USB/SD/AUX)

Insert a USB drive or SD card into the designated port, or connect an external audio device via the AUX-in jack. The stereo will automatically detect the media and allow you to browse and play audio/video files.

5.5 Steering Wheel Control (SWC)

If your vehicle supports steering wheel controls, you can configure them through the stereo's settings menu. This allows you to control volume, track changes, and other functions without taking your hands off the wheel.



Image 5.3: Demonstrates the steering wheel control interface and the AM/FM radio screen.

6. MAINTENANCE

- **Cleaning the Screen:** Use a soft, lint-free cloth to gently wipe the touchscreen. Avoid abrasive cleaners or solvents.
- **Software Updates:** Periodically check the manufacturer's website for any available software updates to ensure optimal performance and compatibility.
- **General Care:** Avoid exposing the unit to extreme temperatures, direct sunlight for prolonged periods, or excessive moisture.

7. TROUBLESHOOTING

- **No Power:** Check all power connections, including the main power harness and ignition wire. Ensure the vehicle's fuse for the stereo is intact.
- **No Sound:** Verify speaker connections are secure. Check the volume level and mute settings. Ensure the correct audio source is selected.
- **Bluetooth Pairing Issues:** Ensure Bluetooth is enabled on both the stereo and your phone. Delete previous pairings and try again. Ensure your phone's OS version is supported.
- **Phone Mirroring Not Working:** Confirm your phone's operating system version is compatible (Android 11 or below, iPhone XR/8 Plus or below). Use the original USB cable. Ensure the 'Phonelink' or 'Mirrorlink' app is selected on the stereo.
- **Backup Camera Not Displaying:** Check the camera's power connection to the reverse light and the RCA video cable connection to the stereo. Ensure the pink reverse trigger wire is correctly connected to the vehicle's reverse light signal.
- **Poor Radio Reception:** Check the antenna connection. Ensure the antenna is properly installed and not obstructed.

8. SPECIFICATIONS





Feature	Specification
Brand	SOUNDKITS
Model Number	SKT-70B
Product Dimensions	3.89 x 7 x 2.36 inches
Item Weight	2.53 pounds
Display Type	7-inch HD Capacitive Touchscreen
Display Resolution	1024*600
Video Playback	Supports 1920 x 1080P
Connectivity Technology	Auxiliary, Bluetooth, Mirror Link, USB
Controller Type	Android, iOS
Special Features	AM FM Radio, Bluetooth Calling Music Streaming, Equalizer, GPS Navigation, Steering Wheel Control
Voltage	12 Volts DC
Max Power Output	4x 50W (200 watts total)
Audio Output Mode	Stereo
Color Options	7 Color Option (backlight)

9. WARRANTY AND SUPPORT

SOUNDKITS is committed to providing excellent customer service and product support.

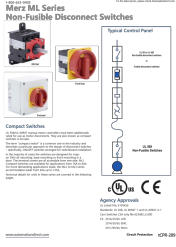
- **Fast Response:** Customer inquiries are typically addressed within 24 hours.
- **Replacement Policy:** Enjoy a 90-day free replacement or refund period.
- **Product Responsibility:** The product is covered by a 12-month responsibility period for manufacturing defects.
- **Technical Guidance:** Lifetime technical guidance and support are available.

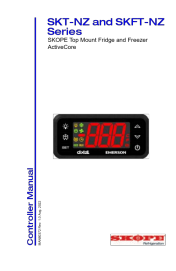
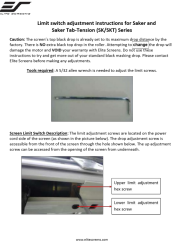
For support, please contact the seller, Soundkits US, directly through your Amazon order page by clicking 'Ask a question'.

	<p>Merz UL 508 Non-Fusible Disconnect Switches - Technical Specifications and Accessories</p> <p>Comprehensive guide to Merz UL 508 Non-Fusible Disconnect Switches, covering DIN rail mount, front door mount, and enclosed types, along with technical specifications, agency approvals, and available accessories.</p>
	<p>HYUNDAI-KIA SKT 100/200 CNC Turning Center Installation and Maintenance Manual</p> <p>Comprehensive installation and maintenance manual for the HYUNDAI-KIA SKT 100 and SKT 200 CNC Turning Centers, detailing specifications, safety procedures, and repair guidelines.</p>
	<p>SKOPE SKT-NZ and SKFT-NZ Series Controller Manual</p> <p>This manual provides detailed information on the Dixell XR77CH electronic controller used in SKOPE Top Mount Fridge and Freezer ActiveCore units, including an overview, faceplate description, procedures for operation, and alarm explanations.</p>
	<p>Elite Screens Saker and Saker Tab-Tension (SK/SKT) Series Limit Switch Adjustment Guide</p> <p>Step-by-step instructions for adjusting the limit switches on Elite Screens Saker and Saker Tab-Tension (SK/SKT) projector screens, covering how to adjust the drop distance and retraction.</p>
	<p>STIER Systainer-Kompressor SKT 160-8-6: Bedienungsanleitung und Sicherheitshinweise</p> <p>Umfassende Bedienungsanleitung für den STIER Systainer-Kompressor SKT 160-8-6 (904237). Enthält Sicherheitshinweise, technische Daten, Installations- und Wartungsanleitungen für Hobby- und professionelle Anwender.</p>
	<p>Braun Series 7 740s-7 Wet & Dry Electric Shaver User Manual</p> <p>User manual for the Braun Series 7 740s-7 Wet & Dry electric shaver. Learn about features, charging, usage, cleaning, maintenance, troubleshooting, and warranty.</p>