



[Manuals.plus](#) /

› [AISITIN](#) /

› AISITIN 3.5W Solar Fountain Pump Instruction Manual

## AISITIN 3.5W

# AISITIN 3.5W Solar Fountain Pump Instruction Manual

[Introduction](#)   [Safety Information](#)   [Package Contents](#)   [Setup](#)   [Operating](#)  
[Instructions](#)   [Maintenance](#)   [Troubleshooting](#)   [Specifications](#)   [Warranty & Support](#)

## 1. INTRODUCTION

---

Thank you for choosing the AISITIN 3.5W Solar Fountain Pump. This product is designed to create a beautiful water feature for your bird bath, garden pond, fish tank, or aquarium, utilizing solar energy for eco-friendly operation. This manual provides detailed instructions for assembly, operation, maintenance, and troubleshooting to ensure optimal performance and longevity of your solar fountain pump.



Image: The AISITIN 3.5W Solar Fountain Pump operating in a bird bath, showcasing its water spray.

## 2. SAFETY INFORMATION

- Ensure the pump is fully submerged in water before operation to prevent damage.
- Do not operate the pump without water.
- Keep the solar panel clean and free from obstructions to ensure maximum sunlight exposure and efficient operation.
- Regularly clean the pump to prevent blockages from debris and extend its lifespan.
- This product is designed for outdoor water features and should not be used for any other purpose.
- Keep out of reach of children and pets when not in use or during maintenance.

## 3. PACKAGE CONTENTS

Your AISITIN 3.5W Solar Fountain Pump package includes the following components:

- 1x 3.5W Solar Panel with integrated pump
- Multiple Nozzles (various spray patterns)
- 1x Filter sponge

- 3x Retractable fixed brackets
- 1x 9.8ft connecting cord (for separate design models)

## Split design for solar panel and water pump



Image: An exploded view of the solar fountain kit, showing the solar panel, pump, various nozzles, and connecting cord.

## 4. SETUP

1. **Choose a Location:** Select a location for your water feature that receives direct sunlight for the majority of the day. The solar panel requires direct sunlight to operate effectively.
2. **Assemble Nozzles:** Attach your desired nozzle combination to the pump outlet. Refer to the "Multiple Water Styles" section for options.
3. **Place Pump in Water:** Gently place the pump into your bird bath, pond, or container. Ensure the pump is completely submerged in water. The water level should be sufficient to cover the pump entirely.
4. **Position Solar Panel:** If using the separate design, place the solar panel in a location with maximum direct sunlight. The 9.8ft cord allows flexibility for placement.
5. **Use Retractable Brackets (Optional):** For bird baths or containers, extend the retractable fixed brackets to center the fountain. This prevents the fountain from drifting to the edge and splashing

water out of the basin.

## Suspension Fixing Bracket

Keep the fountain from getting close to the edge of the birdbath. Avoid water splashing out of the birdbath.

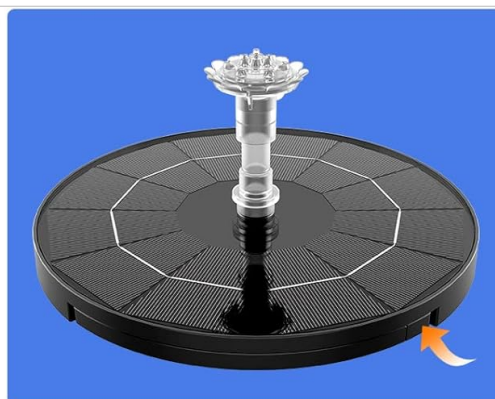

Image: Illustration of the suspension fixing bracket, demonstrating how it keeps the fountain centered in a bird bath.

## 5. OPERATING INSTRUCTIONS

The AISITIN 3.5W Solar Fountain Pump is designed for automatic operation. Once the solar panel receives sufficient direct sunlight, the pump will start spraying water immediately. The spray height is directly influenced by the intensity of the sunlight.

### 5.1 Multiple Water Styles

The fountain comes with various nozzles to create different water spray patterns. You can easily change nozzles to achieve your desired effect and prevent water from splashing out of your container.

# Various combinations of nozzles

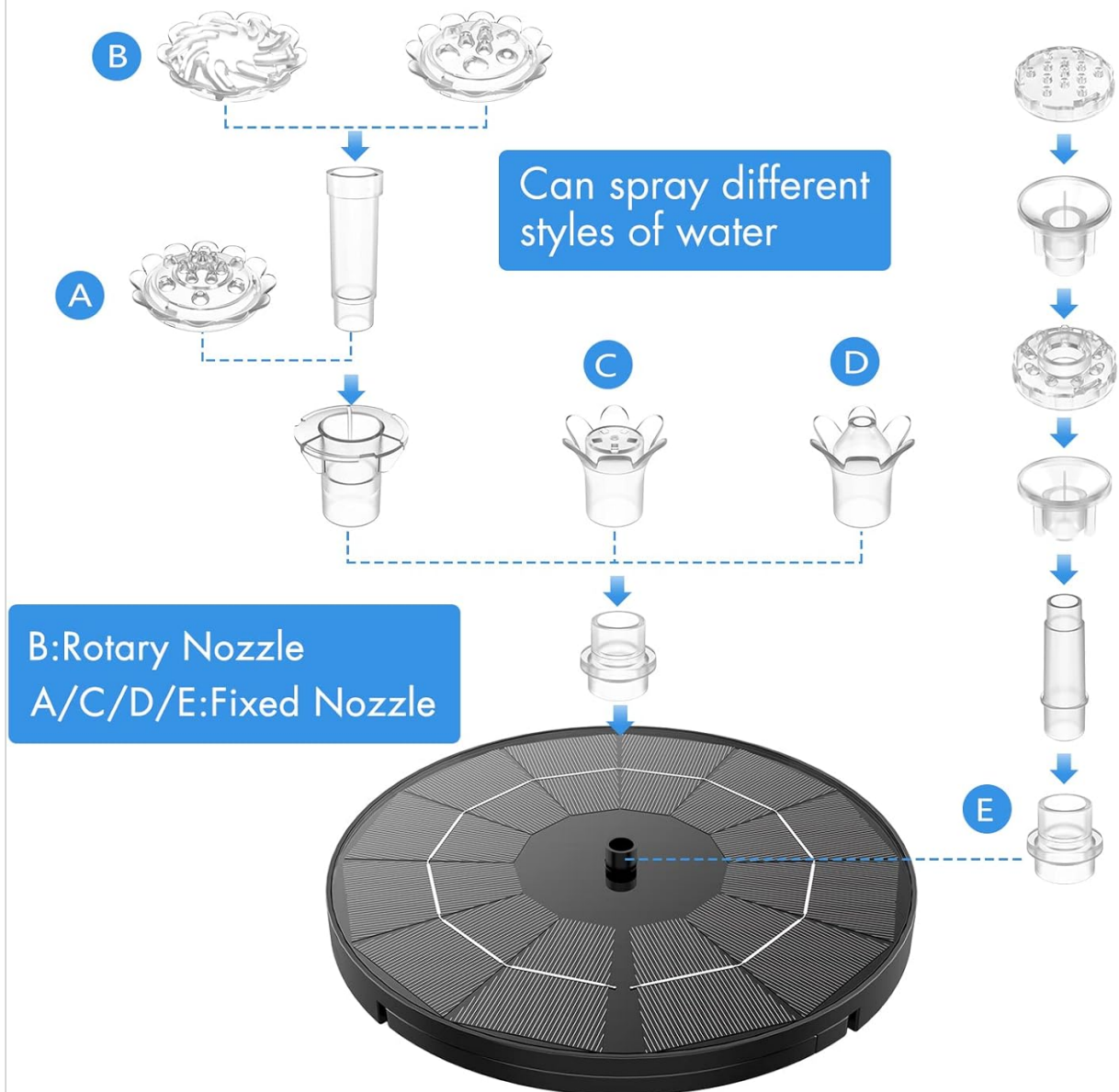

Image: A visual guide illustrating different nozzle types (rotating, double, vertical) and how they can be combined to produce various spray styles.

## 5.2 Water Shortage Protection

The pump features a built-in water shortage protection mechanism. If the water level drops too low and the pump is no longer fully submerged, it will automatically stop operating to prevent damage and extend its lifespan. Ensure the water basin is adequately filled for continuous operation.

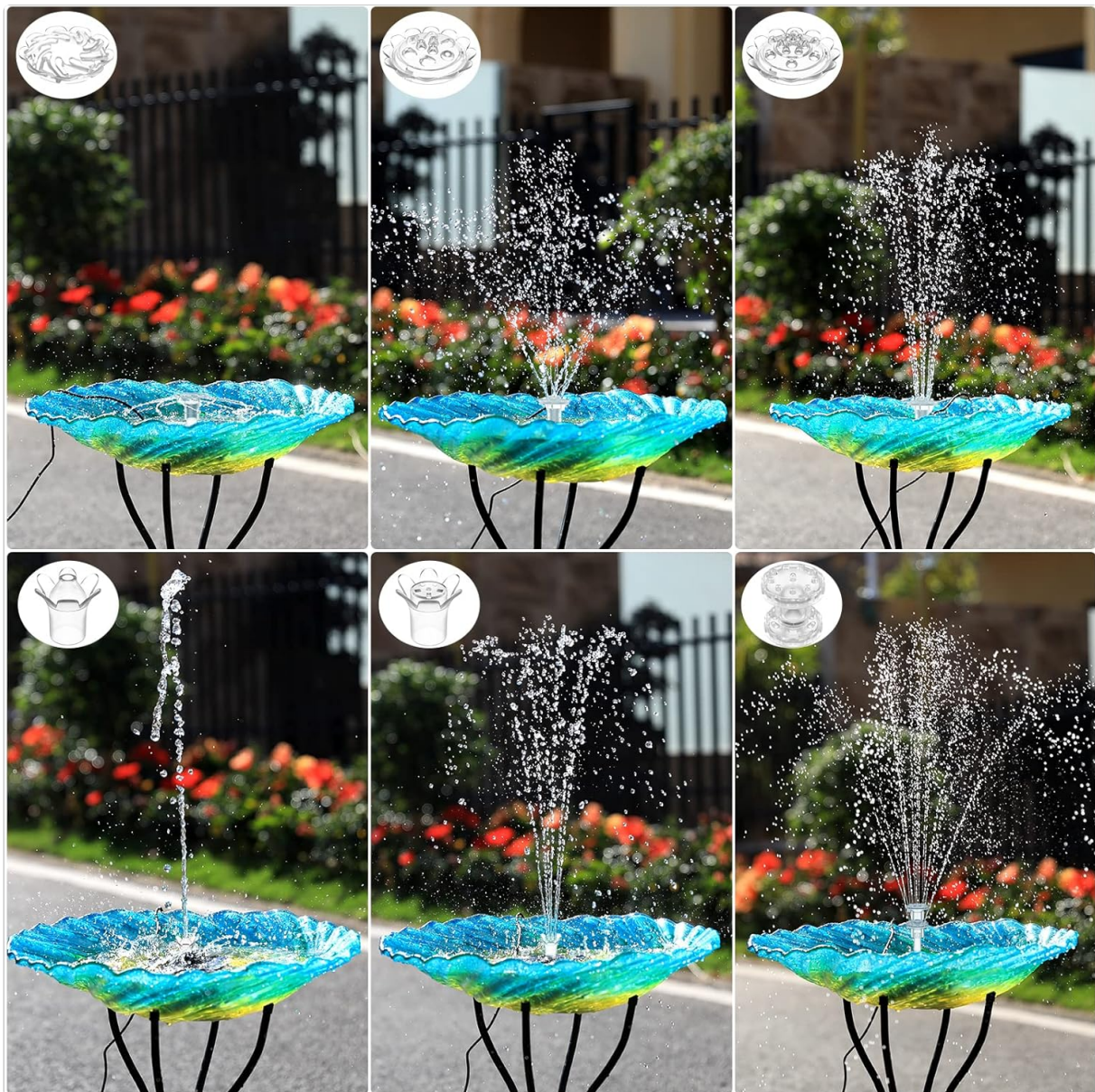

Image: A collage of six different water spray patterns, demonstrating the variety achievable with the included nozzles.

## 6. MAINTENANCE

Regular maintenance is crucial for the optimal performance and longevity of your solar fountain pump.

- **Clean the Pump:** Periodically remove the pump from the water and clean any debris, algae, or impurities that may have accumulated. This prevents clogging and ensures consistent water flow.
- **Clean the Filter:** The pump includes a filter sponge. Clean or replace this filter regularly to maintain water quality and pump efficiency.
- **Clean the Solar Panel:** Wipe the surface of the solar panel with a soft, damp cloth to remove dust, dirt, or leaves. A clean solar panel ensures maximum sunlight absorption and power generation.
- **Maintain Water Level:** Always ensure there is enough water in the basin for the pump to be fully submerged. Evaporation can quickly reduce water levels, especially on sunny days.

## 7. TROUBLESHOOTING

If your solar fountain pump is not operating as expected, consider the following common issues and solutions:

Problem	Possible Cause	Solution
Fountain not spraying or weak spray	<ul style="list-style-type: none"> <li>◦ Insufficient direct sunlight</li> <li>◦ Solar panel is dirty or blocked</li> <li>◦ Water level is too low</li> <li>◦ Pump or nozzle is clogged with debris</li> </ul>	<ul style="list-style-type: none"> <li>◦ Move the solar panel to an area with direct sunlight.</li> <li>◦ Clean the solar panel surface.</li> <li>◦ Add more water to the basin until the pump is fully submerged.</li> <li>◦ Clean the pump and nozzle thoroughly.</li> </ul>
Fountain stops working intermittently	<ul style="list-style-type: none"> <li>◦ Intermittent sunlight (clouds, shade)</li> <li>◦ Water shortage protection activated</li> </ul>	<ul style="list-style-type: none"> <li>◦ Ensure consistent direct sunlight.</li> <li>◦ Check and refill water level.</li> </ul>
Water splashes out of basin	<ul style="list-style-type: none"> <li>◦ Nozzle type is too powerful for the basin size</li> <li>◦ Fountain is too close to the edge</li> </ul>	<ul style="list-style-type: none"> <li>◦ Change to a less powerful nozzle or one with a wider, lower spray.</li> <li>◦ Use the retractable brackets to center the fountain.</li> </ul>

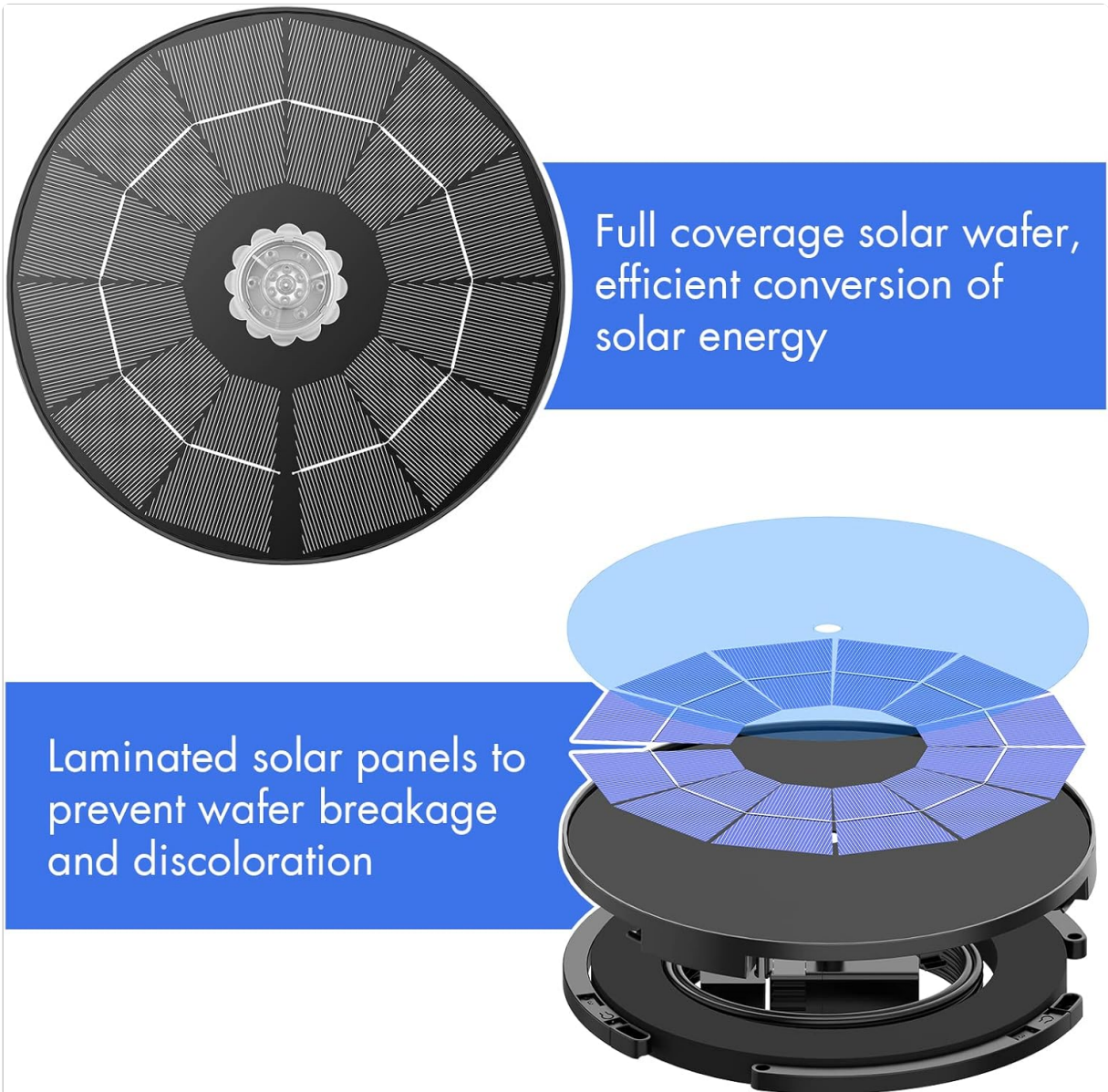

Image: A detailed view of the solar panel and pump, highlighting the full coverage solar wafer and laminated panels for efficient energy conversion.

## 8. SPECIFICATIONS

Feature	Detail
Brand	AISITIN
Model	3.5W Solar Fountain Pump
Power Source	Solar Powered
Material	Plastic
Color	Black
Product Dimensions	9"L x 8"W x 2"H
Item Weight	12.69 Ounces
Special Features	DIY Water Feature, Garden Decorations, Solar Bird Bath Fountain, Solar Fountain, Solar Water Pump
Included Components	Solar fountain, multiple nozzles, etc.

## 9. WARRANTY AND SUPPORT

For warranty information or technical support, please refer to the product packaging or contact AISITIN customer service directly. Contact details can typically be found on the manufacturer's website or through your purchase platform.