

LoraTap SS9111Q1

LoraTap Wireless Switch Kit SS9111Q1 Instruction Manual

Model: SS9111Q1 | Brand: LoraTap

1. INTRODUCTION

This manual provides comprehensive instructions for the installation, setup, operation, and maintenance of your LoraTap Wireless Switch Kit, Model SS9111Q1. This kit allows for convenient remote control of lighting fixtures using an 868 MHz radio frequency transmitter and a compact receiver module. It is designed for easy integration into existing electrical systems, offering both fixed and portable control options.

Please read this manual thoroughly before installation and use to ensure safe and correct operation.

2. SAFETY INFORMATION

WARNING: Electrical installation should only be performed by a qualified electrician or competent person. Always disconnect power at the circuit breaker before performing any electrical work.

- Ensure the main power supply is switched off before installation or maintenance.
- The receiver module requires a neutral wire for operation. Verify its availability before installation.
- Do not use this switch with dimmer switches or any other power variation wall switches, as this may damage the relay receiver.
- The maximum load capacity is 2500W. Do not exceed this rating.
- Operating voltage range: 85-265V AC.
- This product is not a Wi-Fi switch.

Veuillez noter la compatibilité

Veuillez ne pas utiliser un autre interrupteur à variation de puissance mural pour atténuer le récepteur de relais, sinon, le récepteur de relais pourrait être endommagé.

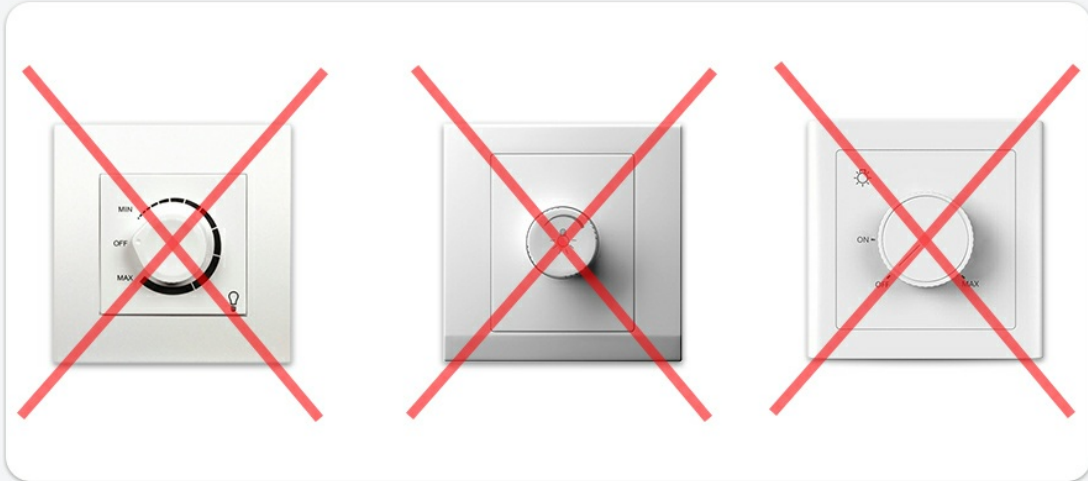

Interrupteur de variation de lumière

Image: Illustration showing incompatible dimmer switches with a red cross, indicating they should not be used with the LoraTap wireless switch kit.

3. PACKAGE CONTENTS

Verify that all components are present in your package:

- 1x Wireless Transmitter (Remote Control)
- 1x Relay Receiver Module
- 1x Wall Plate for Transmitter
- 3x Double-sided Adhesive Tapes
- Screws and Wall Anchors
- 1x Small Screwdriver
- 3x Wiring Cables
- 1x User Guide (This manual)

Qu'est-ce qu'il y a dans la boîte?



Émetteur

①

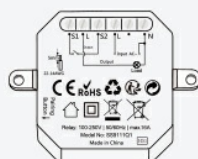

Récepteur de relais

②



Terminal

③



Vis

④

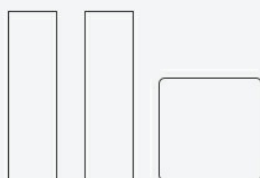

3 bandes adhésives doubles faces

⑤



Tournevis

⑥



3 câbles pour la câblage

⑦



Guide de l'utilisateur

⑧

Image: Visual representation of the LoraTap Wireless Switch Kit contents, including the transmitter, receiver, mounting accessories, and tools.

4. SPECIFICATIONS

| Feature | Detail |
|--------------------------|--|
| Model Number | SS9111Q1 |
| Brand | LoraTap |
| Operating Voltage | 85-265V AC |
| Max Load Power | 2500W |
| Radio Frequency | 868 MHz |
| Indoor Control Range | Up to 30 meters (through walls) |
| Outdoor Control Range | Up to 200 meters |
| Transmitter Battery | 1x CR2032 Lithium Metal (included) |
| Transmitter Battery Life | Over 10 years (approx. 220,000 clicks) |
| Receiver Dimensions | Approx. 46mm x 46mm x 18mm (L x W x H) |
| Transmitter Dimensions | Approx. 67mm x 67mm (L x W) |
| Material | Plastic |
| Certifications | CE, RoHS |

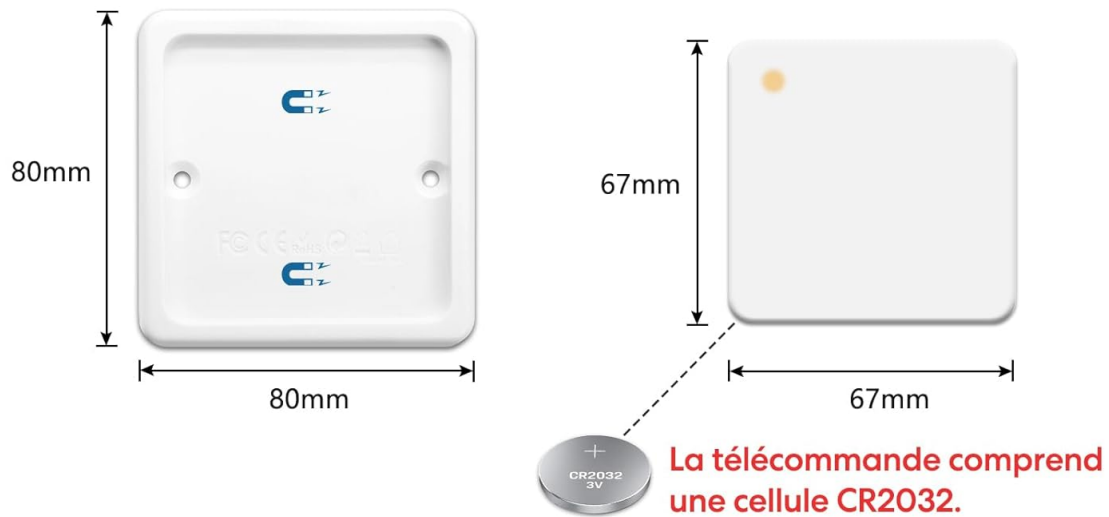

Installation de la plaque de mur magnétique

Méthode 1

Installation avec une bande adhésive double face.

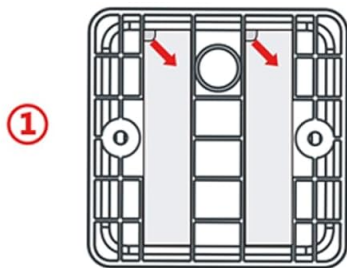

Méthode 2

Fixez la plaque de mur au mur avec des vis.

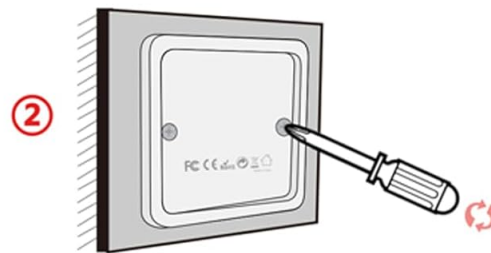

Image: Dimensions of the wireless transmitter and its wall plate, highlighting the CR2032 battery.

5. INSTALLATION

The LoraTap Wireless Switch Kit is designed for easy installation without extensive wiring or wall damage. Ensure power is disconnected before proceeding.

5.1 Receiver Module Wiring

The receiver module must be installed in a location where it can receive power (Live and Neutral) and connect to the load (e.g., a light fixture). A neutral wire is essential for the receiver's operation. The terminal block accepts one wire of maximum 1.5 mm² per terminal.

Note: Some users recommend using solid copper core cables instead of multi-strand aluminum for better connection stability.

Wiring Diagrams:

1. **Connecting with an Existing Wall Switch (Two-Way Control):** This setup allows both the traditional wall switch and the wireless transmitter to control the light.

Un fil neutre est nécessaire, il est essentiel pour l'alimentation électrique.



Image: Detailed wiring diagram illustrating how to integrate the LoraTap receiver with a standard wall switch for two-way control.

2. **Direct Connection to Load (No Existing Wall Switch):** Use this method if you are adding a new control point for a light fixture without a pre-existing wall switch.

Trois méthodes d'installation

Assurez-vous qu'il y a un fil neutre lors de l'installation afin que l'unité puisse être alimentée.

① Le module fonctionne avec l'interrupteur de la mur

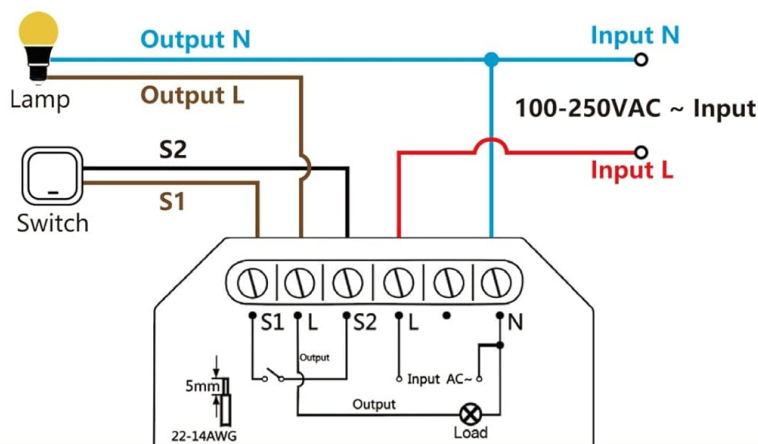

② Non connecté à l'interrupteur de mur

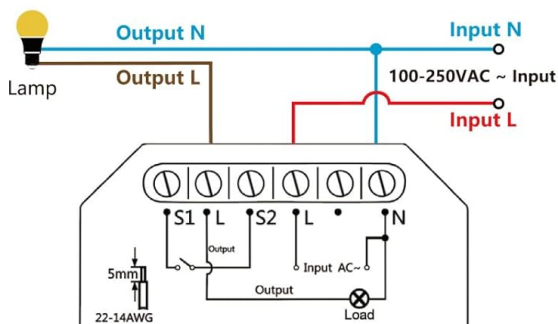

③ Fonctionne avec un interrupteur à deux voies

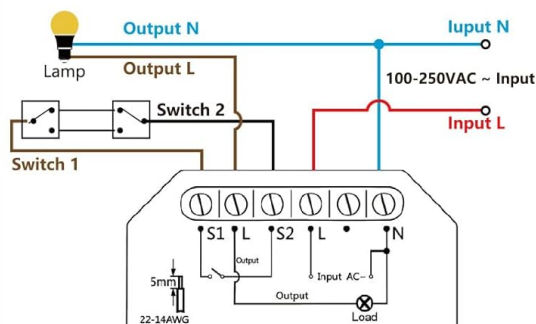

Image: Comprehensive wiring diagrams for various installation scenarios, including direct connection to a lamp (Method 2).

3. **Two-Way Switch Functionality (Va-et-vient):** The kit supports creating a two-way switch setup with your traditional switch. Refer to the provided wiring diagrams for specific connections.

The compact size of the receiver (approx. 46x46x18mm) allows for installation within existing switch boxes or ceiling rose enclosures, provided there is sufficient space and a neutral wire.

5.2 Transmitter Mounting

The wireless transmitter can be used in two ways: fixed to a wall or as a portable remote control.

- **Fixed Mode:** Attach the wall plate to your desired location using the included double-sided adhesive tape or screws. The transmitter magnetically attaches to this plate.
- **Portable Mode:** The transmitter can be easily removed from its magnetic wall plate to be used as a handheld remote control.

Montable et amovible

Mode fixe



Mode portable



Image: The LoraTap wireless switch demonstrating both fixed wall-mounted and portable handheld usage modes.

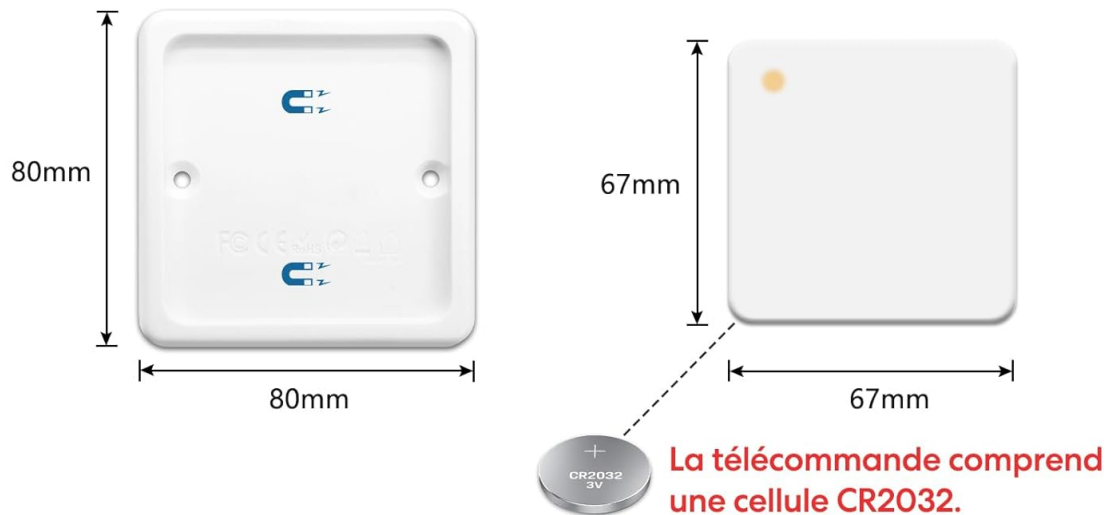

Installation de la plaque de mur magnétique

Méthode 1

Installation avec une bande adhésive double face.

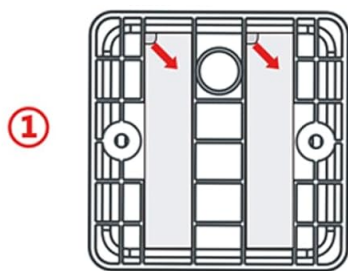

Méthode 2

Fixez la plaque de mur au mur avec des vis.

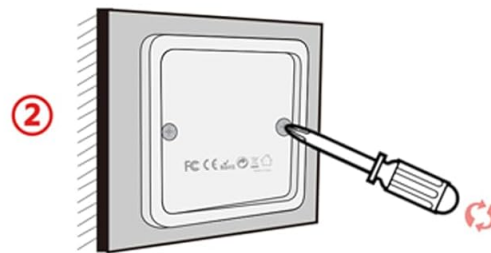

Image: Instructions for installing the magnetic wall plate using either adhesive tape or screws.

6. SETUP AND PAIRING

The LoraTap Wireless Switch Kit typically comes pre-paired from the factory, ready for immediate use after installation. However, if you need to pair additional transmitters to a receiver, or re-pair existing ones, follow these steps:

1. Ensure the receiver module is powered on.
2. Press and hold the pairing button on the receiver module (usually a small button, refer to the receiver diagram for exact location) until the indicator light starts flashing.
3. Within 5 seconds of the indicator light flashing, press the desired button on your wireless transmitter.
4. The receiver's indicator light will stop flashing, confirming successful pairing.

Multiple transmitters can be paired to a single receiver, and one transmitter can control multiple receivers. Each product has an independent ID, preventing interference between multiple units.

Pas d'interférences

Chaque produit possède un ID indépendant, permettant l'utilisation simultanée de plusieurs ensembles sans interférences entre eux.

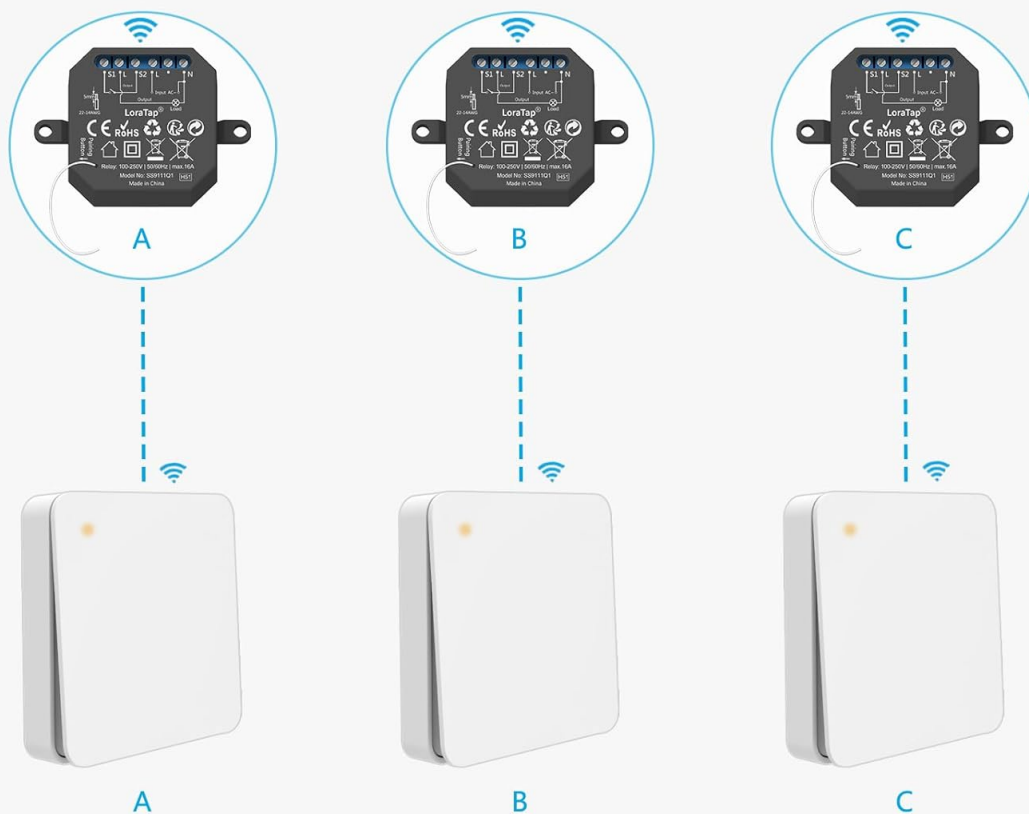

Image: Illustration demonstrating that multiple LoraTap wireless switch kits can operate simultaneously without signal interference.

7. OPERATION

Once installed and paired, operate the switch by pressing the button on the wireless transmitter. The transmitter has a tactile button for ON/OFF control.

- **Control Range:** The wireless signal has an indoor range of up to 30 meters and an outdoor range of up to 200 meters. It can effectively transmit through walls, windows, and ceilings.
- **Indicator Light:** The transmitter features a small indicator light that illuminates briefly when pressed, confirming signal transmission and indicating battery health. This light does not indicate the ON/OFF status of the connected load.
- **Memory Function:** The receiver module includes a memory function. If power is interrupted and then restored, the connected light will return to its last known state (ON or OFF) before the power cut.

Super distance de contrôle à distance

La portée de contrôle intérieure est de jusqu'à 30 mètres, et le signal fort peut passer à travers les murs, les fenêtres et les plafonds.

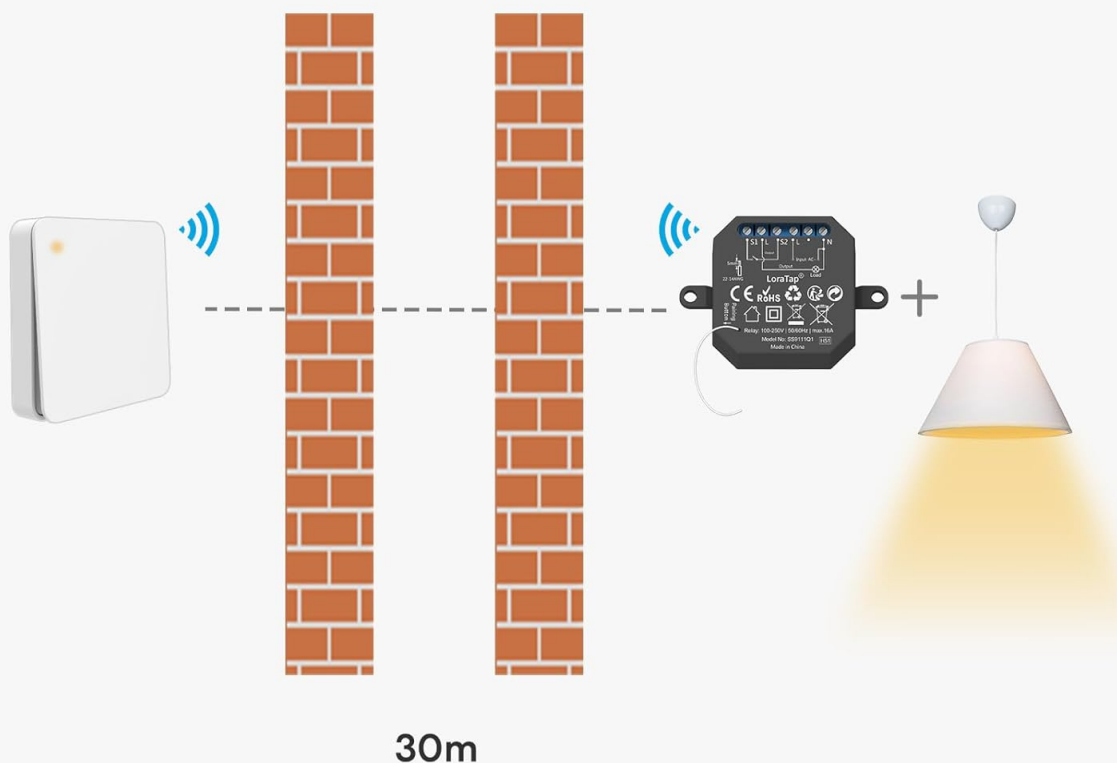

Image: Visual representation of the wireless control range, demonstrating signal penetration through multiple walls.

Module de lumière avec fonction mémoire

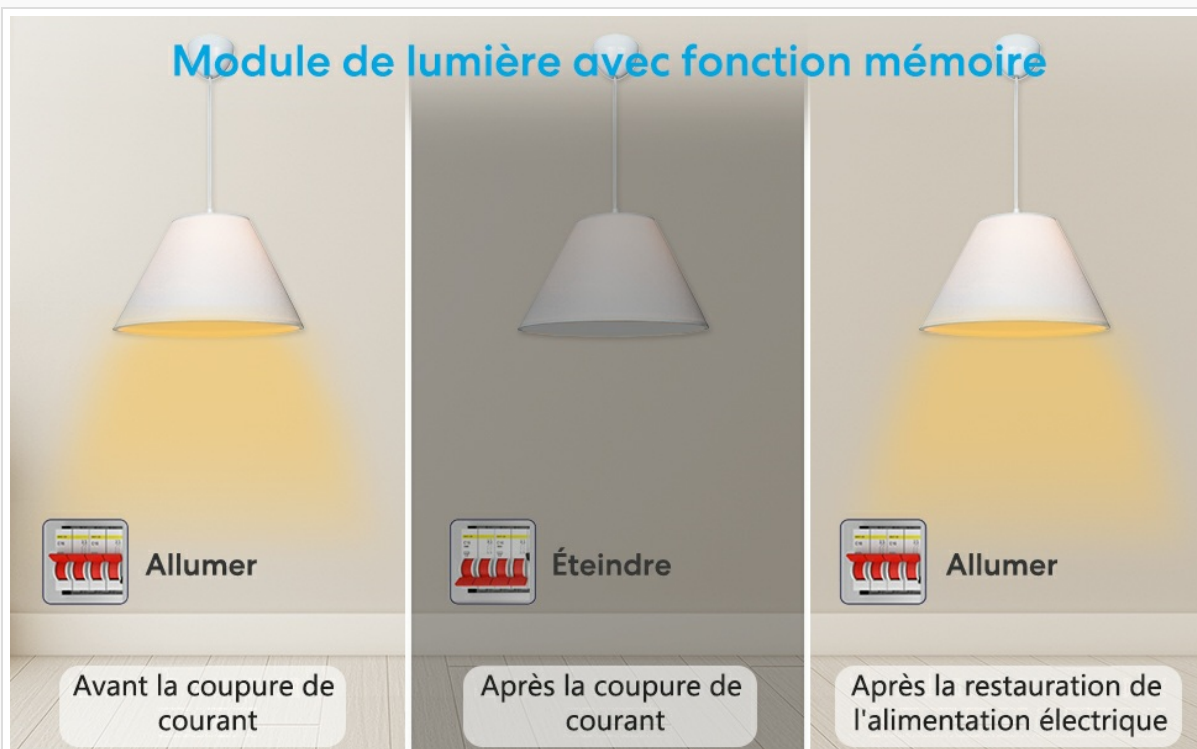

Image: Demonstration of the memory function, showing the light returning to its previous state after a power interruption.

8. MAINTENANCE

8.1 Battery Replacement

The wireless transmitter is powered by a CR2032 lithium metal battery, which has a lifespan of over 10 years or approximately 220,000 clicks. When the indicator light on the transmitter becomes dim or fails to illuminate upon pressing, it's time to replace the battery.

1. Carefully open the transmitter casing (refer to the product diagram for the battery compartment location).
2. Remove the old CR2032 battery.
3. Insert a new CR2032 battery with the positive (+) side facing up.
4. Close the transmitter casing securely.

8.2 Cleaning

Clean the surfaces of the transmitter and receiver with a soft, dry cloth. Do not use abrasive cleaners or solvents, as these may damage the plastic housing.

9. TROUBLESHOOTING

- **Light does not respond to transmitter:**

- Check if the receiver module is correctly wired and receiving power.
- Verify the transmitter battery. Replace the CR2032 battery if the indicator light is dim or not illuminating.
- Ensure the transmitter and receiver are paired. If not, follow the pairing instructions in Section 6.
- Confirm the transmitter is within the effective control range.

- **Light flickers or remains dimly lit when OFF (especially with LED lights):**

- This can occur due to residual voltage in the circuit. Ensure the neutral wire connection to the receiver is secure and correctly wired. In some cases, a capacitor may be needed across the load (light fixture) to absorb residual current, though this is not typically required for this product.

- **Delay in response when using with a traditional wired switch:**

- A slight delay (2-3 seconds) can sometimes be observed, especially if the traditional switch is toggled rapidly. This is generally a characteristic of the relay mechanism and not a fault.

- **Traditional wired switch does not control the light after receiver installation:**





- Double-check the wiring connections for the traditional switch (S1, S2 terminals on the receiver). Ensure the neutral wire is not interrupted by the traditional switch.

10. WARRANTY AND SUPPORT

The LoraTap Wireless Switch Kit SS9111Q1 comes with a **5-year warranty**. This warranty covers defects in materials and workmanship under normal use. For warranty claims or technical support, please contact your retailer or LoraTap customer service with your purchase details.

The product is CE and RoHS certified, ensuring compliance with European safety, health, and environmental protection requirements.

Related Documents - SS9111Q1

| | |
|---|--|
|  | <p>Loratap Wireless Socket User Guide - SP511Q2-US-V3, SP512Q2-US-V3</p> <p>User guide for the Loratap Wireless Socket models SP511Q2-US-V3 and SP512Q2-US-V3. Includes installation, pairing, troubleshooting, and technical specifications.</p> |
|  | <p>Loratap Wireless Outlet User Guide: Installation, Operation, and Troubleshooting</p> <p>Comprehensive user guide for Loratap wireless outlets (models SP511Q1, SP7512Q1, SP7513Q1). Learn about installation, operation, pairing, troubleshooting, and safety warnings for your smart home devices.</p> |
|  | <p>LoraTap SC500W Roller Shutter Module User Guide and Installation</p> <p>Comprehensive user guide for the LoraTap SC500W Roller Shutter Module, covering installation, wiring, setup with the Smart Life app, and troubleshooting for smart home automation.</p> |
|  | <p>LoraTap SC500W Smart Curtain Switch Installation Guide & Wiring Diagrams</p> <p>Detailed installation guide and wiring instructions for the LoraTap SC500W smart curtain switch module. This document covers installation cautions, wiring for standard blinds and blinds with built-in drivers, and options for use without a physical manual switch, ensuring proper AC power connection for smart home automation.</p> |
|  | <p>LoraTap SC420W-EU Smart Curtain Switch Installation Guide</p> <p>Detailed installation instructions for the LoraTap SC420W-EU Smart Curtain Switch, compatible with Tuya Smart Life, Google Home, and Alexa voice assistants for controlling roller shutter electric motors.</p> |



[Tuya ZigBee Remote User Guide - LoraTap Installation and Pairing](#)

Comprehensive user guide for the LoraTap Tuya ZigBee Remote. Includes installation instructions, pairing steps with ZigBee hubs, troubleshooting tips, and product specifications. Model numbers: SS6100ZB, SS6200ZB, SS600ZB, SS6400ZB, SS7100ZB, SS7200ZB, SS7300ZB, SS9100ZB-YA, SS9200ZB-YA, SS9300ZB-YA, SS9400ZB-YA, SS9600ZB.