

SmallRig 3660B

SmallRig L-Bracket 3660B Instruction Manual for Sony Alpha Series Cameras

Comprehensive guide for installation, operation, and maintenance of your SmallRig L-Bracket.

1. INTRODUCTION

This manual provides detailed instructions for the proper use and care of your SmallRig L-Bracket 3660B. Designed for select Sony Alpha series cameras, this L-bracket facilitates quick transitions between horizontal and vertical shooting orientations and offers multiple mounting points for accessories.



Image 1.1: SmallRig L-Bracket 3660B mounted on a Sony Alpha camera.

2. COMPATIBILITY

The SmallRig L-Bracket 3660B is compatible with the following Sony Alpha camera models:

- Sony A7 V
- Sony A7R V
- Sony A7 IV
- Sony A7S III
- Sony A1
- Sony A7R IV
- Sony A9 II

Note: When the L-bracket is attached, the LCD screen of the Alpha 7 IV / Alpha 7S can rotate up to 120 degrees.

Compatibility



For Sony
Alpha 7R V



For Sony
Alpha 7 IV



For Sony
Alpha 7S III



For Sony
Alpha1



For Sony
Alpha 7R IV



For Sony
Alpha 9 II

Image 2.1: Visual representation of compatible Sony Alpha camera models.

3. PACKAGE CONTENTS

Verify that all items are present in the package:

- Baseplate (L-Bracket 3660B) x 1
- Allen Wrench (integrated)

Package Includes

Baseplate × 1

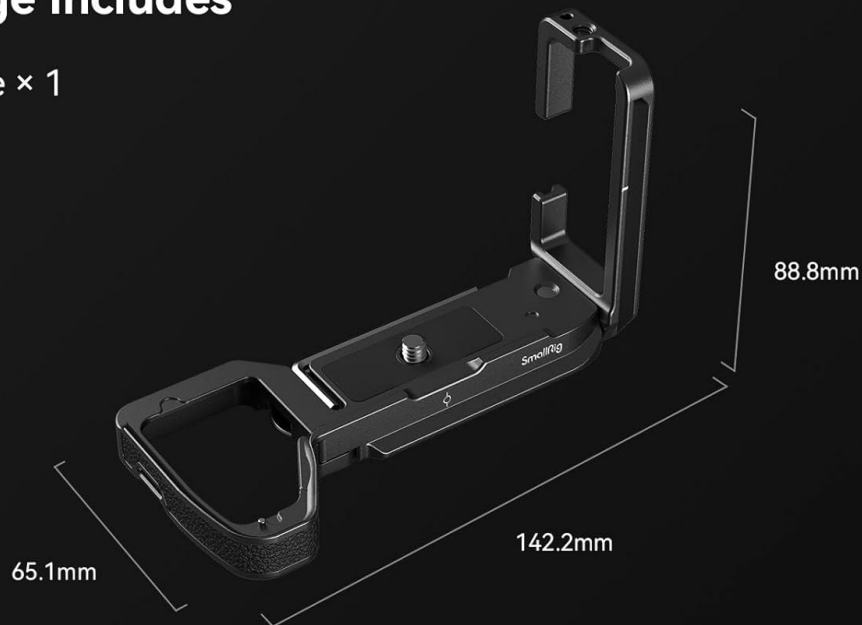

Specifications

Brand: SmallRig

Product Dimensions: 142.2 x 65.1 x 88.8mm

ID: 3660B

Package Dimensions: 161.0 x 123.0 x 71.5 mm

Net Weight: 135g±5g

Material: Material(s): Aluminum Alloy, Stainless Steel, Silicone, Genuine Leather

Image 3.1: Package contents and key dimensions of the L-Bracket.

4. SETUP AND INSTALLATION

4.1 Attaching the L-Bracket to Your Camera

1. Align the L-bracket with the bottom of your camera.
2. Secure the L-bracket to the camera using the 1/4"-20 screw at the bottom and the locating pin.
3. Ensure the built-in silicone cushions on the baseplate and side plate pad are properly positioned to prevent scratches and twisting.



Image 4.1: Proper attachment of the L-Bracket to the camera body.

4.2 Battery Access

The L-bracket features a spindle spanner at the battery door, allowing for easy battery replacement without disassembling the entire grip.

Easy Battery Replacement without L-Plate Disassembly

There is a hinge arm at the battery door, achieving easy battery replacement

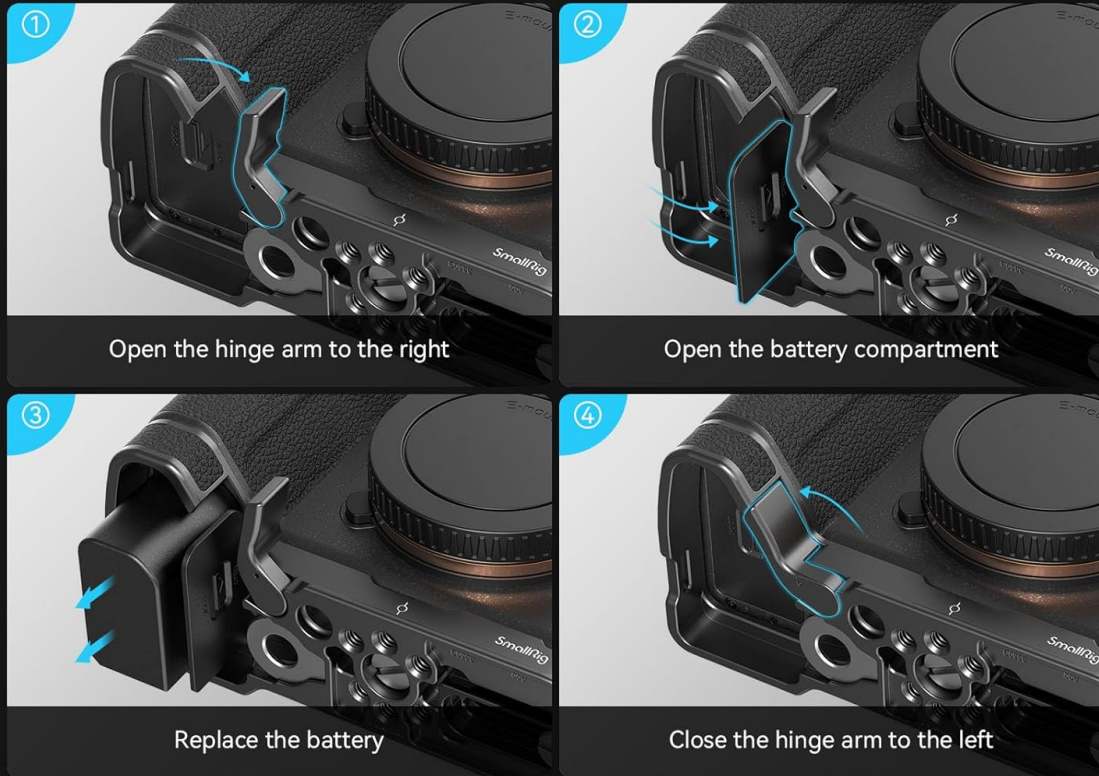

Image 4.2: Illustrated steps for battery access with the L-Bracket.

4.3 Multiple Mounting Points

The L-bracket provides various mounting options:

- **Base Plate:** Features multiple 1/4"-20 threaded holes and a 1/4"-20 screw with a locating pin. Includes a built-in wrist strap hole for use with Hand Strap 3848 and a QD mount for attaching a QD strap buckle.
- **Side Plate:** Equipped with a 1/4"-20 threaded hole with a locating pin hole.

Multiple Mounting Points



Image 4.3: Overview of the L-Bracket's multiple mounting points.

5. OPERATING INSTRUCTIONS

5.1 Quick Switching Between Horizontal and Vertical Shooting

The base plate and side plate are Arca-Swiss standard compatible, allowing for rapid transitions between horizontal and vertical shooting modes. This L-bracket is also compatible with Arca-Type tripods and DJI RS 2 / RSC 2 / RS 3 / RS 3 Pro gimbals.

Horizontal and Vertical Shooting

Designed with quick release plate for Arca-style for quickly switching between horizontal and vertical



Image 5.1: Demonstrating the quick switch functionality for shooting orientation.

5.2 Extendable Side Plate for Cable Access

The side plate can be adjusted by up to 25mm, providing space for cable access (e.g., HDMI) during vertical shooting. This feature enhances mounting flexibility.

Note: To access all ports, ensure the side plate is pulled out first.

Extendable Design for Total Flexibility

The baseplate can be stretched up to 25mm during vertical shooting to allow cable access



Image 5.2: The extendable side plate feature for improved cable management.

5.3 Unobstructed Interface Access

The design of the L-bracket ensures that all camera interfaces, including ports and the LCD screen, remain accessible and unobstructed.

No Blocking of the Interface



Image 5.3: Visual confirmation of full access to camera interfaces.

5.4 Enhanced Grip

The L-bracket integrates with the camera body, providing a comfortable grip and leaving room for the little finger, which can improve handling during extended use.

6. INSTRUCTIONAL VIDEOS

The following video demonstrates a quick release mechanism, similar to the functionality provided by the SmallRig L-Bracket 3660B for rapid transitions between shooting orientations.

Your browser does not support the video tag.

Video 6.1: Demonstration of a quick release system, illustrating principles applicable to the L-Bracket's design.

7. MAINTENANCE

- **Cleaning:** Use a soft, dry cloth to wipe the L-bracket. Avoid abrasive cleaners or solvents that could damage the finish.
- **Storage:** Store the L-bracket in a dry, dust-free environment when not in use.
- **Inspection:** Periodically check all screws and connections to ensure they are secure. Tighten if necessary using the integrated Allen wrench.

8. TROUBLESHOOTING

- **Loose Fit:** If the L-bracket feels loose on the camera, ensure the 1/4"-20 screw is fully tightened and the locating pin is correctly engaged.
- **Blocked Ports:** If a port is blocked, verify that the extendable side plate is fully extended.
- **LCD Screen Rotation Issue:** Confirm that your camera model is listed in the compatibility section. Note that some models have a limited rotation angle (e.g., 120 degrees for Alpha 7 IV / Alpha 7S) when the L-bracket is attached.

9. SPECIFICATIONS

Attribute	Detail
Brand	SmallRig
Model ID	3660B
Product Dimensions	142.2 x 65.1 x 88.8 mm
Net Weight	135g ± 5g
Material	Aluminum Alloy, Stainless Steel, Silicone, Genuine Leather
Color	Black
Compatible Devices	Sony A7 V / A7R V / A7 IV / A7S III / A1 / A7R IV / A9 II

10. WARRANTY AND SUPPORT

For warranty information and customer support, please refer to the official SmallRig website or contact your local distributor. Keep your purchase receipt for warranty claims.

Manufacturer: SMALLRIG

ASIN: B09PTTQJHH

