

Manuals.plus /

- › 4D Cityscape /
- › 4D Cityscape Harry Potter Hagrid's Hut 3D Puzzle Instruction Manual

4D Cityscape 4D51072

4D Cityscape Harry Potter Hagrid's Hut 3D Puzzle Instruction Manual

Model: 4D51072

INTRODUCTION

Welcome to the magical world of Harry Potter with your new 4D Cityscape Hagrid's Hut 3D Puzzle. This 101-piece model is designed for enthusiasts aged 14 and up, offering a rewarding assembly experience. Crafted with Core-Gate™ EPS Technology, each piece is precisely manufactured to ensure a true likeness and color matching the original design. No glue is required for assembly, making the process clean and straightforward. The final assembled product is a detailed collectible model, perfect for any Harry Potter fan.

WHAT'S IN THE BOX

Your 4D Cityscape Harry Potter Hagrid's Hut 3D Puzzle package contains:

- 101 Pieces
- Detailed Instruction Booklet

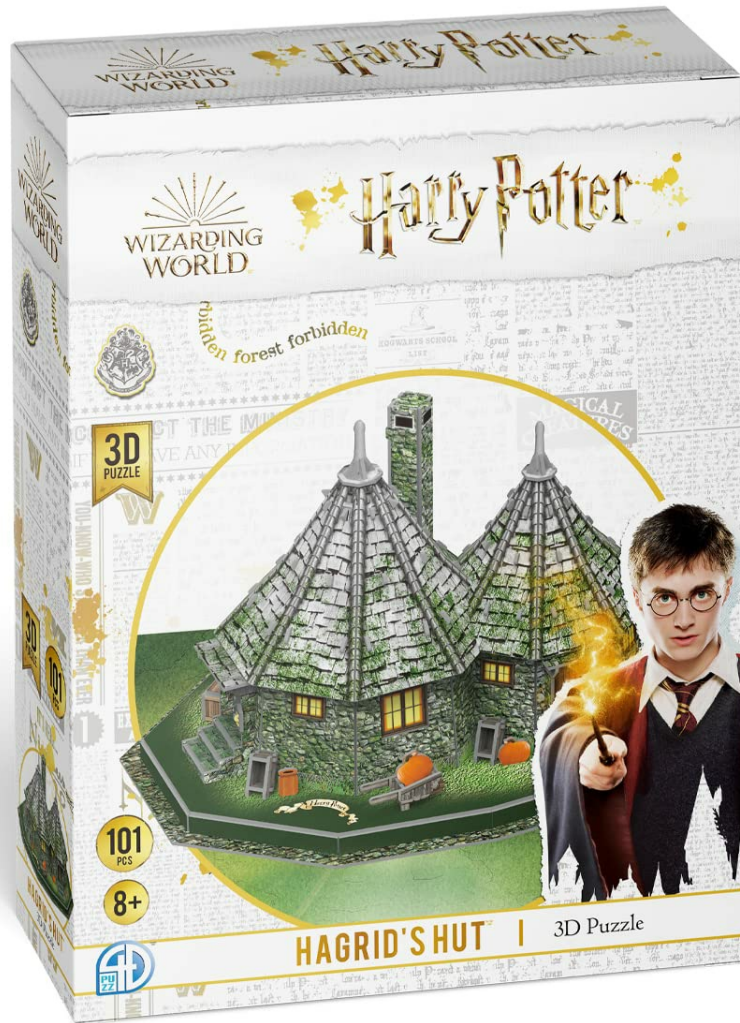

Front view of the 3D puzzle box for Hagrid's Hut, featuring Harry Potter and the assembled model. The box indicates 101 pieces and an age recommendation of 8+.



Back view of the 3D puzzle box, displaying the assembled model and individual pieces, along with a real-life image of Hagrid's Hut.

ASSEMBLY INSTRUCTIONS

Follow these steps carefully to assemble your Hagrid's Hut 3D Puzzle. Refer to the included instruction booklet for detailed diagrams and piece identification. No glue is required for assembly.

1. **Preparation:** Unpack all contents. Identify the different sheets of puzzle pieces. Carefully punch out all pieces from their sheets. Ensure all small holes for tabs are clear.
2. **Sorting:** Sort the pieces by color, design, or number as indicated in the instruction booklet. This will help streamline the assembly process.
3. **Assemble Flat Sections:** Begin by assembling the flat base sections of the puzzle. These often form the foundation upon which the 3D structure is built.
4. **Build Vertical Structures:** Connect the vertical wall pieces and other structural components by inserting the tabs into the corresponding slots. Ensure a snug fit for stability.

5. **Add Details and Roof:** Once the main structure is stable, add smaller decorative pieces and the roof sections. The roof pieces are designed to interlock securely.
6. **Final Connections:** Connect any remaining sections or bridges as per the instruction diagrams to complete the full model of Hagrid's Hut.

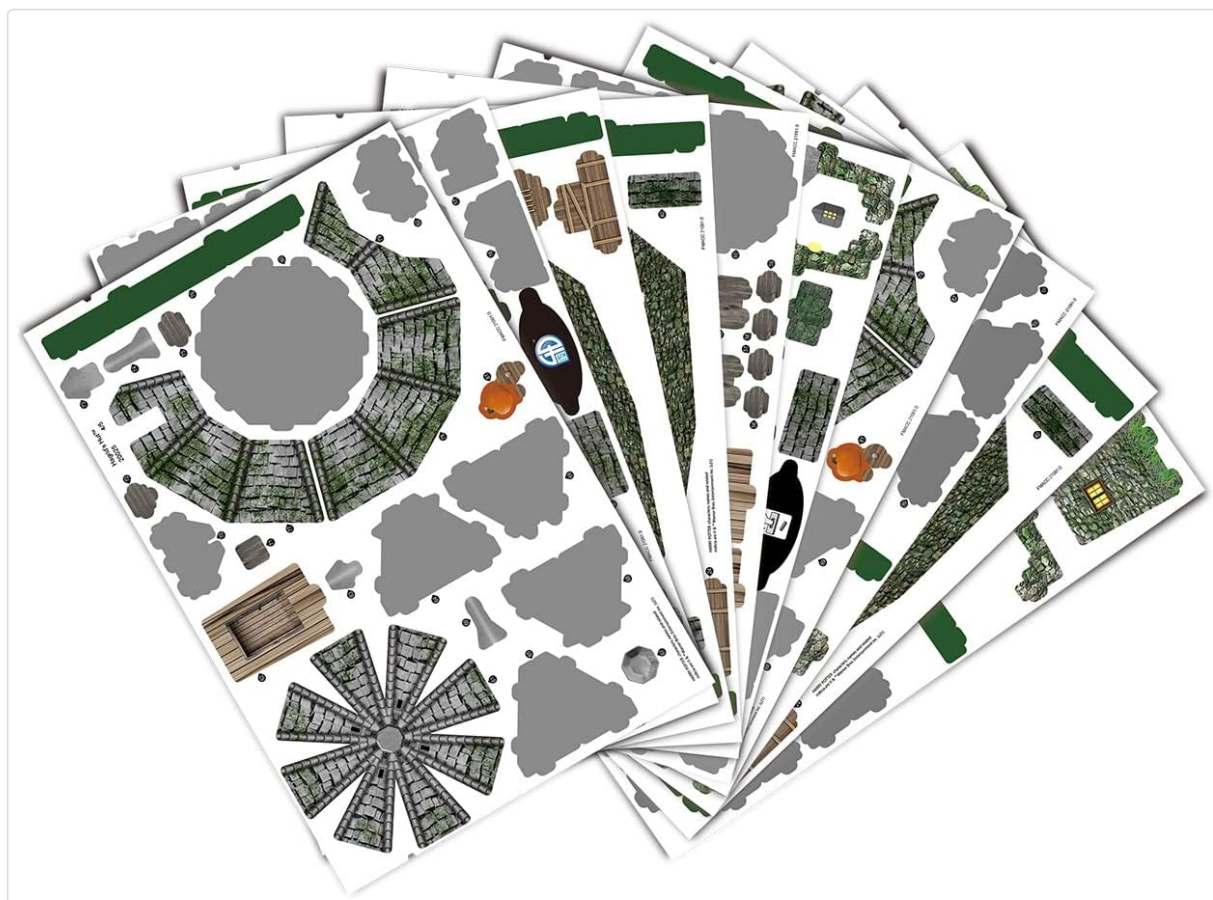

Multiple sheets of puzzle pieces before punching out, illustrating the layout and numbering. Each piece is clearly marked for easy identification during assembly.



Various unassembled puzzle pieces laid out on a surface, demonstrating the foam material and printed details ready for assembly.



Fully assembled 3D model of Hagrid's Hut, showcasing its detailed design with two round structures and a mossy roof.

PRODUCT FEATURES

- Official and approved Warner Brothers Licensed Product.
- Manufactured with 2.00 mm Core-Gate™ EPS Technology for precision modeling.
- All color specifications are approved through Pantone references for true likeness and color.
- No glue is required for assembly.
- The fully assembled product measures 9.06" x 12.6" x 7.8".

SPECIFICATIONS

Feature	Detail
Product Dimensions	12 x 9 x 2 inches (packaging)
Assembled Dimensions	9.06" x 12.6" x 7.8"
Item Weight	1.06 pounds
ASIN	B09PMBWPWB
Item Model Number	4D51072
Manufacturer Recommended Age	14 years and up
Manufacturer	4D Brand International
Number of Pieces	101
Assembly Time	Approximately 4 hours
Material	Core-Gate™ EPS Technology

SAFETY INFORMATION

- **Choking Hazard:** This product contains small parts and is not suitable for children under 3 years of age.
- **Age Recommendation:** Recommended for ages 14 and up due to the complexity of assembly.
- **Handling:** Handle pieces with care to avoid bending or tearing.

MAINTENANCE

To ensure the longevity of your 3D puzzle model:

- **Cleaning:** Gently dust the assembled model with a soft, dry cloth. Avoid using liquid cleaners or abrasive materials.
- **Storage:** Store the model in a dry environment, away from direct sunlight or extreme temperatures, to prevent material degradation or fading.
- **Handling:** When moving the model, support it from the base to prevent damage to the assembled structure.

TROUBLESHOOTING

- **Difficulty with Piece Insertion:** If a tab does not fit easily into a slot, gently wiggle it or check for any remaining paper debris in the slot. Do not force pieces, as this may cause damage.
- **Loose Connections:** Ensure all tabs are fully inserted into their corresponding slots. The foam material is designed to hold securely without glue.
- **Missing Pieces:** In the rare event of a missing piece, please contact the manufacturer, 4D Brand International, for assistance.

WARRANTY AND SUPPORT

Specific warranty information is not provided in the product details. For any product support, warranty claims, or inquiries regarding your 4D Cityscape Harry Potter Hagrid's Hut 3D Puzzle, please contact the manufacturer, 4D Brand International, directly. Refer to the product packaging for contact details or visit their official website.