

Epson ST-C4100

Epson Workforce ST-C4100 Wireless Inkjet Multifunction Printer User Manual

Model: ST-C4100

1. INTRODUCTION

This manual provides instructions for the setup, operation, maintenance, and troubleshooting of your Epson Workforce ST-C4100 Wireless Inkjet Multifunction Printer. Please read this manual thoroughly before using the product to ensure proper and safe operation.

The Epson Workforce ST-C4100 is a Supertank Color Multifunction Printer (MFP) designed for small work teams. It features easy-to-fill, supersized ink tanks, automatic 2-sided printing, and convenient wired and wireless networking capabilities. The printer also includes a 2.4-inch color touchscreen, a 30-sheet Automatic Document Feeder (ADF), and fax functionality.

2. WHAT'S IN THE BOX

Verify that all components are present before proceeding with setup:

- Epson WorkForce ST-C4100 MFP
- User Manual (this document)
- Power Cord
- 2 x 502 Black Ink Bottles (127 mL each)
- 2 x 502 Cyan Ink Bottles (70 mL each)
- 2 x 502 Magenta Ink Bottles (70 mL each)
- 2 x 502 Yellow Ink Bottles (70 mL each)

3. SETUP

3.1 Unpacking the Printer

Carefully remove the printer from its packaging. Remove all protective tapes and packing materials from the

exterior and interior of the printer.



Image: The Epson Workforce ST-C4100 printer, showing its compact design and paper handling capabilities.

3.2 Power Connection

Connect the power cord to the printer and then to a power outlet. The printer features a 90-degree power cord for flexible placement in tight spaces.

3.3 Initial Ink Filling

The ST-C4100 uses Supertank ink bottles. Follow these steps to fill the ink tanks:

1. Open the ink tank unit cover on the side of the printer.
2. Open the cap for the corresponding color ink tank.
3. Uncap the ink bottle and insert it into the filling port. The ink will automatically fill the tank.
4. Once the tank is full, remove the bottle and securely close the ink tank cap and the unit cover.



Image: A detailed view of the printer's Supertank ink reservoirs, indicating the separate compartments for black, cyan, magenta, and yellow inks.

3.4 Paper Loading

Load paper into the 250-sheet capacity paper tray:

1. Pull out the paper cassette from the front of the printer.
2. Adjust the paper guides to match the size of your paper.
3. Load the paper stack print-side down.
4. Slide the paper cassette back into the printer.



Image: The paper input tray of the Epson ST-C4100, shown extended with paper ready for loading.

3.5 Network Connection

The printer supports both wired (Ethernet) and wireless (Wi-Fi) connectivity.

- **Wireless Setup:** Use the 2.4-inch color touchscreen to navigate to the network settings and connect to your Wi-Fi network.
- **Wired Setup:** Connect an Ethernet cable from your router or network hub to the Ethernet port on the printer.

The Epson Smart Panel® app can assist with setup and monitoring from your mobile device.

4. OPERATING THE PRINTER

4.1 Control Panel Overview

The printer features a 2.4-inch color touchscreen for easy navigation and operation.



Image: The printer's front view, highlighting the intuitive touchscreen interface for various functions.

4.2 Printing Documents

To print from a computer or mobile device, ensure the printer is connected to the same network. Select the print option from your application and choose the Epson ST-C4100. The printer supports automatic 2-sided printing to save paper.



Image: The Epson ST-C4100 in operation, demonstrating its ability to produce color prints.

4.3 Copying Documents

Place your document on the scanner glass or in the 30-sheet Automatic Document Feeder (ADF). Use the touchscreen to select the "Copy" function and adjust settings such as number of copies, color/black & white, and paper size.



Image: The Automatic Document Feeder (ADF) of the Epson ST-C4100, showing a document inserted for multi-page scanning or copying.

4.4 Scanning Documents

Documents can be scanned to a computer or cloud service. Place the document on the scanner glass or in the ADF. Select the "Scan" function from the touchscreen and follow the prompts to choose your destination and settings.

4.5 Faxing Documents

The ST-C4100 includes fax functionality. Connect a phone line to the printer's fax port. Use the touchscreen to enter the recipient's fax number and send your document.

5. MAINTENANCE

5.1 Ink Refilling

Monitor ink levels through the transparent ink tanks or the printer's display. When an ink tank is low, refill it using genuine Epson 502 ink bottles. Refer to section 3.3 for ink filling instructions.

Note: Using non-Epson ink may affect print quality and printer performance, and could void your warranty.

5.2 Cleaning the Printer

- **Exterior:** Wipe the exterior of the printer with a soft, damp cloth.
- **Scanner Glass:** Clean the scanner glass with a soft, lint-free cloth and a mild glass cleaner.

- **Print Head Cleaning:** If print quality declines (e.g., missing lines, streaking), perform a print head cleaning cycle through the printer's maintenance menu on the touchscreen.

5.3 Firmware Updates

Periodically check for and install firmware updates to ensure optimal performance and access to the latest features. Updates can typically be performed via the printer's network connection through the settings menu.

6. TROUBLESHOOTING

6.1 Common Issues and Solutions

- **Printer Not Responding:**
 - Check power connections.
 - Verify network connectivity (Wi-Fi or Ethernet).
 - Restart the printer and your computer/device.
- **Poor Print Quality:**
 - Perform a print head cleaning and nozzle check from the maintenance menu.
 - Ensure ink tanks are adequately filled.
 - Use appropriate paper type and quality.
- **Paper Jams:**
 - Turn off the printer and carefully remove any jammed paper from the input tray, output tray, or internal access areas.
 - Ensure paper is loaded correctly and not overfilled.
- **Wireless Connection Issues:**
 - Confirm the printer is within range of your wireless router.
 - Re-enter Wi-Fi credentials via the touchscreen.
 - Restart your router and printer.

For further assistance, refer to the Epson support website or contact customer service.

7. SPECIFICATIONS

Feature	Detail
Model Name	WorkForce ST-C4100
Printing Technology	Inkjet (PrecisionCore Heat-Free Technology)
Printer Output	Color
Functions	Print, Copy, Scan, Fax
Connectivity	Networkable, USB, Wireless (Wi-Fi, Ethernet)

Feature	Detail
Maximum Print Resolution (Black & White)	4800 x 1200 DPI
Maximum Print Resolution (Color)	4800 x 1200 DPI
Maximum Print Speed (Color)	8.5 ppm
Max Copy Speed (Black & White)	15.5 ppm
Duplex Printing	Automatic
Scanner Type	Flatbed
Automatic Document Feeder (ADF)	30-sheet capacity
Max Input Sheet Capacity	250 sheets
Output Sheet Capacity	250 sheets
Control Method	Touch (2.4" Color Touchscreen)
Ink Type	Bottle (Epson 502 Series)
Supported Media Sizes	4 x 6, 5 x 7, 8 x 10, 8.5 x 11, 8.5 x 14, 10.5 x 7.25, 8.3 x 11.7, 3.5 x 5, 5 x 47 inches
Product Dimensions	19.9 x 16.6 x 12.5 inches (approx.)
Item Weight	20.5 pounds
Memory Storage Capacity	64 MB
Included Components	Printer, Manual, Power Cord, Ink Bottles

8. WARRANTY AND SUPPORT

8.1 Product Warranty

The Epson Workforce ST-C4100 comes with a **2-year limited warranty**. Please refer to the warranty documentation included with your product for specific terms and conditions.



Note: Warranty coverage may vary by region. Keep your purchase receipt for warranty claims.

8.2 Customer Support

For technical support, driver downloads, or additional resources, please visit the official Epson support website. You can also contact Epson customer service directly for personalized assistance.

The Epson Smart Panel® app is available for mobile devices, offering tools for setup, monitoring, printing, scanning, and ordering supplies.

Related Documents - ST-C4100

	<p>Epson L350 Series Color Inkjet Printer Service Manual</p> <p>Comprehensive service manual for Epson L350, L351, L300, L301, L355, L358, L210, L211, L110, and L111 color inkjet printers. Covers troubleshooting, disassembly, reassembly, adjustments, and maintenance procedures.</p>
	<p>Epson Color Inkjet Printer Service Manual for ET-4750 Series and others</p> <p>Comprehensive service manual for Epson ET-4750, ET-4760, L6190, ST-4000, ET-3750, ET-3760, L6170, ST-3000, ET-3700, ET-3710, L6160, ET-2750, ET-2760, L4160, ST-2000, ET-2700, L4150 series color inkjet printers, covering operation, troubleshooting, maintenance, and safety.</p>
	<p>Epson WorkForce Pro WF-7310: Quick Start and Setup Guide</p> <p>Step-by-step instructions for setting up your Epson WorkForce Pro WF-7310 printer. Learn how to unpack, install ink, load paper, install software, and utilize mobile printing features.</p>
	<div><div><p>Epson Stylus Pro WT7910 -</p><p>Epson Stylus Pro WT7910</p></div><div>Epson ClearProof</div></div>
	<p>Epson XP-2150 Series User's Guide</p> <p>Comprehensive user guide for the Epson XP-2150 Series printer, covering setup, operation, maintenance, troubleshooting, network connectivity, printing, copying, and scanning.</p>
	<p>Epson WF-C579R User's Guide</p> <p>Comprehensive user guide for the Epson WF-C579R multifunction printer, covering setup, product basics, printing, scanning, faxing, networking, troubleshooting, and technical specifications.</p>

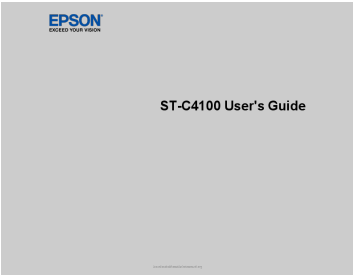

[pdf] User Manual Instructions Specifications Guide

User s Guide ST C4100 This document contains an overview of the product specifications basic and in depth usage instructions information on using options CPD 60855 R0 Epson America Workforce C4100 Manual files thelostmanual org data display embed toolleft true toolright false print zoom auto quot ||| **ST-C4100** User s Guide Downloaded from thelostmanual.org Downloaded from thelostmanual.org Contents **ST-C4100** User s Guide

..... 13

Product Basics

lang:en score:45 filesize: 1.7 M page_count: 333 document date: 2024-08-10

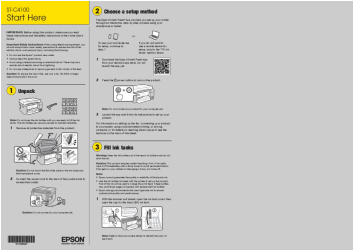

[pdf] Instructions Guide

Start Here Epson Once initial setup of the printer is complete you can top off ink tanks with any remaining See online User s Guide for instructions Caution Do cpd60852 files support epson docid cpd6 ||| **ST-C4100** Start Here IMPORTANT: Before using this product, make sure you read these instructions and the safety instructions in the online User s Guide. Important Safety Instructions: When using telephone equipment, you should always follow basic safety precautions to reduce the risk of fire, electri...

lang:en score:41 filesize: 2.47 M page_count: 4 document date: 2021-09-15

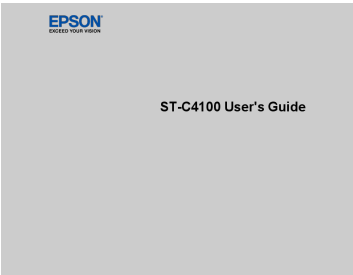

[pdf] Instructions Guide

User s Guide ST C4100 CPD 60855 R0 Epson America Follow the instructions on screen to activate your product email address Parent topic Connect Solutions for Smartphones Tablets and More Using Smart Panel Mobile App Displays additional information or such as loading paper placing a document cpd60855 files support epson docid cpd6

ST-C4100 User s Guide Contents **ST-C4100** User s Guide

..... 13

Product Basics

lang:en score:38 filesize: 3.34 M page_count: 333 document date: 2021-10-14

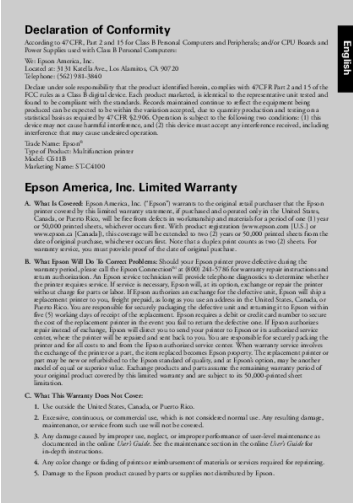

[pdf] Guide Declaration of Conformity Warranty

ST C4100 Notices Epson America Inc Any damage caused by improper use neglect or performance of user level maintenance as documented in the online User s Guide cpd60854 files support epson docid cpd6

English Declaration of Conformity According to 47CFR, Part 2 and 15 for Class B Personal Computers ... ed operation. Trade Name: Epson Type of Product: Multifunction printer Model: C611B Marketing Name: **ST-C4100** Epson America, Inc. Limited Warranty A. What Is Covered: Epson America, Inc. Epson warr...

lang:en score:37 filesize: 96.47 K page_count: 12 document date: 2021-07-27

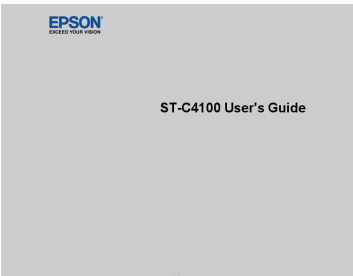

[pdf] User Manual Guide

EPSON ST C4100 01 MANUAL Manual Hub uc id 1gvM1YlafxSt2UqBJhcseNG01o0nCREnR export drive google file d preview |||

ST-C4100 User s Guide https://manual-hub.com/ https://manual-hub.com/ Contents **ST-C4100** User s Guide

..... 13

Product Basics

lang:en score:34 filesize: 4.47 M page_count: 333 document date: 2023-10-02



[\[pdf\]](#) Guide

BUSINESS PRINTING SOLUTIONS Epson Business Printing Solutions Small Workgroup Line Guide newwavetech vendor stores resource centers Product Info |||

BUSINESS PRINTING SOLUTIONS DESKTOP/SMALL WORKGROUP 2022 LINE GUIDE Printers not to scale. Shown wi ... d page complexity. For more information, visit www.epson.com/printspeed 1 Promo valid for ST-C2100, **ST-C4100**, ST-M1000, ST-M3000, ST-C8000, ST-C8090, WF-C5790 Supertank C11CG02201-LB and WF-M5799 Su...

lang:en **score:32** filesize: 6.1 M page_count: 8 document date: 2022-07-07

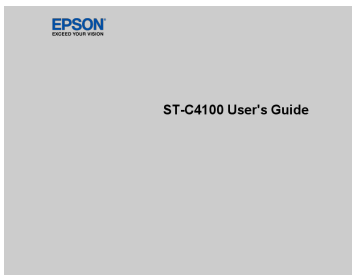

[\[pdf\]](#) Specifications Guide

User s Guide ST C4100 CPD 60855 R0 Epson America ManualEpson WorkForce Supertank Color MFP Overview Specs Details SHlcf4a954a 456c 482f 8094 69bfccdfb78cdn cs 1worldsync cf 4a cf4a954a 69bfccdfb78 |||

ST-C4100 User s Guide Contents **ST-C4100** User s Guide

..... 13

Product Basics 13

lang:en **score:31** filesize: 3.34 M page_count: 333 document date: 2021-10-14

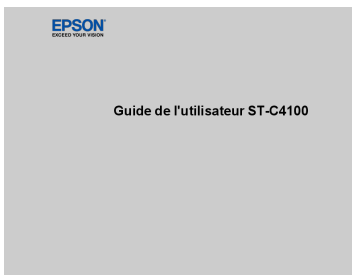

[\[pdf\]](#) Guide

Guide de l'utilisateur ST C4100 CPD 60856 R0 Epson America Epson1 Affiche état du boîtier maintenance 2 la connexion réseau 3 écran Paramètres son appareilcpd60856files support epson docid cpd6 cpd60856 |||

Guide de l'utilisateur **ST-C4100** Table des matires Guide de l'utilisateur **ST-C4100**..... 13

Notions de base concernant le produit 13

lang:fr **score:31** filesize: 4.26 M page_count: 357 document date: 2021-10-14



[\[pdf\]](#) Guide

Download 6 10 MB Epson WorkForce ST M1000 Monochrome Supertank Printer RGO Business Printing Solutions Desktop Small Workgroup 2022 Line Guide CPD 58618R3 rgo ca sites 1587 2021 12 |||

BUSINESS PRINTING SOLUTIONS DESKTOP/SMALL WORKGROUP 2022 LINE GUIDE Printers not to scale. Shown wi ... d page complexity. For more information, visit www.epson.com/printspeed 1 Promo valid for ST-C2100, **ST-C4100**, ST-M1000, ST-M3000, ST-C8000, ST-C8090, WF-C5790 Supertank C11CG02201-LB and WF-M5799 Su...

lang:en **score:30** filesize: 6.1 M page_count: 8 document date: 2022-06-24



[\[pdf\]](#) Guide Accessories

Business Printing Solutions 5 days ago — Wi Fi Direct® is a registered trademark and CERTIFIED™ of Alliance® trademarks or their respective epson 043024 bij portfolio line guide content shi cms accelerator media s |||

Business Printing Solutions 2023/2024 Line Guide Printers shown with optional accessories. The Fut ... For more information, visit www.epson.com/printspeed Limitations apply. Promo valid for ST-C2100, **ST-C4100**, ST-M1000, ST-M3000, ST-C8000, ST-C8090 and WF-M5799 Supertank C11CG04201-LB printers thr... lang:en **score:29** filesize: 7.37 M page_count: 10 document date: 2024-04-30



[\[pdf\]](#) Specifications Warranty Borchure

Fiche technique brochure en Epson WorkForce ST C4100 Supertank Color MFP C11CJ60203

Imprimantes multifonctions Inso ca 47079a1f aada 4b94 922f 8136d180c242 cdn cnetcontent 47 07 |||

Multifunction Supertank WorkForce **ST-C4100** Supertank Color MFP Print Copy Scan Fax SPECIFICATION SHEET The Supertank Color MFP with ADF, Fax and wireless. Up to 2 years of ink in the box1 -- includes enough ink to print up to 14,000 pages black/11,200 color2 Save up to 90 percent on ink -- ...

lang:en **score:28** filesize: 779.44 K page_count: 2 document date: 2021-07-20



[\[pdf\]](#) Specifications Warranty Borchure

Fiche technique brochure en Epson WorkForce ST C4100 Supertank Color MFP C11CJ60203

Imprimantes multifonctions Inso ca 9c445d68 07c9 4ab1 90e0 edf9e51e50cd cdn cnetcontent 9c 44 |||

Multifunction Supertank WorkForce **ST-C4100** Supertank Color MFP Print Copy Scan Fax SPECIFICATION SHEET The Supertank Color MFP with ADF, Fax and wireless. Up to 2 years of ink in the box1 -- includes enough ink to print up to 14,000 pages black/11,200 color2 Save up to 90 percent on ink -- ...

lang:en **score:28** filesize: 847.32 K page_count: 2 document date: 2021-08-09



[\[pdf\]](#) Specifications Warranty

WorkForce® ST C4100 WorkForce Printer Specification Sheet CPD 60926R2 impressionsolutions 2022 06 |||

Multifunction Supertank WorkForce **ST-C4100** Supertank Color MFP Print Copy Scan Fax SPECIFICATION SHEET The Supertank Color MFP with ADF, Fax and wireless.

Up to 2 years of ink in the box¹ -- includes enough ink to print up to 14,000 pages black/11,200 color² Save up to 90 percent on ink -- ...

lang:en **score:27** filesize: 848.57 K page_count: 2 document date: 2022-02-07



[\[pdf\]](#) Specifications Warranty

ViewEpson WorkForce ST C4100 Inkjet A4 4800 x 1200 DPI Wi Fimmo 96175458 1658903311 5701 16006objects icecat biz objects mmo 16006 |||

Multifunction Supertank WorkForce **ST-C4100** Supertank Color MFP Print Copy Scan Fax SPECIFICATION SHEET The Supertank Color MFP with ADF, Fax and wireless.

Up to 2 years of ink in the box¹ -- includes enough ink to print up to 14,000 pages black/11,200 color² Save up to 90 percent on ink -- ...

lang:en **score:26** filesize: 848.57 K page_count: 2 document date: 2022-02-07



[\[pdf\]](#) Specifications Datasheet Warranty Borchure

Product Data Sheet BrochureEpson WorkForce ST C4100 Supertank Color MFP Overview Specs Details SHI47079a1f aada 4b94 922f 8136d180c242cdn cs 1worldsync 47 07 47079a1f 8136d180c242 |||

Multifunction Supertank WorkForce **ST-C4100** Supertank Color MFP Print Copy Scan Fax SPECIFICATION SHEET The Supertank Color MFP with ADF, Fax and wireless.

Up to 2 years of ink in the box¹ -- includes enough ink to print up to 14,000 pages black/11,200 color² Save up to 90 percent on ink -- ...

lang:en **score:25** filesize: 779.44 K page_count: 2 document date: 2021-07-20

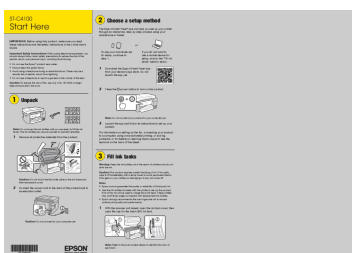

[\[pdf\]](#) Quick Start Guide Instructions Specifications Guide

Quick Start GuideEpson WorkForce ST C4100 Supertank Color MFP Overview Specs Details SHI339f490d 896f 460f 96d2 915c209e1587cdn cs 1worldsync 33 9f 339f490d 915c209e1587 |||

ST-C4100 Start Here IMPORTANT: Before using this product, make sure you read these instructions and the safety instructions in the online User s Guide. Important Safety Instructions: When using telephone equipment, you should always follow basic safety precautions to reduce the risk of fire, electri...

lang:en **score:24** filesize: 2.47 M page_count: 4 document date: 2021-09-15

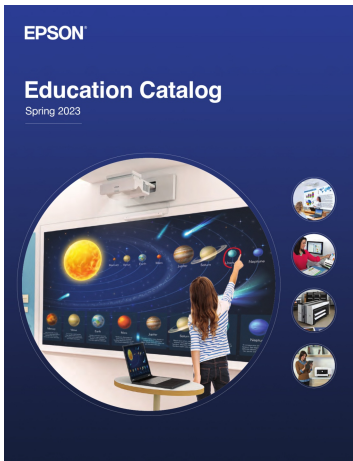

[\[pdf\]](#) User Manual Owner's Manual Catalog

Education Catalog Epson 27 juin 2023 — Check your owner s manual to determine if a wireless LAN SUPERTANK AND WORKFORCE PRINTER SERVICE PLANS WF C5790 M5799 EPPDSKC1U EPPDSKC1A EPPDSKC1R original use productpictures hybrisl d B2C assetDescr CPD 60479R4 Single Pages mediaserver goepson ImConvServlet imconv 4cceb8946d4f01c87614baec0788b8ef1164f2ba ||| Education Catalog Spring 2023 Solutions for Education Today s rapidly changing educational landsc ... ave up to 90 percent on ink with low-cost replacement ink bottles vs. ink cartridges3 ST-C2100 and **ST-C4100** only . They re the ideal choice for high-volume, high-quality, hassle-free printing. MODEL... lang:en score:22 filesize: 5.52 M page_count: 52 document date: 2023-06-20



[\[pdf\]](#) Specifications Warranty

EPSON WORKFORCE ST 4100 ECO TANK INKJET COLOR MFP COPY PRINT SCAN FAX WorkForce C4100 Printer Specification Sheet CPD 61821 nuworldinc assets images Epson workforce ||| Multifunction Supertank WorkForce **ST-C4100** Supertank Color MFP Print Copy Scan Fax SPECIFICATION SHEET The Supertank Color MFP with ADF, Fax and wireless. Up to 2 years of ink in the box1 -- includes enough ink to print up to 14,000 pages black/11,200 color2 Save up to 90 percent on ink -- ... lang:en score:21 filesize: 1.1 M page_count: 2 document date: 2021-10-29



[\[pdf\]](#)

PowerPoint Presentation Haol Yao Daily Hot Deals on Technology Products howardcomputers Epson Howard BIJ promo media howard docs ||| Goodbye toner. Hello 2 years of ink. Epson Supertank printers come with up to two years of ink guaranteed1--and if you run out in those two years, we ve got you covered2 WorkForce ST-C2100 Supertank A4 Color MFP WorkForce **ST-C4100** Supertank A4 Color MFP WorkForce ST-C5000 Supertank A4 Color MFP ... lang:en score:20 filesize: 459.09 K page_count: 1 document date: 2024-01-05

Epson® Inkjet
A Solution That Delivers

Epson's line of exceptional office printers powered by PrecisionCore® Heat-Free Inkjet Technology is designed to get the most standard for productivity and the environmental benefit of low energy consumption backed by a 2-year limited warranty.

Model	Price	Features
WorkForce® EC-C110 Essential Color MFP	\$259 \$239	Light and portable Color copies Optional external display Large
WorkForce® Pro WF-C410 A4 Color Printer	\$199 \$179	Light and portable Color copies Optional external display Large
WorkForce® Pro WF-C410 A4 Color Printer	\$199 \$179	Light and portable Color copies Optional external display Large
WorkForce® ST-C2100 Supertank A4 Color MFP	\$279 \$249	Light and portable Color copies Optional external display Large
WorkForce® Pro ST-C4100 Supertank A4 Color MFP	\$449 \$399	Light and portable Color copies Optional external display Large
WorkForce® ST-M1000 A4 Monochrome Printer	\$289 \$259	Light and portable Color copies Optional external display Large

Contact your Authorized Dealer:

Dealer Name
Dealer Telephone Number
Dealer Email Address

Epson America, Inc.
2711 Avenida Encinas, Suite 100
Foster City, CA 94404

[pdf] Flyer Warranty

Raven Creative Epson US Instant Rebate Flyer 1 fe5e0932bbdbbee188a67

ade54de1bba9a4fe61c120942a09245b ssl cf1 rackcdn |||

z Epson s line of exceptional office printers powered by PrecisionCore Heat-Free Technology is desi ... J05205 H05igh-quality and fast Auto 2-sided printing Built-in copy, scan, and fax WorkForce Pro **ST-C4100** Supertank A4 Color MFP 50* INSTANT REBATE 449 MAP 399 C11CJ60203 Powerful printer Fa...

lang:en score:20 filesize: 486.37 K page_count: 1 document date: 2023-03-24

Two Years of Ink Guarantee Claim Form **EPSON**
RECEIVE YOUR INK

Limitations apply. For details on this offer, please visit www.epson.com/2yearguarantee

STEP 1: PURCHASE AND REGISTER YOUR PRINTER:

Purchase one of the qualifying WorkForce® printers listed below between April 1, 2023 and March 31, 2024. Register your printer as instructed on the registration documentation provided in the printer box or at www.epson.com. Printer must be registered within 30 days of purchase.

Qualifying Printers:

WorkForce ST-C2100 (C11CG8020)	WorkForce ST-C4100 (C11CG8020)
WorkForce ST-C4100 (C11CG8020)	WorkForce ST-M1000 (C11CG9320)
WorkForce ST-M1000 (C11CG9320)	WorkForce ST-M3000 (C11CG9320)
WorkForce ST-M3000 (C11CG9320)	WorkForce Pro WF-M5799 Supertank (C11CG94201-LB)

STEP 2: PURCHASE YOUR INK:

Purchase qualifying ink(s) no later than two years after printer purchase date.

WorkForce ST-C2100, ST-C4100 Qualifying Ink:
T520120-S, T520220-S, T520320-S, T520420-S

- Receive a rebate of up to \$28.88 per ink bottle for the T520120-S and \$18.88 for the T520220-S, T520320-S, T520420-S.

WorkForce ST-M1000, ST-M3000 Qualifying Ink:
T520120-S

- Receive a rebate of up to \$24.79 per ink bottle.

WorkForce ST-C8000, ST-C8000 Qualifying Ink:
T542120-S, T542220-S, T542320-S or T542420-S

- Receive a rebate of up to \$41.99 per ink bottle for the T542120-S and \$31.99 for the T542220-S, T542320-S, T542420-S.

WorkForce Pro WF-M5799 Supertank Qualifying Ink:
M57120, M572120

- Receive a rebate of up to \$158.29 per ink pack for the M57120 and \$302.89 for the M572120.

[pdf] Documentation

2 Years of Printing Guarantee EA1139 Combo Coupon CPD 59114 P3 Ink Rebate Form Estore Center

Epson Canada original assetDescr 12483 23 97201 EN mediaserver goepson ImConvServlet imconv fc2f8eb3183a8282643a9feec3deddfa0c412991 |||

Two Years of Ink Guarantee Claim Form Limitations apply. For details on this offer, please visit www.epson.com/2yearguarantee gistered within 30 days of purchase. Qualifying Printers: WorkForce ST-C2100 C11CJ63203 WorkForce **ST-C4100** C11CJ60203 WorkForce ST-M1000 C11CG94201 WorkForce ST-M3000 C11CG93201 WorkForce ST-C... lang:en score:20 filesize: 2.02 M page_count: 2 document date: 2023-03-31

Two Years of Ink Guarantee Claim Form **EPSON**
RECEIVE YOUR INK

Limitations apply. For details on this offer, please visit www.epson.com/2yearguarantee

Online Rebate Submission: You have the option to submit the rebate form online. For details, please visit www.epson.com/promotions and click "The submit Rebate" under "Rebate Resources."

STEP 1: PURCHASE AND REGISTER YOUR PRINTER:

Purchase one of the qualifying WorkForce® printers listed below between April 1, 2019 and March 31, 2023. Register your printer as instructed on the registration documentation provided in the printer box or at www.epson.com. Printer must be registered within 30 days of purchase.

Qualifying Printers:

WorkForce ST-2000 (C11CG2202)	WorkForce ST-4000 (C11CG2202)
WorkForce ST-3000 (C11CG2202)	WorkForce ST-C8000 (C11CG17102)
WorkForce ST-4000 (C11CG2202)	WorkForce ST-C8000 (C11CG17102)
WorkForce ST-C2100 (C11CG8020)	WorkForce Pro WF-C5790 Supertank (C11CG92001-LB)
WorkForce ST-C4100 (C11CG8020)	WorkForce Pro WF-M5799 Supertank (C11CG94201-LB)
WorkForce ST-M1000 (C11CG9320)	

STEP 2: PURCHASE YOUR INK:

Purchase qualifying ink(s) no later than two years after printer purchase date.

WorkForce ST-2000, ST-3000, ST-4000, ST-C2100, ST-C4100 Qualifying Ink:
T502120-S, T502220-S, T502320-S, T502420-S

- Receive a rebate of up to \$18.88 per ink bottle for the T502120-S and \$12.88 for the T502220-S, T502320-S, T502420-S.

WorkForce ST-M1000, ST-M3000 Qualifying Ink:
T520120-S

- Receive a rebate of up to \$17.99 per ink bottle.

WorkForce ST-C8000, ST-C8000 Qualifying Ink:
T542120-S, T542220-S, T542320-S or T542420-S

- Receive a rebate of up to \$29.89 per ink bottle for the T542120-S and \$21.89 for the T542220-S, T542320-S, T542420-S.

WorkForce Pro WF-C5790 Supertank Qualifying Ink:
T502120, T5022120, T502320, T502420, T502520, T502620, T502720, T502820, T502920, T503020, T503120, T503220, T503320, T503420, T503520, T503620, T503720, T503820, T503920, T504020, T504120, T504220, T504320, T504420, T504520, T504620, T504720, T504820, T504920, T505020, T505120, T505220, T505320, T505420, T505520, T505620, T505720, T505820, T505920, T506020, T506120, T506220, T506320, T506420, T506520, T506620, T506720, T506820, T506920, T507020, T507120, T507220, T507320, T507420, T507520, T507620, T507720, T507820, T507920, T508020, T508120, T508220, T508320, T508420, T508520, T508620, T508720, T508820, T508920, T509020, T509120, T509220, T509320, T509420, T509520, T509620, T509720, T509820, T509920, T510020, T510120, T510220, T510320, T510420, T510520, T510620, T510720, T510820, T510920, T511020, T511120, T511220, T511320, T511420, T511520, T511620, T511720, T511820, T511920, T512020, T512120, T512220, T512320, T512420, T512520, T512620, T512720, T512820, T512920, T513020, T513120, T513220, T513320, T513420, T513520, T513620, T513720, T513820, T513920, T514020, T514120, T514220, T514320, T514420, T514520, T514620, T514720, T514820, T514920, T515020, T515120, T515220, T515320, T515420, T515520, T515620, T515720, T515820, T515920, T516020, T516120, T516220, T516320, T516420, T516520, T516620, T516720, T516820, T516920, T517020, T517120, T517220, T517320, T517420, T517520, T517620, T517720, T517820, T517920, T518020, T518120, T518220, T518320, T518420, T518520, T518620, T518720, T518820, T518920, T519020, T519120, T519220, T519320, T519420, T519520, T519620, T519720, T519820, T519920, T520020, T520120, T520220, T520320, T520420, T520520, T520620, T520720, T520820, T520920, T521020, T521120, T521220, T521320, T521420, T521520, T521620, T521720, T521820, T521920, T522020, T522120, T522220, T522320, T522420, T522520, T522620, T522720, T522820, T522920, T523020, T523120, T523220, T523320, T523420, T523520, T523620, T523720, T523820, T523920, T524020, T524120, T524220, T524320, T524420, T524520, T524620, T524720, T524820, T524920, T525020, T525120, T525220, T525320, T525420, T525520, T525620, T525720, T525820, T525920, T526020, T526120, T526220, T526320, T526420, T526520, T526620, T526720, T526820, T526920, T527020, T527120, T527220, T527320, T527420, T527520, T527620, T527720, T527820, T527920, T528020, T528120, T528220, T528320, T528420, T528520, T528620, T528720, T528820, T528920, T529020, T529120, T529220, T529320, T529420, T529520, T529620, T529720, T529820, T529920, T530020, T530120, T530220, T530320, T530420, T530520, T530620, T530720, T530820, T530920, T531020, T531120, T531220, T531320, T531420, T531520, T531620, T531720, T531820, T531920, T532020, T532120, T532220, T532320, T532420, T532520, T532620, T532720, T532820, T532920, T533020, T533120, T533220, T533320, T533420, T533520, T533620, T533720, T533820, T533920, T534020, T534120, T534220, T534320, T534420, T534520, T534620, T534720, T534820, T534920, T535020, T535120, T535220, T535320, T535420, T535520, T535620, T535720, T535820, T535920, T536020, T536120, T536220, T536320, T536420, T536520, T536620, T536720, T536820, T536920, T537020, T537120, T537220, T537320, T537420, T537520, T537620, T537720, T537820, T537920, T538020, T538120, T538220, T538320, T538420, T538520, T538620, T538720, T538820, T538920, T539020, T539120, T539220, T539320, T539420, T539520, T539620, T539720, T539820, T539920, T540020, T540120, T540220, T540320, T540420, T540520, T540620, T540720, T540820, T540920, T541020, T541120, T541220, T541320, T541420, T541520, T541620, T541720, T541820, T541920, T542020, T542120, T542220, T542320, T542420, T542520, T542620, T542720, T542820, T542920, T543020, T543120, T543220, T543320, T543420, T543520, T543620, T543720, T543820, T543920, T544020, T544120, T544220, T544320, T544420, T544520, T544620, T544720, T544820, T544920, T545020, T545120, T545220, T545320, T545420, T545520, T545620, T545720, T545820, T545920, T546020, T546120, T546220, T546320, T546420, T546520, T546620, T546720, T546820, T546920, T547020, T547120, T547220, T547320, T547420, T547520, T547620, T547720, T547820, T547920, T548020, T548120, T548220, T548320, T548420, T548520, T548620, T548720, T548820, T548920, T549020, T549120, T549220, T549320, T549420, T549520, T549620, T549720, T549820, T549920, T550020, T550120, T550220, T550320, T550420, T550520, T550620, T550720, T550820, T550920, T551020, T551120, T551220, T551320, T551420, T551520, T551620, T551720, T551820, T551920, T552020, T552120, T552220, T552320, T552420, T552520, T552620, T552720, T552820, T552920, T553020, T553120, T553220, T553320, T553420, T553520, T553620, T553720, T553820, T553920, T554020, T554120, T554220, T554320, T554420, T554520, T554620, T554720, T554820, T554920, T555020, T555120, T555220, T555320, T555420, T555520, T555620, T555720, T555820, T555920, T556020, T556120, T556220, T556320, T556420, T556520, T556620, T556720, T556820, T556920, T557020, T557120, T557220, T557320, T557420, T557520, T557620, T557720, T557820, T557920, T558020, T558120, T558220, T558320, T558420, T558520, T558620, T558720, T558820, T558920, T559020, T559120, T559220, T559320, T559420, T559520, T559620, T559720, T559820, T559920, T560020, T560120, T560220, T560320, T560420, T560520, T560620, T560720, T560820, T560920, T561020, T561120, T561220, T561320, T561420, T561520, T561620, T561720, T561820, T561920, T562020, T562120, T562220, T562320, T562420, T562520, T562620, T562720, T562820, T562920, T563020, T563120, T563220, T563320, T563420, T563520, T563620, T563720, T563820, T563920, T564020, T564120, T564220, T564320, T564420, T564520, T564620, T564720, T564820, T564920, T565020, T565120, T565220, T565320, T565420, T565520, T565620, T565720, T565820, T565920, T566020, T566120, T566220, T566320, T566420, T566520, T566620, T566720, T566820, T566920, T567020, T567120, T567220, T567320, T567420, T567520, T567620, T567720, T567820, T567920, T568020, T568120, T568220, T568320, T568420, T568520, T568620, T568720, T568820, T568920, T569020, T569120, T569220, T569320, T569420, T569520, T569620, T569720, T569820, T569920, T570020, T570120, T570220, T570320, T570420, T570520, T570620, T570720, T570820, T570920, T571020, T571120, T571220, T571320, T571420, T571520, T571620, T571720, T571820, T571920, T572020, T572120, T572220, T572320, T572420, T572520, T572620, T572720, T572820, T572920, T573020, T573120, T573220, T573320, T573420, T573520, T573620, T573720, T573820, T573920, T574020, T574120, T574220, T574320, T574420, T574520, T574620, T574720, T574820, T574920, T575020, T575120, T575220, T575320, T575420, T575520, T575620, T575720, T575820, T575920, T576020, T576120, T576220, T576320, T576420, T576520, T576620, T576720, T576820, T576920, T577020, T577120, T577220, T577320, T577420, T577520, T577620, T577720, T577820, T577920, T578020, T578120, T578220, T578320, T578420, T578520, T578620, T578720, T578820, T578920, T579020, T579120, T579220, T579320, T579420, T579520, T579620, T579720, T579820, T579920, T580020, T580120, T580220, T580320, T580420, T580520, T580620, T580720, T580820, T580920, T581020, T581120, T581220, T581320, T581420, T581520, T581620, T581720, T581820, T581920, T582020, T582120, T582220, T582320, T582420, T582520, T582620, T582720, T582820, T582920, T583020, T583120, T583220, T583320, T583420, T583520, T583620, T583720, T583820, T583920, T584020, T584120, T584220, T584320, T584420, T584520, T584620, T584720, T584820, T584920, T585020, T585120, T585220, T585320, T585420, T585520, T585620, T585720, T585820, T585920, T586020, T586120, T586220, T586320, T586420, T586520, T586620, T586720, T586820, T586920, T587020, T587120, T587220, T587320, T587420, T587520, T587620, T587720, T587820, T587920, T588020, T588120, T588220, T588320, T588420, T588520, T588620, T588720, T588820, T588920, T589020, T589120, T589220, T589320, T589420, T589520, T589620, T589720, T589820, T589920, T590020, T590120, T590220, T590320, T590420, T590520, T590620, T590720, T590820, T590920, T591020, T591120, T591220, T591320, T591420, T591520, T591620, T591720, T591820, T591920, T592020, T592120, T592220, T592320, T592420, T592520, T592620, T592720, T592820, T592920, T593020, T593120, T593220, T593320, T593420, T593520, T593620, T593720, T593820, T593920, T594020, T594120, T594220, T594320, T594420, T594520, T594620, T594720, T594820, T594920, T595020, T595120, T595220, T595320, T595420, T595520, T595620, T595720, T595820, T595920, T596020, T596120, T596220, T596320, T596420, T596520, T596620, T596720, T596820, T596920, T597020, T597120, T597220, T597320, T597420, T597520, T597620, T597720, T597820, T597920, T598020, T598120, T598220, T598320, T598420, T598520, T598620, T598720, T598820, T598920, T599020, T599120, T599220, T599320, T599420, T599520, T599620, T599720, T599820, T599920, T600020, T600120, T600220, T600320, T600420, T600520, T600620, T600720, T600820, T600920, T601020, T601120, T601220, T601320, T601420, T601520, T601620, T601720, T601820, T601920, T602020, T602120, T602220, T602320, T602420, T602520, T602620, T602720, T602820, T602920, T603020, T603120, T603220, T603320, T603420, T603520, T603620, T603720, T603820, T603920, T604020, T604120, T604220, T604320, T604420, T604520, T604620, T604720, T604820, T604920, T605020, T605120, T605220, T605320, T605420, T605520, T605620, T605720, T605820, T605920, T606020, T606120, T606220, T606320, T606420, T606520, T606620, T606720, T606820, T606920, T607020, T607120, T607220, T607320, T607420, T607520, T607620, T607720, T607820, T607920, T608020, T608120, T608220, T608320, T608420, T608520, T608620, T608720, T608820, T608920, T609020, T609120, T609220, T609320, T609420, T609520, T609620, T609720, T609820, T609920, T610020, T610120, T610220, T610320, T610420, T610520, T610620, T610720, T610820, T610920, T611020, T611120, T611220, T611320, T611420, T611520, T611620, T611720, T611820, T611920, T612020, T612120, T612220, T612320, T612420, T612520, T612620, T612720, T612820, T612920, T613020, T613120, T613220, T613320, T613420, T613520, T613620, T613720, T613820, T613920, T614020, T614120, T614220, T614320, T614420, T614520, T614620, T614720, T614820, T614920, T615020, T615120, T615220, T615320, T615420, T615520, T615620, T615720, T615820, T615920, T616020, T616120, T616220, T616320, T616420, T616520, T616620, T

With so many options and features, choosing the right business printer can be tricky. **Here are four questions to help guide you in finding the printer that's best for your business.**

With so many options and features, choosing the right business printer can be tricky. **Here are four questions to help guide you in finding the printer that's best for your business.**

1



How to decide: Think about both convenience and volume of printing. Epson Supertank printers support high productivity and high capacity ink tanks so you can keep printing without worrying about running out of ink.

2



How to decide: If you print text documents often, such as reports and contracts, you might opt for a monochrome printer. On the other hand, if you print graphics, photos, presentations, and marketing materials, you'll need a color printer.

3



How to decide: If you need the printer for simple print jobs, a single-function printer will likely be sufficient. For high-volume printing, digitizing, and sharing documents outside of the company, a multifunction printer may give you the flexibility you need.

4



How to decide: Consider the size of your usual printing jobs as well as what future needs you might have and the types of materials you can create and print on your own.

EPSON®

^a Based on average weekly discount point volumes of about 100 pages.

How to Choose the Best Printer for Your Workspace, Classroom, and Beyond With so many options and fe ... www.epson.com/inkinfo 3 Limitations apply. Promo valid for two years from purchase date on ST-C2100, **ST-C4100**, ST-M1000, ST-M3000, ST-C5000, ST-C5500, ST-C8000, ST-C8090 and WF-M5799 Supertank C11CG04... lang:en score:19 filesize: 140.07 K page_count: 1 document date: 2024-04-17



[pdf] Flyer

Running low on ink We ve got you covered Epson® Genuine Inks—available now! epson bij desktop print flyer connection media aekbuv2a |||

Stock up on ink now Running low on ink We ve got you covered. Epson Genuine Inks- -available now ... 90 DURABrite Pro Ink Cartridges 912 502 532 WorkForce Pro WF-C8190 WF-C8690 WorkForce ST-C2100 **ST-C4100** WorkForce ST-M1000 ST-M3000 DURABrite Pro Ink Cartridges Claria ET Standard Ink Bottles...

lang:en score:19 filesize: 544.53 K page_count: 2 document date: 2023-07-25

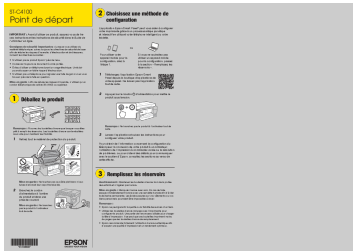

[pdf] Instructions Guide

Point de départ cpd60853 files support epson docid cpd6 |||

ST-C4100 Point de dpart IMPORTANT : Avant d utiliser ce produit, assurez-vous de lire ces instructions et les instructions de scurit dans le Guide de l utilisateur en ligne. Consignes de scurit importantes : Lorsque vous utilisez du matriel tlphonique, suivez toujours les directives de scurit de bas...

lang:fr score:18 filesize: 2.47 M page_count: 4 document date: 2021-10-14

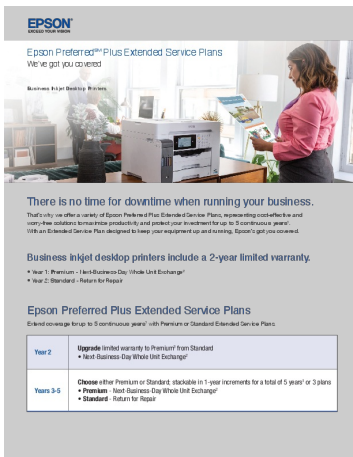

[pdf] Flyer Warranty

Business Desktop Printers Extended Service Plans Epson US original assetDescr BIJ Warranty Flyer CPD 61521R2 Final mediaserver goepson ImConvServlet imconv

f3028519f7a32e59fd27d117d9d8b909dfda2e86 ||| ||| Epson PreferredSM Plus Extended Service Plans

We ve got you covered Business Inkjet Desktop Printers There is no time for downtime when running your business. That s why we offer a

Epson PreferredSM Plus Extended Service Plans We ve got you covered Business Inkjet Desktop Printers ... 40, WF-C4810, ST-M1000, ST-2000, ST-C2100, ST-3000, ST-M3000, WF-C5290, WF-C5790, WF-M5799 ST-4000, **ST-C4100**, WF-6590, WF-6090 WF-M5799 Supertank, WF-C5790 Supertank EPPDSKB1U EPPDSKC1U EPPDSKD1U EPP...

lang:en score:18 filesize: 638.83 K page_count: 2 document date: 2022-09-29



[pdf] Flyer

Choose the Right InkSmall Business Printers Connectionv1connection media aekbuv2a epson bij desktop print ink flyer la en |||

Stock up on ink now Running low on ink We ve got you covered. Epson Genuine Inks- -available no ... 90 DURABrite Pro Ink Cartridges 912 502 532 WorkForce Pro WF-C8190 WF-C8690 WorkForce ST-C2100 **ST-C4100** WorkForce ST-M1000 ST-M3000 DURABrite Pro Ink Cartridges Claria ET Standard Ink Bottles...

lang:en score:18 filesize: 544.53 K page_count: 2 document date: 2023-07-25

Rebate **EPSON®**

Purchase ten (10) of the same qualifying Epson Business Supertank printers between October 1, 2023, and March 31, 2024 and receive one (1) more of the same printer purchased, by mail*.

Get ONE (1) MORE of the same printer purchased, by mail*

Submit your rebate form online! It's fast and easy. Visit www.epsonrebates.com to get started.

For each claim submission, the TEN (10) printers purchased must be the same model. Additional printer sent by mail will be the same model purchased. Qualifying products must be purchased between 10/1/2023 and 3/31/2024. Claims must be postmarked within 30 days from the date of purchase. *Please allow up to 10 weeks for program fulfillment.

There is a maximum of one (1) claim per address and/or customer within a 12-month period, with the exception of authorized approved bids. For complete offer terms, please read all pages of this rebate form coupon.

See page 9 for rebate terms and conditions. Page 1 of 2

[pdf]

Get ONE 1 MORE Epson For each claim submission the TEN 10 printers purchased must be same model Additional printer sent by mail will original assetDescr WorkForce Series Printer Buy 23 17703 Coupon CPD 58428R4 Final mediaserver goepson ImConvServlet imconv

d8e24c288cea43845a9b1e284e69890650059797 |||

Rebate Purchase ten 10 of the same qualifying Epson Business Supertank printers between October 1, ... I Number s Qty. Purchased WorkForce ST-C2100 C11CJ63203 WorkForce ST-C5500 C11CJ28202 WorkForce **ST-C4100** C11CJ60203 WorkForce ST-M1000 C11CG94201 WorkForce ST-C5000 C11CJ29203 WorkForce ST-M300...

lang:en score:17 filesize: 226.86 K page_count: 3 document date: 2023-09-21

EPSON®

Epson Solutions Suite — Streamlined configuration and management for your printer fleet

Epson business printers offer a full suite of advanced solutions designed to help businesses easily manage the installation, configuration and operation of their print environment. With workflow administration, fleet management, remote services and third-party integration, Epson Solutions Suite has you covered.

Epson Device Admin
A powerful device management solution, Epson Device Admin was designed to simplify the installation, configuration and management of networked Epson printers with instant notifications and usage reporting.

Epson Print Admin
A cost-effective administration tool, Epson Print Admin helps customers increase productivity and reduce print costs and improve productivity with its user-friendly software integration. Also available on select models as an embedded solution with **Epson Print Admin Services**.

Epson Remote Services
A cloud-based remote fleet management tool, Epson Remote Services (ERS) was built to help partners remotely diagnose customer service issues, perform service operations, generate alerts and usage reports via email for registered users, and receive all from the convenience of the cloud.

Epson Open Platform
For use to select Epson multifunction printers, Epson Open Platform allows users to gain control of their printing operations by interacting with embedded software from a variety of third-party independent software vendors (ISVs). Select Epson single-function printers also support Open Platform integration and compatibility but do not have third-party integration.

[pdf] Flyer

Streamlined configuration and management for your printer fleet 1 For models WF M5399 C5390 EP C7000 jobs will print automatically after authentication No option to select individual job printing 2

Available original assetDescr BLJ Epson Solutions Suite Flyer CPD 60370R10 mediaserver goepson ImConvServlet imconv 262528fbc2a0419ba982f80055dfabec0e69996 |||

Epson Solutions Suite -- Streamlined configuration and management for your printer fleet Epson busin ... M5899, WF-C5390, WF-M5399 WF-C4810, WF-C4310 EC-C7000 EC-C110 ST-C8090 ST-C8000 ST-C5500, ST-C5000, **ST-C4100**, ST-C2100, ST-M3000, ST-M1000 Model Name s Model Type A3 Epson Device Admin Yes Batc...

lang:en score:17 filesize: 895.79 K page_count: 2 document date: 2025-03-25

[pdf] Accessories

E SBS Schematic Alt LEARN MORE Office Printers Business Copiers Scanners Epson Canada original assetDescr Small Solutions R1 mediaserver goepson ImConvServlet imconv

4badbb6c440c1d17c31791125c82bb418db661d8 |||

Small Business Solutions Bring impact to your small business with Epson printers. An ideal choice fo ...

clrlptaicoshitynhpee,giedanbrnygitenodiesouotisunu.firtsrneedglvrietyS. MANAGER S OFFICE WorkForce **ST-C4100** Multifunction Print, Copy, Scan, Fax A4 Letter/Legal 15/8 ISO ppm black/color Epson...

lang:en score:17 filesize: 2.19 M page_count: 1 document date: 2024-12-06

Small Business Solutions **EPSON**

Discover the power of Epson's Small Business Solutions. From office printers to multifunction copiers, Epson's Small Business Solutions offer a wide range of products designed to meet the needs of small businesses. With a focus on reliability, performance, and ease of use, Epson's Small Business Solutions are the ideal choice for your business.

SMALL BUSINESS SOLUTIONS

WORKFORCE SERIES
A powerful device management solution, Epson Device Admin was designed to simplify the installation, configuration and management of networked Epson printers with instant notifications and usage reporting.

EPSON OPEN PLATFORM
For use to select Epson multifunction printers, Epson Open Platform allows users to gain control of their printing operations by interacting with embedded software from a variety of third-party independent software vendors (ISVs). Select Epson single-function printers also support Open Platform integration and compatibility but do not have third-party integration.

EPSON® EXCEED YOUR VISION

2022 EDUCATION CATALOG

[pdf] Catalog

Education Catalog ► Projectors Printers Scanners K12 and Higher Epson US original use productpictures assetDescr 2022 CPD 60479R3 mediaserver goepson ImConvServlet imconv

f69c9123683bfc115d8f9ff0d1f0be7e3c09b4bb |||

2022 EDUCATION CATALOG Solutions for Education Today s rapidly changing educational landscape dem ... ve up to 90 percent on ink with lowcost replacement ink bottles vs. ink cartridges*** ST-C2100 and **ST-C4100** only . It s the smart choice for high-volume, high-quality, hassle-free printing. MODEL Pr...

lang:en score:17 filesize: 26.7 M page_count: 48 document date: 2022-06-10

