

Manuals+

[Q & A](#) | [Deep Search](#) | [Upload](#)

[manuals.plus](#) /

› [TEEHO](#) /

› [TEEHO TE001 Keyless Entry Door Lock Instruction Manual](#)

TEEHO TE001

TEEHO TE001 Keyless Entry Door Lock Instruction Manual

Model: TE001 | Brand: TEEHO

INTRODUCTION

This manual provides detailed instructions for the installation, operation, maintenance, and troubleshooting of your TEEHO TE001 Keyless Entry Door Lock. Please read this manual thoroughly before installation and use to ensure proper function and longevity of your lock.





Front view of the TEEHO TE001 Keyless Entry Door Lock.

SETUP AND INSTALLATION

The TEEHO TE001 Keyless Entry Door Lock is designed for easy installation, typically requiring only a screwdriver. Follow the steps below for a successful setup.

Door Compatibility

- **Door Hole Diameter:** Only suitable for 2-1/8" (54mm) door holes. Not compatible with 38mm door holes.
- **Door Thickness:** Compatible with doors ranging from 1-3/8" to 2" (35mm to 50mm) thick.
- **Backset:** Supports 2-3/8" or 2-3/4" (60mm or 70mm) backsets.

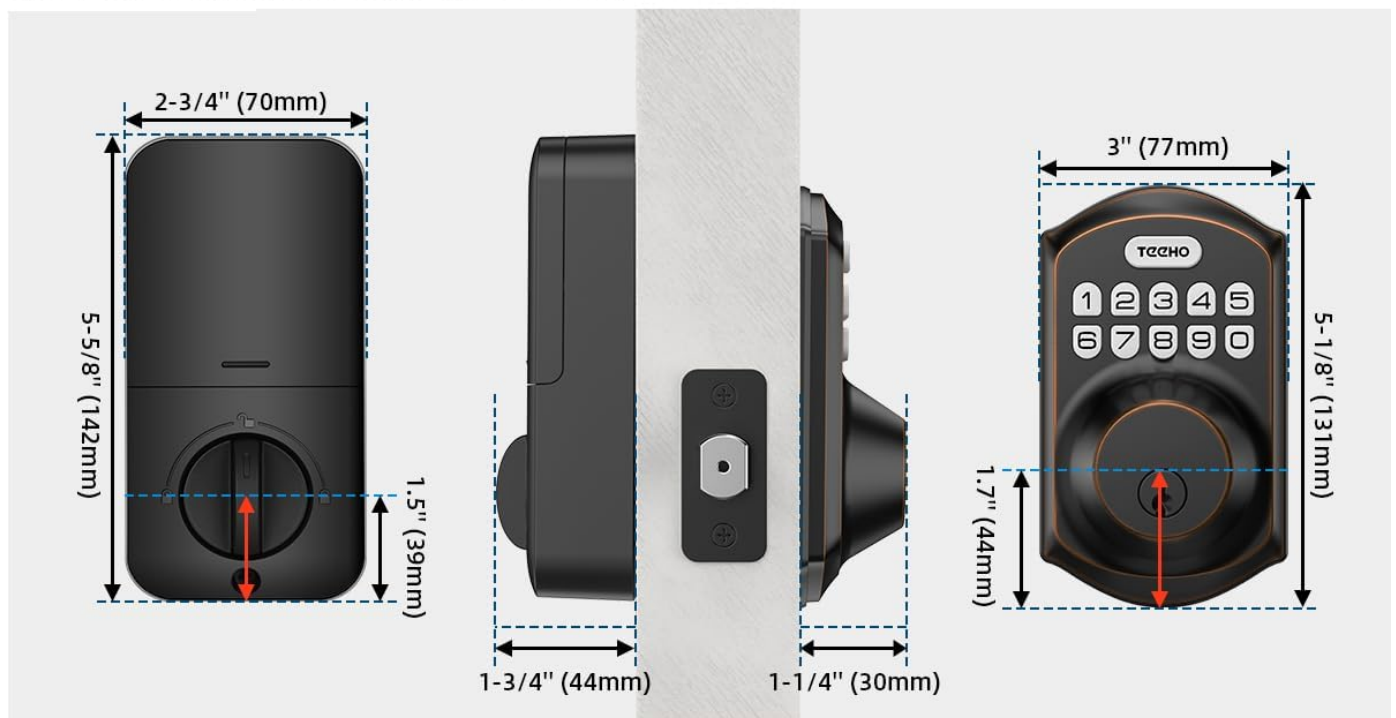
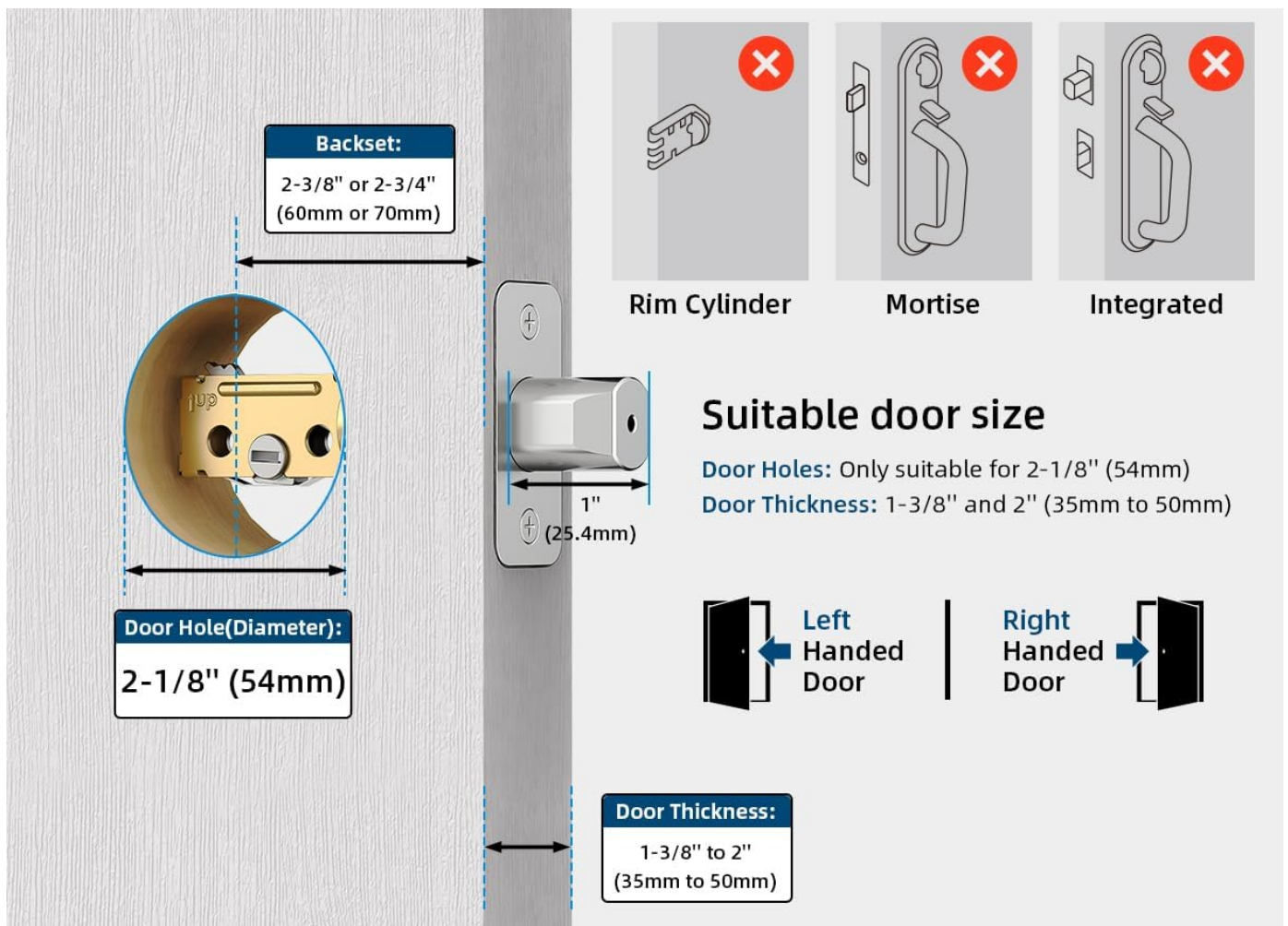

Diagram illustrating suitable door dimensions and lock types.

Installation Steps

1. Ensure your door meets the compatibility requirements.
2. Install the latch into the door edge.
3. Mount the exterior keypad assembly, ensuring the cable passes through the door hole.
4. Install the interior mounting plate.

5. Connect the cable from the exterior assembly to the interior assembly.
6. Secure the interior assembly to the mounting plate.
7. Insert 4 AA alkaline batteries (not included) into the battery compartment.
8. Perform the door handing process as per the detailed programming instructions to calibrate the lock.

For a visual guide, please refer to the official programming video below or the detailed Installation Manual (PDF) provided with your product.

OPERATING INSTRUCTIONS

The TEEHO TE001 offers multiple convenient and secure ways to operate your door lock.

User Codes

The lock supports up to 20 individual user codes for family members or regular access. Each user can customize their own unlock method.

Up to 20 PIN Codes



Up to 20 different PIN Codes allow different family members to customize their own unlock method.

The lock supports up to 20 unique PIN codes for various users.

One-Time PIN Code

For temporary access, a one-time PIN code can be generated. This code will automatically be deleted after a single use, providing secure, limited access for guests or service personnel.

One-Time PIN Code



The Entry Code is '**135192**'

Okay, I'm in.
Thanks



A one-time PIN code can be provided for single-use entry.

Automatic Locking and One-Touch Locking

- **Automatic Lock:** The lock can be set to automatically lock within 10-99 seconds after the door is closed.
- **One-Touch Auto-Lock:** To quickly lock the door from the outside, simply press and hold any key on the keypad for 2 seconds.

Auto lock & one-touch locking



Auto

Press and hold any key for 2 seconds to lock. Automatically locked 10-99 seconds after closing the door.

The lock features automatic locking and one-touch locking for convenience.

Anti-Peeping Password

To enhance security and prevent others from guessing your code, you can enter random digits before or after your actual PIN code. The lock will still recognize the correct sequence within the longer string of numbers.

Anti Peeping PIN Code

Enter Random Digits to Avoid Snooping



135 +
Random Digits

1259
PIN Code

+ 246
Random Digits

Utilize the anti-peeping feature by entering random digits before or after your actual code.

Mute Mode

The lock features a mute mode for silent operation, which can be useful during quiet hours or to avoid disturbing others.

Programming Video

Watch this official video for detailed instructions on programming your TE001 Keypad Door Lock.

MAINTENANCE

Proper maintenance ensures the longevity and optimal performance of your TEEHO TE001 lock.

Battery Replacement

- The lock features a low battery indicator to alert you when batteries need replacement.
- Requires 4 AA alkaline batteries (not included). Replace all four batteries simultaneously for best performance.
- Expected battery life is up to 1 year, depending on usage.

Cleaning

Clean the keypad and exterior surface with a soft, damp cloth. Avoid using abrasive cleaners or solvents, as these can damage the finish and electronic components.

Weather Resistance

The lock has an IP54 weather resistance rating, providing protection against dust and splashing water. While durable, avoid direct exposure to heavy rain or prolonged submersion.

TROUBLESHOOTING

If you encounter issues with your TEEHO TE001 lock, consider the following common solutions:

- **Lock Not Responding:** Check the batteries. If the low battery indicator is on or the lock is unresponsive, replace all 4 AA batteries.
- **Code Not Working:** Ensure you are entering the correct master code or user code. Try re-programming the code following the instructions in the Operating section or the programming video.
- **Auto-Lock Malfunction:** Verify that the door is properly aligned and closes completely. Obstructions or misalignment can prevent the deadbolt from extending fully.
- **Keypad Unresponsive:** Ensure the keypad is clean and free from debris. If issues persist, a factory reset may be necessary (refer to the full user guide for instructions).

For more complex issues, please contact TEEHO customer service.

SPECIFICATIONS

Feature	Description
Brand	TEEHO
Model Name	TE001
Lock Type	Keypad Deadbolt Door Lock
Material	Aluminum
Color	Oil Rubbed Bronze

Item Dimensions (L x W x H)	5.12 x 2.95 x 1.3 inches
Item Weight	1.76 Pounds
Power Source	4 AA Batteries (not included)
Special Features	Battery Indicator, Back-Lit Keypad, 20 Individual User Codes, One-time Access, Auto Lock, One-touch Lock, Anti-peeping Password, Vacation Mode, Mute Mode, Wrong Entry Limit, IP54 Waterproof
Recommended Uses	Indoor door lock, outdoor door lock



WARRANTY AND SUPPORT

TEEHO is committed to providing excellent customer service and product support.

- **Warranty:** TEEHO offers a 1-year warranty on all parts.
- **Customer Service:** Lifetime customer service is available, including online phone support from Monday to Friday, 9 AM to 5 PM PST, and 24/7 online email service.

For assistance, please refer to the contact information provided with your product packaging or visit the official TEEHO website.

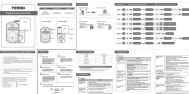
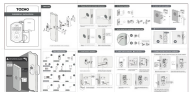
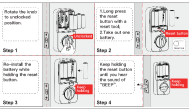
Related Documents - TE001

	TEEHO TE001K Keyless Entry Door Lock and Door Knob Installation Guide Comprehensive installation instructions for TEEHO TE001K keyless entry door locks and door knobs, covering door preparation, parts identification, and step-by-step assembly for secure and easy installation.
	TEEHO TE001/TE001K Keyless Entry Door Lock Programming Instructions Comprehensive programming instructions for the TEEHO TE001 and TE001K keyless entry door locks, covering installation, usage, feature settings, and troubleshooting.
	TEEHO TE002K Fingerprint Door Lock Installation Guide Comprehensive installation instructions for the TEEHO TE002K Fingerprint Door Lock, detailing door preparation, parts identification, and step-by-step assembly for a secure and easy setup.
	TEEHO Smart Lock Reset Guide: Step-by-Step Instructions This guide provides clear, step-by-step instructions for resetting TEEHO keyless entry door locks, including models like TE001 and TE002K. Essential for maintaining your smart lock.
	TEEHO TE001 Keyless Entry Door Lock Installation Guide Step-by-step instructions for installing the TEEHO TE001 keyless entry door lock, including door preparation, parts identification, and assembly.

<div><div>TEEHO</div><div>Installation Manual</div><div>TEEHO TE001</div><div>Need Help? Contact Us! If you have any questions, please contact us at: ☎ +1 (833) 878-3346 (Monday-Friday 9:00 am-5:00 pm PST) ✉ support@teeho.com 🌐 teeho.com</div><div>Tutorial Video <div>Scan the QR code and search TEEHO Please watch these videos first and use this manual as a guide.</div></div></div>	<div>TEEHO TE001 Smart Lock Installation Manual</div> <div>Comprehensive installation guide for the TEEHO TE001 smart door lock, covering parts list, step-by-step installation, troubleshooting, and safety information.</div>
---	---