

Bietrun TS-230

Bietrun Voice Amplifier TS-230 Instruction Manual

Model: TS-230 | Brand: Bietrun

1. INTRODUCTION

The Bietrun Voice Amplifier TS-230 is a portable and versatile public address system designed to amplify your voice clearly and powerfully. Ideal for teachers, coaches, instructors, tour guides, and anyone needing to project their voice to a group, this device helps save your throat and ensures your message is heard. It features both wired and wireless microphone options, Bluetooth connectivity, FM radio, and media playback capabilities.

2. WHAT'S IN THE BOX

- Voice Amplifier
- Wireless Microphone Headset
- Wired Microphone Headset
- Charging Cable
- Waistband Belt



Image: All items included in the Bietrun Voice Amplifier package.

3. PRODUCT OVERVIEW



Image: The Bietrun Voice Amplifier main unit with its accompanying headsets and cables.

Easy to Use Touch Display

Touch SOURCE button 3 times to switch mode



Image: Detailed view of the amplifier's touch controls, ports (MIC, AUDIO IN, USB, DC 5V), and FM antenna.

The main unit is compact and lightweight, weighing only 0.45 lb (204g). It features intuitive touch controls on the top panel for playback and source selection. Side panels include ports for wired microphone input, auxiliary audio input, USB disk, Micro SD card, and DC 5V charging. A retractable FM antenna is also present. A back clip allows for attachment to a belt or pocket, and a waistband belt is included for hands-free carrying.

Ergonomic Design, Elastic Head Bracket



Change Channel

Short press the PAIR button on the mic to avoid interference

Image: The wireless headset microphone features an ergonomic design with an adjustable arm for optimal positioning near the mouth.

4. SETUP & INITIAL USE

4.1 Charging the Device

Before first use, fully charge the voice amplifier and wireless microphone. Use the included 2-in-1 charging cable. The amplifier has a 2000mAh rechargeable lithium battery, taking approximately 3 hours for a full charge and providing up to 12 hours of working time at max volume. The wireless microphone can be used for about 6 hours on a full charge.

2000mAh Rechargeable Battery



3 Hours
Charging
Time



12 Hours
Working
Time



Image: Visual representation of the amplifier's 2000mAh battery, 3-hour charging time, and 12-hour working time.

4.2 Connecting Wired Microphone

Insert the 3.5mm jack of the wired microphone headset into the 'MIC' jack on the amplifier. Adjust the flexible gooseneck to position the microphone approximately 1-2 inches from your mouth for optimal sound pickup.

4.3 Pairing Wireless Microphone (UHF Transmission)

The wireless microphone and amplifier are designed to pair automatically. Follow these steps:

1. Turn off both the amplifier and the wireless microphone.
2. Turn on the wireless microphone. Long press the 'PAIR' button on the microphone until the blue light flashes quickly.
3. Turn on the amplifier and switch it to 'UHF' mode. Wait for the 'UHF' icon on the display to change from flashing to staying on, indicating successful connection.
4. Increase the volume and begin using.

Re-pair When No Sound

Easy to use, quick pairing, avoid interference

- 1 Turn off the amplifier and wireless microphone

Change Channel

Short press the PAIR button on the mic to avoid interference

- 2 Turn on the wireless microphone

- 3 Long press the **pair** button until the blue light flash quickly

- 4 Turn on the amplifier, wait for the "UHF" on the display from flash to stay on, which means connected successfully, then increase the volume and use it.

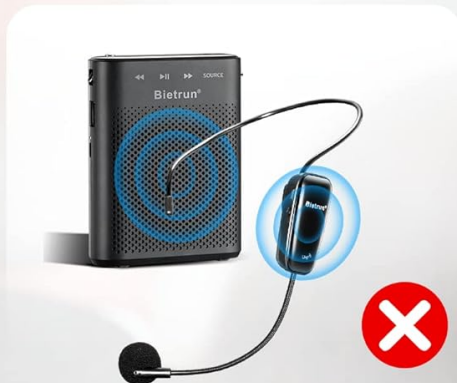

Image: Visual guide for re-pairing the wireless microphone and amplifier, showing power buttons and pairing indicator.

Video: Demonstrates how to use the Bietrun Voice Amplifier and troubleshoot pairing issues if there is no sound. This video is provided by the seller, Bietrun.

4.4 Microphone Placement

For optimal sound quality and to avoid feedback (noise or statics), do not place the microphone directly in front of the voice amplifier speaker. Position the microphone headset with the mic element close to your mouth, typically 1-2 inches away.



NOTE:

Do not put the microphone in front of the voice amplifier when using it, or it may cause noise or statics



Image: Illustrates the correct placement of the microphone headset (away from the speaker) versus incorrect placement (in front of the speaker).

5. OPERATING INSTRUCTIONS

5.1 UHF Voice Amplification

Once the microphone is connected (wired or wireless), ensure the amplifier is in UHF mode. Adjust the volume using the side scroll wheel. The 20W peak power provides clear, crisp sound covering up to 10,000 sq.ft (1000).

**20W Output-Sound
Coverage up to
10000 SQ.FT**

No Noise
No Static

Image: Highlights the 20W output and sound coverage of up to 10,000 sq.ft, emphasizing no noise or static.

5.2 Bluetooth Mode

To use the amplifier as a Bluetooth speaker:

1. Short press the 'SOURCE' button 3 times to switch to Bluetooth 5.0 mode. The display will show 'BLUE' and indicate 'waiting for pairing'.
2. On your mobile phone, activate Bluetooth and search for 'Bietrun'.
3. Select 'Bietrun' to pair. Once connected, you can play audio from your phone through the amplifier.



Image: Demonstrates the Bluetooth pairing process between the amplifier and a smartphone, showing the 'Bietrun' device name in the phone's Bluetooth settings.

5.3 FM Radio Mode

To listen to FM radio:

1. Short press the 'SOURCE' button to cycle through modes until 'FM' is displayed.
2. Pull out the FM antenna for better reception.
3. Long press the Play/Pause button (||) for 2 seconds to automatically search and save available radio stations.
4. Use the '<<' and '>>' buttons to switch between saved stations.



Image: Shows the amplifier in FM radio mode with its retractable antenna extended, ready for station tuning.

5.4 Playing from TF (Micro SD) Card / USB Disk

Insert a TF (Micro SD) card or USB Disk (not included) with audio files into the respective slot. The amplifier will automatically detect and begin playing the music. You can long press the Play/Pause button to repeat a single tune or loop all music.

5.5 Recording Function

The recording function is available only when using the wired microphone. Ensure a TF card or USB Disk is inserted before attempting to record. Long press the 'REC' button (if available, or refer to manual for specific recording button) to start/stop recording.

6. MAINTENANCE

- Clean the device with a soft, dry cloth. Do not use abrasive cleaners or solvents.
- Store in a cool, dry place away from direct sunlight and extreme temperatures.
- Avoid dropping the device or subjecting it to strong impacts.
- Do not attempt to disassemble or repair the device yourself. Contact customer support for assistance.

7. TROUBLESHOOTING

- **No Sound / Static / Feedback:**
 - Ensure the microphone is not placed directly in front of the amplifier speaker.
 - Check if the microphone is properly connected (wired) or paired (wireless). Refer to Section 4.3 for wireless pairing steps.
 - Adjust the volume level. Excessive volume can cause feedback.
 - For wireless mic, short press the 'PAIR' button on the mic to switch channels and avoid interference.
- **Device Not Turning On:**
 - Check battery level. Recharge the device if the battery is low.
- **Bluetooth Pairing Issues:**
 - Ensure the amplifier is in Bluetooth pairing mode (display shows 'BLUE').
 - Make sure Bluetooth is enabled on your mobile device.
 - Try restarting both the amplifier and your mobile device.
- **Recording Not Working:**
 - Ensure a TF card or USB Disk is inserted into the device.
 - Recording is only supported with the wired microphone.

8. SPECIFICATIONS

Feature	Specification
Brand	Bietrun
Model Number	TS-230
Output Wattage	20 Watts
Item Weight	0.45 lb / 204g
Product Dimensions	3.54 x 1.18 x 4.52 inches
Power Source	Battery Powered (2000mAh Lithium Ion)
Working Time (Max Volume)	12 hours
Charging Time	3 hours
Connectivity Technology	UHF, Bluetooth 5.0

Wireless Microphone Channels	60 channels
Audio Input	Wired microphone, Wireless microphone, 3.5mm AUX, TF card, USB Disk
Mounting Type	Back clip

9. SUPPORT

For any questions, technical support, or warranty inquiries, please contact Bietrun customer service through the platform where you purchased the product or visit the official Bietrun website for contact information.

Documents - Bietrun – TS-230

[\[pdf\]](#)

bietrun ts 230 2022 9 7 Page 1 81CbOg8U6fL ref dp product quick view m media amazon images I |||

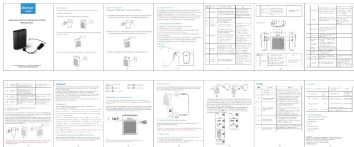

Porta scheda MicroSD Accensione/ Volume Indicatore dicarica
Laspialuminosarossadurante laricaricaesispegnequandola caricacompleta.
Caricacompletapercirca4 ore. Indicatore touch Ognivoltachetocchi,verranno L
operazioneditocconon visualizzate4luciblusullaparte validaselespieluminose
superiore...

lang:it score:12 filesize: 492.94 K page_count: 1 document date: 2025-02-06