

## Manuals+

[Q & A](#) | [Deep Search](#) | [Upload](#)

manuals.plus /

- › [Vonets](#) /
- › [Vonets VAP11G-300 2.4G Mini WiFi Bridge Instruction Manual](#)

### Vonets VAP11G-300

# Vonets VAP11G-300 2.4G Mini WiFi Bridge Instruction Manual

Model: VAP11G-300

Brand: Vonets

## 1. PRODUCT OVERVIEW

The Vonets VAP11G-300 is a professional 300Mbps WiFi repeater designed for stable and reliable network connectivity. It supports WiFi to wired and wired to WiFi functions, making it suitable for various applications.



Image: Two Vonets VAP11G-300 WiFi bridges, showcasing their compact design and included cables.

## 2. PRODUCT FEATURES

- **2025 New Upgrade:** Features a new process design for super stability. Functions as an Industrial Mini WiFi Bridge/Repeater/AP, supporting both WiFi to wired and wired to WiFi connectivity.

- **Parameters:** Offers a 2.4GHz WiFi rate of 300Mbps, adhering to 802.11b/g/n WiFi protocol. Point-to-point transmission distance is up to 100 meters without obstacles for small data, and less than 80 meters for video transmission.
- **Power Supply:** Includes a two-in-one dedicated power cord, offering USB and DC power supply options. USB supports 5V/1A power, while the DC2.0 power hole supports wide voltage DC5-15V. Comes with a 10/100M adaptive Ethernet cable.
- **Compact Size:** The card-sized device is easy to carry and integrate, measuring 3.62 x 1.85 x 0.83 inches.
- **Continuous Update Service:** Software is continuously optimized, allowing online upgrades for optimal device function.



Image: The compact size of the VAP11G-300 compared to a credit card, highlighting its portability and the high-performance Mediatek chip.

### 3. PRODUCT DIAGRAM AND COMPONENTS

The VAP11G-300 features essential components for its operation:

- **USB Port:** For power supply (5V/1A recommended).
- **DC Power Supply Hole:** Supports wide voltage DC5-15V power supply.
- **LAN Port (RJ45):** For Ethernet cable connection.
- **Hotspot Connection Status Light:** Indicates the status of the WiFi hotspot connection.
- **Ethernet Cable Connection Light:** Indicates the status of the Ethernet connection.
- **Reset Button:** Used to reset the device to factory settings.



Image: Detailed diagram illustrating the various ports and indicator lights on the VAP11G-300 device.

## 4. SETUP AND CONFIGURATION

### 4.1 Powering On the Device

Connect the VAP11G-300 to a power source using the provided two-in-one dedicated power cord. A 5V/2A typical power supply is recommended for optimal performance. The device will power on, and indicator lights will illuminate.

### 4.2 Configuration via Computer

To configure the device using a computer, follow these steps:

1. Connect the VAP11G-300 to your computer via an Ethernet cable.
2. Open a web browser and enter the configured domain (<http://vonets.cfg>) or the IP address (192.168.254.254) in the address bar.
3. Enter the User ID and password. Both are typically "admin". Click "Login".
4. Navigate to the WiFi Hotspots section. The device will search for available WiFi hotspots.
5. Select your desired WiFi hotspot from the list and click "Next".
6. Enter the password for your selected WiFi hotspot.
7. Click "Apply" and then "Reboot" or power off the device. The device will reboot, which may take about 1 minute. Wait until the LED light flashes normally.

Your browser does not support the video tag.

Video: A step-by-step guide on how to configure the Vonets VAP11G-300 using a computer, demonstrating the web interface and settings.

### 4.3 Configuration via Smartphone

To configure the device using a smartphone, follow these steps:

1. Find the MAC address of the VAP11G-300, which is located on the back of the device.
2. Connect your smartphone to the WiFi SSID of the VAP11G-300 (the SSID is VONETS\_2.4G\_XXXX, where

XXXX is the last four digits of the MAC address). The default password is 12345678.

3. Open a web browser on your smartphone and enter the configured domain (<http://vonets.cfg>) or the IP address (192.168.254.254) in the address bar.
4. Enter the User ID and password. Both are typically "admin". Click "Login".
5. Navigate to the WiFi Hotspots section. The device will search for available WiFi hotspots.
6. Select your desired WiFi hotspot from the list and click "Next".
7. Enter the password for your selected WiFi hotspot.
8. Click "Apply" and then "Reboot" or power off the device. The device will reboot, which may take about 1 minute. Wait until the LED light flashes normally.

Your browser does not support the video tag.

Video: A step-by-step guide on how to configure the Vonets VAP11G-300 using a smartphone, demonstrating the mobile web interface and settings.

## 5. OPERATING MODES

The Vonets VAP11G-300 supports two primary operating modes:

- **AP Mode:** In Access Point (AP) mode, the device converts wired networks to wireless access. This is suitable for scenarios where an Ethernet cable provides internet access to a computer without requiring dialing.
- **Repeater Mode:** In Repeater mode, the device extends the existing network, facilitating easy network expansion. It can also convert WiFi to an RJ45 network, allowing a computer to access the internet via a network cable.

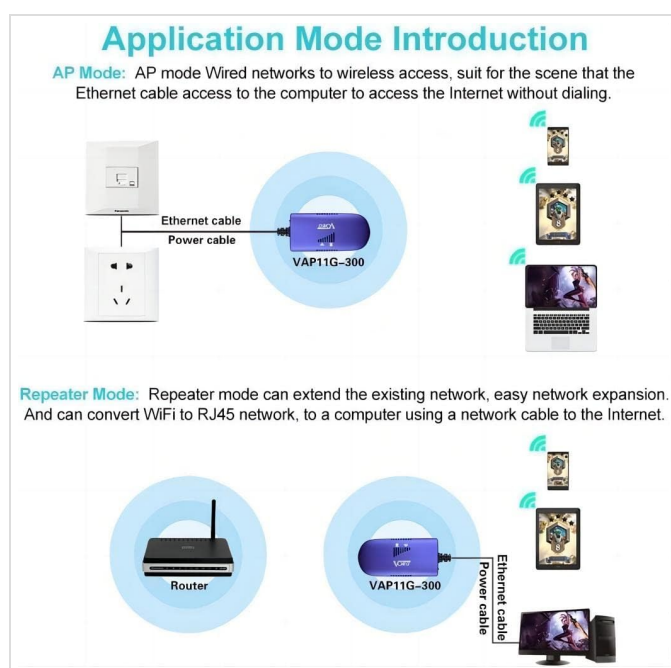

Image: Visual representation of the VAP11G-300 operating in AP Mode (wired to wireless) and Repeater Mode (extending wireless network).

## 6. APPLICATION SCENARIOS

The VAP11G-300 is a versatile device suitable for various network applications, including:

- Surveillance systems (e.g., IP cameras, DVRs)
- Electronic scales

- Medical equipment
- Internet of Things (IoT) equipment
- Video transmission
- Industrial PLC (Programmable Logic Controller)
- Gaming consoles (e.g., PS3)
- Printers
- Robots
- Extending WiFi coverage in areas with weak signals (e.g., single rooms, balconies, duplex buildings).

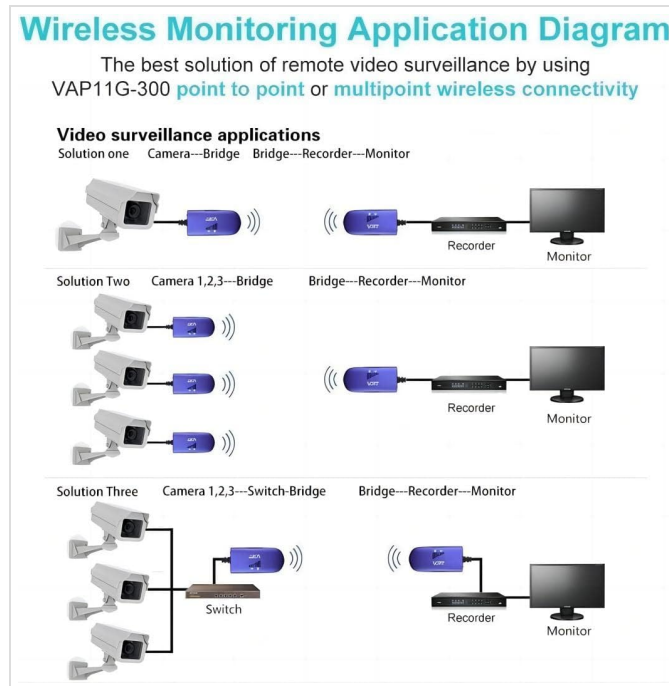

Image: Wireless monitoring application diagram, illustrating how the VAP11G-300 can be used for remote video surveillance in various setups.



Image: A visual guide to various devices and systems that can benefit from the VAP11G-300's connectivity features.

## 7. SPECIFICATIONS

Specification	Value
Product Dimensions	3.62 x 1.85 x 0.83 inches
Item Weight	5.8 ounces
Item Model Number	VAP11G-300
Wireless Communication Standard	802.11bgn
Data Transfer Rate	300 Megabytes Per Second
Frequency Band Class	Dual-Band
Connector Type	RJ45, USB
Manufacturer	Shenzhen Houtian Network Communication Technology Co.,Ltd
Date First Available	December 15, 2021

## 8. TROUBLESHOOTING

If you encounter issues with your Vonets VAP11G-300, consider the following common troubleshooting steps:

- **Power Check:** Ensure the device is properly powered on with the recommended 5V/2A power supply. Check if the indicator lights are active.
- **Network Cable:** Verify that all Ethernet cables are securely connected.
- **IP Address Conflict:** If you experience connectivity issues after configuration, ensure there are no IP address conflicts on your network. The manual recommends disabling the DHCP server if conflicts occur.
- **Reboot Device:** A simple reboot can often resolve temporary connectivity problems. Power off the device, wait a few seconds, and then power it back on.
- **Factory Reset:** If problems persist, use the reset button to restore the device to its factory default settings. This will clear all custom configurations.
- **Check WiFi Hotspot Password:** Double-check that the WiFi hotspot password entered during configuration is correct.
- **Signal Strength:** Ensure the device is within adequate range of the source WiFi hotspot. Weak signals can affect performance.

## 9. MAINTENANCE

To ensure the longevity and optimal performance of your Vonets VAP11G-300:







- Keep the device in a cool, dry place, away from direct sunlight and moisture.
- Avoid placing the device near sources of strong electromagnetic interference.
- Regularly check for and install software updates to benefit from performance optimizations and new features.
- Clean the device periodically with a soft, dry cloth to prevent dust buildup.

## 10. WARRANTY AND SUPPORT

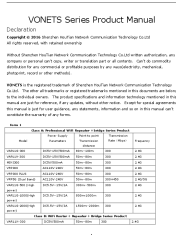
For warranty information, technical support, or further assistance, please refer to the official Vonets website or contact their customer service. Details regarding specific warranty periods and service terms may vary by region

and purchase location.  
You can visit the [Vonets Store on Amazon](#) for more information.

Related Documents - VAP11G-300

	<p><a href="#">VONETS Series Product Manual: WiFi Repeater, Router, and Bridge Setup Guide</a></p> <p>Comprehensive guide to setting up and troubleshooting VONETS WiFi repeaters, routers, and bridges. Covers Class A, B, and C product series with detailed instructions and common fault solutions.</p>
	<p><a href="#">VONETS WiFi Bridge/Repeater - Przewodnik Szybkiej Konfiguracji</a></p> <p>Szczegółowy przewodnik konfiguracji urządzenia VONETS WiFi Bridge/Repeater, opisujący tryby pracy (Repeater, Bridge, AP), podłączanie, ustawienia sieciowe, konfigurację punktu dostępu oraz często zadawane pytania. Zawiera również informacje o certyfikacji zgodności CE.</p>
	<p><a href="#">VONETS WiFi Bridge/Repeater Quick Setting Guide</a></p> <p>A quick guide to setting up and configuring VONETS WiFi Bridge and Repeater devices, including application methods and troubleshooting.</p>
	<p><a href="#">VONETS WiFi Bridge/Repeater/Router VAP11S/VAP11S-5G/VAP11G-500S Quick Setting Guide</a></p> <p>Quick setting guide for VONETS VAP11S, VAP11S-5G, and VAP11G-500S WiFi Bridge, Repeater, and Router devices. Learn how to configure modes, network settings, and installation.</p>
	<p><a href="#">VONETS WiFi Bridge/Repeater/Router VAP11S/VAP11S-5G/VAP11G-500S Quick Setting Guide</a></p> <p>Quick setting guide for VONETS VAP11S, VAP11S-5G, and VAP11G-500S WiFi Bridge/Repeater/Router devices, covering setup, configuration modes, and troubleshooting.</p>
	<p><a href="#">VONETS VAP11G-300 300M WiFi Repeater and Bridge Quick Setting Guide</a></p> <p>Quick setting guide for the VONETS VAP11G-300 300M Professional Mini WiFi Repeater and WiFi Bridge. Learn how to configure and use this device for expanding wireless network coverage.</p>

