

Manuals+

[Q & A](#) | [Deep Search](#) | [Upload](#)

manuals.plus /

> [Jocuu](#) /

> [Jocuu Slow Masticating Juicer \(Model MJ-1503-NAIBAI\) Instruction Manual](#)

Jocuu MJ-1503-NAIBAI

Jocuu Slow Masticating Juicer (Model MJ-1503-NAIBAI) Instruction Manual

Your guide to healthy juicing with ease.

INTRODUCTION

Thank you for choosing the Jocuu Slow Masticating Juicer. This appliance is designed to extract high-purity juice from various fruits and vegetables, preserving nutrients through its slow-speed, cold-press technology. Please read this manual thoroughly before operation to ensure safe and efficient use.

SETUP AND ASSEMBLY

Before first use, wash all detachable parts with warm, soapy water. Ensure all parts are completely dry before assembly.

Component Overview



Image: All detachable parts of the Jocuu Slow Masticating Juicer laid out on a counter, including the motor base, auger, filter, end cap, food tray, pushing rod, juice cup, and pulp container.

Assembly Steps

- Attach the Main Juicing Body:** Align the main juicing body with the motor base and twist until it clicks securely into place.
- Insert the Auger:** Place the spiral auger into the main juicing body.
- Fit the Filter:** Position the fine mesh filter over the auger.
- Attach the End Cap:** Screw the end cap onto the main juicing body until it is firmly attached.
- Place the Food Tray:** Set the food tray on top of the feeding chute.
- Position Containers:** Place the juice cup under the juice outlet and the pulp container under the pulp outlet.

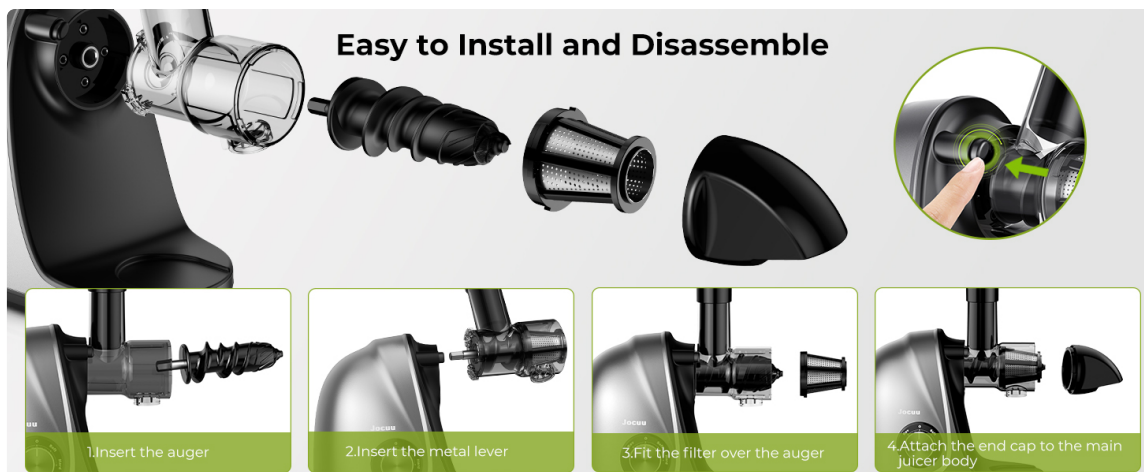

Image: A visual guide demonstrating the four main steps to assemble the juicer: inserting the auger, inserting the metal lever, fitting the filter over the auger, and attaching the end cap to the main juicer body.

Assembly Demonstration Video

Video: A seller-provided video demonstrating the unboxing and assembly process of the Jocuu Masticating Juicer, showing each component and how they fit together.

OPERATING INSTRUCTIONS

Preparation of Ingredients

- Wash all fruits and vegetables thoroughly.
- Cut ingredients into smaller chunks that can easily fit into the feeding chute. This prevents clogging and ensures efficient juicing.
- Remove hard seeds, pits, or thick peels from fruits like peaches, avocados, or citrus fruits before juicing.

Tips to Get the Most Out of Your Juicer

Please cut the fruits and vegetables into smaller pieces first and put down gently. If the machine get stuck, please use the reverse function.

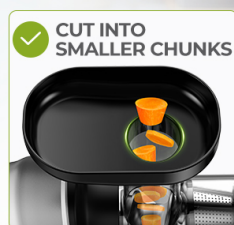
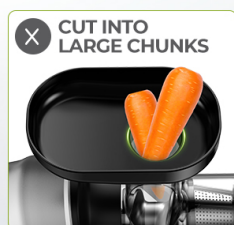

Image: A woman demonstrating how to cut carrots into smaller, manageable pieces before feeding them into the juicer, emphasizing the importance of proper preparation.

Juicing Process

1. Plug in the juicer.
2. Select the appropriate speed mode using the control knob: **Soft Mode** (50-60 RPM) for softer fruits and vegetables (e.g., oranges, watermelon, kiwi, grapes, strawberries, tomatoes) or **Hard Mode** (100-110 RPM) for harder ingredients (e.g., apples, carrots, celery, cucumbers, beets, ginger).

3. Slowly feed the prepared ingredients into the feeding chute. Use the pushing rod gently to guide ingredients down, but do not force them.
4. The juicer will automatically separate juice into the juice cup and pulp into the pulp container.
5. The juicer features an intelligent motor protection chip that automatically shuts off after 20 minutes of continuous operation to ensure longer service life.



SOFE MODE : 50 to 60 RPM



HARD MODE : 100 to 110 RPM



REV MODE: Avoid getting stuck twist to REV direction for 3 seconds

Image: The juicer's control panel highlighting the 'Soft' mode (50-60 RPM) for soft fruits like oranges and strawberries, and 'Hard' mode (100-110 RPM) for hard vegetables like apples and carrots.

Operating Demonstration Video

Video: A seller-provided video demonstrating the juicing process with various fruits and vegetables, showcasing the ease of use and the quality of the extracted juice.

MAINTENANCE AND CLEANING

Regular cleaning ensures the longevity and hygiene of your juicer. The one-touch assembly design allows for quick disassembly.

Disassembly for Cleaning

1. Unplug the juicer from the power outlet.
2. Press the 'Push' button on the side of the main juicing body and twist to unlock and remove it from the motor base.
3. Disassemble the end cap, filter, and auger from the main juicing body.
4. Empty the juice cup and pulp container.

| Easy to Disassemble and Clean

Equipped with a special brush to clean the filter



Image: A hand pressing the 'Push' button on the side of the juicer, indicating the easy disassembly mechanism for cleaning.

Cleaning Steps

- All detachable parts are made of high-quality food-grade antioxidant material and are dishwasher safe.
- Alternatively, rinse all detachable parts under warm running water. Use the provided cleaning brush to remove any pulp residue, especially from the fine mesh filter.
- Wipe the motor base with a damp cloth. Never immerse the motor base in water.
- Allow all parts to air dry completely before reassembling or storing.



Image: Detachable parts of the juicer, including the auger and filter, placed in a dishwasher rack, illustrating their dishwasher-safe feature.

TROUBLESHOOTING

Juicer Clogs or Stops During Operation

- If the machine gets stuck or clogs, immediately switch the control knob to the **Rev (Reverse)** function for 3 seconds. This will help dislodge any stuck ingredients.
- After using the reverse function, switch back to the desired speed mode (Soft or Hard) to continue juicing.
- Ensure ingredients are cut into small enough pieces and not overfilled in the feeding chute.

SPECIFICATIONS

Feature	Detail
Brand	Jocuu
Model Name	Jocuu Slow Juicer (MJ-1503-NAIBAI)
Color	White
Special Feature	Auto-Reversing, Portable
Product Dimensions	18.5"D x 6.69"W x 14.56"H
Finish Type	Brushed

Product Care Instructions	Dishwasher Safe (detachable parts)
Capacity	1.5 Pounds
Maximum Power	150.00 Watts
Power Source	Corded Electric
Blade Material	Polypropylene
Number of Speeds	2 (Soft, Hard) + Reverse
Item Weight	8.09 pounds
Material	Plastic

WARRANTY AND SUPPORT

The Jocuu Slow Masticating Juicer comes with a [2-year warranty for the motor](#) and a [2-year warranty for normal accessory exchange](#). We also provide lifelong technical support and customer service. If you encounter any problems with your juicer during use, please do not hesitate to contact us directly for assistance.