



[Manuals.plus](#) /

> [Joydeco](#) /

> Joydeco 100% Blackout Fabric Roller Shade User Manual

Joydeco SC0001-OWH-34-V2

Joydeco 100% Blackout Fabric Roller Shade User Manual

Brand: Joydeco | Model: SC0001-OWH-34-V2

[Introduction](#) [Safety Information](#) [Product Overview](#) [Installation](#) [Operation](#) [Maintenance](#)
[Troubleshooting](#) [Specifications](#) [Support](#)

1. INTRODUCTION

This manual provides comprehensive instructions for the installation, operation, and maintenance of your Joydeco 100% Blackout Fabric Roller Shade. Please read this manual thoroughly before installation and use to ensure proper function and safety. Keep this manual for future reference.



Figure 1.1: Joydeco 100% Blackout Fabric Roller Shade installed in a living room setting, demonstrating its aesthetic integration and blackout capability.

2. SAFETY INFORMATION

Always prioritize safety during installation and operation. Failure to follow these instructions may result in injury or damage to the product.

- **Child and Pet Safety:** The Joydeco roller shade is designed with child and pet safety in mind. It includes a safety device to secure the operating chain to the wall, preventing entanglement and potential injury to children and pets. Always ensure the chain is properly secured.
- **Installation:** Ensure all mounting hardware is securely fastened to a stable surface. Do not install the shade in locations where it may obstruct emergency exits or ventilation.
- **Operation:** Do not apply excessive force when operating the shade. Keep hands and loose clothing clear of the chain mechanism during operation.
- **Maintenance:** Disconnect the shade from its mounting if performing any significant maintenance beyond routine

cleaning.

3. PRODUCT OVERVIEW

The Joydeco 100% Blackout Fabric Roller Shade provides complete light blockage and enhanced privacy, making it ideal for various rooms including kitchens, offices, bathrooms, entryways, children's rooms, garages, and home theater rooms.

Key Features:

- **100% Blackout:** Ensures complete privacy and blocks 100% of UV rays, creating a dark environment.
- **Thermal Insulation:** Features a thermal coating to help maintain comfortable room temperatures, reducing energy costs.
- **Durable Material:** Made from anti-static, dust-proof, and waterproof fabric for easy maintenance and longevity.
- **Noise Reduction:** The thick fabric helps to dampen outside noise.
- **Child-Friendly Design:** Includes a safety device for the chain to prevent entanglement.

UV Protection

100% Blackout

Child Safe

Thermal Insulated

Privacy Protection

Customization Available

Widths customizable from 15" to 70", with a maximum height of 98". If you have any questions please contact us at: amazonservice@joydeco.com
If any accessories are missing or damaged, leave us a message and we will promptly resend the necessary items.

Figure 3.1: Visual representation of the Joydeco roller shade's main features.

Components:

Your Joydeco roller shade package includes the following components:



Figure 3.2: Detailed view of the roller shade components, including the child safety device, fabric, cord mechanism, and accessory kit.

- Roller Shade Unit (with pre-installed fabric and cord mechanism)
- Mounting Brackets
- Child Safety Device (for securing the chain)
- Screws and Wall Anchors
- Installation Guide

4. INSTALLATION

Before beginning installation, ensure you have the necessary tools: a drill, screwdriver, measuring tape, and pencil.

4.1. Measuring for Installation

Proper measurement is crucial for a perfect fit. There are two main installation methods: Inside Mount and Outside Mount.

4.1.1. Inside Mount Measurement

For an inside mount, the roller blind size is based on the width of the blind top header. It will fit perfectly by deducting 1/5 inch from the inside width of the window frame.

- **Width:** Measure the inside width of your window frame at three points (top, middle, bottom) and use the smallest measurement. Deduct 0.2 inches (approx. 1/5 inch) from this measurement for the shade width.
- **Height:** Measure the exact inside height of your window frame.
- **Window Depth:** Ensure your window depth is greater than 2 inches (5 cm) for proper clearance.
- *Note: A tiny light gap will exist on each side with an inside mount. For 100% blackout, consider an outside mount.*

Inside Install

How to measure:

Deduct 0.2" from inside-width of window-frame.
Exact inside-height of window-frame.

Window depth >2"

Note: Tiny light-gap will exist on each side,
Please choose outside install for 100% blackout.

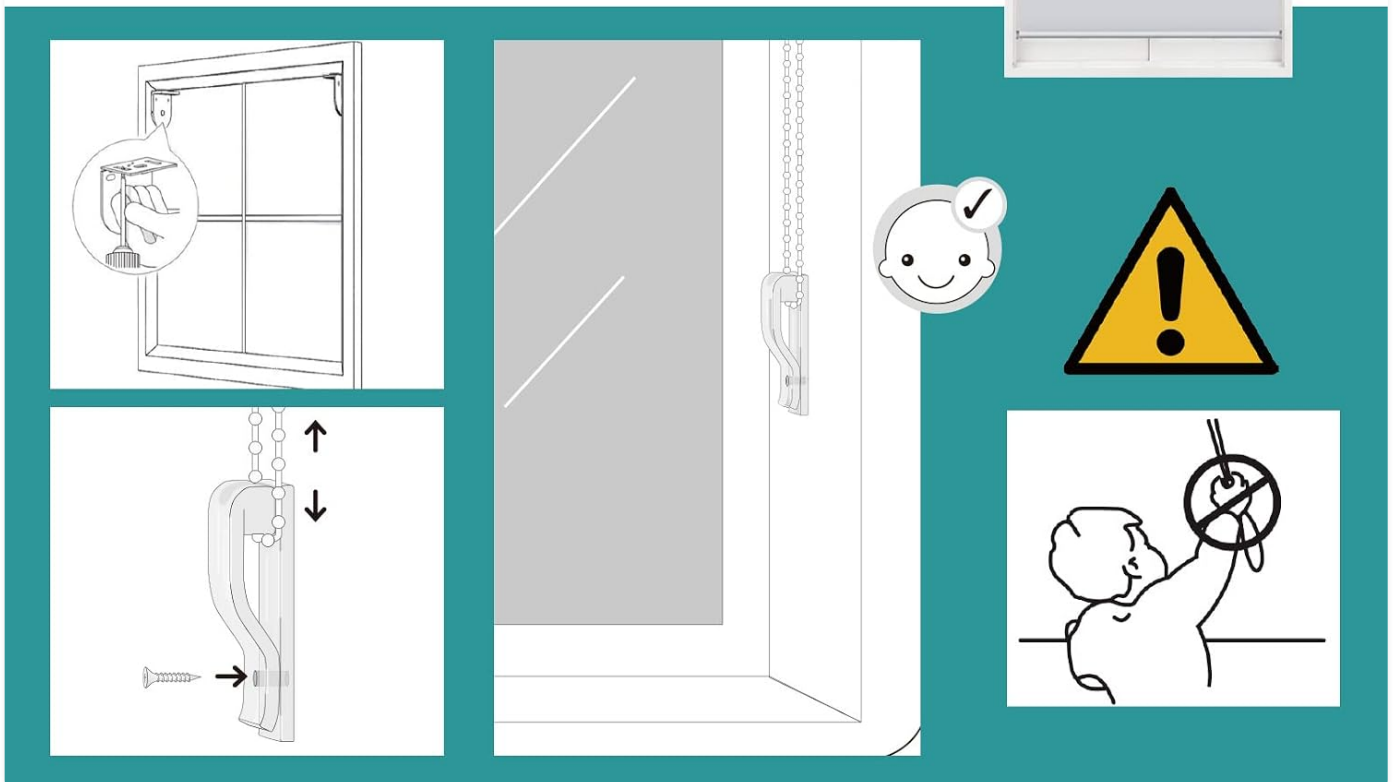

Figure 4.1: Inside Mount Measurement and Installation Guide.

4.1.2. Outside Mount Measurement

For an outside mount, the shade is mounted on the outside of the window casing or frame. This is ideal for achieving full

privacy and preventing light from shining into your home, as there are no gaps.

- **Width:** Add 2-4 inches or more to the outer width of your window frame to ensure full coverage and prevent light leakage.
- **Height:** Add 2-4 inches or more to the outer height of your window frame.
- *Note: There is no requirement for window depth with an outside mount. This may be the only option for shallow window frames.*

Outside Install

How to measure:

Plus 2-4" or more based on outer-width & outer-height of window-frame.

No requirement for window depth.

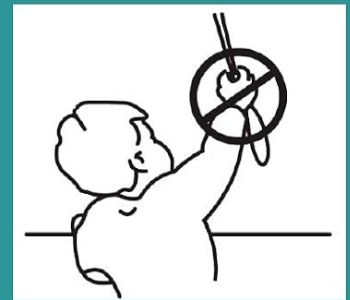
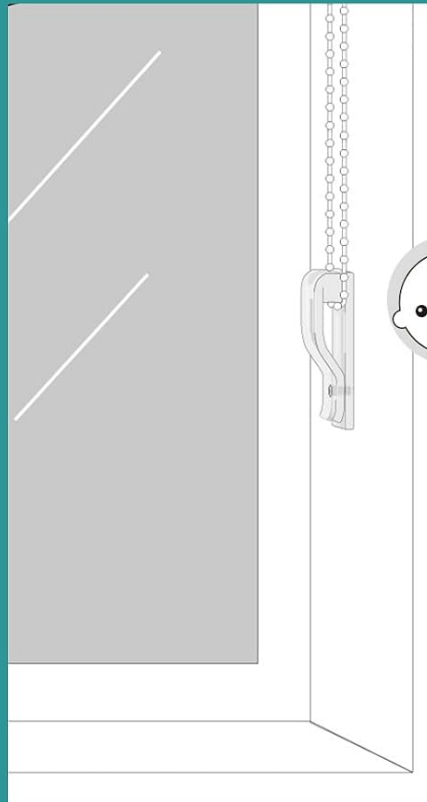
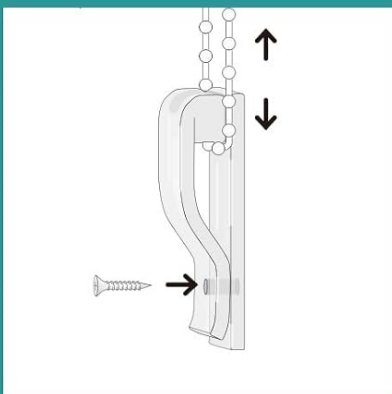
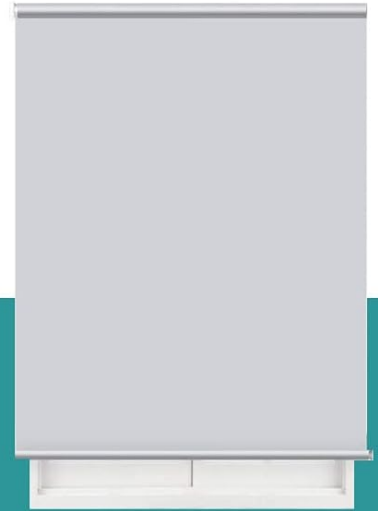

Figure 4.2: Outside Mount Measurement and Installation Guide.

4.2. Step-by-Step Installation

Follow these steps to install your Joydeco roller shade:

1. **Prepare the Brackets:** Identify the left and right mounting brackets.
2. **Attach End Caps:** Securely attach the plastic end caps to the roller shade mechanism.
3. **Insert Roller into Bracket:** Insert the roller mechanism into the designated slot on one of the mounting brackets.
4. **Align and Secure:** Align the other end of the roller with the second bracket and push to secure it in place.

5. **Check Fit:** Ensure the roller is firmly seated in both brackets.
6. **Mount Brackets:** Mark the desired mounting locations on the wall or window frame using your measurements. Drill pilot holes and secure the brackets with the provided screws and wall anchors.
7. **Install Shade:** Carefully snap the roller shade assembly into the mounted brackets.
8. **Secure Safety Device:** Attach the child safety device to the wall, ensuring the chain is taut and out of reach of children and pets.
9. **Final Check:** Test the shade's operation to ensure it raises and lowers smoothly.



Figure 4.3: Step-by-step visual installation guide.

5. OPERATING INSTRUCTIONS

Operating your Joydeco roller shade is simple and intuitive.

- **To Lower the Shade:** Gently pull down on the front side of the operating chain until the shade reaches the desired position.

- **To Raise the Shade:** Gently pull down on the back side of the operating chain until the shade is fully raised or at your preferred height.
- **Smooth Operation:** Always pull the chain smoothly and steadily to ensure the longevity of the mechanism. Avoid sudden jerks.

6. MAINTENANCE

Regular cleaning will keep your Joydeco roller shade looking new and functioning properly.

- **Cleaning the Fabric:** To remove dirt or dust from the shade, use only a damp cloth or a feather duster. Do not use harsh chemicals or abrasive cleaners, as these may damage the fabric or coating.
- **Mechanism Care:** Periodically check the operating chain and mechanism for any signs of wear or obstruction. Ensure the chain is free of tangles.

7. TROUBLESHOOTING

If you encounter any issues with your Joydeco roller shade, refer to the following common troubleshooting tips:

Problem	Possible Cause	Solution
Shade does not roll up or down smoothly.	Chain is tangled or obstructed. Shade is not properly seated in brackets.	Untangle the chain. Ensure the chain is not caught on anything. Re-seat the shade firmly into the mounting brackets.
Shade is crooked.	Brackets are not level. Fabric is not aligned on the roller.	Check bracket alignment with a level and adjust if necessary. Gently guide the fabric back into alignment by hand while operating the shade.
Light leakage around the edges.	Inside mount chosen. Measurements were not precise for outside mount.	This is normal for inside mounts. For full blackout, an outside mount is recommended. Ensure outside mount measurements include sufficient overlap (2-4 inches on each side).

If the problem persists, please contact customer support for further assistance.

8. SPECIFICATIONS

Detailed technical specifications for the Joydeco 100% Blackout Fabric Roller Shade:

Attribute	Value
Brand	Joydeco
Model Number	SC0001-OWH-34-V2
Color	Off-White
Size	34×75 inch
Material	Aluminum, Plastic

Attribute	Value
Special Features	UV Protection, Thermal Insulation, 100% Blackout, Child Safe, Anti-static, Dust-proof, Waterproof
Product Weight	2.69 pounds (approx. 1.22 kg)
Package Dimensions	97.2 x 7.2 x 5.8 cm
Care Instructions	Spot cleaning with damp cloth or feather duster
Recommended Use	Indoor

9. WARRANTY AND SUPPORT

Joydeco is committed to providing high-quality products and customer satisfaction.

Customer Support:

If you have any questions, require assistance with installation, or if any accessories are missing or damaged, please contact us directly.

Email: amazonservice@joydeco.com

We will promptly respond and resend any necessary items.

Warranty Information:

Specific warranty details may vary. Please retain your proof of purchase for any warranty claims. For detailed warranty terms and conditions, please contact our customer support team.