

## Manuals+

[Q & A](#) | [Deep Search](#) | [Upload](#)

manuals.plus /

- › [Losi](#) /
- › [Losi 1/10 Tenacity DB Pro 4WD Desert Buggy Brushless RTR Instruction Manual](#)

## Losi LOS03027V2T1

# Losi 1/10 Tenacity DB Pro 4WD Desert Buggy Brushless RTR Instruction Manual

Model: LOS03027V2T1

Brand: Losi

## 1. INTRODUCTION

This instruction manual provides essential information for the setup, operation, and maintenance of your Losi 1/10 Tenacity DB Pro 4 Wheel Drive Desert Buggy Brushless RTR. This high-performance remote-controlled vehicle is designed for durability and speed, featuring a brushless power system and Active Vehicle Control (AVC) technology for enhanced stability. Please read this manual thoroughly before operating the vehicle to ensure proper function and safety.



The Losi 1/10 Tenacity DB Pro 4WD Desert Buggy, featuring a detailed body with Lucas Oil livery, ready for operation.

## 2. SAFETY INFORMATION

**WARNING:** Read the ENTIRE instruction manual to become familiar with the features of the product before operating. Failure to operate the product correctly can result in damage to the product, personal property and

cause serious injury. This is a sophisticated hobby product. It must be operated with caution and common sense and requires some basic mechanical ability. Failure to operate this Product in a safe and responsible manner could result in injury or damage to the product or other property. This product is not intended for use by children without direct adult supervision. Do not use with incompatible components or alter this product in any way outside of the instructions provided by Horizon Hobby, LLC. The product manual contains instructions for safety, operation and maintenance. It is essential to read and follow all the instructions and warnings in the manual, prior to assembly, setup or use, in order to operate correctly and avoid damage or serious injury.

### 3. PACKAGE CONTENTS

---

Your Losi 1/10 Tenacity DB Pro package includes the following components:

- (1) Losi TENACITY DB Pro 1/10-scale 4WD Buggy
- (1) Spektrum DX3 Smart 3-Channel DSMR Radio System
- (1) Spektrum SR6200A DSMR 6-Channel AVC Surface Receiver
- (1) Spektrum Smart 130A Brushless ESC
- (1) Spektrum Firma 4-Pole 3150Kv 550 Motor
- (1) Spektrum S614 Waterproof Metal Gear Surface Servo, 23T
- Product Manual

**Note:** A suitable battery and charger are required for operation and are not included with this product.



This image illustrates that a battery and charger are essential accessories not included with the Losi Tenacity DB Pro.

### 4. GETTING STARTED (SETUP)

---

#### 4.1. Battery and Charger

Select a compatible LiPo battery (typically 2S or 3S for optimal performance) and a suitable LiPo charger. Always follow the battery and charger manufacturer's instructions for safe charging and handling. Ensure the battery is fully charged before first use.

#### 4.2. Transmitter Setup

The Spektrum DX3 Smart 3-Channel DSMR Radio System is pre-bound to your vehicle. Install the required batteries into the transmitter. Familiarize yourself with the basic controls: steering wheel for direction, trigger for throttle (forward/brake/reverse), and trim adjustments.

# Needed to Complete



**Battery**



**Charger**

The Spektrum DX3 Smart 3-Channel DSMR Radio System, used for controlling the Losi Tenacity DB Pro.

## 4.3. Receiver and ESC Connection

Ensure the Spektrum SR6200A DSMR 6-Channel AVC Surface Receiver and Spektrum Smart 130A Brushless ESC are securely connected within the chassis. The ESC is connected to the Spektrum Firma 4-Pole 3150Kv 550 Motor. Refer to the detailed product manual for specific wiring diagrams if needed.



An internal view of the Losi Tenacity DB Pro, illustrating the organized placement of the Spektrum Smart electronics.

## 4.4. Initial Inspection

Before each use, inspect the vehicle for any loose screws, damaged components, or obstructions. Check tire pressure and ensure all moving parts operate freely. Verify that the steering and throttle respond correctly to transmitter inputs.

## 5. OPERATION

### 5.1. Driving Controls

Use the steering wheel on the DX3 transmitter to control the vehicle's direction. Pull the trigger for forward motion and push it for braking and reverse. Practice in an open area to become familiar with the controls.

### 5.2. Recommended Driving Environments

The Tenacity DB Pro is designed for off-road use, including dirt tracks, gravel, and light sand. Avoid operating in deep water or extremely muddy conditions, despite its waterproof components, to prevent potential damage or excessive wear.



The Losi Tenacity DB Pro in action, demonstrating its capability on a dirt surface.



The Losi Tenacity DB Pro performing a jump, showcasing its robust suspension.

### 5.3. Active Vehicle Control (AVC) Technology

The integrated Spektrum SR6200A receiver features AVC technology, which provides stability assistance to help maintain control at high speeds and over challenging terrain. This system can be adjusted or disabled via the transmitter, as detailed in the Spektrum DX3 manual.



The Active Vehicle Control (AVC) system logo, highlighting a key stability feature.

## 6. MAINTENANCE

## 6.1. Post-Run Cleaning

After each use, especially in dusty or wet conditions, clean the vehicle thoroughly. Remove dirt and debris from the chassis, suspension, and drivetrain using a soft brush or compressed air. Avoid using harsh chemicals that could damage plastic or electronic components.

## 6.2. Component Checks

Regularly check all screws and fasteners for tightness. Inspect the shocks for leaks and ensure smooth operation. Examine the tires for wear or damage, and consider replacing them if traction is significantly reduced. Check the motor and ESC for excessive heat buildup during operation.



An underside view of the Losi Tenacity DB Pro chassis, revealing the robust construction and component layout.

## 6.3. Storage

Store the vehicle in a cool, dry place away from direct sunlight and extreme temperatures. Disconnect and remove the battery when storing for extended periods.

## 7. TROUBLESHOOTING

If you encounter issues with your Losi Tenacity DB Pro, consider the following common troubleshooting steps:

- **No Power:** Ensure the battery is fully charged and properly connected. Check the power switch on the ESC.
- **Loss of Control/Erratic Behavior:** Verify transmitter batteries are fresh. Check for proper binding between transmitter and receiver. Inspect antenna wires for damage.
- **Motor Not Responding:** Check motor and ESC connections. Ensure the ESC is calibrated to the transmitter.
- **Reduced Performance:** Inspect for debris in the drivetrain, worn tires, or a low battery charge.

For detailed troubleshooting guides and advanced diagnostics, please refer to the complete product manual or visit the Losi support website.

## 8. SPECIFICATIONS

---

**Product Dimensions:**

28.1 x 12.75 x 9.75 inches

**Item Weight:**

5.8 pounds

**ASIN:**

B09MMP99ZZ

**Item Model Number:**

LOS03027V2T1

**Manufacturer Recommended Age:**

14 months and up

**Release Date:**

November 26, 2021

**Manufacturer:**





Losi

## 9. SUPPORT AND WARRANTY

---

For technical assistance, replacement parts, or warranty information, please contact Losi customer support or visit the official Horizon Hobby website. Keep your proof of purchase for any warranty claims. Detailed warranty terms and conditions are typically provided with the full product manual.

**Related Documents - LOS03027V2T1**

	<p><a href="#">Losi Desert Buggy XL 2.0 Instruction Manual - 1/5 Scale Ready-to-Run Gas RC Car</a></p> <p>Umfassende Bedienungsanleitung für den Losi Desert Buggy XL 2.0 RTR. Enthält detaillierte Anleitungen zur Einrichtung, zum Betrieb, zur Wartung und zur Fehlerbehebung dieses leistungsstarken 1/5-Scale-Gas-RC-Fahrzeugs von Losi.</p>
	<p><a href="#">Losi Lasernut Tenacity Ultra 4 Rock Racer 1/10 Scale 4WD RTR Instruction Manual</a></p> <p>Comprehensive instruction manual for the Losi Lasernut Tenacity Ultra 4 Rock Racer, a 1/10 scale 4WD Ready-to-Run RC vehicle. Covers setup, operation, maintenance, troubleshooting, and safety precautions.</p>
	<p><a href="#">Losi 8IGHT-X Super Lasernut RTR 1/6-Scale 4WD Electric Buggy Instruction Manual</a></p> <p>Comprehensive instruction manual for the Losi 8IGHT-X Super Lasernut RTR 1/6-Scale 4WD Electric Buggy, covering setup, operation, maintenance, troubleshooting, and warranty information.</p>
	<p><a href="#">Manuel d'instructions Losi DBXL 2.0 Desert Buggy XL</a></p> <p>Guide complet pour le Losi DBXL 2.0 Desert Buggy XL, incluant les instructions de démarrage, d'utilisation, de maintenance et de dépannage pour ce véhicule RC à l'échelle 1/5.</p>
	<p><a href="#">Losi 8IGHT 1/8-Scale 4WD Gasoline Buggy RTR: Instruction Manual</a></p> <p>This is the instruction manual for the Losi 8IGHT 1/8-Scale 4WD Gasoline Buggy RTR. It provides comprehensive guidance on setup, operation, maintenance, safety precautions, troubleshooting, and warranty information for this high-performance radio-controlled vehicle.</p>



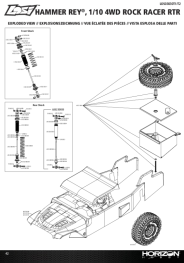

### [Losi Hammer Rey 1/10 4WD Rock Racer RTR Exploded View Diagram and Parts List](#)

Detailed exploded view diagram and comprehensive parts list for the Losi Hammer Rey 1/10 4WD Rock Racer RTR. This document identifies all components with their respective part numbers, crucial for assembly, maintenance, and repair.