

## Manuals+

[Q & A](#) | [Deep Search](#) | [Upload](#)

manuals.plus /

› [LICORNE](#) /

› [LICORNE 36800mAh Solar Power Bank \(Model LJJ-S023\) Instruction Manual](#)

## LICORNE LJJ-S023

# LICORNE 36800mAh Solar Power Bank

## MODEL: LJJ-S023 USER INSTRUCTION MANUAL

### 1. Introduction

---

Thank you for choosing the LICORNE 36800mAh Solar Power Bank, Model LJJ-S023. This portable power bank is designed to provide reliable power for your electronic devices, featuring a high-capacity battery, solar charging capabilities, wireless charging, and multiple output ports. Please read this manual carefully to ensure proper use, optimal performance, and longevity of your device.

This power bank is equipped with a 36800mAh battery, integrated charging cables (Type-C, Lightning, Micro USB), a USB-A output port, a Type-C input/output port, a Micro USB input port, and a 5W wireless charging pad. It also includes a multi-mode LED flashlight for emergencies.

### 2. Product Overview

---

Familiarize yourself with the components of your LICORNE Solar Power Bank:

**Adapt to a variety of harsh environments**



**Shockproof**



**Dustproof**

**Image:** Overview of the LICORNE Solar Power Bank, highlighting its solar panel, LED indicator lights, Type-C port (input/output), Micro USB input port, USB output port, power button, integrated charging cables (Micro USB, Type-C, Lightning), wireless charging panel, hanging ring, and LED flashlight.

- **Solar Panel:** For emergency solar charging.
- **LED Indicator Lights:** Display battery level and charging status.
- **Type-C Port (Input/Output):** For charging the power bank or charging devices.
- **Micro USB Input Port:** For charging the power bank.
- **USB Output Port:** For charging devices.
- **Power Button:** To turn on/off, check battery, and control flashlight.
- **Integrated Charging Cables:** Built-in Micro USB, Type-C, and Lightning cables for convenient device charging.
- **Wireless Charging Panel:** For 5W wireless charging of compatible devices.
- **Hanging Ring:** For attaching to backpacks or other gear.
- **LED Flashlight:** Features Strong, SOS, and Strobe modes.

### 3. Setup

#### Initial Charging

Before first use or before traveling, it is highly recommended to fully charge the power bank via a wall

adapter using the Micro USB or Type-C cable. This ensures the battery is properly conditioned and provides maximum capacity.

1. Connect the provided USB charging cable to the Micro USB or Type-C input port on the power bank.
2. Connect the other end of the cable to a USB wall adapter (not included) or a computer USB port.
3. The LED indicator lights will illuminate to show the charging progress. All lights will be solid when fully charged.

### Solar Charging Note

Solar charging is primarily designed as an emergency backup feature. Due to the compact size of the solar panel and varying light intensity, solar charging efficiency is limited and cannot be guaranteed for primary charging. For daily use, always charge the power bank via a cable and wall adapter.



**Image:** The solar power bank positioned outdoors to receive sunlight for emergency charging. The solar panel is visible on the top surface of the device.

## 4. Operating Instructions

### 4.1 Charging the Power Bank

There are two methods to charge your LICORNE Solar Power Bank:

- **Via USB Cable (Recommended):** Connect a Micro USB or Type-C cable to the corresponding input port on the power bank and plug the other end into a USB wall charger or computer. The LED indicators will show charging progress.
- **Via Solar Panel:** Place the power bank in direct sunlight. The solar indicator light will turn on, indicating that solar charging is active. Remember, this method is for emergency use only and is slower than cable charging.

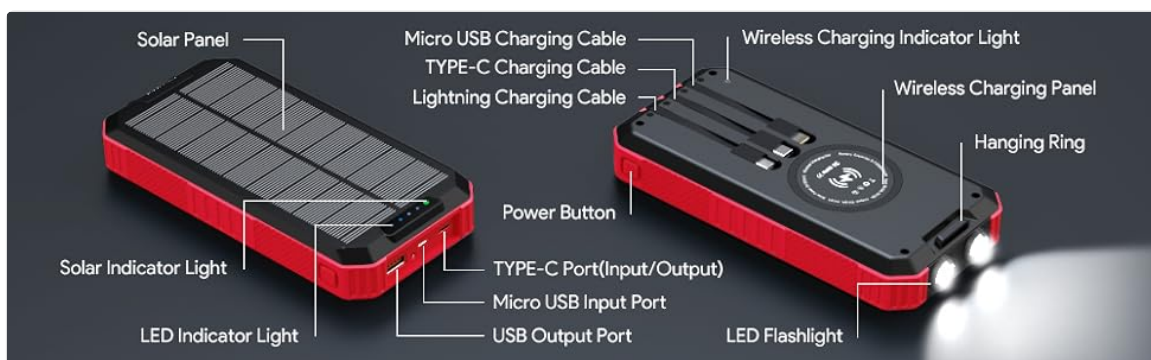

**Image:** The LICORNE Solar Power Bank connected to a power source via a USB cable, showing the LED indicator

lights illuminating to confirm charging. This illustrates the primary method for recharging the power bank.

## 4.2 Charging Your Devices

The power bank offers multiple ways to charge your electronic devices:

- **Using Integrated Cables:** Pull out the built-in Micro USB, Type-C, or Lightning cable and connect it directly to your compatible device.
- **Using USB-A Output Port:** Connect your device's charging cable to the USB-A output port on the power bank.
- **Using Type-C Output Port:** Connect your device's Type-C charging cable to the Type-C port on the power bank.
- **Wireless Charging:** Place your Qi-compatible device on the wireless charging pad. Ensure the device is centered for optimal charging. The wireless charging indicator light will activate.

Press the power button once to activate charging if it doesn't start automatically. The LED indicators will show the remaining power in the power bank.

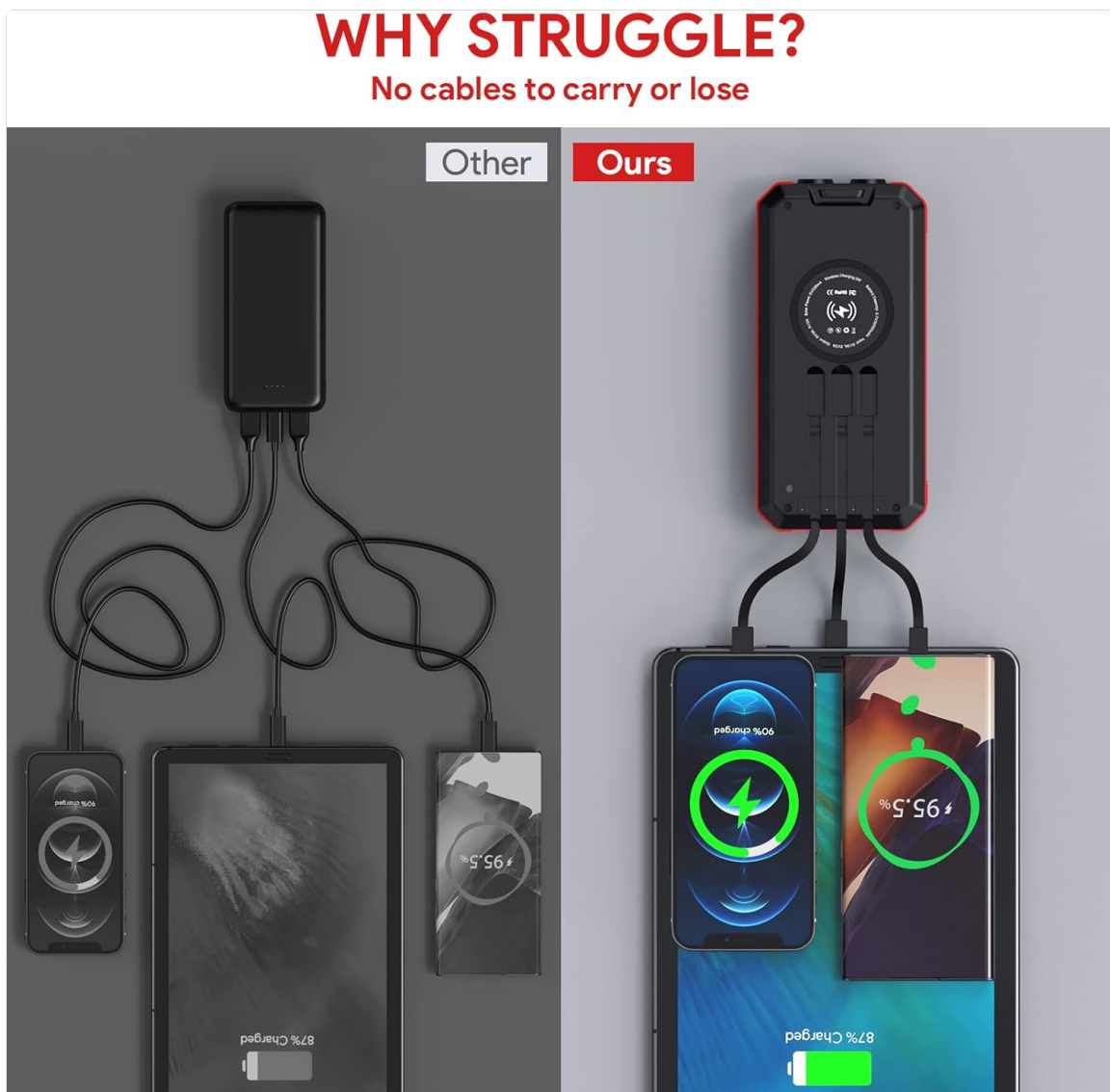

**Image:** The LICORNE Solar Power Bank simultaneously charging multiple devices, including smartphones and a tablet, using its integrated cables and wireless charging feature. This demonstrates its multi-device charging capability.



**Image:** A smartphone placed on the wireless charging pad of the LICORNE Solar Power Bank, indicating active wireless charging. This highlights the convenience of cable-free charging.

### 4.3 LED Flashlight Operation

The built-in LED flashlight has three modes:

- **Strong Mode:** Press and hold the power button for approximately 3 seconds to turn on the flashlight in strong mode.
- **SOS Mode:** With the flashlight on, press the power button once to switch to SOS mode (flashing pattern).
- **Strobe Mode:** Press the power button once again to switch to Strobe mode (rapid flashing).
- **Turn Off:** Press the power button a third time to turn off the flashlight, or press and hold for 3 seconds.

## LED flashlight function



Strong Mode



SOS Mode



Strobe Mode

LICORNE



**Image:** Illustrations depicting the three flashlight modes: Strong Mode for general illumination, SOS Mode for emergency signaling, and Strobe Mode for disorienting or attracting attention. The power bank's dual LED lights are shown emitting light.

## 5. Safety Precautions

To ensure safe operation and prolong the life of your power bank, please observe the following:

- Do not expose the power bank to extreme temperatures (above 60°C/140°F or below 0°C/32°F), direct sunlight for prolonged periods (especially in enclosed spaces like cars), or harsh environments.
- Avoid dropping, hitting, or disassembling the device.
- Keep away from water, moisture, and flammable materials. The device is IP66 rated for water and dust resistance, but it is not designed for submersion.
- Do not use if the device is damaged, swollen, or leaking.
- Keep out of reach of children.
- Use only certified charging cables and adapters.
- The power bank features short circuit protection; however, avoid intentionally short-circuiting the output ports.

## Equipped with Charging Cables



TYPE-C\*1



Lightning\*1



Micro USB\*1



## 4 Output Port & 2 Input Port



TYPE-C\*1  
(Input/Output Port)



USB\*1



Micro USB\*1

**Image:** The LICORNE Solar Power Bank shown in rugged outdoor settings, illustrating its shockproof and dustproof design. One image shows it on rough terrain, and another shows it partially covered in sand, emphasizing its durability in harsh environments.

## 6. Maintenance

- Clean the power bank with a soft, dry cloth. Do not use harsh chemicals or abrasive materials.
- Store the power bank in a cool, dry place when not in use.
- For long-term storage, charge the power bank to approximately 50-75% every three months to maintain battery health. Avoid storing it completely discharged or fully charged for extended periods.

## 7. Troubleshooting

- **Power bank not charging:**
  - Ensure the charging cable is securely connected to both the power bank and the power source.
  - Try a different charging cable or wall adapter.
  - Verify the power source is active.
- **Device not charging from power bank:**
  - Press the power button once to activate the power bank.

- Ensure your device's charging cable is properly connected to the power bank's output port or that your device is correctly placed on the wireless charging pad.
  - Check if the power bank has sufficient charge.
  - Try a different output port or charging method.
- **Slow charging:**
    - Ensure you are using a Quick Charge compatible adapter and cable for fast charging the power bank.
    - For solar charging, ensure direct and strong sunlight. Solar charging is inherently slower and meant for emergencies.
    - For device charging, ensure your device supports fast charging and that you are using appropriate cables.
- **Flashlight not working:**
    - Ensure the power bank has sufficient charge.
    - Press and hold the power button for 3 seconds to activate the flashlight.

## 8. Specifications

Feature	Detail
Model Number	LJJ-S023
Battery Capacity	36800mAh
Micro USB Input	5V/3A
Type-C Input/Output	5V/3A (Quick Charge 3.0 compatible)
USB-A Output	5V/2A (Quick Charge 3.0 compatible)
Integrated Cable Outputs	Micro USB, Type-C, Lightning (5V/2A each)
Wireless Output	5W
Solar Panel Output	5V/0.3A (Emergency use only)
Flashlight Modes	Strong, SOS, Strobe
Durability	IP66 Waterproof & Dustproof, Shockproof
Item Weight	1.37 pounds (approx. 621g)
Dimensions	8.46 x 5.94 x 1.46 inches (approx. 21.5 x 15.1 x 3.7 cm)

## 9. Warranty and Support

Your LICORNE Solar Power Bank is covered by a manufacturer's warranty. For specific warranty details, please refer to the product packaging or contact your retailer. If you encounter any issues or have questions regarding your product, please contact LICORNE customer support through the retailer's platform or the contact information provided with your purchase.

