

[Manuals.plus](#) /

> [PDEEY](#) /

> PDEEY 15W Power Cord Replacement Instruction Manual

## PDEEY 15W Power Cord Replacement

# PDEEY 15W Power Cord Replacement Instruction Manual

For Alexa Dot 3rd/4th/5th Gen, Echo Show 5, TV Cube, and Echo Pop

## 1. INTRODUCTION AND OVERVIEW

---

The PDEEY 15W Power Cord Replacement is designed to provide a reliable and efficient power supply for a range of Amazon Echo devices. This adapter serves as a direct replacement for your original 15W power cord, ensuring your devices receive the correct power for optimal performance.

Key features include a 15W power output, a convenient 5-foot cable length, and a durable DC barrel tip connector. Its compact design makes it suitable for both home use and travel.



Image: The PDEEY 15W Power Cord Replacement shown alongside various compatible Amazon Echo devices, illustrating its intended use.

## 2. SETUP

---

Setting up your PDEEY 15W Power Cord Replacement is a straightforward process. Follow these steps to ensure proper connection and operation:

1. **Unpack the Adapter:** Carefully remove the power adapter from its packaging.
2. **Identify Your Device's Power Port:** Locate the power input port on your compatible Amazon Echo device. This is typically a circular port designed for a barrel connector.
3. **Connect the Adapter to the Device:** Insert the DC barrel tip of the PDEEY power cord firmly into the power input port of your Amazon Echo device. Ensure it is fully seated.
4. **Plug into a Power Outlet:** Insert the two-prong plug of the power adapter into a standard 100-240V AC wall outlet.
5. **Verify Power:** Your Amazon Echo device should power on automatically. Look for indicator lights on your device to confirm it is receiving power.



Image: A woman connecting the PDEEY power cord to an Alexa Dot device, demonstrating the setup process.

### Important Safety Note:

- Ensure the power outlet is easily accessible.
- Do not force the connector into the device's port.
- Avoid plugging the adapter into damaged or overloaded power strips.

## 3. OPERATING

---

The PDEEY 15W Power Cord Replacement operates as a simple plug-and-play device. Once properly connected to your compatible Amazon Echo device and a power outlet, it continuously supplies the necessary power for your device to function.

This power cord is specifically designed for the following Amazon Echo models:

- Alexa Dot (5th Gen 2022)
- Alexa Dot (3rd Gen)
- Alexa Dot (4th Gen)
- Alexa Dot Kids Edition
- Echo Spot
- TV Cube
- Echo Show 5
- Dot with Clock Speakers
- Echo Pop



Image: A visual representation of the various Amazon Echo devices compatible with this 15W power cord.

No additional configuration or software is required for the power cord itself. Its function is solely to deliver stable power to your device.

## 4. MAINTENANCE

---

To ensure the longevity and safe operation of your PDEEY 15W Power Cord Replacement, follow these simple maintenance guidelines:

- **Keep Dry:** Avoid exposing the power cord and adapter to water or excessive moisture.
- **Clean Gently:** If cleaning is necessary, unplug the adapter from the wall and wipe it with a dry, soft cloth. Do not use liquid cleaners or abrasive materials.
- **Avoid Bending:** Do not excessively bend or crimp the cable, especially near the connectors, as this can damage the internal wires.
- **Store Properly:** When not in use, store the power cord in a cool, dry place, away from direct sunlight and extreme temperatures. Avoid tightly wrapping the cable.
- **Inspect Regularly:** Periodically check the cable and adapter for any signs of damage, such as frayed wires, cracks, or discoloration. If damage is observed, discontinue use immediately and replace the cord.

## 5. TROUBLESHOOTING

---

If you encounter issues with your PDEEY 15W Power Cord Replacement, refer to the following troubleshooting steps:

Problem	Possible Cause	Solution
Device not powering on.	Power cord not fully connected.	Ensure the DC barrel tip is fully inserted into the device's power port and the wall plug is firmly in the outlet.
Device not powering on.	Wall outlet is not active.	Test the wall outlet with another working appliance to confirm it has power.
Device powers on but frequently disconnects.	Loose connection at the device port.	While the connection should be snug, some devices or cords may have a slightly looser fit. Ensure the device is placed in a stable location where the cord is not easily disturbed. If the issue persists, consider contacting support.
Adapter feels hot.	Normal operation or overload.	A slight warmth is normal during operation. If the adapter is excessively hot to the touch or emits a burning smell, unplug it immediately and discontinue use. This may indicate an internal fault or an incompatible device.
Power cord is visibly damaged.	Physical damage.	Do not use a damaged power cord. Replace it with a new one to prevent electrical hazards.

## Replacement for 15W Power Cord

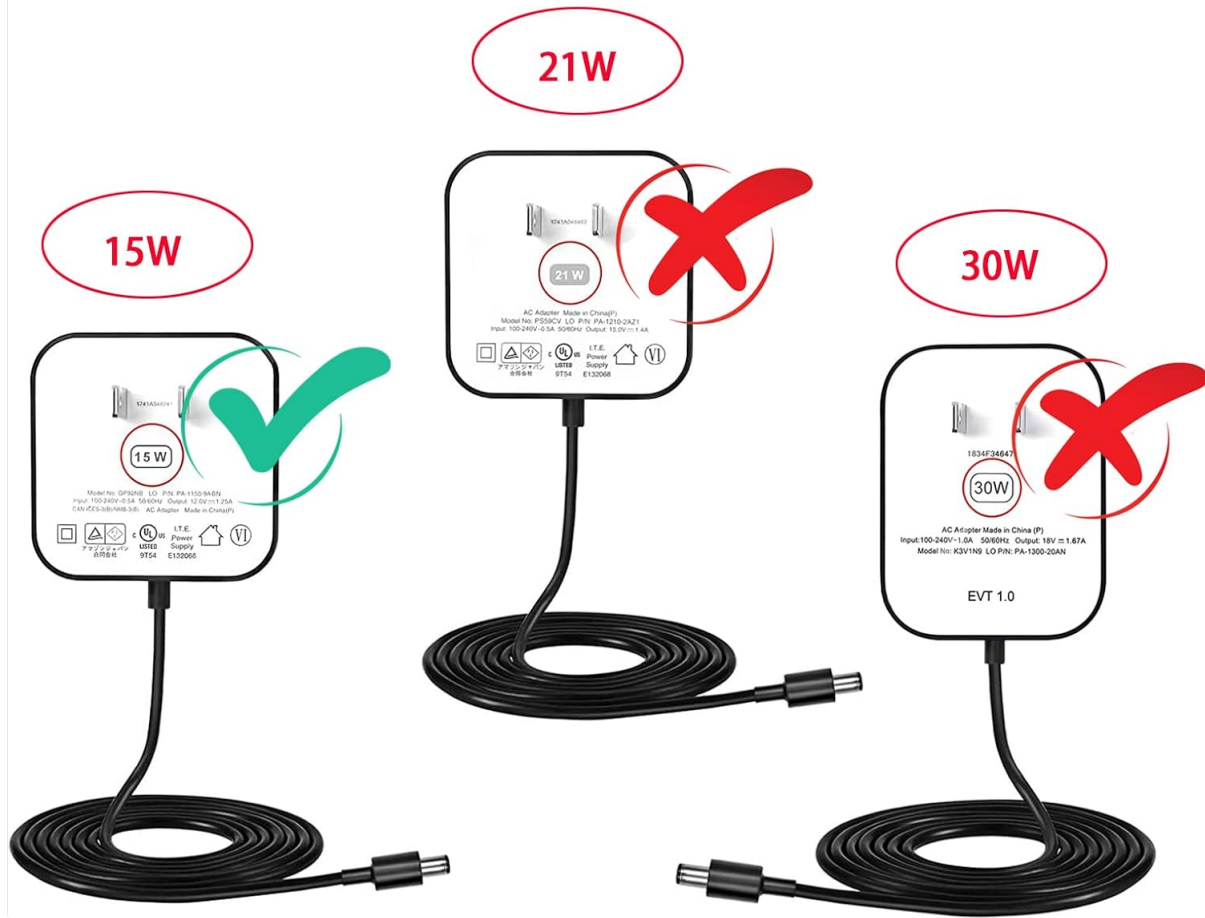

Image: A visual comparison highlighting the correct 15W adapter for compatibility, differentiating it from 21W and 30W alternatives.

## 6. SPECIFICATIONS

Detailed specifications for the PDEEY 15W Power Cord Replacement:

- **Brand:** PDEEY
- **Model:** 15W Power Cord Replacement
- **Wattage:** 15 watts
- **Input Voltage:** 100-240 Volts (AC)
- **Cable Length:** 5 feet (approximately 1.5 meters)
- **Connector Type:** DC Barrel Connector
- **Color:** Black
- **Compatible Devices:** Amazon Echo Dot (3rd, 4th, 5th Gen, Kids Edition), Echo Spot, TV Cube, Echo Show 5, Dot with Clock Speakers, Echo Pop.
- **Included Components:** 1 adapter
- **Special Features:** Portable, Travel-friendly
- **Item Weight:** 2.4 ounces

- **Package Dimensions:** 3.62 x 2.56 x 1.73 inches



Image: A detailed view of the PDEEY 15W power adapter, showing its specifications label and barrel connector.

## 7. WARRANTY AND SUPPORT

---

For information regarding warranty coverage, returns, or technical support for your PDEEY 15W Power Cord Replacement, please refer to the seller's policies on the platform where the product was purchased. You may also visit the official PDEEY store for additional product information and contact options:

[Visit the PDEEY Store on Amazon](#)

Please retain your proof of purchase for any warranty claims or support inquiries.

