

## SpeaKa Professional SP-WMM-200S

# SpeaKa Professional SP-WMM-200S Monitor Wall Mount Instruction Manual

Model: SP-WMM-200S

## 1. INTRODUCTION

This manual provides comprehensive instructions for the safe and efficient installation, operation, and maintenance of your SpeaKa Professional SP-WMM-200S Monitor Wall Mount. Please read this manual thoroughly before installation and retain it for future reference. This wall mount is designed for monitors and TVs ranging from 13 to 30 inches.

## 2. PRODUCT FEATURES

- Aluminum monitor/TV wall mount with multiple articulation points.
- Supports displays from 13 inches (33 cm) to 30 inches (76.2 cm).
- Graduated articulations prevent sudden movements, enhancing stability.
- Lockable design with a rotary knob to secure the arm position.
- Retractable wall plate for quick installation and removal.
- Anti-slip knobs for quick tilt and locking adjustments.

## 3. SPECIFICATIONS

Specification	Detail
Brand	SpeaKa Professional
Model Number	SP-WMM-200S (also SP-9493252)
Compatible Screen Size	13 - 30 inches (33 - 76.2 cm)
Material	Aluminum

Specification	Detail
Mounting Type	Wall Mount
Movement Type	Swivel, Tilt
Color	Various (typically black/dark grey)

## 4. SETUP AND INSTALLATION

**Important Safety Notice:** Ensure the mounting surface can safely support the combined weight of the mount and your display. Professional installation is recommended if you are unsure about wall types or mounting procedures. Always use appropriate safety gear.

### 4.1. Package Contents

Verify that all components are present before beginning installation. Refer to the product packaging for a detailed list of included hardware.

### 4.2. Tools Required (Not Included)

- Drill
- Drill bits appropriate for wall type (wood, concrete, brick)
- Stud finder (for wood stud walls)
- Level
- Phillips head screwdriver
- Pencil
- Measuring tape

### 4.3. Installation Steps

1. **Prepare the Wall:** Identify the desired mounting location. For wood stud walls, use a stud finder to locate the center of a stud. For concrete or brick walls, ensure there are no hidden pipes or electrical wires.
2. **Mark Drilling Points:** Hold the wall plate of the mount against the wall at the desired height and use a level to ensure it is straight. Mark the drilling points through the holes on the wall plate with a pencil.
3. **Drill Holes:** Drill pilot holes at the marked locations. The size of the drill bit will depend on the wall anchors provided with your mount. Insert wall anchors if required for your wall type.
4. **Attach Wall Plate:** Secure the wall plate to the wall using the provided screws and a Phillips head screwdriver. Ensure it is firmly attached and level.
5. **Attach Monitor Plate to Display:** Carefully place your monitor face down on a soft, clean surface. Attach the VESA plate (the part that connects to the monitor) to the back of your display using the appropriate screws from the hardware kit. Ensure the screws are tightened securely but do not overtighten.
6. **Mount Display to Wall Plate:** With assistance, carefully lift the display with the attached VESA plate and hook it onto the wall plate. The retractable design allows for easy engagement. Ensure the display is securely seated.
7. **Secure Display:** Use the locking mechanism (e.g., screws or safety pins) to secure the display to the wall plate, preventing accidental dislodgement.



Figure 1: Front view of the SpeaKa Professional SP-WMM-200S Monitor Wall Mount, showing the VESA plate and wall attachment.



Figure 2: Angled view of the SpeakKa Professional SP-WMM-200S Monitor Wall Mount, highlighting the articulation points.

## 5. OPERATING INSTRUCTIONS

The SpeakKa Professional SP-WMM-200S wall mount offers flexible positioning for your display.

### 5.1. Adjusting Tilt

To adjust the vertical tilt angle of your display, loosen the anti-slip knob located on the tilt mechanism. Adjust the display to the desired angle, then tighten the knob firmly to secure it in place. The graduated articulations help maintain stability during adjustment.



Figure 3: Side view of the mount, illustrating the tilt adjustment mechanism with its anti-slip knob.

## 5.2. Adjusting Swivel

To adjust the horizontal swivel angle of your display, gently rotate the display to the left or right. The mount's design allows for smooth pivoting. If the movement is too loose or too stiff, check the rotary knob on the arm and adjust its tension as needed. Tighten the rotary knob to lock the arm in the desired swivel position.



Figure 4: Front view of the VESA plate, which attaches to the monitor, showing the connection point to the articulating arm.

## 6. MAINTENANCE

Regular maintenance ensures the longevity and safe operation of your wall mount.

- **Cleaning:** Wipe the mount with a soft, dry cloth. Do not use abrasive cleaners or solvents, as they may damage the finish.
- **Check Connections:** Periodically check all screws and bolts to ensure they remain tight. Loose connections can lead to instability or damage.

- **Inspect for Wear:** Examine the mount for any signs of wear, damage, or corrosion. If any issues are found, discontinue use and contact customer support.

## 7. TROUBLESHOOTING

---

If you encounter issues with your SpeaKa Professional SP-WMM-200S wall mount, refer to the following common problems and solutions:

- **Mount feels loose or unstable:**
  - Ensure all wall mounting screws are securely tightened.
  - Verify that the display is properly seated and locked onto the wall plate.
  - Check the tension of the articulation points and rotary knobs; tighten as necessary.
- **Display is not level:**
  - Loosen the VESA plate screws slightly, adjust the display to be level, then re-tighten.
  - Ensure the wall plate itself was installed level. If not, minor adjustments may be possible, or re-installation might be required.
- **Difficulty adjusting tilt or swivel:**
  - Ensure the anti-slip knobs and rotary knobs are sufficiently loosened before attempting to adjust.
  - Do not force adjustments; if movement is stiff, check for obstructions or overtightened locking mechanisms.

## 8. WARRANTY AND SUPPORT

---

The SpeaKa Professional SP-WMM-200S Monitor Wall Mount typically comes with a 1-year warranty for parts availability. Please refer to your purchase documentation for specific warranty terms and conditions.

For technical support, missing parts, or warranty claims, please contact your retailer or the SpeaKa Professional customer service department. Keep your proof of purchase handy when contacting support.

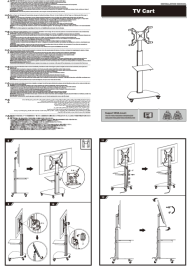
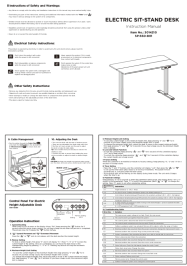
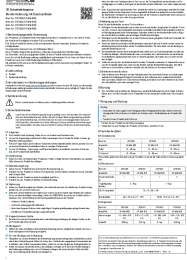
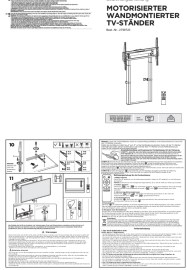
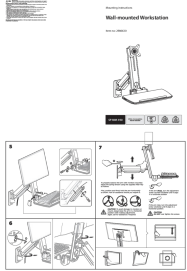
	<p><a href="#">SpeaKa Professional SP-TVC-500 TV Cart Installation Manual</a></p> <p>Step-by-step installation guide for the SpeaKa Professional SP-TVC-500 TV cart, including safety precautions, parts list, and assembly instructions for optimal setup.</p>
	<p><a href="#">SpeaKa Professional Electric Sit-Stand Desk Instruction Manual - Model 3014210</a></p> <p>Comprehensive instruction manual for the SpeaKa Professional electric sit-stand desk (Model 3014210, SP-SSD-B01), covering safety, operation, troubleshooting, and assembly instructions.</p>
	<p><a href="#">SpeaKa Professional Monitor Holder with Gas Pressure Spring: Safety, Use, and Technical Data</a></p> <p>Detailed safety instructions, intended use, handling, installation, maintenance, and technical specifications for SpeaKa Professional gas spring monitor holders (models SP-MM-900, SP-MM-910, SP-MM-920, SP-MM-930). Includes table specifications and warnings.</p>
	<p><a href="#">SpeaKa Professional SP-TVC-900 Motorized TV Stand: User Manual &amp; Setup Guide</a></p> <p>Comprehensive user manual for the SpeaKa Professional SP-TVC-900 motorized TV stand. Learn how to install, operate, pair the remote, and troubleshoot this VESA-compatible, height-adjustable TV mount supporting up to 100-inch screens and 120kg.</p>
	<p><a href="#">SpeaKa Professional SP-MM-950 Wall-mounted Workstation Mounting Instructions</a></p> <p>Detailed mounting instructions for the SpeaKa Professional SP-MM-950 Wall-mounted Workstation, providing step-by-step guidance for assembly and installation.</p>



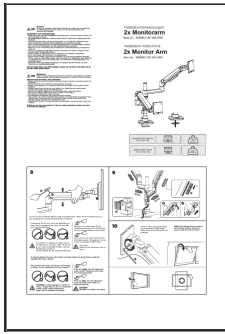

[SpeaKa Professional SP-MM-980 Dual Monitor Arm Installation Guide](#)

Comprehensive installation instructions for the SpeaKa Professional SP-MM-980 dual monitor arm. Learn how to safely mount, adjust, and balance your monitors for optimal ergonomic setup. Supports VESA 75x75 and 100x100, with a weight capacity of 2-20 kg per arm.