

UNIWA F100

UNIWA F100 4G LTE Zello Walkie Talkie User Manual

Model: F100

INTRODUCTION

This manual provides comprehensive instructions for the safe and efficient operation of your UNIWA F100 4G LTE Zello Walkie Talkie. The F100 is a rugged smartphone designed for reliable communication, featuring 4G LTE connectivity, Zello Push-to-Talk (PoC) functionality, a durable IP54 waterproof rating, and an Android 10.0 operating system. Please read this manual thoroughly before using the device to ensure proper functionality and to prevent damage.

SAFETY INFORMATION

- Do not expose the device to extreme temperatures, direct sunlight, or excessive moisture beyond its IP54 rating.
- Use only UNIWA approved batteries and chargers. Unauthorized accessories may damage the device and void the warranty.
- Avoid disassembling or modifying the device. Repairs should only be performed by authorized service personnel.
- Keep the device away from medical devices, as it may interfere with their operation.
- Dispose of the device and its battery responsibly according to local regulations.

PACKAGE CONTENTS

Verify that all items are present in the package:

- UNIWA F100 Smartphone
- 3800mAh Battery
- USB Charging Cable
- Power Adapter
- User Manual (this document)
- SIM Ejector Tool (if applicable)

DEVICE LAYOUT

Familiarize yourself with the physical components of your UNIWA F100.

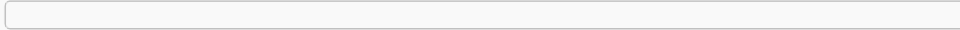

Image Description: This image displays the front of the UNIWA F100 smartphone. It features a 4-inch display, a front-facing camera located above the screen, and an earpiece for calls. The design is robust, indicating its rugged nature.

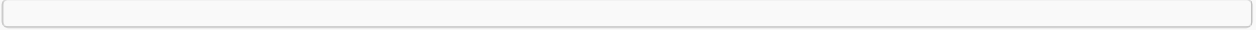

Image Description: This image shows the back and side profile of the UNIWA F100. Visible features include the dual rear cameras, a powerful speaker grille, and various side buttons. Notably, the dedicated SOS button and the Push-to-Talk (PTT) button for Zello communication are highlighted on the side.

- **Front:** 4-inch display, Front Camera, Earpiece.
- **Back:** Dual Rear Cameras, LED Flash, Loudspeaker.
- **Right Side:** Power Button, Volume Up/Down Buttons, Dedicated SOS Button.
- **Left Side:** Dedicated Push-to-Talk (PTT) Button for Zello.
- **Top:** 3.5mm Audio Jack (under protective flap).
- **Bottom:** USB-C Charging Port (under protective flap), Microphone.

SETUP

1. Inserting SIM/SD Card

1. Locate the SIM/SD card tray on the side of the device (usually under a protective flap).
2. Use the provided SIM ejector tool to open the tray.
3. Carefully place your Nano-SIM card(s) and/or microSD card into the designated slots. Ensure correct orientation.
4. Gently push the tray back into the device until it clicks into place. Ensure the protective flap is securely closed to maintain IP54 rating.

2. Battery Installation and Charging

1. If the battery is not pre-installed, remove the back cover of the device.
2. Align the battery contacts with the terminals inside the battery compartment and gently press the battery into place.
3. Replace the back cover, ensuring it is securely fastened.
4. Connect the USB charging cable to the device's USB-C port and the power adapter. Plug the adapter into a wall outlet.
5. Allow the device to charge fully before first use. The charging indicator will show progress.

3. Initial Power On

1. Press and hold the Power button (located on the right side) until the UNIWA logo appears on the screen.
2. Follow the on-screen prompts to complete the initial setup, including language selection, Wi-Fi connection, and Google account setup.

OPERATING INSTRUCTIONS

1. Basic Phone Functions

- **Making Calls:** Open the Phone app, dial the number, and press the call icon.
- **Sending Messages:** Open the Messages app, tap to compose a new message, enter recipient and text, then send.
- **Internet Access:** Connect to Wi-Fi or enable mobile data through Settings > Network & Internet.

2. Zello Walkie Talkie (PoC) Operation

The UNIWA F100 is optimized for Push-to-Talk (PoC) communication using the Zello application.

1. Ensure the Zello app is installed and configured with your account.
2. Open the Zello app and select the desired channel or contact.
3. Press and hold the dedicated PTT button on the left side of the device to transmit your voice. Release the button to listen.
4. Ensure you have an active internet connection (4G LTE or Wi-Fi) for Zello to function.

Your browser does not support the video tag.

Video Description: This video demonstrates the operation of the Zello Push-to-Talk (PTT) feature on the UNIWA F100. It shows a user pressing the dedicated PTT button on the side of the device to initiate voice transmission and releasing it to receive audio, illustrating seamless walkie-talkie communication over 4G LTE.

3. Camera Usage

- Open the Camera app from the home screen or app drawer.
- Tap the shutter button to take a photo.
- Switch between front and rear cameras using the camera switch icon.
- Select video mode to record videos.

4. NFC Functionality

- Enable NFC in Settings > Connected devices > Connection preferences > NFC.
- To use NFC for payments or data transfer, hold the back of the device near a compatible NFC reader or tag.

5. SOS Button

- The dedicated SOS button can be configured in Settings to send emergency messages or make calls to pre-set contacts.
- Press and hold the SOS button for a few seconds to activate the emergency function.

MAINTENANCE

1. Cleaning the Device

- Use a soft, lint-free cloth to wipe the screen and body of the device.
- For stubborn marks, slightly dampen the cloth with water or a screen cleaner. Avoid harsh chemicals.
- Ensure all port covers are securely closed before cleaning to maintain water resistance.

2. Battery Care

- Avoid fully discharging the battery frequently. Charge it before it drops below 20%.
- Do not expose the battery to extreme heat or cold.
- If the device will not be used for an extended period, charge the battery to about 50% before storing.

3. Water and Dust Resistance (IP54)

- The UNIWA F100 is rated IP54, meaning it is protected from limited dust ingress and from water spray from any direction.
- This rating does not imply full waterproofing. Do not submerge the device in water.
- Ensure all port covers and the back cover are securely closed to maintain the IP54 rating.
- If the device gets wet, wipe it dry immediately with a clean cloth.

4. Software Updates

- Regularly check for system updates in Settings > System > System update.
- Updates provide performance improvements, security patches, and new features.
- Ensure the device has sufficient battery life and a stable internet connection before performing an update.

TROUBLESHOOTING

Problem	Possible Solution
Device won't power on	Ensure battery is charged. Press and hold the Power button for 10-15 seconds.
No network signal	Check SIM card insertion. Verify mobile data is enabled. Try restarting the device.
Zello PTT not working	Ensure active internet connection. Check Zello app settings and login status. Verify PTT button mapping.
Battery drains quickly	Close unused apps. Reduce screen brightness. Disable unnecessary features like Wi-Fi/Bluetooth when not in use.
Device is slow/unresponsive	Clear cache of apps. Restart the device. Consider a factory reset (backup data first).

SPECIFICATIONS

- **Model:** UNIWA F100
- **Operating System:** Android 10.0
- **Display:** 4.0-inch IPS Touchscreen
- **RAM:** 2GB
- **ROM:** 16GB (expandable via microSD)
- **Network:** 4G LTE, 3G WCDMA, 2G GSM
- **Cameras:** Dual Rear Camera, Front Camera
- **Battery:** 3800mAh (Removable)
- **Connectivity:** Wi-Fi, Bluetooth, GPS, NFC
- **Special Features:** Zello PoC, SOS Button, IP54 Water/Dust Resistance
- **Dimensions:** (Approximate, specific dimensions not provided in input)
- **Weight:** (Approximate, specific weight not provided in input)

WARRANTY AND SUPPORT

Your UNIWA F100 device comes with a standard manufacturer's warranty. Please refer to the warranty card included in your package for specific terms and conditions, including warranty period and coverage details. For technical support, troubleshooting assistance, or warranty claims, please contact UNIWA customer service through the contact information provided on the official UNIWA website or your purchase receipt. When contacting support, please have your device model (F100) and serial number ready.

Online Resources: For the latest drivers, software updates, and frequently asked questions, visit the official UNIWA support website.

© 2025 UNIWA. All rights reserved.
This manual is subject to change without notice.

Related Documents - F100



[UNIWA F41 Rugged Android Smart Public Network Intercom User Manual](#)

Comprehensive user manual for the UNIWA F41, a rugged Android smart public network intercom designed for industries requiring instant communication, featuring PoC technology, GPS, and durable construction.



Thank you for choosing UNIWA V1000 4G senior phone, it mainly support American 4G bands, not support European 4G bands currently. But it supports 2G(GSM) /3G(WCDMA) global bands.
It is unlocked (SIM free) and take single Nano SIM card. If any question during use, please email us, we will try our best to help you.
✉ Our after-sales email:
2850699288@qq.com

Safety Instructions

This phone is not water-resistant, keep it dry.
To prevent possible hearing damage, do not listen at high volume level for long time.
Exercise caution when holding your device.

Table of Contents

► External features.....	01
► Install SIM card	02
► Install the battery.....	02
► Turn on/off the phone.....	03
► Unlock keypad	03
► Charging	03
► Save contact	04
► Make call	04
► Answer call	05
► Send and receive SMS	05
► Multimedia Settings.....	06
► Bluetooth/Application.....	07
► Settings	07
► Speed Dial	10
► SOS Settings.....	10
► Torch Light	11
► Product specifications	11

External features



- | | |
|----------------------|------------------------|
| ① LED indicator | ⑩ Charging dock |
| ② Earpiece | ⑪ Hang up key |
| ③ Torch | ⑫ Keypad unlock button |
| ④ Volume +/- | ⑬ Return key |
| ⑤ Torch button | ⑭ SOS button |
| ⑥ Menu key | ⑮ Camera |
| ⑦ Dial key | ⑯ Headphone port |
| ⑧ OK key | ⑰ Micro USB |
| ⑨ Navigation key | ⑱ Dock connector |
| ⑲ Charging indicator | |

Insert SIM card

Open the back cover from the bottom right corner of the phone (see figure1) and insert your SIM card (see figure 2).



Install the battery

Before starting up, please tear off the insulating sticker on the battery contacts, then install the battery and cover the back cover, please see the figure below.

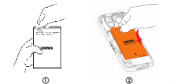

-02

Turn on/off the phone

Long press **Power** for 5 seconds, the phone will turn on/off.

Unlock keypad

Unlock button is on the right side of the phone, you can slide it up to unlock keypad. If the unlock button is already of unlocked state, you can slide it again to unlock.



Charging

When the battery is low, please charge the phone in time. There are 2 ways for charging:

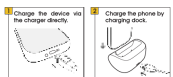

-03

When charging, the indicator on the dock will get red. If the phone is not placed properly with the dock, the indicator will display green. Please reposition the phone until it is well placed.

Save contact

For frequent contacts, you can save their phone number in the contact list by step:

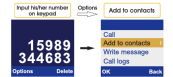

Make call

Enter the phone number on keypad, and then press **Call** to dial.

You can press **Handsfree** to turn on "handsfree" mode. See figure on the right:



-04

Answer call

When coming call, press **Call** key to answer or press **Call** to hang up.

If there is a missed call or unread text message, the indicator on the phone will light up, you can see call history through "Call logs" menu.



Send and receive SMS

You can press **Message** button to write SMS under "Message" menu. When you receive SMS, please view it in the "Inbox". Under "Message" menu, you can set "Broadcast message" and "Voice mail server". See figure below:

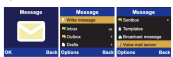

-05

Multimedia Settings Audio and Camera

In "Multimedia" menu you can see sub-menu "Camera", "DV Audio Video", "FM radio", see figure on the right:

You can use **Left** key to move the cursor and press **Enter** key to enter photo mode. And then press **Left** key to take photo. Using the same steps, you can use DV, Video, Audio functions.

Regarding FM radio, when you enter the menu, need use "auto search and save" in the Options menu to find out nearby radio stations. See figure below:



-06

Bluetooth/Application

Under "Application" menu you can see sub-menu "Calendar, Calculator, Recorder, Clock, STK, Unit conversion, Bluetooth, Internet, My text".

Regarding "Bluetooth" function, you can press **Bluetooth** key to activate it and then select "Paired device" to search for nearby Bluetooth device. See figure below:



Settings

In "Settings" menu, you can see sub-menu "Phone settings, Call settings, Profiles, Display, Security, Connections".



-07

Phone settings

Time & date, language settings, shortcut settings, auto power on/off, restore factory settings.

In "Phone settings" menu, you can restore the phone to factory settings. Please backup your data before restore factory setting, the data will be lost after restore factory. The default restore factory password is "0000".

Call settings

Call divert, Call waiting, Call barred, Hide ID, others. See figure on the right:



Profiles

Normal, Silent, Meeting, Indoor, Outdoor. If you want to change "Profiles" setting, press **Profiles** key to enter "Options" menu, and then press **Profiles** key to select "Customize". You will see "Rename, Ring settings, Adjust volume, Ring type, Other alert ring". See figure below:

-08



UNIWA V1000 4G Senior Phone User Manual

User manual for the UNIWA V1000 4G senior phone, detailing features, setup, operation, and specifications. Supports global 2G/3G bands and US 4G bands.

<div><div><div><div><div><div>Back</div><div>Home</div><div>Applications</div></div><div><div>Home</div><div>Back</div><div>Recent</div></div><div><div>Back</div><div>Home</div><div>Recent</div></div></div><div><div>Back</div><div>Home</div><div>Recent</div></div><div><div>Back</div><div>Home</div><div>Recent</div></div></div><div>You can also press the volume +/- keys on the left side of the phone to adjust volume.</div><div><div>► Display</div><div>Animation effect, Wallpaper settings, Screen saver settings, Contrast, keypad backlight time, Auto keypad lock.</div><div><div>► Security</div><div>PIN Modify PIN2, Phone locked, Modify the cellphone passwords, Privacy, Fixed Dialing number, blacklist.</div><div>In order to avoid forgetting password and lock the phone screen, we do not recommend user to set password. Please set and keep password carefully if you use this function.</div><div><div>► Connections</div><div>Network account, Data service, Data Roaming, Network selection, Network type, VoLTE.</div></div></div><div>- 09</div></div><div><div><div>Speed Dial</div><div>►</div></div><div>For some frequent contacts, "Speed dial" can dial them quickly. Key 2-9 can be set as speed dial keys. See figure below:</div><div><div><div><div>Speed Dial</div><div>Speed Dial</div><div>Speed Dial</div><div>Speed Dial</div><div>Speed Dial</div><div>Speed Dial</div><div>Speed Dial</div><div>Speed Dial</div><div>Speed Dial</div><div>Speed Dial</div></div><div><div>Back</div><div>Back</div><div>Back</div><div>Back</div><div>Back</div><div>Back</div><div>Back</div><div>Back</div><div>Back</div><div>Back</div></div></div></div><div>After the frequent contact is set, press the corresponding key for 5 seconds, the phone will call the corresponding person automatically.</div><div><div><div>SOS Settings</div><div>►</div></div><div>When user is in an emergency, he/she can press  button on the back of the phone to call and send SMS to pre-set emergency contacts by pressing  button for 5 seconds. You can pre-set 5 contacts and 1 SOS message. See figure below:</div><div><div><div>SOS Setting</div><div>Set SOS Numbers</div><div>SOS Message</div></div><div><div>Set SOS Numbers</div><div>Set SOS Numbers</div><div>Set SOS Numbers</div><div>Set SOS Numbers</div><div>Set SOS Numbers</div><div>Set SOS Numbers</div><div>Set SOS Numbers</div><div>Set SOS Numbers</div><div>Set SOS Numbers</div><div>Set SOS Numbers</div></div><div><div>SOS Message</div><div>SOS Message</div><div>SOS Message</div><div>SOS Message</div><div>SOS Message</div><div>SOS Message</div><div>SOS Message</div><div>SOS Message</div><div>SOS Message</div><div>SOS Message</div></div></div></div><div>Torch light</div><div>You can slide up/down key on left side of the phone to turn on/off torch light.</div><div><div><div>Product specifications</div><div>►</div></div><div><table><tr><td>Model No.</td><td>UNIWA V1000</td></tr><tr><td>Dimensions</td><td>122.5*56.3*15.1mm</td></tr><tr><td>Weight</td><td>11.4g (include battery)</td></tr><tr><td>Material</td><td>Plastic</td></tr><tr><td>Style</td><td>Bar</td></tr><tr><td>Service</td><td>Unlocked</td></tr><tr><td>SIM</td><td>Single Nano SIM card style standby</td></tr><tr><td>Band</td><td>2G: GSM 850/900/1800/1900MHz 3G: WCDMA 850/900/1700/1900/2100MHz 4G: FDD-LTE R8/848/8/1812813/877386</td></tr></table></div><div>- 11</div></div><div><div><table><tr><td>Phonebook</td><td>1000</td></tr><tr><td>Number</td><td>RGB</td></tr><tr><td>Message</td><td>SMS/MMS</td></tr><tr><td>USB Port</td><td>Micro USB</td></tr><tr><td>Earphone Port</td><td>3.5mm audio jack</td></tr><tr><td>Speaker</td><td>2030 BOX loudspeaker</td></tr><tr><td>Screen</td><td>2.31 Inch QVGA TFT display screen,320*240px</td></tr><tr><td>Camera</td><td>Single camera, 0.3MP back camera</td></tr><tr><td>Audio formats</td><td>MP3</td></tr><tr><td>Video formats</td><td>MP4 etc.</td></tr><tr><td>Radio</td><td>Wireless radio</td></tr><tr><td>SOS Function</td><td>Support preset 5 SOS emergency contacts and 1 emergency SMS</td></tr><tr><td>Torch</td><td>One key to turn on/off torch</td></tr></table></div><div>- 12</div></div><div><div><div><div>BT</div><div>V3.0</div></div><div><div>Battery</div><div>Removable 1700mAh Li-ion battery</div></div><div><div>Language</div><div>English, Arabic, French, Hindi, Indonesian, Malay, Portuguese, Russian, Spanish, Thai, Vietnamese, Italian, Polish, Czech, Greek, Hebrew, Czech, Polish, Swedish, Ukrainian, Dutch, Simplified/Traditional Chinese.</div></div><div><div>Accessories</div><div>1* Battery 1* Charger 1* Charging dock 1* User manual</div></div></div><div><div><div>EC REP</div><div>Proline GmbH Brehmestr. 56, 40229 Düsseldorf Germany</div></div><div><div>CE</div><div>RoHS</div><div>WEEE</div></div></div><div>- 13</div></div></div></div></div>	Model No.	UNIWA V1000	Dimensions	122.5*56.3*15.1mm	Weight	11.4g (include battery)	Material	Plastic	Style	Bar	Service	Unlocked	SIM	Single Nano SIM card style standby	Band	2G: GSM 850/900/1800/1900MHz 3G: WCDMA 850/900/1700/1900/2100MHz 4G: FDD-LTE R8/848/8/1812813/877386	Phonebook	1000	Number	RGB	Message	SMS/MMS	USB Port	Micro USB	Earphone Port	3.5mm audio jack	Speaker	2030 BOX loudspeaker	Screen	2.31 Inch QVGA TFT display screen,320*240px	Camera	Single camera, 0.3MP back camera	Audio formats	MP3	Video formats	MP4 etc.	Radio	Wireless radio	SOS Function	Support preset 5 SOS emergency contacts and 1 emergency SMS	Torch	One key to turn on/off torch	<div><div>UNIWA V202T 4G Flip Feature Phone User Manual</div><div>User manual for the UNIWA V202T 4G flip feature phone, covering unboxing, basic functions, contact management, settings, SOS emergency calls, product specifications, and technical support.</div></div> <div><div><div></div><div>UNIWA F400 User Manual: Smart Handheld Intercom PDA</div><div>Comprehensive user manual for the UNIWA F400, an IP65-rated Android smart handheld intercom PDA. Features include PTT communication, GPS, durable design, 4350mAh battery, and Android 15 OS. Details on setup, functions, maintenance, and specifications. Document metadata: Paper: 100G coated paper, Printing: Double-sided printing, four-color printing, Folding method: Spiral fold, Size: 87*150mm.</div></div></div>
Model No.	UNIWA V1000																																										
Dimensions	122.5*56.3*15.1mm																																										
Weight	11.4g (include battery)																																										
Material	Plastic																																										
Style	Bar																																										
Service	Unlocked																																										
SIM	Single Nano SIM card style standby																																										
Band	2G: GSM 850/900/1800/1900MHz 3G: WCDMA 850/900/1700/1900/2100MHz 4G: FDD-LTE R8/848/8/1812813/877386																																										
Phonebook	1000																																										
Number	RGB																																										
Message	SMS/MMS																																										
USB Port	Micro USB																																										
Earphone Port	3.5mm audio jack																																										
Speaker	2030 BOX loudspeaker																																										
Screen	2.31 Inch QVGA TFT display screen,320*240px																																										
Camera	Single camera, 0.3MP back camera																																										
Audio formats	MP3																																										
Video formats	MP4 etc.																																										
Radio	Wireless radio																																										
SOS Function	Support preset 5 SOS emergency contacts and 1 emergency SMS																																										
Torch	One key to turn on/off torch																																										

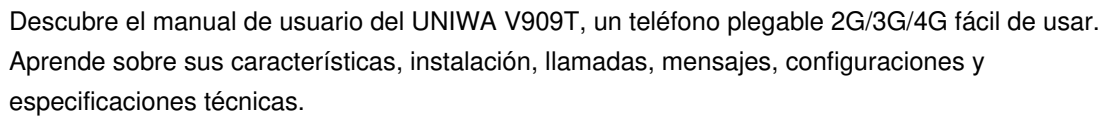
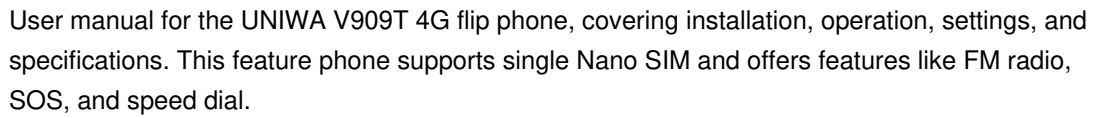

Basic Info	Model No.	
	Display (Inch/Resolution)	
	Color	
Net-work	2G bands	
	3G bands	
	4G bands	
	5G bands	
Body	Screen	
	Dimensions	
	Weight	
	Build/Material	
Display	Type	
	Size	
	Resolution	
Platform	Protection	
	Input (Number/Touch/Type)	
	OS	
Memory	Chipset	
	RAM	
	Storage	
Memory	OS and App	
	Photo/Video quality	
	Pixel	
Battery	mAh	
	Type	
	Charging	
Connectivity	Working time	
	Stand-by time	
	Wi-Fi	
	BT	
	GPS	
Camera	NFC	
	External port	
	Flash	
Reliability	USB	
	Material of	
	Drop proof	
Reliability	Shockproof	

Basic Info Network Body Display Platform Memory Battery Comms Reliability Model
No. Style Bar/Flip/ ... OS function Torch ACCESSORIES Battery USB cable Charger
User manual PTT Headset Clip Dock UNIWA **F100** IP54 Android 10.0 Bar
135*69.5*21.5mm 260g PC TPU Black Multi-languages CTIVITY 4.0 inch WVGA...
lang:en **score:17** filesize: 219.29 K page_count: 16 document date: 2022-05-23

lang:es score:8 filesize: 441.94 K page count: 160 document date: 2021-10-27

Page 3 of 200