

## AMZSEA AMZSEA-ORANGE

# AMZSEA EL-50448 Orange TPMS Relearn Tool User Manual

Model: AMZSEA-ORANGE | Brand: AMZSEA

## 1. INTRODUCTION

This manual provides detailed instructions for the proper use and maintenance of the AMZSEA EL-50448 Orange TPMS Relearn Tool. This device is designed to activate and relearn Tire Pressure Monitoring System (TPMS) sensors in compatible General Motors (GM) vehicles manufactured between 2006 and 2025. Adhering to these instructions will ensure accurate and efficient operation of the tool.

## 2. PRODUCT OVERVIEW

The EL-50448 is a handheld device used to activate individual TPMS sensors, facilitating the relearn procedure required after tire rotations, sensor replacements, or other maintenance activities. It operates on either 315MHz or 433MHz frequencies, making it compatible with a wide range of GM vehicles.

### 2.1 Components

- **TX Pilot Light:** Indicates when the tool is transmitting a signal.
- **LOWBAT Indicator:** Illuminates when the 9V battery needs replacement.
- **Operation Button:** Used to activate the TPMS sensor.
- **Battery Compartment:** Houses a 9V battery (not included).

# TPMS TIRE PRESSURE RESET TOOL



Figure 1: Front and back view of the EL-50448 tool with labeled components including TX pilot light, LOWBAT indicator, operation button, and 9V battery compartment.



Figure 2: The AMZSEA EL-50448 Orange TPMS Relearn Tool.

## 3. SETUP

### 3.1 Battery Installation

1. Locate the battery compartment cover on the back of the EL-50448 tool.
2. Remove the cover.
3. Insert a new 9V battery, ensuring correct polarity.
4. Replace the battery compartment cover securely.

**Note:** A 9V battery is required for operation and is not included with the tool. Ensure the battery is new and fully charged for optimal performance. If the LOWBAT indicator lights up during use, replace the battery.



Figure 3: The EL-50448 tool with its 9V battery compartment open, showing where to insert the battery.

## 4. OPERATING INSTRUCTIONS

The TPMS relearn procedure is necessary after tire rotations, sensor replacement, or module replacement to ensure accurate tire pressure readings. Follow these steps to activate and relearn your vehicle's TPMS sensors:

### 4.1 Entering TPMS Learn Mode

Before using the EL-50448 tool, your vehicle must be in TPMS learn mode. The method to enter this mode varies by vehicle model. Refer to your vehicle's owner's manual for specific instructions. Typically, this involves a sequence of ignition cycles, pressing the hazard light button, or using steering wheel controls. The vehicle's dashboard display will usually indicate 'Tire Relearn Start' or similar when in this mode.



Figure 4: Example of a vehicle dashboard indicating the 'Tire Relearn Start' message.

## 4.2 Activating TPMS Sensors

1. Ensure your vehicle is in TPMS learn mode.
2. Start with the **Left Front (LF)** tire. Hold the EL-50448 tool against the sidewall of the tire, near the valve stem.
3. Press and hold the operation button on the tool. The TX pilot light will illuminate, indicating transmission.
4. Continue holding the tool and button until the vehicle's horn sounds. This indicates successful activation of the sensor.
5. Proceed to the **Right Front (RF)** tire and repeat steps 2-4.
6. Next, move to the **Right Rear (RR)** tire and repeat steps 2-4.
7. Finally, move to the **Left Rear (LR)** tire and repeat steps 2-4.
8. After all four sensors are activated, the vehicle's horn may sound twice to confirm the completion of the relearn procedure.

**Important:** The body control module must read the sensor identification codes in the correct sequence (LF, RF, RR, LR) to determine the sensor location. The turn signal lights may illuminate to indicate the correct reading sequence.

# HOW TO USE IT

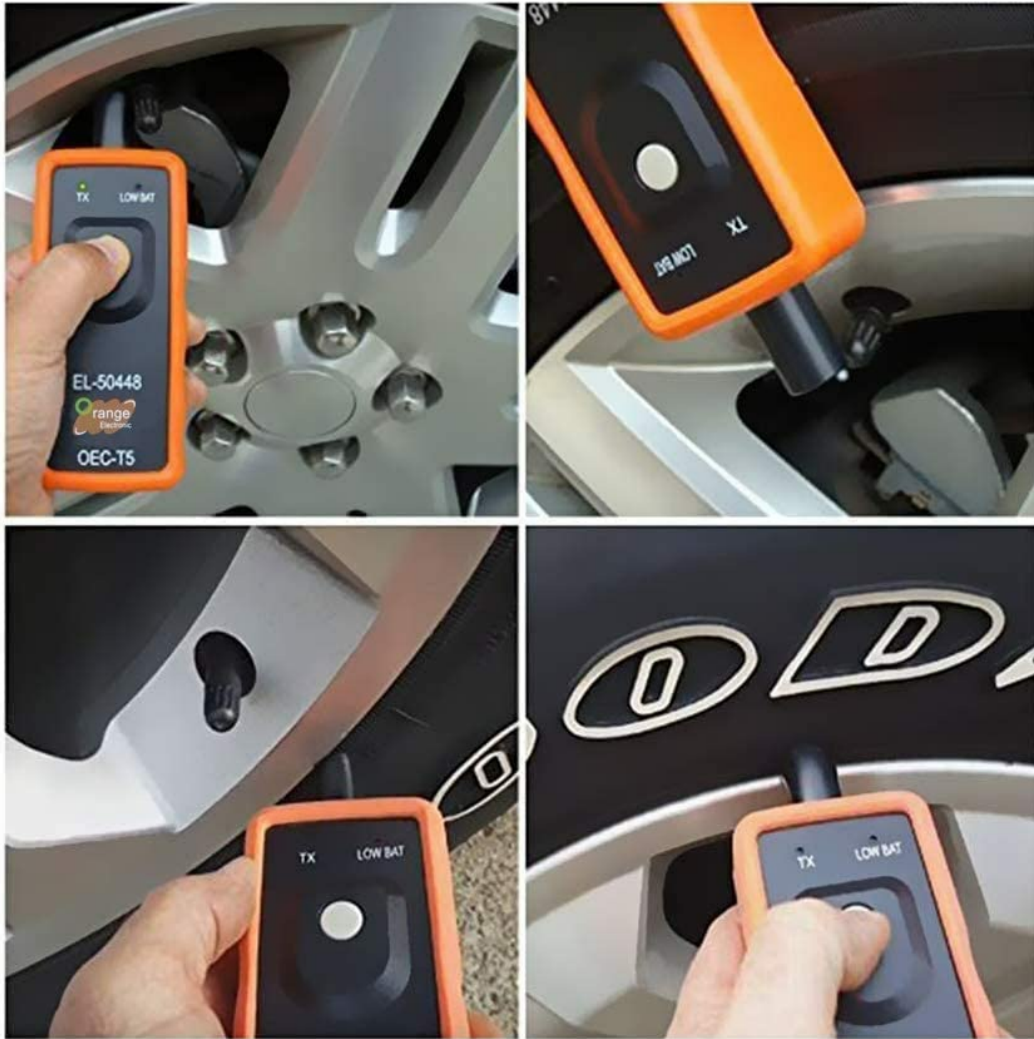

Figure 5: Step-by-step visual guide on positioning the EL-50448 tool near the tire valve stem and pressing the activation button.



Figure 6: Diagram illustrating the correct sequence for activating TPMS sensors (LF, RF, RR, LR).

## 5. MAINTENANCE

### 5.1 Battery Replacement

When the LOWBAT indicator light illuminates, the 9V battery needs to be replaced. Refer to Section 3.1 for

battery installation instructions.

## 5.2 Storage

Store the EL-50448 tool in a dry, cool place away from direct sunlight and extreme temperatures. Remove the battery if the tool will not be used for an extended period to prevent leakage.

---

## 6. TROUBLESHOOTING

- **Tool does not activate sensor / Vehicle horn does not sound:**
    - Ensure the vehicle is correctly in TPMS learn mode. Consult your vehicle's owner's manual.
    - Check the battery. If the LOWBAT indicator is on, replace the 9V battery. Even if not on, a weak battery can cause issues; try a new battery.
    - Ensure the tool is held firmly against the tire sidewall, close to the valve stem.
    - Verify vehicle compatibility (see Section 7.1).
  - **LOWBAT indicator is on:**
    - Replace the 9V battery immediately.
  - **Inconsistent activation:**
    - Ensure there are no strong electromagnetic interferences nearby.
    - Maintain a consistent distance and angle when holding the tool to each tire.
- 

## 7. SPECIFICATIONS

- **Model Number:** AMZSEA-ORANGE (EL-50448)
- **Brand:** AMZSEA
- **Product Dimensions:** 6.1 x 2.17 x 1.38 inches
- **Item Weight:** 0.14 Kilograms (approximately 4.97 ounces)
- **Operating Frequency:** 315MHz or 433MHz
- **Power Source:** 9V Battery (not included)
- **Measurement Accuracy:**  $\pm 2\%$  (for sensor activation, not pressure reading)
- **Style:** Modern
- **Date First Available:** November 4, 2021

### 7.1 Compatibility

The EL-50448 tool is compatible with General Motors (GM) series vehicles (including Buick, Cadillac, GMC) equipped with 315MHz or 433MHz TPMS sensors, manufactured from 2006 to 2025. For a detailed list of compatible models and years, please refer to the compatibility chart below.

## AVAILABLE MODELS

2006-2013	2010	2011	2012	2013	2014-2015	2016-2021
2006 Corvette	95	Astra	Camaro (VIN F)	Barina (5376837)	2014 Buick Lacrosse	2016 Acadia
2006 Nissan Frontier	Acadia, Enclave, OUT-LOOK, Traverse (VIN R/V)	Avalanche, Escalade, Suburban, Tahoe, Yukon (VIN C/K)	Canyon, Colorado (VIN S/T)	Camaro (VIN F) (3106)	2014 Chevy Volt	2016 Buick
2007 Cadillac Escalade	Allure, LaCrosse (VIN G)	Aveo, Barina (VIN S/T)	Caprice PPV	Caprice PPV (3105)	2014 Chevy SS	2016 Buick cascada
2007 GMC Yukon Denali	Antara, Captiva, Terrain, Winstorm	Buick Excelle	Captiva Sport	Captiva Sport (3101)	2014 Chevy Cruze	2016 Chevy lahoe
2007 NBS Silverado	Avalanche, Escalade, Suburban, Tahoe, Yukon (VIN C/K)	Buick Regal (China)	Chevrolet Cobalt (2809)	Cobalt (3107)	2014 Chevy Equinox	2016 Chevy Cruze
2008 Avalanche	Aveo, G3, Barina (VIN S/T)	Camaro (VIN F)	Colorado (Other IO), S10 (South America)	Colorado, Colorado 7, S10, Trallblazer (5392270)	2014 Chevy Silverado	2016 Chevy equinox
2008 Chevy Colorado	Buick Excelle	Canyon, Colorado (VIN S/T)	Corvette (VIN Y)	Combo-D	2014 Chevy Malibu	2016 Chevy Colorado
2008 chevy suburban z71	Buick Regal (China)	Caprice PPV	Cruze (2863)	Corvette (VIN Y) (3104)	2014 Chevy Traverse	2016 Chevrolet SS Sedan
2008 Chevrolet Impala	Camaro (VIN F)	Captiva Sport	CTS (VIN D)	Cruze (Global) (5377099)	2014 Chevy Impala	2016 Chevy traverse
2008 Chevrolet Tahoe	Canyon, Colorado (VIN S/T)	Corvette (VIN Y)	Equinox, Terrain (VIN L)	CTS (VIN D) (3085)	2014 Cadillac ATS	2016 Chevy Silverado
2008 GMC Sierra	Cobalt G5 (VIN A)	Cruze	Express, Savana (VIN G/H)	Encore (China) (5377162)	2014 Cadillac CTS	2016 Chevrolet Express 3500
2008 GMC Acadia	Corvette (VIN Y)	CTS (VIN D)	Impala (VIN W)	Encore, Jr ax (North America) (5377181)	2014 Cadillac ELR	2016 Cadillac XTS
2009 C6 Corvette	Cruze (China)	DTS (VIN K)	Insignia (2707)	Equinox, Terrain (VIN L) (3100)	2014 Camaro 1LS	2016 Equinox
2009 Corvette	Cruze	Equinox, Terrain (VIN L)	LaCrosse (China) (2710)	Excelle (5377155)	2014 GMC Sierra 1500	2016 GMC YUKON DENAU
2009 Chevrolet HHR	CTS (VIN D)	Express, Savana (VIN G/H)	LaCrosse (VIN G) (2709)	Express, Savana (VIN G/H) (3103)	2014 GMC Van	2016 GMC 2500HD Denali
2009 GMC Sierra 2500 duramax	Daewoo Lacetti	HHR (VIN A)	Malibu (VIN Z)	Impala (VIN W) (3102)	2014 Suburban	2016 GMC Canyon
2009 Impala	DTS (VIN K)	Impala (VIN W)	Opel Combo-D	Insignia (3098)	2014 Acadia	2016 GMC Terrain
2009 Silverado 2500 HD	Equinox, Terrain (VIN L)	Insignia	Optra, Viva (VIN J)	LaCrosse (China) (3095)	2014 Buick Encore	2016 Impala
2009 Sierra	Express, Savana (VIN G/H)	LaCrosse (China)	Orlando (2859)	LaCrosse (VIN G) (North America) (3090)	2014 Buick Enclave	2016 Chevrolet Trax
2010 Nissan GT-R	G6 (VIN Z)	Lucerne (VIN H)	Regal (China) (2711)	Malibu (China) (3096)	2015 Buick Regal	2016 Suburban
2011 Chevrolet Traverse	H3/H3T (VIN N)	Malibu (VIN Z)	Regal (VIN G) (2708)	Malibu (Europe, Other IO and South America) (2713)	2016 Buick Verano	2017 Caddy CTS
2011 Cadillac SRX	HHR (VIN A)	Orlando	Sierra, Silverado (VIN C/K)	Malibu (North America) (3093)	2015 Chevy Tahoe	2017 Chevy Silverado
2012 Cadillac SRX	Impala (VIN W)	Regal (VIN G)	Sonic (US/Canada) (2775)	Mokka, Jr ax, Tracker (Europe) (5377179)	2015 Chevy Impala	2017 Chevy Equinox
2012 Chevrolet Traverse LTZ	Insignia	Sierra, Silverado (VIN C/K)	SRX (VIN N)	Onix (3166)	2015 Chevy equinox	2017 Chevy Impala
2012 Chevy suburban	LaCrosse (China)	SRX (VIN N)	VE/W/M - Sedan, Ute, Sportwagon, Caprice, Lumina, VXR8	Orlando (Global) (5377530)	2015 Chevy Camaro	2017 Chevy 1500
2012 Chevy Tahoe	Lucerne (VIN H)	STS (VIN D)	Verano (US/Canada) (2816)	Regal (China) (3099)	2015 Chevy Cruze	2017 Chevy Cruze
2012 Chevy Truck	Malibu (VIN Z)	VE/W/M - Sedan, Ute, Sportwagon, Caprice, Lumina, Omega, VXR8	Volt (VIN R)	Regal (VIN G) (North America) (3089)	2015 Chevrolet Colorado	2017 Chevy Volt
2012 Chevy Caprice PPV	Opel/Vauxhall Astra	Volt	Zafira-C (2860)	Sierra, Silverado (VIN C/K)	2015 Chevy sonic	2017 Chevy Colorado
2012 GMC TERRAIN	Sierra, Silverado (VIN C/K)	2012	2013	Sonic (US/Canada) (5377994)	2015 Chevy Malibu	2017 Chevrolet Camaro
2012 GMC 2500HD	SKY, Solstice (VIN M)	Acadia, Enclave, Traverse (VIN R/V)	Acadia, Enclave, Traverse (VIN R/V) (3206)	Spark (US/Canada), Barina Spark (Automatic Transmission)	2015 Chevy Silverado 1500	2017 Chevrolet Spark
2012 Nissan Sentra	SRX (VIN N)	Alpheon (2706)	Alpheon (3094)	SRX (VIN N) (3201)	2015 Chevy Silverado 2500	2017 Chevy Traverse
2013 Buick LaCrosse	STS (VIN D)	Ampera, Volt (VIN R) (Europe) (3211)	Ampera, Volt (VIN R) (Europe) (3211)	Spin	2015 Silverado 2500HD truck	2017 Canyon Denali
2013 Buick Regal	VE/W/M - Sedan, Sportwagon, Ute, Lumina, caprice, hsv	Antara, Captiva	Antara, Captiva (5376555)	Trax, Tracker (Africa, Australia, Middle East South America) (5377156)	2015 Chevrolet 2500HD	2017 Cadillac XTS
2013 Chevy suburban	VUE (VIN 1), Captiva Sport	Astra-J (2857)	Astra-J Convertible/ Coupe (5376567)	VE/W/M Ute, Caprice, Lumina	2015 GMC 2500HD	2017 GMC Canyon Truck
2013 Chevy Tahoe	2011	Avalanche, Escalade, Suburban, Tahoe, Yukon (VIN C/K)	Astra-J (5376577)	Verano (US/Canada) (5377996)	2015 GMC Acadia	2017 GMC Sierra
2013 Chevrolet Equinox	Acadia, Enclave, Traverse (VIN R/V)	Aveo Classic, Barina Classic (VIN T)	ATS (VIN A) (3086)	Volt (VIN R) (North America, Holden) (3210)	2015 GMC SAVANA	2017 GMC Acadia
2013 Cadillac XTS	Alpheon	Aveo, Sonic (2777)	Avalanche, Escalade, Suburban, Tahoe, Yukon (VIN C/K) (3088)	XTS (China) (3092)	2015 GMC Yukon Denali	2017 Tahoe
2013 Cadillac CTS-V	Antara, Captiva	Barina (2774)	Aveo, Sonic (Africa, Middle East AP, South America, CKO Mexico) (5376711)	XTS (North America) (3091)	2015 GMC Sierra	2018 GMC Terrain
2013 Cadillac ATS	Buick Excelle (2861)		Aveo, Sonic (Europe) (5376704)	Zafira-Tourer	2015 Suburban	2018 GMC Canyon Denal
2013 GMC 2500HD pickup						

Figure 7: Comprehensive compatibility chart for GM vehicles (2006-2025) with the EL-50448 TPMS Relearn Tool.

# For **GM** equipped with 315 or 433 MHZ

using when change a new sensor or do tire rotation



Car



Truck



SUV



Pickup



Figure 8: Visual representation of compatible GM vehicle types: Car, Truck, SUV, and Pickup.

## 8. WARRANTY AND SUPPORT

### 8.1 Warranty Information

The AMZSEA EL-50448 TPMS Relearn Tool comes with a 12-month guarantee from the date of purchase. This warranty covers manufacturing defects and ensures the product functions as described under normal use. Please retain your proof of purchase for warranty claims.

### 8.2 Customer Support

For any questions, technical assistance, or warranty claims, please contact AMZSEA customer support. Contact details can typically be found on the product packaging or the retailer's website where the product was purchased.

