

ENKI BBT0246

ENKI Deion BBT0246 Thermostatic Surface Mounted Shower Mixer User Manual

Model: BBT0246

INTRODUCTION

Thank you for choosing the ENKI Deion BBT0246 Thermostatic Surface Mounted Shower Mixer. This high-quality shower mixer is designed to provide a safe and enjoyable showering experience with precise temperature control and an integrated anti-scald device. This manual contains important information regarding the installation, operation, and maintenance of your new shower mixer. Please read it thoroughly before installation and retain it for future reference.

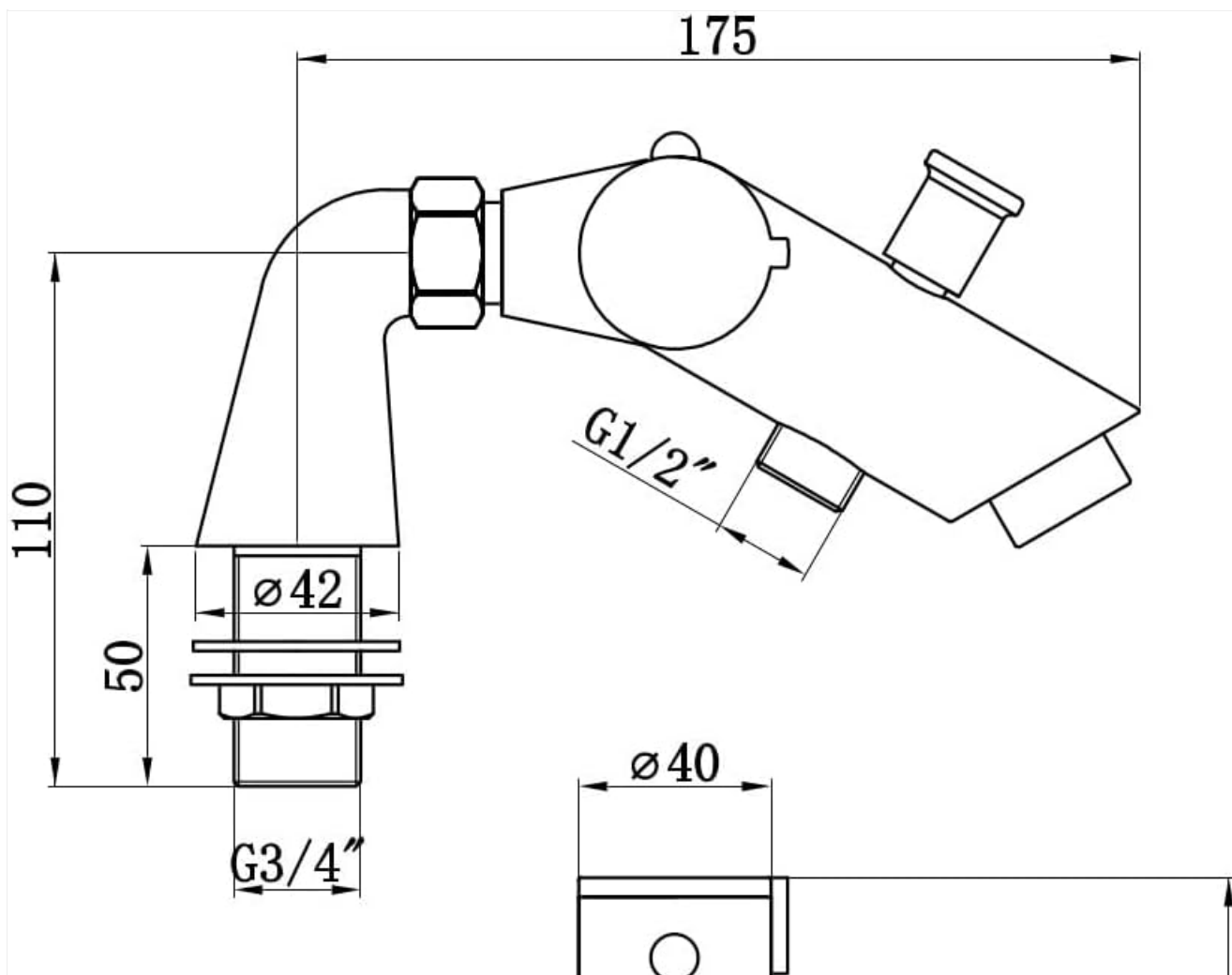

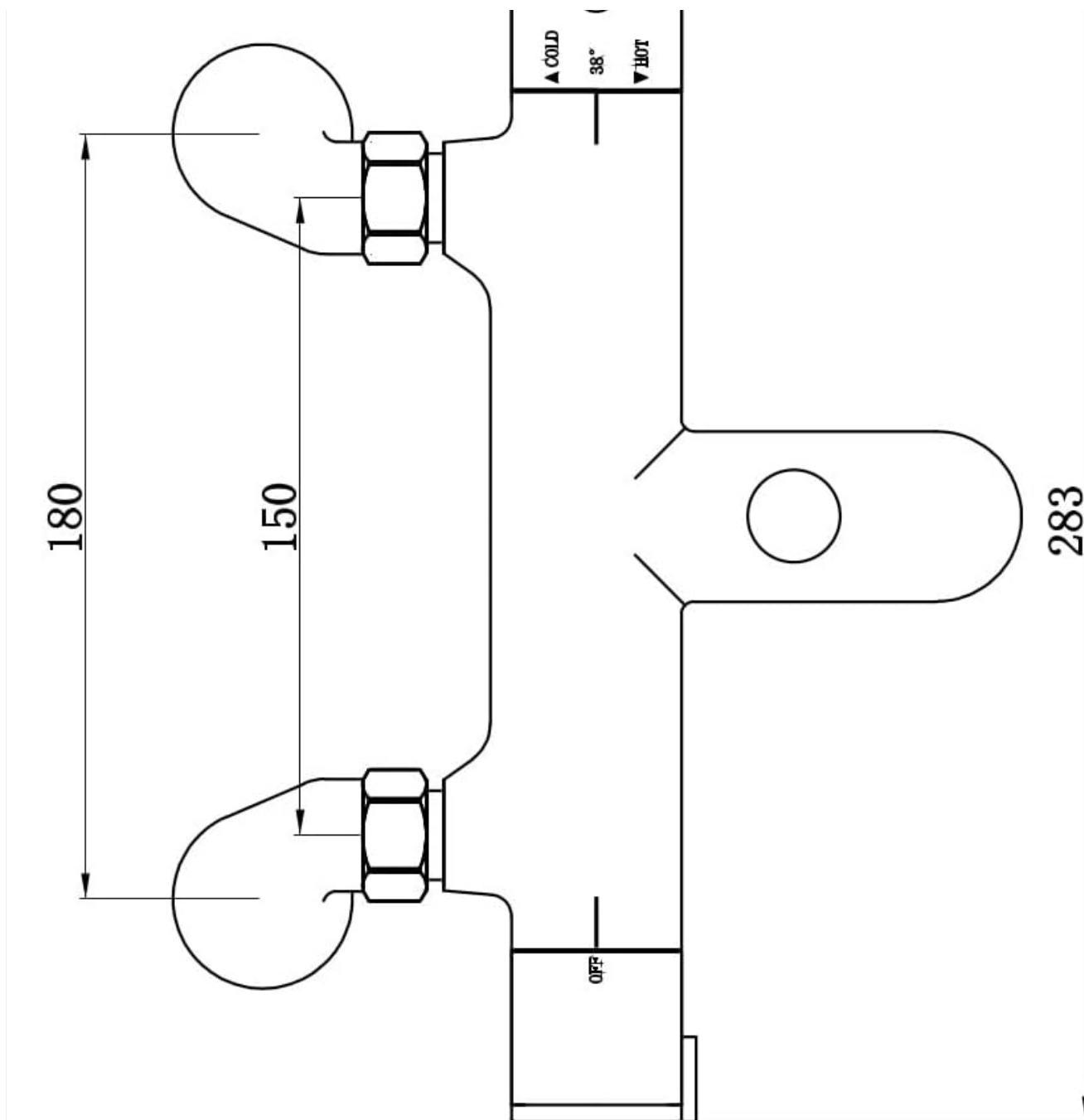

The ENKI Deion BBT0246 Thermostatic Shower Mixer, showcasing its modern design and chrome finish.

SAFETY INFORMATION

- Installation should be carried out by a qualified professional in accordance with local plumbing regulations.
- Ensure the main water supply is turned off before commencing any installation or maintenance work.
- Verify that all connections are secure and watertight to prevent leaks.
- Do not use abrasive cleaners or harsh chemicals on the mixer's surface, as this may damage the finish.
- The integrated anti-scald device is designed for safety; do not attempt to bypass or modify it.

PACKAGE CONTENTS

Please check that all components are present and undamaged before installation:

- 1 x ENKI Deion BBT0246 Thermostatic Surface Mounted Shower Mixer
- 2 x Tap Pillar Legs

- 1 x Installation Guide (this document)

SPECIFICATIONS

Model Number	BBT0246
Brand	ENKI
Material	Solid Brass
Finish	Chrome Plated
Connection Distance	180 mm
Shower Outlet Diameter	1/2 inch
Minimum Water Pressure	0.5 Bar (1.0 Bar recommended for optimal performance)
Product Dimensions (L x W x H)	36 x 19 x 16.5 cm
Item Weight	2.53 kg
Special Features	Temperature Control, Anti-scald Device



Technical drawing illustrating the dimensions and connections of the ENKI Deion BBT0246 Thermostatic Shower Mixer. Key dimensions include a connection distance of 180mm, a shower outlet of G1/2", and overall dimensions for installation planning.

INSTALLATION (SETUP)

Professional installation is recommended for this product. Ensure you have the necessary tools and plumbing knowledge before proceeding.

1. **Prepare the Installation Area:** Turn off the main water supply. Ensure the wall surface is clean, flat, and capable of supporting the mixer's weight.
2. **Check Water Pressure:** This mixer requires a minimum water pressure of 0.5 bar. For optimal performance, a pressure of 1.0 bar is recommended. This shower valve will not operate efficiently on a gravity-fed tank system unless a booster pump is installed.
3. **Mount the Tap Pillar Legs:** Securely attach the two tap pillar legs to the wall, ensuring they are level and spaced 180mm apart (center-to-center) to align with the mixer's inlets. Use appropriate wall fixings for your wall type.
4. **Connect the Mixer:** Attach the shower mixer to the tap pillar legs. Ensure the hot and cold water inlets are correctly connected (typically hot on the left, cold on the right, as indicated on the mixer). Use PTFE tape on threaded connections to ensure a watertight seal.

- 5. **Tighten Connections:** Carefully tighten all connections using a suitable spanner, taking care not to overtighten and damage the fittings.
- 6. **Test for Leaks:** Slowly turn on the main water supply and check all connections for any signs of leakage. Address any leaks immediately by tightening connections further or re-applying PTFE tape.
- 7. **Flush the System:** Allow water to run through the mixer for a few minutes to flush out any debris from the pipes before first use.

OPERATION

The ENKI Deion BBT0246 features thermostatic control for consistent water temperature and an anti-scald device for safety.

- **Water Flow Control:** The right handle typically controls the water flow. Turn it to increase or decrease the flow rate.
- **Temperature Control:** The left handle controls the water temperature. Rotate it to adjust the temperature. The mixer is designed to maintain a constant temperature, even if water pressure fluctuates.
- **Anti-Scald Feature:** The integrated anti-scald device prevents sudden temperature spikes, ensuring the water temperature remains safe. A common safety stop is set at 38°C (100.4°F). To exceed this temperature, you may need to press a safety override button (if present) on the temperature control handle while turning it.

MAINTENANCE

Regular maintenance will help prolong the life and performance of your shower mixer.

- **Cleaning:** Clean the mixer regularly with a soft cloth and mild soapy water. Rinse thoroughly and dry with a soft cloth to prevent water spots. Avoid using abrasive cleaners, scouring pads, or chemical-based cleaning agents, as these can damage the chrome finish.
- **Check for Leaks:** Periodically inspect all connections for any signs of leaks. Address any leaks promptly to prevent water damage.
- **Thermostatic Cartridge:** In hard water areas, limescale buildup can affect the thermostatic cartridge. If you notice inconsistent temperature control, the cartridge may need cleaning or replacement. This task should be performed by a qualified plumber.

TROUBLESHOOTING

Problem	Possible Cause	Solution
Inconsistent water temperature	Fluctuating water pressure, faulty thermostatic cartridge, limescale buildup.	Check water pressure. Clean or replace thermostatic cartridge (professional recommended).
Low water flow	Blocked filters, low water pressure, kinked hoses.	Clean inlet filters. Check household water pressure. Ensure hoses are not kinked.
Water leaking from connections	Loose connections, damaged seals/washers, incorrect installation.	Tighten connections. Replace seals/washers. Re-install if necessary (professional recommended).
No hot or cold water	Water supply turned off, blocked pipes, faulty thermostatic cartridge.	Check water supply. Inspect pipes for blockages. Replace thermostatic cartridge (professional recommended).

If you are unable to resolve an issue using the troubleshooting guide, please contact a qualified plumber or the product supplier for assistance.

WARRANTY & SUPPORT

This ENKI Deion BBT0246 Thermostatic Surface Mounted Shower Mixer comes with a **10-year warranty** from the date of purchase, covering manufacturing defects. This warranty does not cover damage caused by improper installation, misuse, accidental damage, or normal wear and tear.

For warranty claims or technical support, please contact your retailer or the manufacturer directly. Ensure you have your proof of purchase and model number (BBT0246) available when contacting support.