

briidea Feeder Activator Remote Control

briidea Feeder Activator Remote Control User Manual

Model: Feeder Activator Remote Control

1. INTRODUCTION

Thank you for choosing the briidea Feeder Activator Remote Control. This device allows for convenient, wireless activation of your feeder from a distance, helping to minimize disturbance to wildlife. Please read this manual thoroughly before installation and operation to ensure proper use and longevity of your product.

2. PRODUCT OVERVIEW

The briidea Feeder Activator Remote Control system consists of a compact receiver unit and a handheld remote transmitter. It is designed for broad compatibility with various 6-volt or 12-volt feeders and can also be adapted for other applications such as controlling lights or fans.

Key Features:

- **Wireless Remote Control:** Activate your feeder from up to 1000 feet away.
- **Programmable Receiver:** Default 5-second activation, with options to set custom delay times or continuous operation.
- **Easy to Use:** Simple button press for activation.
- **Compact Design:** Transmitter is easy to carry, and the receiver installs discreetly.
- **Broad Compatibility:** Works with 6-volt or 12-volt feeders, fish feeders, lights, and fans.



This image highlights the main features of the briidea Feeder Activator Remote Control, including its small size, programmable design, broad compatibility, 1000ft maximum range, and ease of use.

3. PACKAGE CONTENTS

- 1x briidea Feeder Activator Receiver Unit
- 1x Remote Transmitter
- Wiring Connectors (e.g., wire nuts)



An overview of the briidea Feeder Activator Remote Control system, showing the compact receiver unit with wiring and the handheld remote transmitter.

4. SAFETY INFORMATION

- Ensure all power is disconnected from the feeder system before beginning installation.
- Verify correct voltage (6V or 12V) and polarity before connecting the receiver to prevent damage.
- Keep the receiver and wiring protected from environmental elements to avoid short circuits or corrosion.
- Do not attempt to modify the internal components of the device.

5. SETUP

5.1. Receiver Installation and Wiring

1. Identify the power source (6V or 12V battery) and the feeder motor wires.
2. Mount the receiver unit in a suitable location, preferably inside the feeder housing or a protective enclosure, ensuring the antenna wire is routed outside for optimal signal reception. The receiver is equipped with 3M adhesive for easy, screw-free installation.
3. Connect the receiver wires according to the diagram below:
 - **Black wire (GND):** Connect to the negative terminal of your 6V or 12V battery.
 - **Red wire (V+):** Connect to the positive terminal of your 6V or 12V battery.
 - **Blue wire (OUT V+):** Connect to one of the feeder motor wires.
 - **White wire (OUT V-):** Connect to the other feeder motor wire.
4. Use the provided wire connectors to secure all connections. Ensure connections are tight and insulated.
5. After connecting, if the receiver's status light blinks when attempting to activate, it may indicate that the motor wires (Blue and White) need to be swapped at their connectors.

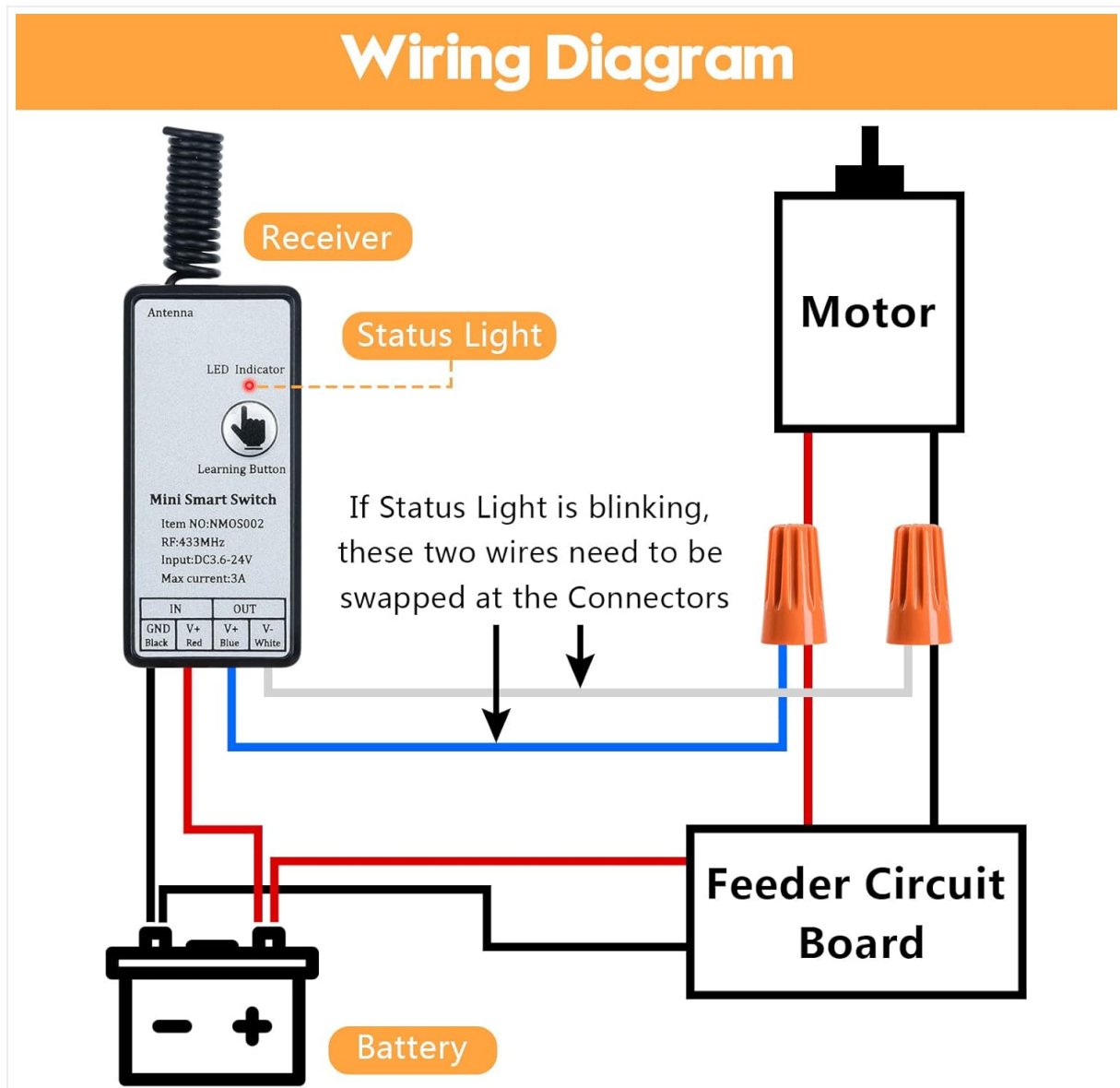

A detailed wiring diagram illustrating how to connect the briidea Feeder Activator receiver to a 6V or 12V battery and a feeder motor. It shows connections for GND (Black), V+ (Red), and motor wires (Blue, White), with a note about swapping motor wires if the status light blinks.

5.2. Transmitter Battery Installation

The remote transmitter requires a 23A 12-volt battery (not included). Open the battery compartment on the back of the transmitter and insert the battery, observing correct polarity.

6. OPERATING INSTRUCTIONS

Once the receiver is correctly wired and the transmitter has a battery, the system is ready for use. Simply press the activation button on the remote transmitter to activate the feeder motor. The default operation is a 5-second activation period.



An illustration showing the briidea remote control activating a feeder from a distance, demonstrating its maximum range of 1000 feet.



The briidea remote control being used to activate a deer feeder, showcasing its application in wildlife feeding scenarios.

7. PROGRAMMING MODES

The receiver features a programmable design, allowing you to customize the activation delay time or operation mode beyond the default 5-second setting. Refer to the specific programming instructions provided with your product for details on how to adjust these settings. Typically, this involves pressing the 'Learning Button' on the receiver a certain number of times to enter different modes (e.g., momentary, toggle, timed delay).

8. MAINTENANCE

- **Cleaning:** Wipe the receiver and transmitter with a dry, soft cloth. Do not use harsh chemicals or abrasive cleaners.
- **Battery Replacement:** Replace the 23A 12V battery in the transmitter when the signal range decreases or the LED indicator on the remote does not light up.
- **Wiring Inspection:** Periodically check all wiring connections for corrosion or damage, especially in outdoor environments.

9. TROUBLESHOOTING

- **Feeder not activating:**
 - Check the battery in the remote transmitter.
 - Verify all wiring connections to the receiver and feeder motor are secure and correct.
 - Ensure the receiver is receiving power from the 6V or 12V battery.
 - Confirm you are within the 1000ft operating range. Obstructions can reduce range.
- **Receiver status light blinking:** This typically indicates incorrect motor wire polarity. Refer to the wiring diagram in Section 5.1 and swap the blue and white motor wires.
- **Device not responding to programming:** Ensure you are following the programming instructions precisely. If issues persist, try resetting the receiver (refer to your product's specific reset procedure).

10. SPECIFICATIONS

Feature	Detail
Product Dimensions	Receiver: 2 x 1 x 1 inches (approximate) Transmitter: 3.6 x 1.6 x 0.6 inches (approximate)
Item Weight	2.89 ounces
Input Voltage	DC 3-24V (Compatible with 6V or 12V systems)
Max Current	3A
Max Number of Supported Devices	1 (per receiver unit)
Wireless Range	Up to 1000 feet (line of sight)
Compatible Devices	Deer feeders, Fish feeders, Lights, Fans, and other 6V/12V modification controls

Small and Compact Design, Easy to Carry



This image provides the physical dimensions of both the bridge receiver and the remote transmitter, emphasizing their compact size for portability and discreet installation.

Compatibility



Compatibility:

Compatible with 6-volt or 12-volt feeders, fans, lights or other modification controls.

This image illustrates the broad compatibility of the briidea Feeder Activator Remote Control, showing its use with deer feeders, fish feeders, lights, and fans, highlighting its versatility beyond just wildlife feeders.

11. WARRANTY AND SUPPORT

For warranty information or technical assistance, please contact briidea customer support through the retailer where the product was purchased or visit the official briidea website. Please have your product model and purchase date available when contacting support.

Related Documents - Feeder Activator Remote Control

HASS-05 AC Soft Starter User Manual



[Briidea HASS-05 AC Soft Starter User Manual](#)

User manual for the Briidea HASS-05 AC Soft Starter, detailing its features, benefits, specifications, and installation guide. This soft starter is designed to reduce inrush current for AC motors, offering reverse motor protection and easy installation.



[briidea HASS-05 AC Soft Starter User Manual and Installation Guide](#)

Comprehensive user manual and installation guide for the briidea HASS-05 AC Soft Starter. Learn about its features, benefits, technical specifications, safety precautions, and step-by-step wiring and installation procedures for HVAC systems.

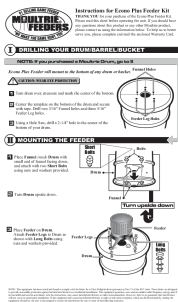

Moultrie Econo Plus Feeder Kit: Installation and Operation Guide

Comprehensive instructions for installing, programming, and operating the Moultrie Econo Plus Feeder Kit. Learn how to drill drums, mount the feeder, set feed amounts, and troubleshoot common issues.

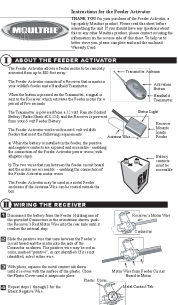

Moultrie Feeder Activator Instructions and Setup Guide

Detailed instructions for setting up and wiring the Moultrie Feeder Activator. Learn how to connect the receiver, check status lights, mount the unit, and operate the transmitter for remote feeder activation.

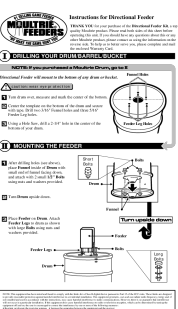

Moultrie Directional Feeder Kit: Installation, Programming, and Operation Guide

Detailed instructions for setting up and using the Moultrie Directional Feeder Kit. Covers drilling, mounting, programming feed amounts, battery installation, and answers common questions.



Moultrie 6-Volt Universal Replacement Timer: Installation & Programming Guide

Comprehensive instructions for installing, programming, and testing the Moultrie 6-Volt Universal Replacement Timer for game feeders. Includes wiring, battery setup, time settings, and troubleshooting tips.

