

YOSE POWER 50116f77-f177-4a51-b2cb-17c6fade1d9a

YOSE POWER Portable Power Station User Manual

Model: 50116f77-f177-4a51-b2cb-17c6fade1d9a

1. INTRODUCTION

Thank you for choosing the YOSE POWER Portable Power Station. This manual provides essential information for the safe and efficient operation, maintenance, and troubleshooting of your device. Please read this manual thoroughly before use and retain it for future reference.

2. SAFETY INSTRUCTIONS

- Do not disassemble, repair, or modify the unit. Incorrect reassembly may cause fire or injury.
- Do not expose the unit to fire or extreme temperatures.
- Do not use or store the unit in direct sunlight, near heat sources, or in high humidity environments.
- Keep the unit away from children and pets.
- Ensure proper ventilation during use to prevent overheating.
- The unit features **Overload Protection** and **Short Circuit Protection**. If an overload or short circuit occurs, the unit will automatically shut down to prevent damage. Disconnect the device causing the issue and restart the power station.
- Use only recommended accessories and charging methods.
- Avoid dropping or subjecting the unit to strong impacts.

3. PACKAGE CONTENTS

Verify that all items are present in your package:

- YOSE POWER Portable Power Station
- AC Charger
- Car Port Charger
- User Manual

Product Specifications

Product

Portable power station

Battery Type

Lithium-ion battery

Battery Capacity

108000mAh&3.6V388Wh

Charging Time

Around 7~8 hours

USB Output*3

5V, 2.4A (each)

DC Output Efficiency

≥90%

DC Output

12V10A120W, 12V5A*2

AC Output

230V50Hz(continue 300W)

Weight

3.5kg

Dimension

215*160*192mm

AC Output Efficiency

≥85%



AC Charger



Car port Charger



User manual

Image: The YOSE POWER Portable Power Station shown with its AC charger, car port charger, and user manual.

4. PRODUCT OVERVIEW

The YOSE POWER Portable Power Station is a compact and versatile power source designed for various applications, including outdoor activities, emergency backup, and general portable power needs. It features multiple output ports and charging options.



Image: Front view of the YOSE POWER Portable Power Station, displaying the LED light, digital screen, DC input, DC outputs, USB ports, and AC output socket.



Image: A close-up of the power station's control panel, highlighting the LED light, digital display, DC input, DC 12V/10A car port, two DC 5A ports, USB Type-C PD27W port, three USB 5V/2.4A ports, and the AC 230V/50Hz output socket.



Image: An exploded view of the power station, revealing the internal lithium-ion battery cells and the cooling fan mechanism.



Image: A diagram illustrating the airflow generated by the internal cooling fan, designed to dissipate heat and maintain optimal operating temperature.

5. CHARGING THE POWER STATION

The power station can be charged using three primary methods:

1. **Wall Charger:** Connect the provided AC charger to a standard wall outlet. Charging time is approximately 7-8 hours.
2. **Car Charger:** Use the included car port charger to charge the unit from your vehicle's 12V outlet. Charging time is approximately 8-10 hours.
3. **Solar Panels:** Connect compatible solar panels (not included) to the DC input port. Charging time is approximately 8 hours, depending on sunlight intensity and panel wattage.

Three charging methods

Solar panels/Car charger/wall charger

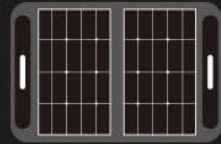

Solar Panels Charger
Around 8 hours



Car Charger
Around 8~10 hours

Wall Charger
Around 7~8 hours

Image: An infographic illustrating the three charging methods: solar panels, car charger, and wall charger, along with their approximate charging durations.

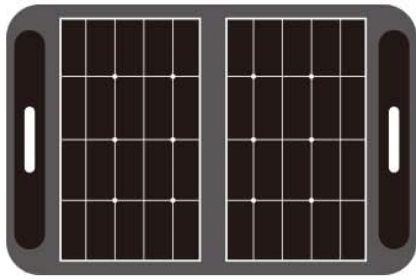

Solar Panels Charger

Around 8 hours

DC interface

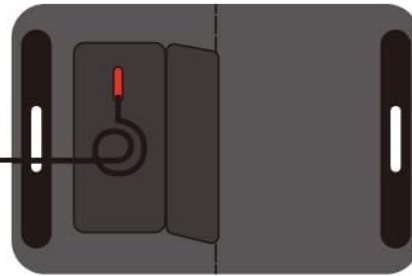

Image: The portable power station connected to two solar panels in an outdoor setting, demonstrating solar charging capability.

6. OPERATING THE POWER STATION

The power station offers various output methods to power different devices:

- **AC Output:** The 230V/50Hz AC outlet provides continuous power up to 300W. This is suitable for laptops, small appliances, and other AC-powered devices. The power station uses a modified sine wave output.
- **DC Output:** Includes a 12V/10A car port (120W) and two 12V/5A DC ports. Ideal for car refrigerators, portable fans, and other 12V DC devices.
- **USB Output:** Features one USB Type-C PD27W port and three 5V/2.4A USB-A ports. These are suitable for charging smartphones, tablets, cameras, and other USB-powered devices.
- **LED Light:** A built-in LED light provides illumination for camping or emergency situations.

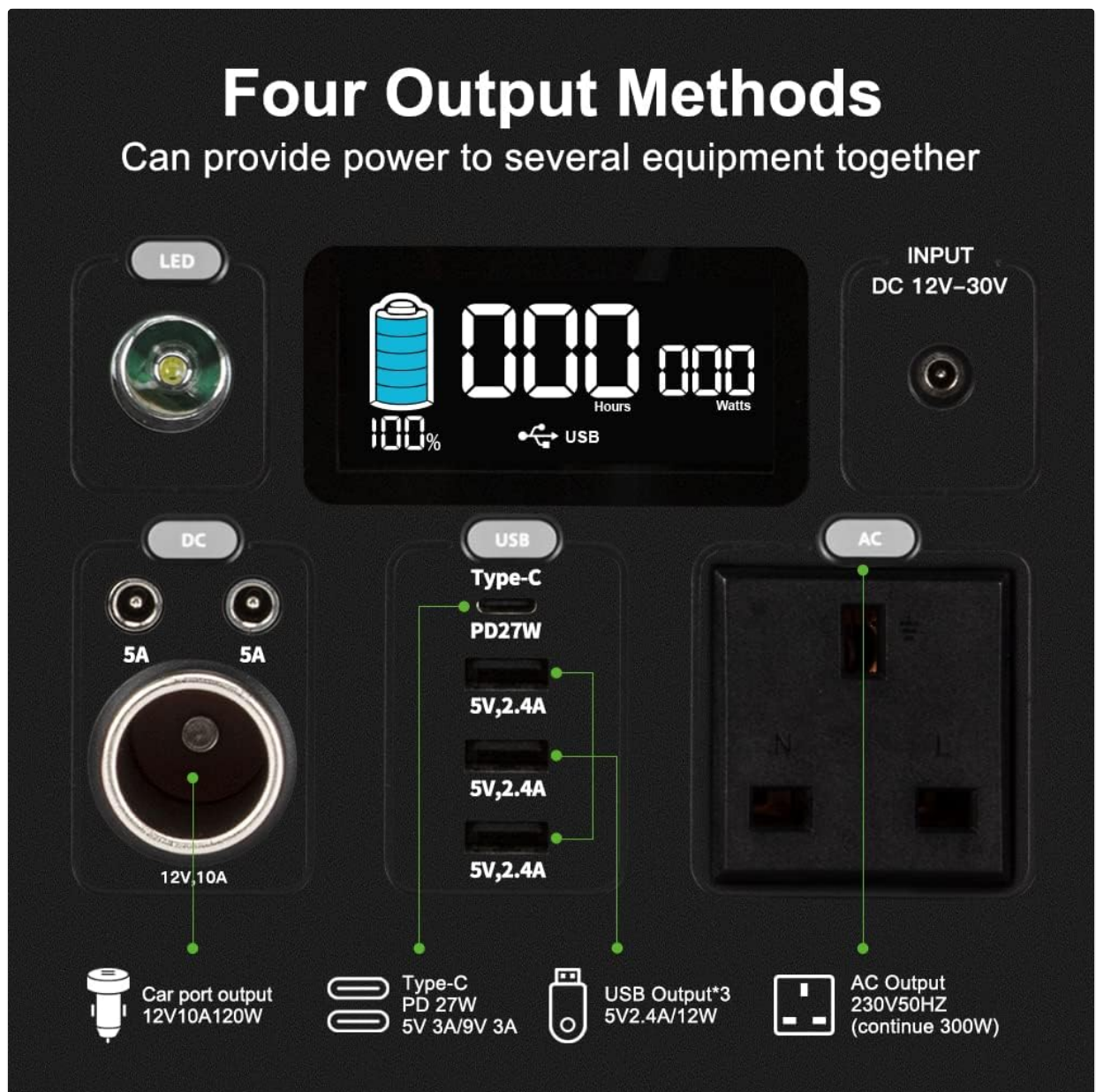

Image: An infographic demonstrating the power station's ability to charge multiple devices, including drones, cameras, MacBooks, iPhones, floodlights, TVs, CPAP machines, Nintendo Switches, car refrigerators, and interphones, with approximate usage times.



Image: A graphical comparison between a pure sine wave and a modified sine wave, illustrating the output characteristics of the power station's AC inverter.



Image: The power station providing power to a CPAP machine, demonstrating its utility for essential medical devices during power outages or off-grid situations.



Image: A close-up view of the bright LED light integrated into the power station, useful for illumination in low-light conditions.

7. MAINTENANCE AND STORAGE

- Clean the unit with a dry, soft cloth. Do not use abrasive cleaners or solvents.
- Store the unit in a cool, dry place, away from direct sunlight and moisture.
- For long-term storage, charge the unit to 50-80% every 3-6 months to maintain battery health.
- Avoid storing the unit in extreme temperatures (below 0°C or above 40°C).

8. TROUBLESHOOTING

- **Unit not turning on:** Ensure the power button is pressed firmly. Check if the battery is completely depleted and needs charging.
- **No output from ports:** Ensure the specific output port (AC, DC, USB) is activated. Check if the device being charged or powered exceeds the power station's output limits, triggering overload protection.
- **Charging slowly:** Verify that the charger is correctly connected and functioning. For solar charging, ensure panels are in direct sunlight and free from obstructions.
- **Overheating:** If the unit feels excessively hot, disconnect all devices and allow it to cool down in a well-ventilated area. Ensure the cooling vents are not blocked.



9. SPECIFICATIONS



Feature	Specification
Product Dimensions	21.6 x 16 x 19.2 cm
Item Weight	3.49 kg (7.7 Pounds)
Battery Type	Lithium-ion battery
Battery Capacity	108000mAh & 3.6V (388Wh)
AC Output	230V, 50Hz (Continuous 300W)
DC Output	12V 10A (120W), 2x 12V 5A
USB Output	1x Type-C PD27W, 3x 5V/2.4A
Charging Time (Wall Charger)	Approx. 7-8 hours
DC Output Efficiency	≥90%
AC Output Efficiency	≥85%
Special Features	Overload Protection, Portable, Short Circuit Protection

10. WARRANTY AND SUPPORT

For warranty information or technical support, please refer to the contact details provided with your purchase documentation or visit the official YOSE POWER website. Keep your proof of purchase for warranty claims.

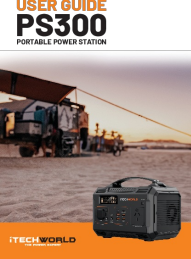
Related Documents - 50116f77-f177-4a51-b2cb-17c6fade1d9a

 <p>NEXPOW YP-300W USER MANUAL</p> <p>Please read the user manual carefully to start your power journey.</p> <p>POWER YOUR IMAGINATION</p> <p>www.nexpow.com 1888 960 0888</p>	<p>NEXPOW YP-300W Portable Power Station User Manual and Specifications</p> <p>Comprehensive user manual for the NEXPOW YP-300W portable power station. Learn about features, operation, charging, specifications, troubleshooting, and safety for this 296Wh solar generator.</p>
	<p>GMM 300W Power Station User Manual</p> <p>User manual for the GMM 300W Power Station, detailing important safety instructions, product overview, recharge modes, output specifications, maintenance, troubleshooting, and FAQs. This portable power station features a 296Wh lithium-ion battery, multiple output ports including AC, DC, and USB, and a 5W LED light.</p>
 <p>USER GUIDE PS300 PORTABLE POWER STATION</p> <p>ITECHWORLD</p>	<p>iTechworld PS300 Portable Power Station User Guide</p> <p>Comprehensive user guide for the iTechworld PS300 Portable Power Station, detailing product features, charging methods, fault resolution, specifications, and essential safety precautions for optimal and safe operation.</p>

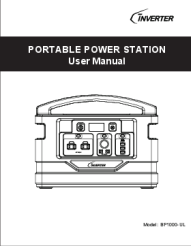
	<p>ECOFLOW RIVER mini Portable Power Station Features</p> <p>Explore the ECOFLOW RIVER mini, a 210Wh portable power station with 300W output, lightweight design, and solar charging capabilities for outdoor use.</p>
	<p>Matson MAPP300 Lithium Portable Power Station 300W AC, USB-C PD, QC 3.0</p> <p>Discover the Matson MAPP300, a 300W Lithium Portable Power Station. Features AC outlet, USB-C PD, QC 3.0, and DC ports for charging devices. Includes specifications, safety instructions, and warranty details from Tridon Australia.</p>
	<p>C INVERTER BP1000-UL Portable Power Station User Manual</p> <p>Comprehensive user manual for the C INVERTER BP1000-UL Portable Power Station, detailing features, specifications, operation, troubleshooting, and warranty information for this 1110Wh lithium polymer battery solar generator.</p>