

[Manuals.plus](#) /

› [LNMBBS](#) /

› LNMBBS 10-Inch Android Tablet User Manual

LNMBBS T13-B

LNMBBS 10-Inch Android Tablet User Manual

Model: T13-B | Brand: LNMBBS

INTRODUCTION

This manual provides comprehensive instructions for the setup, operation, maintenance, and troubleshooting of your new LNMBBS 10-Inch Android Tablet. Please read this manual thoroughly to ensure proper use and to maximize the performance and longevity of your device. Keep this manual for future reference.

PACKAGE CONTENTS

Upon opening the package, please verify that all the following items are included:

- LNMBBS Tablet
- Case for tablet 2-in-1
- Bluetooth Keyboard
- Mouse
- Capacitive Pen
- USB Charger (USA standard)
- Type C Data Cable
- Instruction Manual (this document)



Image: The LNMBBS 10-Inch Android Tablet displayed with its full set of accessories, including the keyboard, mouse, capacitive pen, charging cable, and power adapter.

PRODUCT OVERVIEW

Familiarize yourself with the physical components and ports of your LNMBBS tablet.

Widescreen, Stunning Visuals

Built to tackle Work and Play

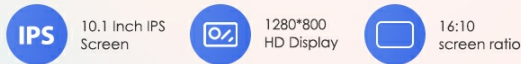

Image: A detailed diagram highlighting the various ports and buttons on the LNMBBS tablet, including the Type-C charging port, headphone jack, power button, volume buttons, front and rear cameras, dual speakers, and the Micro SD card slot.

Key Components:

- **Front Camera:** For video calls and selfies.
- **Rear Camera:** For capturing photos and videos.
- **Power Button:** Press and hold to power on/off, short press to sleep/wake.
- **Volume Buttons:** Adjust audio volume.
- **Type-C Port:** For charging and data transfer.
- **Headphone Jack (3.5mm):** For connecting wired headphones.
- **Dual Speakers:** Provide stereo audio output.
- **Micro SD Card Slot:** For expanding storage up to 128GB.

SETUP

1. Initial Charging

Before first use, fully charge your tablet using the provided USB charger and Type-C data cable. The battery indicator on the screen will show charging progress. A full charge ensures optimal battery performance.

Your browser does not support the video tag.

Video: An official product video demonstrating the LNMBBS T13 tablet, highlighting its slim design, Octa-core processor, Android 12 privacy features, TF expansion, and charging capabilities. This video provides a visual overview of the tablet's key aspects.

2. Power On/Off

- **To Power On:** Press and hold the Power Button until the LNMBBS logo appears.
- **To Power Off:** Press and hold the Power Button until a power-off menu appears, then select "Power off".
- **Sleep/Wake:** Short press the Power Button to put the tablet to sleep or wake it up.

3. Connecting Accessories

Bluetooth Keyboard:

The included Bluetooth keyboard enhances productivity. Follow these steps to pair it:

1. Ensure the keyboard is charged.
2. Turn on the ON/OFF switch on the keyboard.

3. Press the **CONNECT** button on the keyboard; the Bluetooth logo indicator will flash.
4. On your tablet, go to **Settings > Connected devices > Bluetooth**.
5. Enable Bluetooth if it's not already on.
6. Select "Bluetooth 3.0 Keyboard" from the list of available devices.
7. Follow any on-screen prompts to complete pairing (e.g., entering a code).

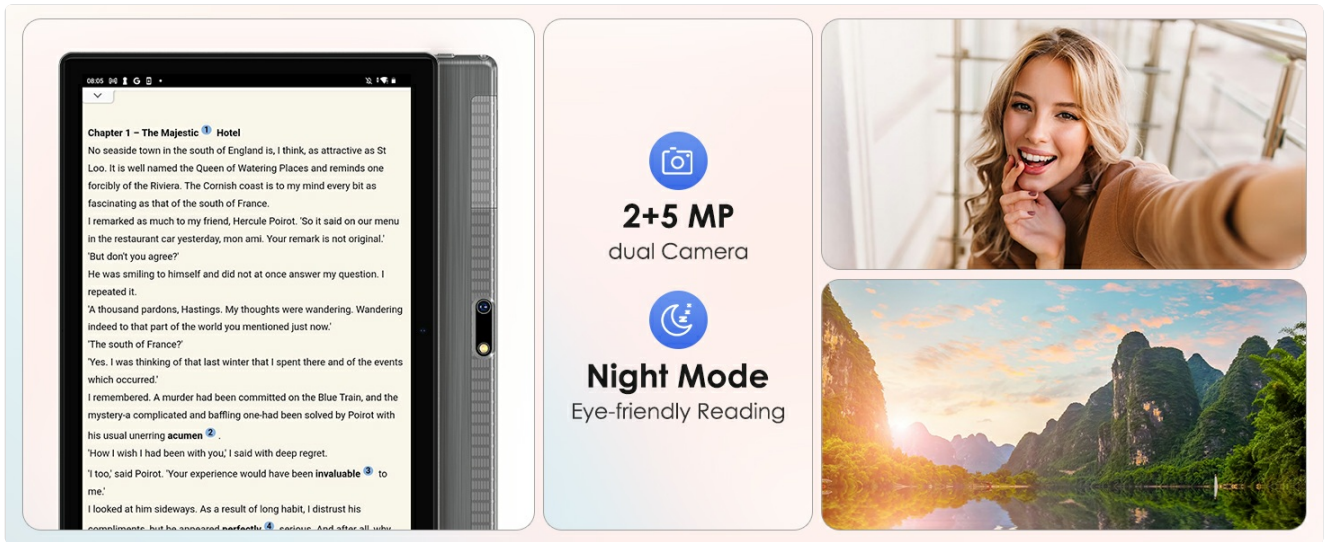

Image: A visual guide demonstrating the steps to connect the Bluetooth keyboard to the tablet, including turning on the keyboard and navigating the tablet's Bluetooth settings.

Wireless Mouse:

The wireless mouse connects via a USB dongle. Note that the tablet has a Type-C port, so an OTG adapter cable (often included) is required for the USB-A dongle.

1. Insert AAA batteries into the mouse.
2. Plug the USB dongle into the OTG adapter cable.
3. Connect the Type-C end of the OTG adapter cable to the tablet's Type-C port.
4. The tablet should automatically detect the mouse.

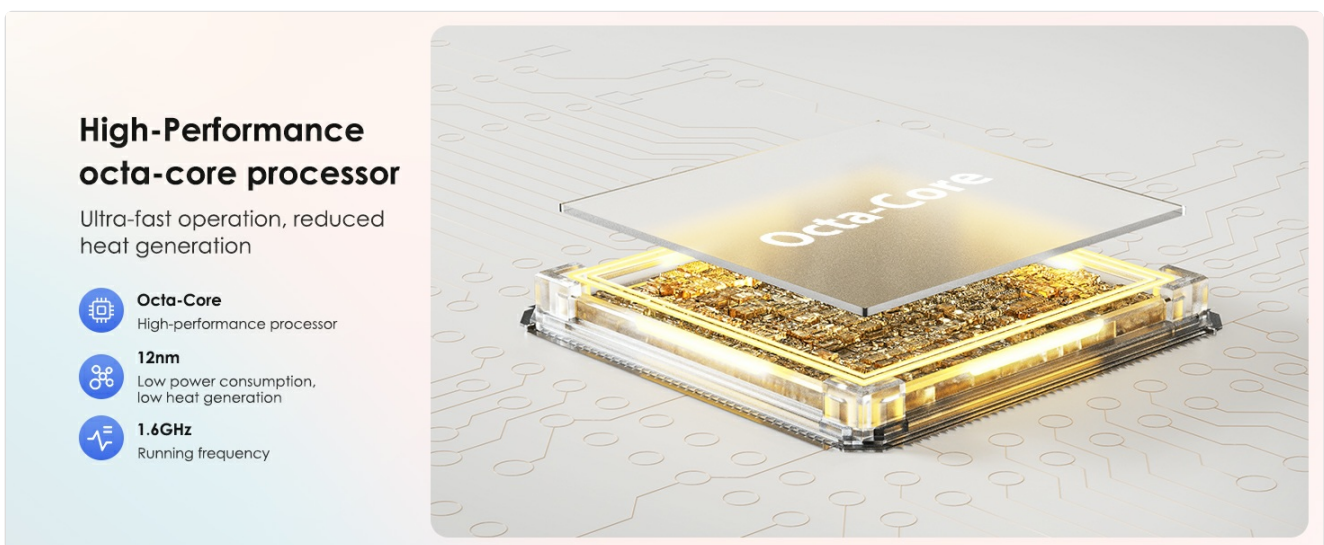

Image: A step-by-step visual guide for connecting the wireless mouse, illustrating battery placement, USB dongle insertion, and the complete setup with the tablet and keyboard.

4. Wi-Fi Connection

To access the internet, connect your tablet to a Wi-Fi network:

1. Go to **Settings > Network & internet > Wi-Fi**.
2. Turn on Wi-Fi.
3. Select your desired network from the list.
4. Enter the password if prompted, then tap **Connect**.

5. Google Account Setup

For full access to Google services like the Play Store, Gmail, and Google Drive, sign in with your Google account during initial setup or later via **Settings > Accounts**.

OPERATING INSTRUCTIONS

Basic Navigation

- **Home Screen:** Swipe left or right to navigate between home screens.
- **App Drawer:** Swipe up from the bottom of the screen to access all installed applications.
- **Notifications & Quick Settings:** Swipe down from the top of the screen to view notifications and quick settings toggles.
- **Multitasking/Recent Apps:** Tap the square icon (or swipe up and hold from the bottom if using gesture navigation) to view recently used apps.

Storage Expansion (Micro SD)

Your tablet supports Micro SD cards up to 128GB for expanded storage. Locate the Micro SD card slot (refer to Product Overview section) and gently insert the card until it clicks into place. You will be prompted to format the card for use as portable storage or internal storage.

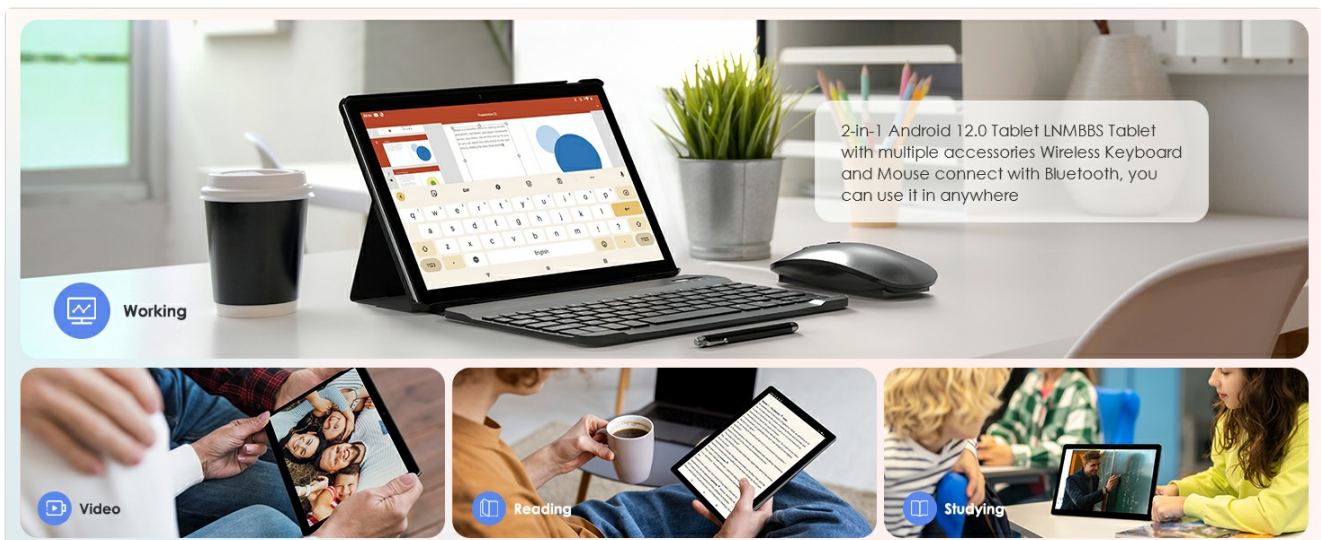

Image: The tablet screen displaying its memory specifications (4GB RAM, 64GB ROM) and highlighting the capability to expand storage via a Micro SD card.

Camera Usage

The tablet features a 5MP front camera and a 2MP rear camera. Open the "Camera" app to capture photos and videos. You can switch between front and rear cameras within the app interface.

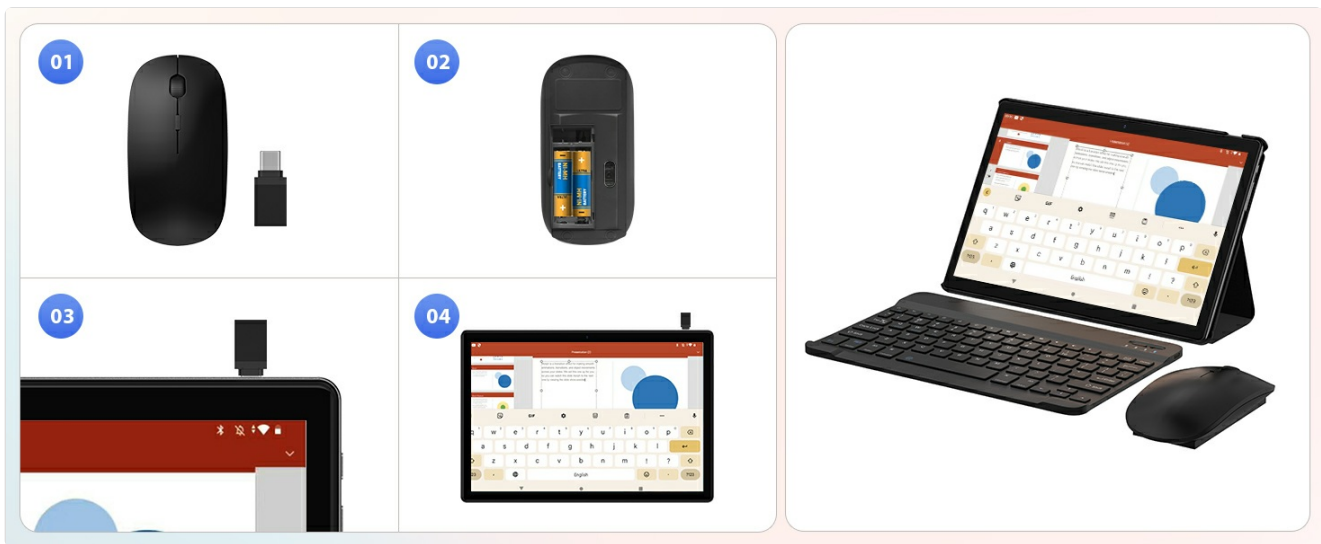

Image: A visual representation of the tablet's camera capabilities, showcasing its dual cameras and examples of photos taken, along with features like Night Mode for comfortable reading.

Connectivity

- **Bluetooth:** Connect to other Bluetooth devices like headphones, speakers, or other tablets/phones via **Settings > Connected devices > Bluetooth**.
- **GPS:** The built-in GPS allows for navigation and location-based services. Ensure location services are enabled in **Settings > Location**.
- **FM Radio:** Use the pre-installed FM Radio app to listen to local radio stations. Headphones may be required as an antenna.

Screen Casting

You can cast your tablet's screen to a larger display, such as a TV, for an enhanced viewing experience. This feature is typically found in Quick Settings or **Settings > Connected devices > Cast**.

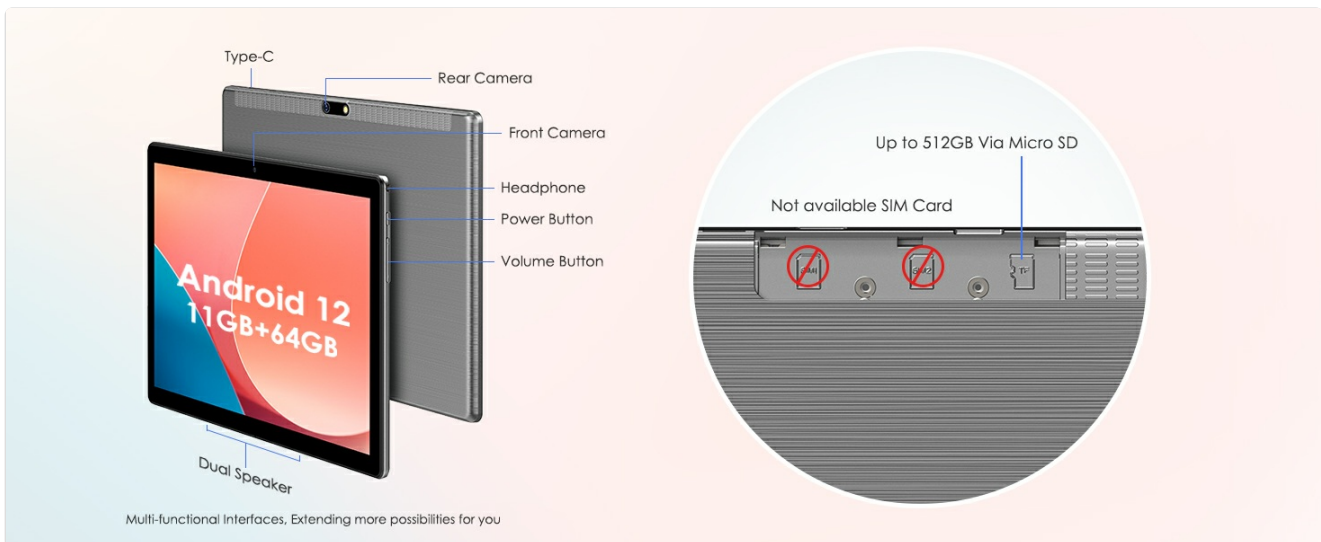

Image: Demonstrations of the tablet's versatile uses, including GPS navigation, screen casting to a television, and utilizing the smart split screen feature for multitasking.

Digital Wellbeing & Parental Controls

The Android 12 system includes Digital Wellbeing and Parental Controls features to help manage screen time and ensure a safe digital environment. Access these settings via **Settings > Digital Wellbeing & parental controls**.



Android 12 System & Lightweight Metal Body



Android 12
Limit Useless Ads



Privacy
Security & Device control



GMS **GMS certified**
via Google Play



Parental Controls
Digital Wellbeing

Image: The tablet showcasing the Android 12 interface and the Digital Wellbeing dashboard, which provides insights into app usage and allows for setting parental controls.

FEATURES

The LNMBBS 10-Inch Android Tablet is designed with a range of features to enhance your digital experience:

- **Powerful Performance:** Equipped with a 1.6GHz 64-bit Octa-core CPU and 4GB RAM for smooth multitasking and gaming.
- **Ample Storage:** 64GB internal storage, expandable up to 128GB via Micro SD card.
- **Vivid Display:** 10.1-inch HD (1280x800) IPS screen with 2.5D curved glass for bright and immersive visuals.
- **Latest Android OS:** Runs on Google GMS-certified Android 12 (updated August 24, 2023), offering a pure Android experience with enhanced privacy features.
- **Long-lasting Battery:** Built-in 5000mAh battery provides extended usage time, with fast charging via USB-C.
- **Dual Cameras:** 5MP front and 2MP rear-facing cameras for photos and video calls.
- **Connectivity:** Supports 2.4Ghz Wi-Fi, Bluetooth, and GPS.
- **Productivity Suite:** Comes with a Bluetooth keyboard, wireless mouse, and capacitive pen, transforming your tablet into a versatile workstation.

2 IN 1 Multi-function Android 12 Tablet

Equipped with more accessories, keyboard, mouse, capacitive pen, tablet cover

2 IN 1 Multi-function



Android 12



10.1 Inch IPS Screen



4GB RAM
64GB ROM



1280*800 Display



Octa-core CPU



Dual Stereo Speakers



Dual Camera



6000mah Battery

Image: An infographic showcasing the tablet's key features, including its Android 12 operating system, IPS display, memory, storage, resolution, processor, speakers, cameras, and battery capacity.

MAINTENANCE

Cleaning Your Tablet

To keep your tablet clean and in good condition:

- Use a soft, lint-free cloth (e.g., microfiber) to wipe the screen and body.
- For stubborn smudges, slightly dampen the cloth with water or a screen cleaner designed for electronics.
- Avoid using harsh chemicals, abrasive materials, or excessive moisture.

Battery Care

To prolong battery life:

- Avoid extreme temperatures.
- Do not let the battery completely drain frequently.
- Use the original charger or a certified compatible charger.

Software Updates

Regularly check for and install software updates to ensure your tablet has the latest features, security patches, and performance improvements. Go to **Settings > System > System update**.

TROUBLESHOOTING

This section addresses common issues you might encounter with your tablet.

Problem	Possible Cause	Solution
Tablet won't turn on.	Low battery; system crash.	Charge the tablet for at least 30 minutes. Press and hold the Power Button for 10-15 seconds to force restart.
Cannot connect to Wi-Fi.	Incorrect password; router issue; Wi-Fi disabled.	Double-check password. Restart router. Ensure Wi-Fi is enabled in settings. Forget and reconnect to the network.
Bluetooth accessory won't pair.	Accessory not in pairing mode; already paired; interference.	Ensure accessory is in pairing mode. Unpair from other devices. Move closer to the tablet. Restart both devices.
Tablet is slow or unresponsive.	Too many apps running; low storage; outdated software.	Close background apps. Clear cache. Free up storage. Check for system updates. Restart the tablet.
Battery drains quickly.	High screen brightness; background apps; heavy usage.	Reduce screen brightness. Close unused apps. Limit background data. Disable unnecessary features (GPS, Bluetooth) when not in use.

SPECIFICATIONS

Detailed technical specifications for the LNMBBS 10-Inch Android Tablet (Model T13-B):

Feature	Detail
Model Name	LNMBBS T13
Operating System	Android 12 (GMS Certified)
Processor	1.6 GHz Octa-Core (MediaTek)
RAM	4 GB DDR SDRAM
Internal Storage	64 GB Flash Memory
Expandable Storage	Up to 128 GB via Micro SD card
Screen Size	10.1 Inches
Screen Resolution	1280 x 800 pixels (HD IPS)
Rear Camera	5 MP
Front Camera	2 MP
Battery	5000mAh Lithium Ion (included)
Wireless Connectivity	802.11n Wi-Fi, Bluetooth
Navigation	GPS
Dimensions (LxWxH)	9.45 x 6.5 x 0.35 inches

Feature	Detail
Item Weight	3.34 pounds
Color	Gray

WARRANTY AND SUPPORT

LNMBBS offers a **1-year return and exchange service** for this product. If you encounter any issues or have questions not covered in this manual, please contact LNMBBS customer support for assistance. Refer to the product packaging or the official LNMBBS website for the most current contact information.

For additional resources and FAQs, please visit the LNMBBS support page.