

Manuals+

[Q & A](#) | [Deep Search](#) | [Upload](#)

[manuals.plus](#) /

› [YOOREAL](#) /

› [YOOREAL Digital Maintenance Hours Meter and Tachometer User Manual](#)

YOOREAL YR-HM027A

YOOREAL Digital Maintenance Hours Meter & Tachometer

Model: YR-HM027A

User Instruction Manual

PRODUCT OVERVIEW

The YOOREAL Digital Maintenance Hours Meter and Tachometer (Model YR-HM027A) is designed to monitor engine operation time and RPM for various small engines, including those found in garden mowers, tractors, generators, outboard motors, snowblowers, and pressure washers. It provides essential data for timely maintenance and optimal engine performance.



Image: The Yooreal Digital Maintenance Hours Meter, showing its compact design and attached wiring.

- **Hours Counter:** Tracks total and partial engine operating hours, with an initial hours programming feature.
- **Maintenance Timer (SVC):** Allows setting countdown timers for service intervals, such as oil or air filter changes.
- **RPM Gauge:** Displays real-time engine RPM and maximum RPM, with an adjustable alert RPM function to prevent overspeeding.
- **Easy Installation:** Designed for straightforward installation using either adhesive or screws.
- **Durability:** Features a built-in replaceable CR2032 battery and favorable waterproof resistance (IP67).

SAFETY INFORMATION

This product contains a button cell battery. Button cell batteries can cause severe internal chemical burns if swallowed. Keep new and used batteries away from children. Seek immediate medical attention if a battery is swallowed or inserted into any part of the body.

<p>⚠ WARNING</p> <ul style="list-style-type: none"> • INGESTION HAZARD: This product contains a button cell or coin battery. • DEATH or serious injury can occur if ingested. • A swallowed button cell or coin battery can cause Internal Chemical Burns in as little as. • KEEP new and used batteries OUT OF REACH of CHILDREN. • Seek immediate medical attention suspected to be swallowed or inserted insied any part of the body. 	<p>⚠ ADVERTENCIA</p> <ul style="list-style-type: none"> • PELIGRO DE INGESTIÓN: Este producto contiene una pila de botón o una pila de botón. • LA MUERTE o lesiones graves pueden ocurrir si se ingiere. • Una pila de botón o una pila de botón tragada puede causar quemaduras químicas internas en tan solo 2 horas. • MANTENGA las pilas nuevas y usadas FUERA DEL ALCANCE de los NIÑOS. • Busque atención médica inmediata si un Se sospecha que la batería se ingiere o se inserta en cualquier parte del cuerpo. 	<p>⚠ VARNING</p> <ul style="list-style-type: none"> • FARA VID FÖRTÄRING: Denna produkt innehåller ett knappcells- eller myntbatteri. • Dödsfall eller allvarlig skada kan inträffa vid förtäring. • Ett knappcells- eller myntbatteri som sväljs kan orsaka inre kemiska brännskador på så kort tid som 2 timmar. • FÖRVARA nya och använda batterier utom räckhåll för barn. • Sök omedelbart läkarvård om du misstänker att ett batteri har sväljts eller förts in i någon del av kroppen. 
<p>⚠ AVVERTIMENTO</p> <ul style="list-style-type: none"> • PERICOLO DI INGESTIONE: Questo prodotto contiene una pila a bottone o una batteria a bottone. • MORTE o lesioni gravi possono verificarsi se ingerito. • Una pila a bottone o una batteria a bottone ingerita possono causare ustioni chimiche interne in appena 2 ore. • TENERE le batterie nuove e usate FUORI PORTATA di BAMBINI. • Consultare immediatamente un medico se si sospetta che una batteria sia stata ingerita o inserita in qualsiasi parte del corpo. 	<p>⚠ AVERTISSEMENT</p> <ul style="list-style-type: none"> • RISQUE D 'INGESTION : Ce produit contient une pile bouton ou une pile bouton. • La MORT ou des blessures graves peuvent survenir en cas d' ingestion. • Une pile bouton ou une pile bouton avalée peut provoquer des brûlures chimiques internes en aussi peu que 2 heures. • GARDEZ les piles neuves et usagées HORS DE PORTÉE des ENFANTS. • SUCHEN Sie sofort einen Arzt auf, wenn der Verdacht besteht, dass eine Batterie verschluckt oder in einen Körperteil eingeführt wurde. 	<p>⚠ OSTRZEŻENIE</p> <ul style="list-style-type: none"> • NIEBEZPIECZEŃSTWO POŁKNIĘCIA: Ten produkt zawiera baterię guzikową lub pastylkową. • Połknięcie grozi śmiercią lub poważnymi obrażeniami. • Połknięcie baterii guzikowej lub pastylkowej może spowodować wewnętrzne oparzenia chemiczne w ciągu zaledwie 2 godzin. • NOWE i ZUŻYTE BATERIE NALEŻY PRZECHOWYWAĆ Z DALĄ OD DZIECI. • W przypadku podejrzenia połknięcia lub włożenia baterii do jakiegokolwiek części ciała należy natychmiast skontaktować się z lekarzem. 
<p>⚠ WARNUNG</p> <ul style="list-style-type: none"> • VERSCHLUCKUNGSGEFAHR: Dieses Produkt enthält eine Knopfzelle oder Knopfzelle. • TOD oder schwere Verletzungen können bei Verschluck-ken auftreten. • Eine verschluckte Knopfzelle oder Knopfzelle kann in nur 2 Stunden innere Verätzungen verursachen. • BEWAHREN Sie neue und gebrauchte Batterien AUSSERHALB DER REICHWEITE von KINDER. • Suchen Sie sofort einen Arzt auf, wenn der Verdacht besteht, dass eine Batterie verschluckt oder in einen Körperteil eingeführt wurde. 	<p>⚠ WAARSCHUWING</p> <ul style="list-style-type: none"> • GEVAAR VOOR INSLIKKEN: Dit product bevat een knooppel- of knooppelbatterij. • DOOD of ernstig letsel kan optreden bij inslikken. • Een ingeslikte knooppel of knooppelbatterij kan in slechts 2 uur interne chemische brandwonden veroorzaken. • HOUD nieuwe en gebruikte batterijen BUITEN BEREIK van KINDEREN. • Zoek onmiddellijk medische hulp als het vermoeden bestaat dat een batterij is ingeslikt of in een deel van het lichaam is geplaatst. 	<p>⚠ UYARI</p> <ul style="list-style-type: none"> • YUTMA TEHLİKESİ: Bu ürün bir düğme hücre veya madeni para pil içerir. • Yutulması halinde ÖLÜM veya ciddi yaralanma meydana gelebilir. • Yutulan bir düğme pil veya madeni para pil 2 saat gibi kısa bir sürede İç Kimyasal Yanıklara neden olabilir. • Yeni ve kullanılmış pilleri ÇOCUKLARIN ULAŞAMAYACAĞI YERLERDE TUTUN. • Bir pilin yutulduğundan veya vücudun herhangi bir yerine sokulduğundan şüpheleniliyorsa derhal tıbbi yardım alın. 

Image: Multi-language warning label regarding the dangers of button cell batteries if swallowed.

SETUP AND INSTALLATION

Before installation, ensure the product surface and the mounting location are free from moisture or grease.

Battery Activation

The device comes with a pre-installed CR2032 battery. Before first use, remove the insulating sheet from the battery compartment to activate the meter.

DIMENSION



Replaceable battery CR2032



Wire total length:68.8 inches

Image: Rear view of the meter showing the replaceable CR2032 battery compartment and product dimensions.

Wiring for Signal Pickup

Connect the red wire by wrapping it 5-8 times around the spark plug wire. The black wire is for ground, which helps in achieving a more stable signal. The red wire has a length of 5.74 ft (1.75m) and can be shortened or extended (not exceeding 9.84 ft) as needed.

Mounting Options

The meter can be mounted using either the provided adhesive velcro or screws.

This product can be directly velcro installation or with screws ,the installation method is as follows:

Velcro installation:



Screw installation:

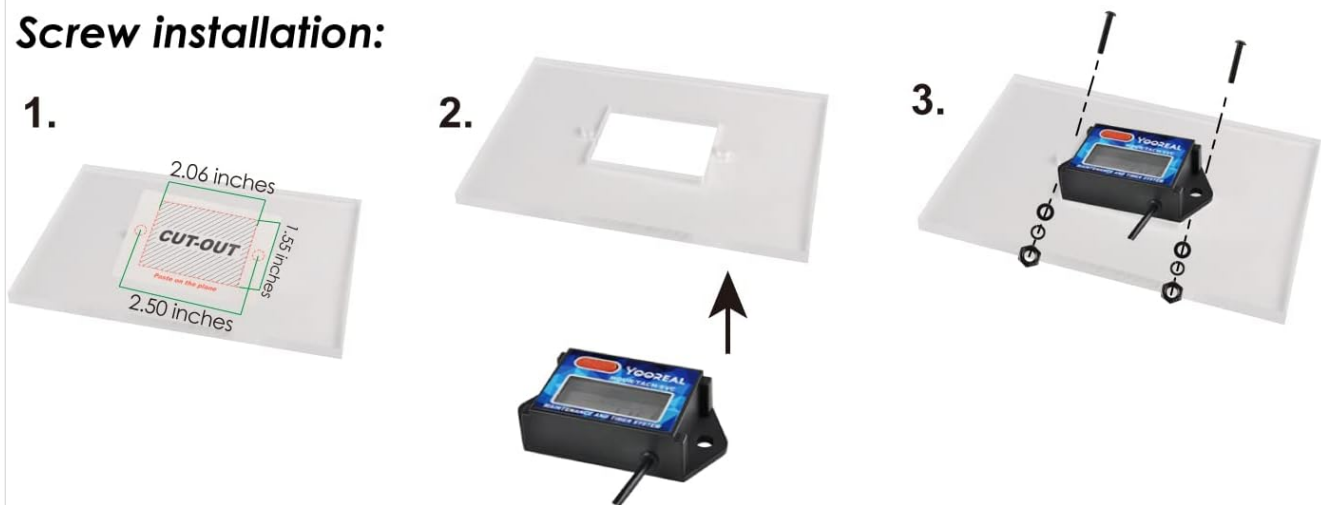

The product surface and the pasted place without moisture or grease.

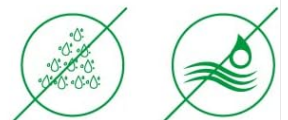

Image: Step-by-step diagrams illustrating both velcro and screw installation methods for the meter.

Velcro Installation:

1. Clean the mounting surface thoroughly.
2. Apply the adhesive velcro to the back of the meter.
3. Press the meter firmly onto the desired clean, dry surface.

Screw Installation:

1. Use the provided cut-out sticker to mark the drilling locations.
2. Drill pilot holes as marked.
3. Secure the meter using the provided screws and washers.

PRODUCT ACCESSORIES LIST



Product*1	User manual*1	3M adhesive velcro*1	Battery CR2032*1
Cable tie*2	M6×35 screws*2	M6×16 screws*2	M6 hex nut*4
M6 flat washer*4	M6 spring washers*4	Cut-out sticker*1	Yooreal color box*1

Image: A comprehensive list of included product accessories, such as the meter, user manual, velcro, battery, cable ties, screws, and cut-out sticker.

OPERATING INSTRUCTIONS

Hours Counter (TOT)

The meter tracks the total operating hours of the engine. The timing range is 0 to 99999 hours. For new meter replacements, an initial hours value can be programmed within 1 hour before the engine starts working.

Partial Hours (JOB)

This feature allows tracking of partial operating hours, which can be reset for individual tasks or job durations.

Service Interval Timer (SVC)

Set maintenance timers to remind you when service is due (e.g., oil changes, air filter replacement). The maintenance timers can be set from 5 to 2000 hours, with an 'OFF' selection option.

TOT - TOTAL HOURS OF OPERATION

TOT initial hours can be set within 1 hour before engine working .



Timing range:0-999999H

Accuracy:0.1/1 H



JOB

PARTIAL HOURS

It is resettable



SVC

SERVICE INTERVAL TIME

Timing range: 5-2000 H with OFF selection

Image: Display showing Total Hours (TOT), resettable Partial Hours (JOB), and Service Interval Time (SVC) with their respective timing ranges.

RPM Gauge

Monitor the engine's revolutions per minute (RPM) and maximum RPM. The RPM range is 0-25000 RPM. You can set an Alert RPM to prevent engine overspeeding. The meter also features programmable engine firing patterns to adjust idle speed status.

RPM/MAX RPM

RPM range: 0-25000RPM, Refresh rate: 0.5s/1s
Resolution: 10 RPM

ALERT RPM

Alert range: 1000-25000RPM with OFF selection



9 different programming

1P1R	1P2R	2P1R
3P1R	3P2R	4P1R
5P2R	6P1R	8P1R

Image: Display showing current RPM, Max RPM, and Alert RPM settings, along with a table of programmable firing patterns.

24-Hour Clock

The device also includes a 24-hour clock display.

MAINTENANCE

The YOOREAL meter is designed for low maintenance. The built-in CR2032 battery is replaceable, ensuring long endurance. The device has a favorable waterproof resistance rating of IP67, protecting it from dust and immersion in water up to 1 meter for 30 minutes.





WATERPROOF

IP67
Waterproof



Electric Saw Trimmer



Land Cutter



Lawn Mower Edging Machine



Generator



Turf Trimmer

Image: Illustration of the meter submerged in water, demonstrating its IP67 waterproof rating, along with examples of compatible outdoor power equipment.

For battery replacement, refer to the battery activation section under "Setup and Installation" for instructions on accessing the battery compartment.

TROUBLESHOOTING

If you encounter issues with your YOOREAL Digital Maintenance Hours Meter, consider the following common troubleshooting steps:

- **No Display/Meter Not Turning On:**
 - Ensure the insulating sheet has been removed from the CR2032 battery.
 - Check if the CR2032 battery is correctly installed and has sufficient charge. Replace if necessary.
- **Inaccurate RPM/Hours Reading:**
 - Verify that the red signal wire is securely wrapped 5-8 times around the spark plug wire.

- Ensure the black ground wire is properly connected for a stable signal.
- Check for any damage to the signal wires.
- Confirm the correct engine firing pattern is selected in the meter settings.

- **Buttons Not Responding:**

- Ensure the meter is not exposed to extreme temperatures or moisture beyond its IP67 rating.
- Try removing and reinserting the battery to reset the device.

If problems persist after attempting these steps, please contact YOOREAL customer support for further assistance.

SPECIFICATIONS

Brand	YOOREAL
Model Number	YR-HM027A
Material	Plastic
Dimensions (L x W x H)	3.15 x 1.56 x 0.79 inches (80 x 39.6 x 20 mm)
Item Weight	3.1 ounces (88 Grams)
UPC	787997589717
Hours Tracking Range (TOT)	0 to 99999 H
Maintenance Timer Range (SVC)	5 to 2000 H / OFF
RPM Range	0 to 25000 RPM
Refresh Rate	0.5s/1s
Resolution	10 RPM
Alert RPM Range	1000-25000 RPM with OFF selection
Battery Type	CR2032 Lithium Metal (included, replaceable)
Waterproof Rating	IP67
Clock System	24-H

WARRANTY AND SUPPORT

YOOREAL provides a **2-year guarantee** for this product, backed by excellent after-sales and technical group support. During this period, if there is any quality problem with the product, YOOREAL provides free replacement service.

For any inquiries or assistance, the YOOREAL Care Team is available 7 days a week, 24 hours a day, offering professional customer support and hassle-free replacement/return services.

[Visit the YOOREAL Store on Amazon](#)

