

CNBINGO S1-201+M1-P111

CNBINGO Double Touch Light Switch with Schuko Socket

MODEL: S1-201+M1-P111

User Instruction Manual

1. Introduction

Thank you for choosing the CNBINGO Double Touch Light Switch with integrated Schuko Socket. This product combines modern design with practical functionality, offering touch-sensitive control for two lighting circuits and a standard power outlet. This manual provides essential information for safe installation, operation, and maintenance of your device.

Please read this manual thoroughly before installation and use, and retain it for future reference.

2. Important Safety Information

- **Electrical Installation:** Installation must be performed by a qualified electrician in accordance with local electrical codes and regulations. Always turn off the main power supply at the circuit breaker before beginning any electrical work.
- **Voltage:** This device operates on 110-240V AC, 50-60Hz. Ensure your electrical system matches these specifications.
- **Neutral Conductor:** While the touch switch mechanism itself may not require a neutral conductor for its operation, the integrated Schuko socket requires a neutral connection for proper function. Therefore, a neutral wire must be present in the wall box for the complete unit.
- **Glass Panel Installation:** It is critical to install the glass panel **before** turning on the power supply. Testing the switch without the glass panel can lead to incorrect calibration of the touch sensor, potentially affecting its functionality after the glass is installed.
- **Product Type:** This is a 1-pole touch switch, not a changeover (2-way) switch for controlling a single light from multiple locations.
- **Functionality:** This device is **not** a Wi-Fi switch and does not support control via smart home systems like Alexa or Google Home. It is also **not** a dimmer switch and cannot adjust light intensity.
- **Child Protection:** The Schuko socket includes child protection features.

MÜSSEN SIE VOR DEM KAUF WISSEN

1. Dies ist ein 1- poliger Berührungsschalter, **kein Wechselschalter**. Kein Adapter, Neutral oder Erdungskabel erforderlich
2. Dies ist **kein WLAN Schalter**, kann nicht mit Alexa oder Google Home funktionieren.
3. Dies ist **kein Dimmer**, kann nicht dimmen.
4. **Bitte berühren Sie den Schalter nicht**, bevor die Glasplatte installiert wurde, sonst funktioniert er nicht. Denn wenn es ohne Glas getestet wird, merkt es sich den Abstand zwischen Pad und Figur und kann nach dem erneuten Aufsetzen des Glases nicht mehr gut funktionieren.



Nicht WLAN

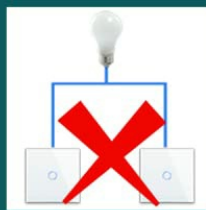

Nicht
Wechselschalter



Nicht
Dimmschalter



Berühren Sie
nicht die Platine

Figure 1: Important notes regarding product functionality and installation.

3. Product Features

- **Modern Design:** Features a sleek glass panel with touch-sensitive controls and status LEDs.
- **Durable Touch Panel:** Made of stylish glass (157 x 86 mm), smooth, easy to clean, scratch-resistant, and maintains its appearance over time.
- **Touch Switch:** Two independent touch switches, 1-pole switch-off. Each compartment supports up to 500W.
- **Status LED:** Strong/weak blue status LED indicates the on/off state of each switch.
- **Schuko Socket:** Single socket with child protection, supporting AC 16 Amp 250 V max.
- **High-Quality Construction:** Safe fireproof PC base with phosphor copper metal internals for optimal conductivity and safety.

4. Package Contents

The package typically includes:

- CNBINGO Double Touch Light Switch with Schuko Socket
- Mounting Screws (2 pieces)

- User Manual (this document)



Figure 2: Typical package contents.

5. Setup and Installation

Follow these steps for proper installation. Ensure power is OFF before proceeding.

5.1 Wiring Diagram

Refer to the diagram below for correct wiring connections. The unit requires Live (L) and Neutral (N) connections for the socket, and Live (L) and switched Live outputs (L1, L2) for the light switches.



Mounting

Vertical or Horizontal



Figure 3: Wiring terminals on the back of the unit.

- **L:** Live input for both switch and socket.
- **N:** Neutral input for the socket.
- **L1, L2:** Switched Live outputs for connecting to light fixtures. (This model has two switches, so L1 and L2 are relevant).

5.2 Mounting

The unit is designed for flush-mounted installation in a standard EU wall box. It can be installed either horizontally or vertically to suit your preference and existing decor.

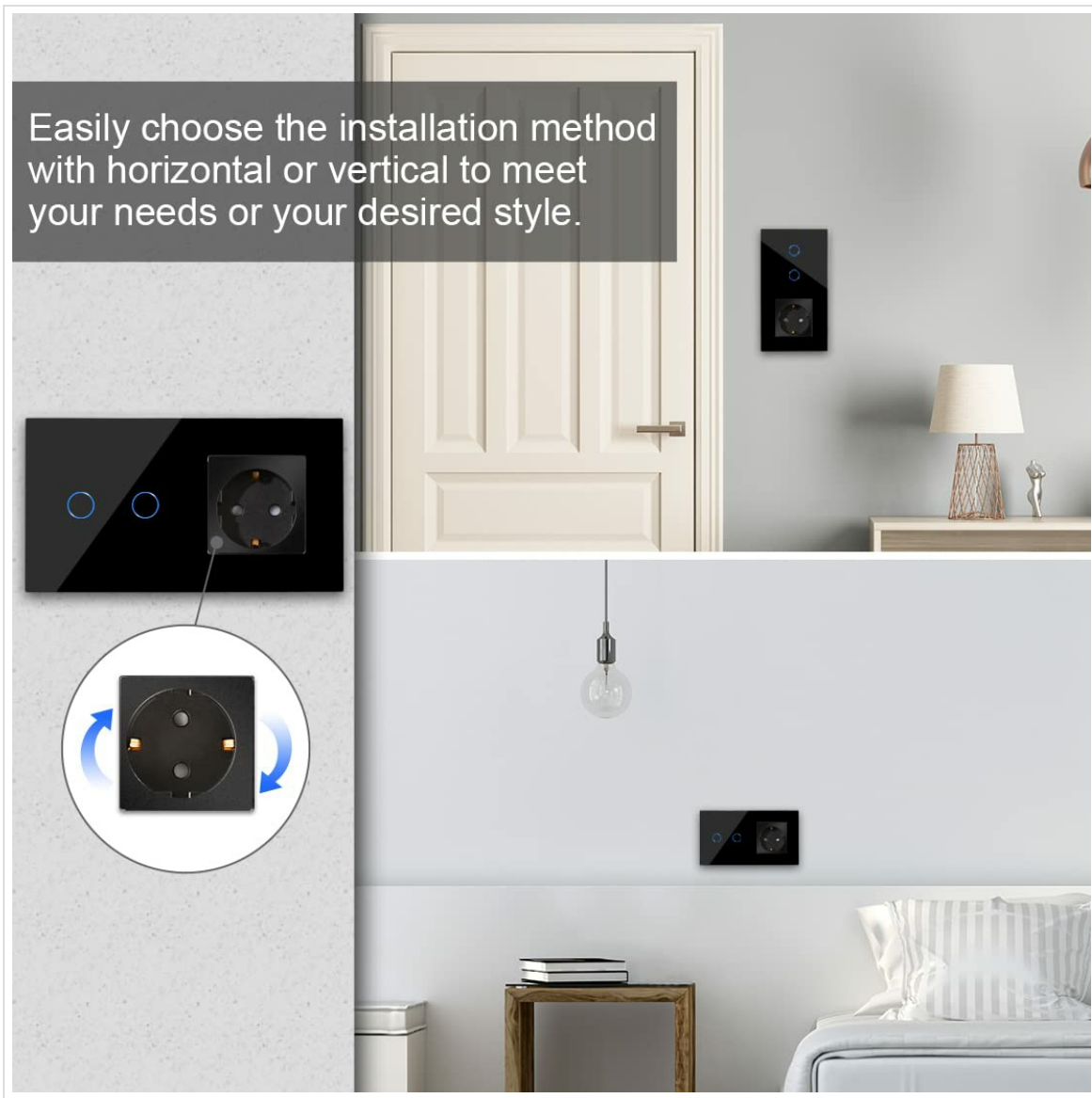

Figure 4: Installation options (horizontal or vertical).

1. Ensure the power supply to the installation area is turned OFF at the main circuit breaker.
2. Carefully remove the existing switch/socket from the wall box.
3. Connect the wires according to the wiring diagram (Figure 3). Securely fasten all wire connections.
4. Mount the switch unit into the wall box using the provided screws. Ensure it is flush and securely fixed.
5. Attach the glass front panel to the mounted unit. Ensure it clicks into place securely.
6. Once the glass panel is fully installed, restore power at the main circuit breaker.

Important: Do not restore power until the glass panel is securely installed. Failure to do so may result in improper touch sensor calibration.

6. Operating Instructions

6.1 Light Switch Operation

The light switch features two touch-sensitive areas on the glass panel.

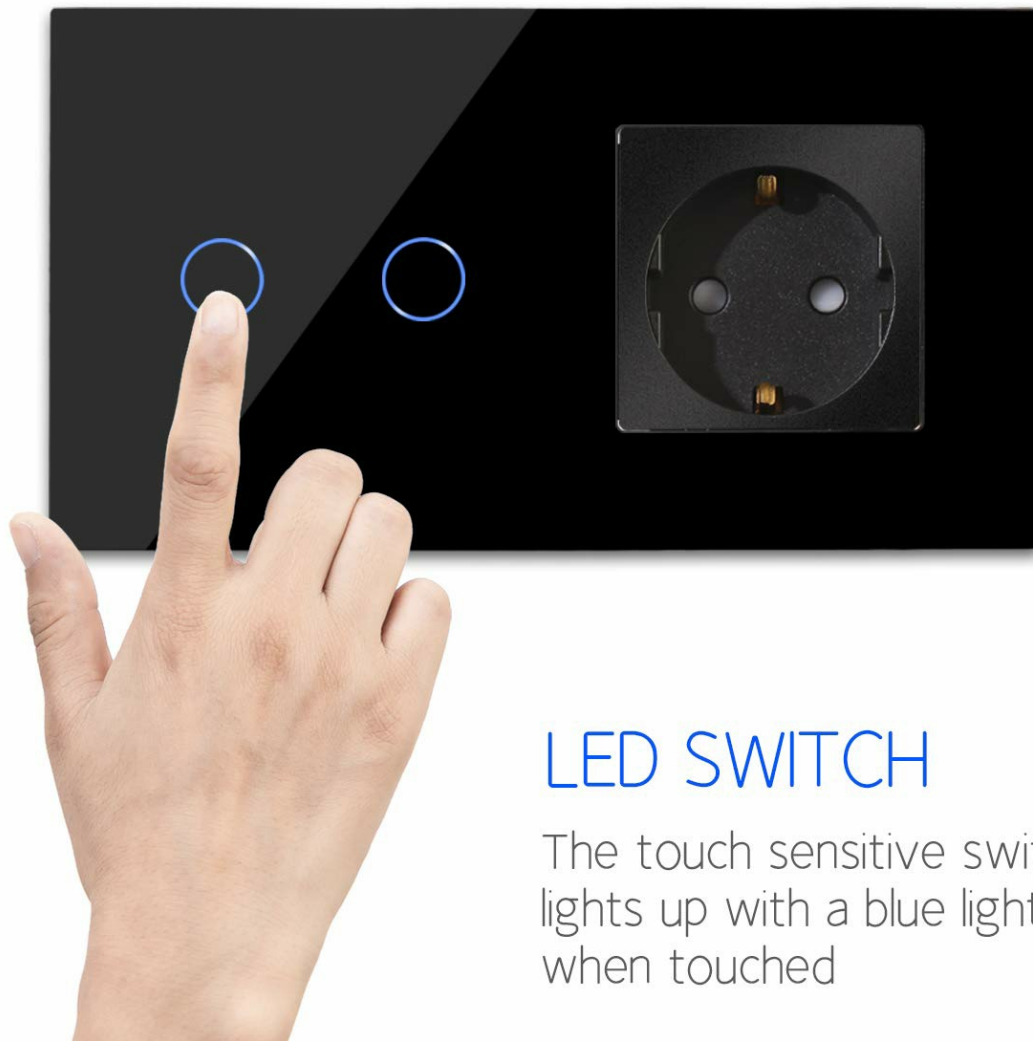

Figure 5: Touch operation with LED indicator.

- To turn a light ON or OFF, gently touch the corresponding circular area on the glass panel.
- A blue LED indicator will illuminate (strong or weak) to show the current status (ON/OFF) of the light circuit.

6.2 Schuko Socket Usage

The integrated Schuko socket functions as a standard power outlet.

- Insert the plug of your electrical appliance into the socket.
- Ensure the appliance's power requirements do not exceed the socket's maximum rating of 16 Amp 250 V.
- The socket features child protection, which may require slightly more force to insert a plug initially.

7. Maintenance

- **Cleaning:** The glass panel is smooth and easy to clean. Use a soft, damp cloth to wipe the surface. Avoid abrasive cleaners or harsh chemicals that could damage the glass or electronics.
- **Inspection:** Periodically inspect the unit for any signs of damage, loose connections, or wear. If any issues are found, disconnect power and consult a qualified electrician.

8. Troubleshooting

- **Switch Not Responding:**

- Ensure the glass panel was installed before power was restored. If not, disconnect power, re-install the glass panel, and then restore power.
- Check if the main power supply to the unit is active.
- Verify wiring connections are secure.

- **Socket Not Providing Power:**

- Check if the main power supply to the unit is active.
- Verify Live (L) and Neutral (N) wiring connections to the socket are correct and secure.
- Ensure the appliance plugged in is functioning correctly.

- **Lights Not Turning On/Off:**

- Check the light bulb/fixture for functionality.
- Verify the switched Live (L1, L2) connections to the light fixture are correct and secure.

If issues persist after troubleshooting, consult a qualified electrician or contact CNBINGO customer support.

9. Specifications

Model Number	S1-201+M1-P111
Product Dimensions	15.7 x 8.6 x 3.9 cm
Weight	280 g
Brand	CNBINGO
Color	Black
Material	Glass
Voltage	110-240V AC
Frequency	50-60Hz
Power Consumption	0.02W
Max. Load (per switch)	500W
Socket Amperage	16 Amps (max)
Socket Voltage	250V (max)
Operating Temperature	-20°C to +70°C



STANDARD SIZE

Fits EU standard flush-mounted box

Figure 6: Product dimensions.

10. Warranty and Support

CNBINGO offers a **5-year free warranty** on this product. For warranty claims or technical support, please contact CNBINGO customer service through your retailer or the official CNBINGO website. Please have your model number (S1-201+M1-P111) and purchase details ready when contacting support.



© 2025 CNBINGO. All rights reserved.

Related Documents - S1-201+M1-P111

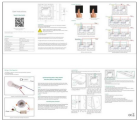

[CNBINGO Touch Light Switch User Manual and Instructions](#)

This manual provides detailed instructions for the CNBINGO Touch Light Switch, covering technical specifications, safety guidelines, installation procedures, usage, troubleshooting, and proper disposal. It ensures safe and efficient operation of the lighting control.

	<p>CNBINGO Touch 2 Way Switch User Manual and Installation Guide</p> <p>Comprehensive user instructions, technical specifications, wiring diagrams, and troubleshooting guide for the CNBINGO Touch 2 Way Light Switch. Learn how to install, synchronize, and maintain your smart light switch.</p>
	<p>User Instructions WiFi Dimmer Touch Switch - CNBINGO</p> <p>Comprehensive user manual for the CNBINGO WiFi Dimmer Touch Switch, detailing installation, technical specifications, app setup, troubleshooting, and voice control integration with Alexa and Google Assistant.</p>
	<p>CNBINGO Touch Dimmer Switch User Instructions and Wiring Guide</p> <p>Detailed user instructions and wiring guide for the CNBINGO Touch Dimmer Switch, covering technical data, usage, installation, troubleshooting, and applicable lamps. Ensure safe and proper installation by a trained specialist.</p>