

LITTLE TREE 1029

LITTLE TREE Free Standing Wood Closet Clothes Rack, Model 1029 - User Manual

Model: 1029 | Brand: LITTLE TREE

1. INTRODUCTION

Thank you for choosing the LITTLE TREE Free Standing Wood Closet Clothes Rack, Model 1029. This versatile and sturdy garment rack is designed to provide ample storage for your clothing, accessories, and other items, helping you organize your living space efficiently. Please read this manual carefully before assembly and use to ensure safe operation and optimal performance of your product.

2. SAFETY INFORMATION

- Always follow the assembly instructions precisely.
- Do not exceed the maximum weight capacity of 450 lbs for the entire unit, 50 lbs for garment rods, and 40 lbs for each shelf. Overloading can cause instability and damage.
- Ensure all screws and fasteners are securely tightened before use. Periodically check for loose connections.
- Place the unit on a flat, stable surface to prevent tipping.
- Keep small parts and packaging materials away from children to prevent choking hazards.
- Do not climb on the unit or allow children to hang from the garment rods.

3. PACKAGE CONTENTS

Before beginning assembly, please verify that all components listed in the packaging are present and undamaged. If any parts are missing or damaged, please contact customer service for assistance.

- Heavy-duty metal frame components
- Thick particle board shelves
- Garment hanging rods
- Assembly hardware (screws, bolts, Allen wrench)
- Adjustable foot pads
- Instruction manual

4. SETUP AND ASSEMBLY

Assembly is required for this product. All necessary tools and instructions are included. It is recommended to assemble the unit with two people for ease and safety, though it can be done by one person. Follow the step-by-step diagrams provided in the included instruction booklet.

General Assembly Tips:

- Lay out all parts and hardware before starting.
- Do not fully tighten screws until all components are loosely assembled. This allows for easier alignment.
- Ensure all parts are oriented correctly according to the diagrams.

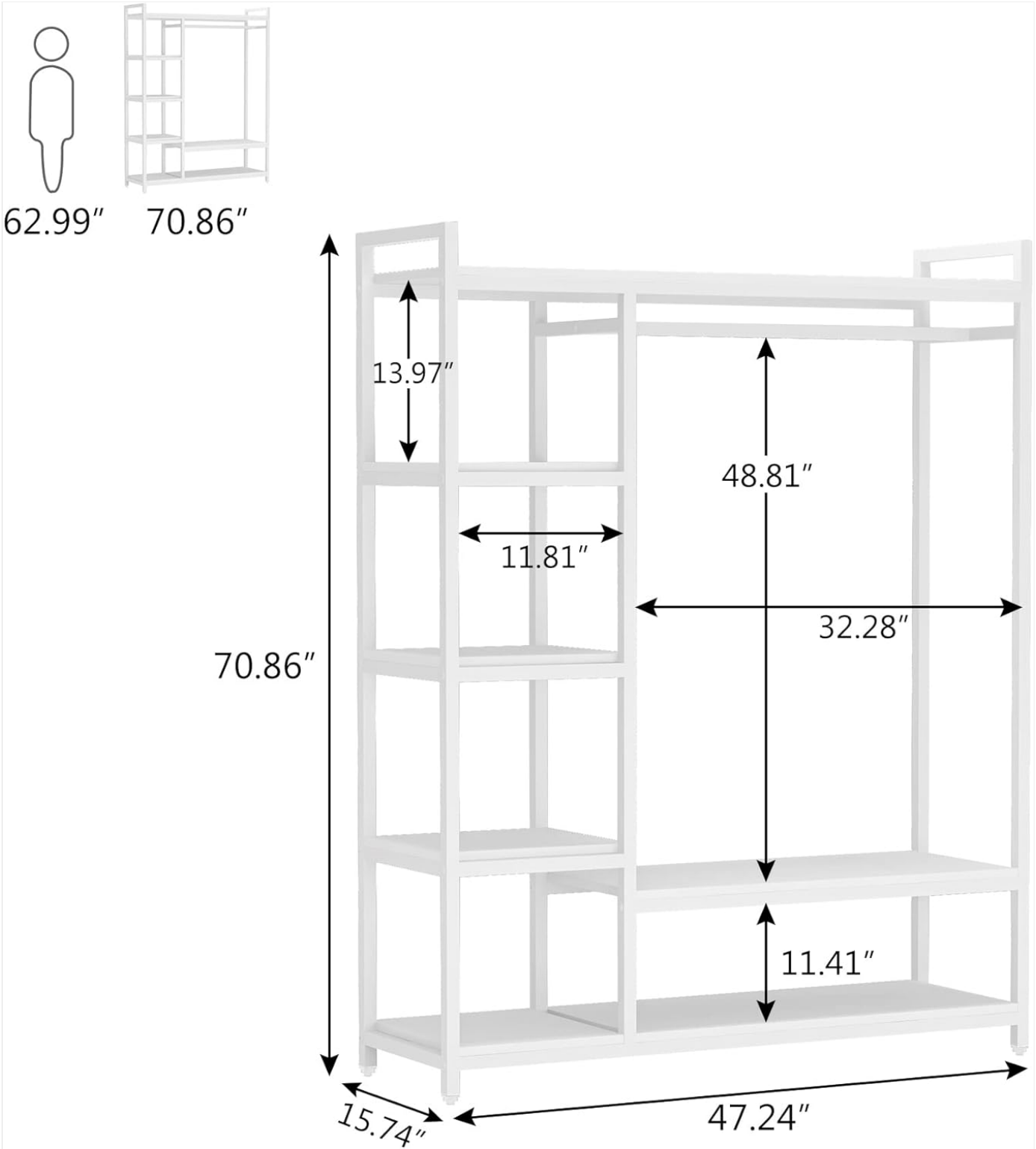

Figure 4.1: Assembly Diagram with Dimensions. This diagram illustrates the overall dimensions and key measurements of the closet rack, including shelf heights and hanging rod length.

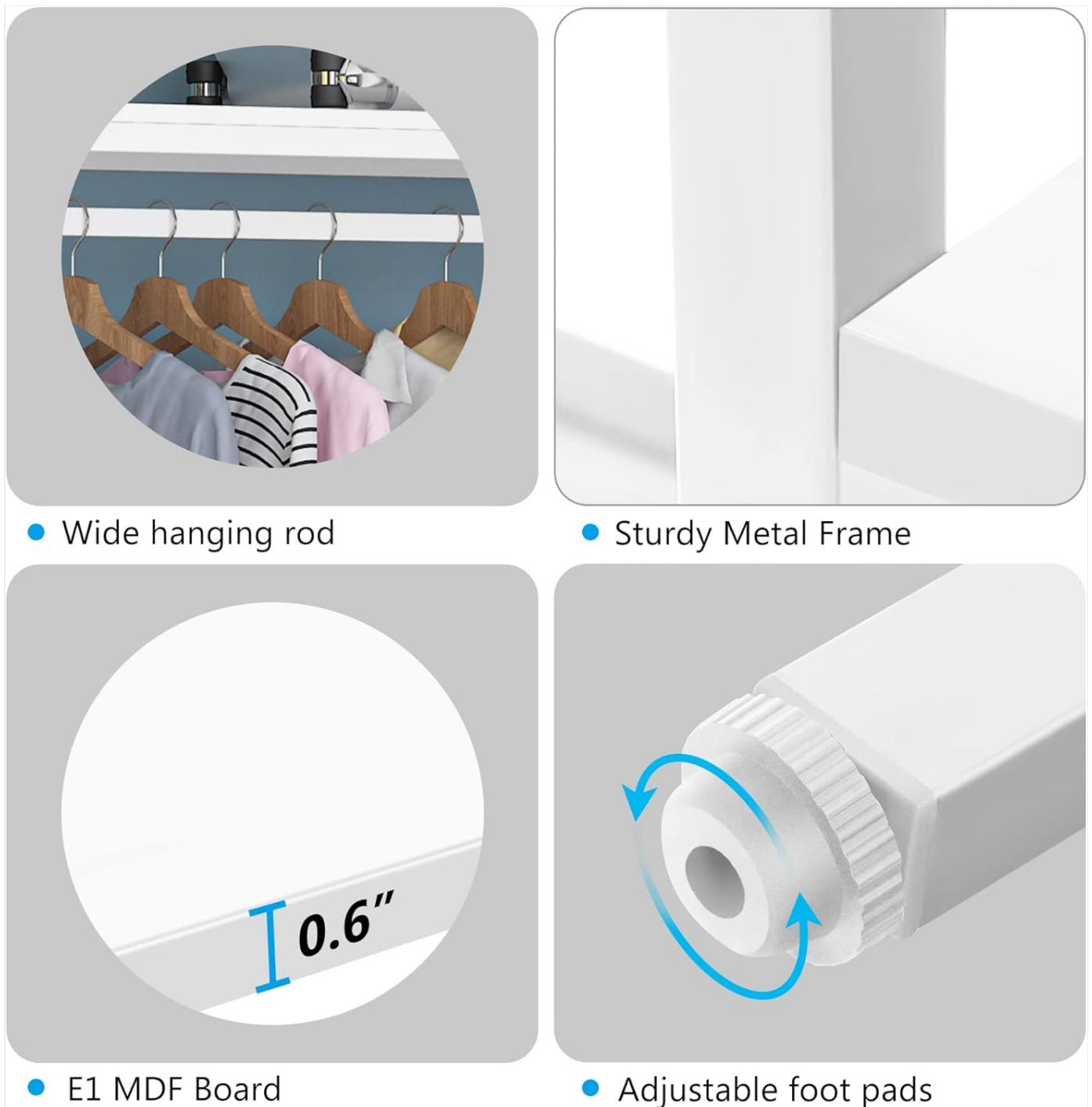

Figure 4.2: Detailed Features. This image highlights the wide hanging rod, sturdy metal frame construction, the 0.6-inch thick E1 MDF board for shelves, and the adjustable foot pads for stability on uneven surfaces.

Your browser does not support the video tag.

Video 4.1: Closet Rack Overview. This video provides a brief overview of the LITTLE TREE closet rack, showcasing its large storage space and stable, sturdy construction.

5. OPERATION AND USAGE

The LITTLE TREE Free Standing Wood Closet Clothes Rack offers a versatile storage solution for various items. Utilize the hanging rods for garments that require hanging, such as shirts, dresses, and coats. The multiple shelves are ideal for folded clothes, shoes, bags, and storage bins.

- **Hanging Rods:** Hang clothes evenly to distribute weight. Each garment rod can hold up to 50 lbs.
- **Shelves:** Arrange folded items, shoes, or decorative storage boxes on the shelves. Each shelf can bear up to 40 lbs.
- **Top Shelf:** The top surface can be used for larger items like luggage or seasonal bedding.

Strong bearing capacity

load capacity up to 350 lbs

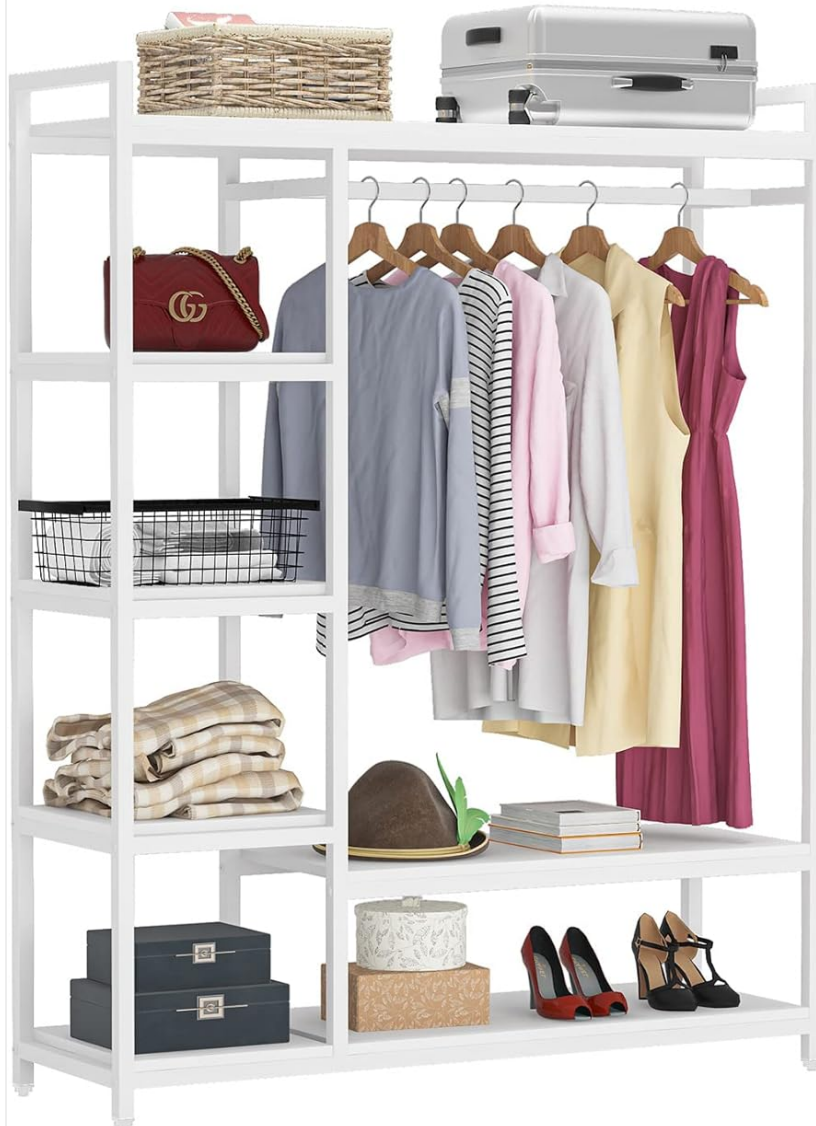

Hanging rod bears up to 80 lb



Each shelf bears up to 40 lb

Figure 5.1: Weight Capacity Guidelines. This diagram visually represents the maximum load capacity for the hanging rod (up to 50 lbs) and individual shelves (up to 40 lbs), emphasizing the unit's strong bearing capacity.



Top Shelf Storage Space

Figure 5.2: Top Shelf Storage Space. This image shows the spacious top shelf, suitable for storing larger items such as luggage or extra pillows.

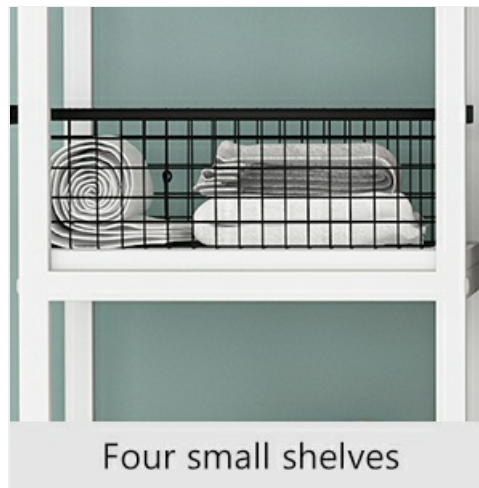

Figure 5.3: Four Small Shelves. This image details the four smaller shelves on the side of the unit, perfect for organizing folded garments, accessories, or small storage bins.



Figure 5.4: Two Bottom Shelves. This image displays the two lower shelves, ideal for shoe storage or larger bins.

Your browser does not support the video tag.

Video 5.1: Freestanding Closet Organizer in Use. This video demonstrates the practical application of the freestanding closet organizer, showing various items stored on its shelves and hanging rods.

6. MAINTENANCE

To maintain the appearance and longevity of your closet rack, follow these simple maintenance guidelines:

- **Cleaning:** Wipe with a dry cloth to remove dust and dirt. Avoid using harsh chemicals or abrasive cleaners, which can damage the finish.
- **Inspection:** Periodically check all screws and connections to ensure they remain tight. Re-tighten if necessary.
- **Placement:** Avoid placing the unit in direct sunlight or near heat sources to prevent material warping or discoloration.

7. TROUBLESHOOTING

If you encounter any issues with your LITTLE TREE Free Standing Wood Closet Clothes Rack, please refer to the following common solutions:

Problem	Possible Cause	Solution
---------	----------------	----------

Problem	Possible Cause	Solution
Unit is wobbly or unstable.	Loose screws or uneven floor.	Ensure all screws are tightened. Adjust the foot pads to level the unit on uneven surfaces.
Missing parts during assembly.	Packaging error.	Carefully check all packaging materials. If parts are still missing, contact customer service with your purchase details.
Difficulty aligning parts during assembly.	Screws tightened too early.	Loosen all screws slightly, align the parts, then gradually tighten all screws evenly.

For issues not covered here, or if problems persist, please contact LITTLE TREE customer service for further assistance.

8. SPECIFICATIONS

Feature	Detail
Brand	LITTLE TREE
Model Number	1029
Material	Engineered Wood (E1 MDF Board) and Heavy-Duty Metal Frame
Color	White&white
Product Dimensions	15.74 x 47.24 x 70.86 inches (Depth x Width x Height)
Item Weight	34 pounds
Maximum Recommended Load (Total)	450 Pounds
Hanging Rod Capacity	50 Pounds
Each Shelf Capacity	40 Pounds
Special Feature	Portable, Freestanding, Adjustable Foot Pads
Product Care Instructions	Wipe with Dry Cloth
UPC	036659243772

9. WARRANTY AND SUPPORT

LITTLE TREE offers an 18-month warranty on this product. We are committed to providing friendly customer service. If your item arrives damaged in any way, or if you have any questions regarding assembly, operation, or warranty claims, please do not hesitate to contact us.

For support, please visit the [LITTLE TREE Store on Amazon](#) or refer to the contact information provided in your purchase documentation.



