

BESTISAN SW65C

BESTISAN SW65C 6.5" Powered Subwoofer User Manual

Model: SW65C

1. INTRODUCTION

Thank you for choosing the BESTISAN SW65C 6.5-inch Powered Subwoofer. This compact yet powerful subwoofer is designed to enhance your home audio experience by delivering deep, rich bass, perfect for music, movies, and gaming. Its down-firing design and versatile connectivity options make it an ideal addition to any small-to-mid sized room, studio, or home theater setup. Please read this manual thoroughly before operating your subwoofer to ensure proper setup and optimal performance.



Image: Front view of the BESTISAN SW65C 6.5-inch Powered Subwoofer, showcasing its sleek black design.

2. PACKAGE CONTENTS

Please check the package carefully to ensure all items are present and in good condition:

- BESTISAN SW65C Powered Subwoofer
- Power Adapter
- Stereo RCA to 3.5mm Audio Cable
- Quick Start Guide / User Manual

Package Included



Powered Subwoofer

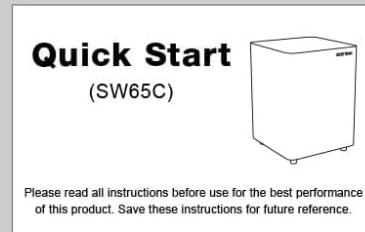

User manual



Power adapter



Powered Subwoofer
Coaxial cable(1.5M)

Image: Visual representation of the items included in the BESTISAN SW65C package: the subwoofer unit, power adapter, coaxial cable, and user manual.

3. PRODUCT OVERVIEW

3.1 Key Features

- **Powered Subwoofer:** A perfect solution for small-to-mid size rooms.
- **6.5 Inch Down Firing Woofer:** Maximizes floor coupling for room-shaking bass. The unique downward-firing design ensures efficient use of space while enhancing low-frequency extension.
- **LFE & Line Inputs:** Ensures compatibility with most receivers, bookshelf speakers, and soundbars.
- **Bass Control:** Features separate knobs for bass level adjustment and master volume control for fine-tuning.
- **Compact Size:** Measuring approximately 9.3"D x 9.3"W x 13"H, it fits effortlessly into tight spots.

3.2 Controls and Connections

The rear panel of the SW65C subwoofer provides all the necessary controls and input/output connections for integration into

your audio system.



Image: Detailed view of the BESTISAN SW65C subwoofer's rear panel, showing all control knobs and input/output ports.

1. **VOLUME:** Adjusts the overall output volume of the subwoofer.
2. **LOW PASS (60Hz-160Hz):** Controls the crossover frequency, determining the highest frequency the subwoofer will reproduce.
3. **PHASE (0°/180°):** Adjusts the phase of the subwoofer output relative to the main speakers.
4. **AUX (3.5mm):** Auxiliary input for connecting devices with a 3.5mm audio output.
5. **L/R (Line In):** RCA stereo line-level inputs for connecting to a receiver or other audio source.
6. **LFE (Low-Frequency Effects):** Dedicated input for connecting to the LFE output of an AV receiver.
7. **SPEAKER IN (R/L):** Speaker-level inputs for connecting directly from your amplifier's speaker outputs.
8. **SPEAKER OUT (R/L):** Speaker-level outputs to pass the signal to your main speakers.
9. **LED:** Power indicator light.
10. **DC IN:** Power adapter input.
11. **POWER SWITCH:** Turns the subwoofer on or off.

3.3 Dimensions

The BESTISAN SW65C is designed with a compact footprint to seamlessly integrate into various living spaces.

Product Dimensions: 9.3" (Depth) x 9.3" (Width) x 13" (Height)

Item Weight: 10.5 Pounds



Image: Diagram illustrating the compact dimensions of the BESTISAN SW65C subwoofer, showing its height, width, and depth.

4. SETUP

4.1 Placement

Optimal placement of your subwoofer is crucial for achieving the best bass response in your room. Due to its down-firing design, the SW65C benefits from being placed on a solid surface. Experiment with different locations, such as corners or along walls, to find the spot that provides the most balanced and impactful bass for your listening area. Avoid placing it directly against a wall or in a cabinet that might restrict airflow or cause excessive resonance.



Image: An example of the BESTISAN SW65C subwoofer placed next to a bookshelf in a living room setting, demonstrating its compact size and ease of integration.

4.2 Connecting Your Subwoofer

The SW65C offers multiple connection options to integrate with your existing audio system.

4.2.1 LFE Input Connection (Recommended for AV Receivers)

1. Locate the LFE or Subwoofer Output on your AV receiver.
2. Connect a single RCA cable (not included) from the LFE/Subwoofer Output of your receiver to the LFE input on the SW65C subwoofer.
3. Ensure your receiver's settings are configured to send low-frequency effects to the subwoofer.

4.2.2 Line Input (RCA) Connection

1. Connect RCA cables (not included) from the stereo pre-out (L/R) or line-out of your audio source (e.g., stereo receiver, pre-amplifier) to the L/R Line Inputs on the SW65C subwoofer.
2. If connecting to a device with a 3.5mm output, use the provided Stereo RCA to 3.5mm Audio Cable to connect to the AUX input.

4.2.3 Speaker Level Input/Output Connection

This method is used when your amplifier or receiver does not have dedicated subwoofer or line-level outputs.

1. Connect speaker wires from your amplifier's main speaker outputs to the SPEAKER IN terminals on the subwoofer. Ensure correct polarity (+ to + and - to -).
2. Connect speaker wires from the SPEAKER OUT terminals on the subwoofer to your main passive speakers. Ensure correct polarity.



Image: The BESTISAN SW65C subwoofer integrated into a home theater setup, positioned next to a TV and soundbar, illustrating its role in enhancing surround sound.

5. OPERATING INSTRUCTIONS

5.1 Powering On/Off

- Connect the power adapter to the DC IN port on the subwoofer and then to a wall outlet.
- Flip the POWER SWITCH to the 'ON' position. The LED indicator will illuminate.
- To turn off, flip the POWER SWITCH to the 'OFF' position.

5.2 Adjusting Controls

- **VOLUME:** Rotate the VOLUME knob to increase or decrease the subwoofer's output level. Start with a low volume and gradually increase it to blend with your main speakers.
- **LOW PASS (Crossover Frequency):** This knob allows you to set the upper frequency limit for the subwoofer. Adjust it to blend smoothly with your main speakers. A common starting point is 80Hz, but it may vary depending on your main speakers' low-frequency capabilities.
- **PHASE (0°/180°):** The phase switch helps ensure that the subwoofer's sound waves are in sync with your main speakers. Listen to your audio and try both 0° and 180° settings to determine which provides the most impactful and cohesive bass.

6. MAINTENANCE

To ensure the longevity and optimal performance of your BESTISAN SW65C subwoofer, follow these maintenance guidelines:

- **Cleaning:** Use a soft, dry cloth to wipe down the exterior of the subwoofer. Do not use liquid cleaners, aerosols, or abrasive chemicals, as they may damage the finish.
- **Ventilation:** Ensure adequate ventilation around the subwoofer. Do not block any ventilation openings.
- **Environment:** Keep the subwoofer away from direct sunlight, heat sources, excessive dust, moisture, and extreme temperatures.
- **Handling:** Avoid dropping or subjecting the subwoofer to strong impacts.

7. TROUBLESHOOTING

If you encounter any issues with your subwoofer, please refer to the following common problems and solutions:

Problem	Possible Cause	Solution
No Sound from Subwoofer	<ul style="list-style-type: none">• Power not connected or turned on.• Incorrect input selection on receiver.• Volume too low.• Cables loose or faulty.	<ul style="list-style-type: none">• Check power connection and switch.• Ensure correct input is selected on your receiver/source.• Increase subwoofer volume.• Verify all cables are securely connected and undamaged.
Distorted or Boomy Bass	<ul style="list-style-type: none">• Subwoofer volume too high.• Incorrect crossover frequency.• Poor placement.• Phase mismatch.	<ul style="list-style-type: none">• Decrease subwoofer volume.• Adjust the LOW PASS knob to a lower frequency.• Try repositioning the subwoofer.• Toggle the PHASE switch (0°/180°) to find the best setting.

Problem	Possible Cause	Solution
Humming or Buzzing Noise	<ul style="list-style-type: none">• Ground loop issue.• Loose cable connections.• Interference from other electronics.	<ul style="list-style-type: none">• Try plugging the subwoofer into a different electrical outlet.• Ensure all audio cables are securely connected.• Move the subwoofer or audio cables away from power cords or other electronic devices.

If the problem persists after trying these solutions, please contact BESTISAN customer support for further assistance.

8. SPECIFICATIONS

Detailed technical specifications for the BESTISAN SW65C Powered Subwoofer:

Feature	Specification
Model Name	SW65C
Speaker Type	Subwoofer
Woofer Diameter	6.5 Inches
Speaker Maximum Output Power	400 Watts
Frequency Response	35Hz-200Hz
Connectivity Technology	Auxiliary, RCA (Wired)
Control Method	Manual Knobs
Product Dimensions	9.3"D x 9.3"W x 13"H
Item Weight	10.5 Pounds
Color	Black
Power Source	Corded Electric

9. WARRANTY AND SUPPORT

9.1 Limited Warranty

The BESTISAN SW65C Powered Subwoofer comes with a limited warranty. Please refer to the warranty card included in your package or visit the official BESTISAN website for detailed warranty terms and conditions. This warranty typically covers manufacturing defects and malfunctions under normal use.

9.2 Customer Support

For technical assistance, troubleshooting, or warranty claims, please contact BESTISAN customer support. You can usually find contact information (email, phone, or support portal) on the official BESTISAN website or in the Quick Start Guide provided with your product. Please have your model number (SW65C) and purchase details ready when contacting support.

