

## Manuals+

[Q & A](#) | [Deep Search](#) | [Upload](#)

[manuals.plus](#) /

› [GEEBOBO](#) /

› [GEEBOBO 5-Tiered Tall Plant Stand Instruction Manual](#)

### GEEBOBO ge-5tier-round-plant-stand-003

# GEEBOBO 5-Tiered Tall Plant Stand Instruction Manual

Model: ge-5tier-round-plant-stand-003

## INTRODUCTION

---

This manual provides detailed instructions for the assembly, operation, and maintenance of your GEEBOBO 5-Tiered Tall Plant Stand. Designed for both indoor and outdoor use, this stand offers a stylish and functional way to display multiple plants. Its tiered structure ensures each plant receives adequate light, while the durable pine wood construction provides stability and longevity.



Image: A woman watering plants displayed on the GEEBOBO 5-tiered plant stand, showcasing its use in a home environment.

## PACKAGE CONTENTS

Before assembly, please verify that all components listed below are present in your package. If any parts are missing or damaged, please contact customer support.

- Disc A (Large Base) - 1 pc
- Disc B (Small Shelves) - 5 pcs
- Legs (a1, a2, b, c, d, e) - Various quantities as per diagram
- Screws (S1, S2, S) - Total 18 screws (S) plus S1 and S2
- Installation Tool - 1 pc
- Wheels - 4 pcs
- Gloves - 1 pair

# 5 Tier Corner Plant Stand for Indoor Outdoor



Image: Detailed diagram of all components and their quantities for the GEEBOBO plant stand.

## SETUP AND ASSEMBLY

Follow these steps carefully to assemble your plant stand. It is recommended to assemble the stand on a soft surface or the packaging material to prevent scratches. Wear the provided gloves during assembly.

1. **Step 1:** Connect leg sections a1 and a2 using screws S1 and S2 as shown in the diagram.
2. **Step 2:** Secure the connected a1 and a2 sections by fixing screws S into each designated hole.
3. **Step 3:** Attach the assembled a1/a2 structure to the center hole of the large Disc A (base) using screw S.
4. **Step 4:** Fix the remaining legs (b, c, d, e) to the base, ensuring their holes align by height as depicted in the assembly diagram.
5. **Step 5:** Attach the five Disc B (small shelves) to the vertical legs. Ensure they are securely fastened but do not fully tighten screws until all parts are aligned.
6. **Step 6:** Insert the four wheels into the designated holes on Disc A. Apply firm pressure to ensure they are fully seated and prevent them from falling out.

### Important Assembly Tips:

- Do not fully tighten screws until all components are aligned and in place. This prevents wood cracking and ensures stability.
- Assemble on packaging to avoid damage to the floor or the product.
- If a part seems misaligned, re-check the instructions and ensure you are using the correct screws and orientation.

## Installation Guide

# GEEBOBO Plant Stand

PINE WOOD/ORIGINAL LIFE/SMALL FURNITURE

### Product Composition

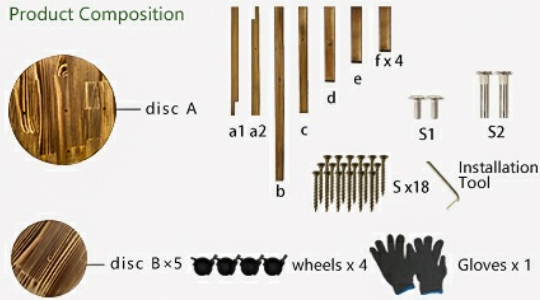

### Installation Tips

- 1 Please read the instruction carefully to understand the attentions in the process of installation and maintenance of the plant stand
- 2 Please Do not 100% tighten the screws until all the screws are aligned
- 3 Please Do not over tighten the screws to avoid wood cracking
- 4 Assemble on packaging boxes to avoid damage to flower rack and room floors
- 5 Use only a rag or slightly damp cloth to clean the surface of the flower stand, do not use strong detergents
- 6 Use of mismatched accessories may cause damage to the product, please confirm various parts types before assembling
- 7 When the installation is completed, if there are any remaining screws and nuts. Take it easy, in case of need, they are spare against unexpected needs

If there are any quality or installation problems, please contact us on Amazon, we will reply to solve it within 24 hours

### Start Assembling

⚠ Wear gloves when installing flower racks

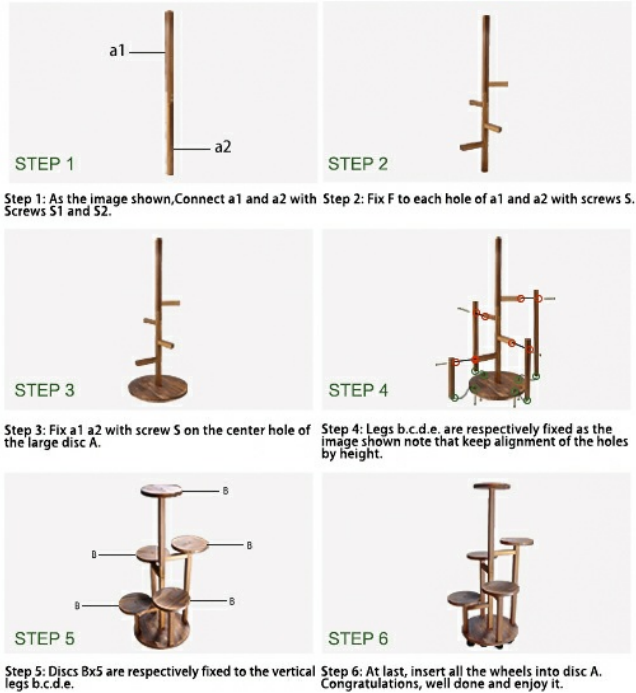

Image: Visual guide for the step-by-step assembly process of the plant stand.

## OPERATION

Your GEEBOBO plant stand is designed for versatile plant display and easy mobility.

### Placing Plants

Each of the five round trays has a diameter of 7.1 inches, suitable for small to medium-sized flower pots. Arrange your plants to ensure balanced weight distribution across the stand for optimal stability. The tiered design allows each plant to receive adequate sunlight and air circulation.

### Using Movable Wheels

The plant stand comes with four detachable wheels, allowing for easy relocation. To move the stand, ensure the wheel locks (if present) are disengaged. To secure the stand in place, engage the wheel locks. The wheels provide 360-degree rotation for smooth movement.



Image: Detail of the movable wheel feature, highlighting its locking mechanism for stability.

## MAINTENANCE

To ensure the longevity and appearance of your GEEBOBO plant stand, follow these maintenance guidelines:

- **Cleaning:** Wipe the surface with a soft, slightly damp cloth. Avoid using strong detergents, abrasive cleaners, or harsh chemicals, as these can damage the wood finish.
- **Water Protection:** Although the pine wood undergoes a 300°C carbonization process for durability, it is recommended to use drip trays under plant pots to prevent water from accumulating on the wood surfaces. Excessive moisture can still affect the wood over time.
- **Inspection:** Periodically check all screws and connections to ensure they remain tight. Re-tighten if necessary to maintain stability.
- **Environmental Care:** While suitable for outdoor use, prolonged exposure to extreme weather conditions (heavy rain, direct scorching sun) may accelerate wear. Consider moving the stand indoors during harsh weather.



Image: Visual representation of the pine wood material and carbonization process, highlighting product durability.

## TROUBLESHOOTING

If you encounter any issues with your plant stand, refer to the following common problems and solutions:

- **Stand is Unstable/Wobbly:**

- Ensure all screws are fully tightened after assembly.
- Check for even weight distribution of plants. Rearrange pots to balance the load.
- Verify that the stand is placed on a flat, level surface.

- **Difficulty Inserting Wheels:**

- The wheel holes are intentionally snug to prevent wheels from falling out. Apply firm, steady pressure to insert them completely.

- **Wood Splitting During Assembly:**

- This can occur if screws are overtightened or forced. Always align parts correctly before tightening screws. If a minor split occurs, ensure the screw still holds securely. For significant damage, contact support.

- **Missing or Damaged Parts:**

- Refer to the "Package Contents" section. If any parts are missing or damaged upon arrival, do not proceed with assembly. Contact GEEBOBO customer support immediately.

## SPECIFICATIONS

<b>Model Number</b>	ge-5tier-round-plant-stand-003
<b>Brand</b>	GEEBOBO
<b>Material</b>	Pine Wood
<b>Color</b>	Walnut
<b>Product Dimensions (L x W x H)</b>	13 x 13 x 34 inches
<b>Item Weight</b>	4.4 pounds (2 Kilograms)
<b>Number of Tiers</b>	5
<b>Tray Diameter</b>	7.1 inches
<b>Special Feature</b>	Movable Wheels
<b>Assembly Required</b>	Yes



Image: Dimensional drawing of the plant stand, indicating height, width, and shelf diameter.

## WARRANTY AND SUPPORT

GEEBOBO is committed to providing quality products and customer satisfaction. If you encounter any quality issues, installation problems, or have questions regarding your plant stand, please do not hesitate to contact us.

**Customer Support:** For assistance, please contact us through the Amazon platform where you purchased the product. We aim to respond and resolve any issues within 24 hours.

**Warranty Information:** Specific warranty details may vary. Please refer to your purchase documentation or contact customer support for information regarding product warranty and return policies.