

GTMEDIA GTMEDIA GT COMBO

# GT MEDIA GT Combo 4K Satellite TV Receiver User Manual

Model: GTMEDIA GT COMBO | Brand: GTMEDIA

[Introduction](#)   [Safety Information](#)   [Package Contents](#)   [Product Overview](#)   [Setup](#)   [Operating Instructions](#)   [Maintenance](#)   [Troubleshooting](#)   [Specifications](#)   [Warranty & Support](#)

## 1. INTRODUCTION

This user manual provides comprehensive instructions for the GT MEDIA GT Combo 4K Satellite TV Receiver. It covers everything from initial setup and connection to advanced operating features, maintenance, and troubleshooting. Please read this manual carefully before using the device to ensure proper operation and to maximize your viewing experience.



Figure 1: Front view of the GT MEDIA GT Combo 4K Satellite TV Receiver.

## 2. SAFETY INFORMATION

To ensure safe operation and prevent damage to the device or injury to yourself, please observe the following safety precautions:

- **Power Supply:** Use only the power adapter provided with the device. Ensure the power outlet matches the voltage requirements.

- **Ventilation:** Do not block any ventilation openings. Place the device in a well-ventilated area to prevent overheating.
- **Water and Moisture:** Do not expose the device to rain, moisture, or excessive humidity. Keep it away from liquids.
- **Cleaning:** Disconnect the power before cleaning. Use a soft, dry cloth. Do not use liquid or aerosol cleaners.
- **Servicing:** Do not attempt to service this product yourself. Refer all servicing to qualified service personnel. Opening the casing may expose you to dangerous voltages or other hazards.
- **Placement:** Place the device on a stable, flat surface. Avoid placing it near heat sources or in direct sunlight.
- **Lightning:** During a lightning storm or when unused for long periods, unplug the device from the power outlet and disconnect antenna/cable systems.

Carefully unpack your GT MEDIA GT Combo receiver and check that all the following items are included:

Figure 2: Included items in the GT MEDIA GT Combo package.

- IR Remote Control
- Power Adapter
- HDMI Cable
- User Manual
- Product Warranty Card

## 4. PRODUCT OVERVIEW

---

The GT MEDIA GT Combo is a versatile 4K satellite and terrestrial/cable TV receiver. Familiarize yourself with its various ports and indicators.

### 4.1 Front Panel

The front panel features a digital display for time and channel information, along with indicators for USB and network status. It also includes a CA Card slot for conditional access modules.



Figure 3: Front panel with display and CA Card slot.

### 4.2 Rear and Side Panels

The rear and side panels house all the necessary connection ports for your TV, satellite dish, and terrestrial antenna.

# Interfaces display



Figure 4: Rear and side panel interfaces.

- **LNB IN:** Connects to your satellite dish.
- **ANT IN:** Connects to your terrestrial antenna (DVB-T/T2) or cable (DVB-C) input.
- **HD OUT (HDMI 2.0):** Connects to your TV or display for high-definition video and audio output.
- **USB 3.0 + USB 2.0 Ports:** For connecting external storage devices (e.g., USB drives for PVR, media playback) or other USB peripherals.
- **S/PDIF:** Digital audio output for connecting to an audio receiver or soundbar.
- **DC 12V:** Power input for the included power adapter.
- **Ethernet:** For wired network connection to access online features and updates.
- **CA Card Slot:** For inserting a Conditional Access Module card (located on the side).

## 5. SETUP GUIDE

Follow these steps to set up your GT MEDIA GT Combo receiver:

1. **Connect to TV:** Connect one end of the HDMI cable to the **HD OUT** port on the receiver and the other end to an available HDMI input on your TV.

2. **Connect Satellite Dish:** Connect your satellite dish cable to the **LNB IN** port on the receiver.
3. **Connect Terrestrial Antenna/Cable:** Connect your terrestrial antenna or cable TV input to the **ANT IN** port.
4. **Network Connection (Optional):** For internet features, connect an Ethernet cable from your router to the **Ethernet** port on the receiver, or configure Wi-Fi later in the settings.
5. **Insert CA Card (Optional):** If you have a CA card, gently insert it into the **CA Card Slot** on the side of the receiver, ensuring correct orientation.
6. **Connect Power:** Connect the power adapter to the **DC 12V** port on the receiver, then plug the adapter into a power outlet.
7. **Power On:** Turn on your TV and select the correct HDMI input. The receiver should power on automatically or can be turned on using the remote control.
8. **Initial Setup Wizard:** Follow the on-screen instructions for the initial setup, which typically includes language selection, network configuration, and channel scanning.

## 6. OPERATING INSTRUCTIONS

---

This section details the main functions and features of your GT MEDIA GT Combo receiver.

### 6.1 Channel Scanning and Management

After initial setup, you will need to scan for channels. Navigate to the "Installation" or "Channel Search" menu. The receiver supports DVB-S/S2/S2X for satellite, and DVB-T/T2/Cable for terrestrial and cable channels. Select your preferred scanning method (e.g., Automatic Scan, Manual Scan) and parameters (e.g., satellite, transponder, terrestrial region).

### 6.2 CA Card Decoding

The integrated CA card slot supports decoding of encrypted channels. Ensure your CA card is correctly inserted and activated by your service provider. The receiver supports CA card decoding for various services.

### 6.3 Voice Remote Control

The GT Combo features a Bluetooth voice remote control, simplifying channel search and content navigation. To use, press the dedicated voice button on the remote and speak your command clearly.



# Powerful Voice Search Assistant

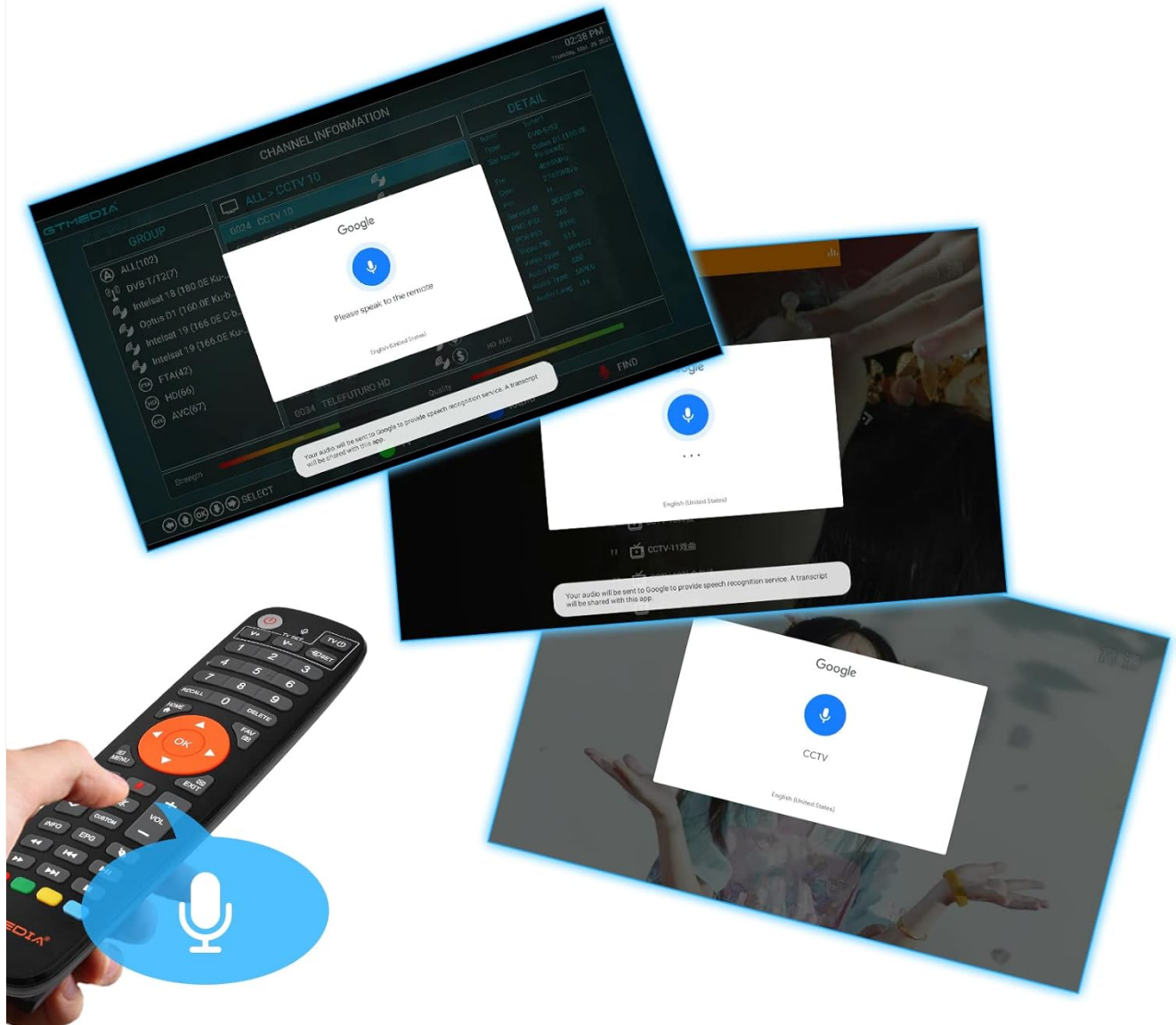

Figure 5: Using the voice search assistant with the remote control.



Figure 6: Location of the voice button on the remote.

## 6.4 Customization Options

Personalize your receiver's interface and behavior through various customization settings:

- **Custom Wallpaper:** Set your preferred background image for the main menu.
- **APP Entry Background:** Customize the background for application tabs.
- **DVB Preview Window:** Configure the preview window for DVB channels.
- **Auto-start APP:** Set applications to launch automatically upon startup.

- **Custom Shortcut Key:** Assign functions to custom buttons on the remote.
- **Auto Play for Media:** Configure automatic playback for media files.

## Custom Wallpaper Setting



Figure 7: Custom wallpaper setting interface.



Figure 8: Location of the custom button on the remote.

### 6.5 PVR and Media Playback

Connect a USB storage device to record live TV programs (PVR) or play back various media files. The receiver supports HEVC 10-bit and YUV422 for enhanced visual quality. Access these features through the "Media" or "PVR" menu.

## 6.6 Online Applications

The GT Combo comes with pre-installed applications, allowing you to access online content such as YouTube and other streaming services. Ensure your device is connected to the internet via Ethernet or Wi-Fi.

## 7. MAINTENANCE

Proper maintenance ensures the longevity and optimal performance of your GT MEDIA GT Combo receiver.

- **Cleaning:** Regularly wipe the exterior of the receiver with a soft, dry, lint-free cloth. Do not use abrasive cleaners, waxes, or solvents.
- **Ventilation:** Ensure that the ventilation slots on the device are not obstructed by dust or other objects. Periodically clean dust from the vents using a soft brush or compressed air.
- **Firmware Updates:** Check the manufacturer's website periodically for firmware updates. Keeping your device's firmware up-to-date can improve performance, add new features, and fix bugs.
- **Storage:** If storing the device for an extended period, disconnect it from power, pack it in its original packaging or a protective box, and store it in a cool, dry place.

## 8. TROUBLESHOOTING

If you encounter issues with your GT MEDIA GT Combo receiver, refer to the table below for common problems and their solutions.

Problem	Possible Cause	Solution
No picture/sound on TV.	Incorrect HDMI input selected on TV. Loose HDMI cable. Receiver not powered on.	Ensure TV is on the correct HDMI input. Check HDMI cable connections. Verify receiver is powered on.
No channels found after scanning.	Antenna/dish not connected or misaligned. Incorrect scan settings.	Check antenna/dish connections. Ensure dish is properly aligned. Verify scan settings (e.g., satellite, transponder, terrestrial region).
Remote control not responding.	Batteries are dead or inserted incorrectly. Obstruction between remote and receiver. Remote not paired (for Bluetooth).	Replace batteries. Ensure line of sight. Re-pair Bluetooth remote if necessary (refer to remote pairing instructions in the full manual).
Cannot access online apps.	No internet connection. Incorrect network settings.	Check Ethernet cable or Wi-Fi connection. Verify network settings (IP address, DNS). Restart router and receiver.
CA card not recognized.	Card inserted incorrectly. Card not activated or expired.	Re-insert CA card, ensuring correct orientation. Contact your service provider to verify card status.

## 9. SPECIFICATIONS

Below are the technical specifications for the GT MEDIA GT Combo receiver:



# Product Dimension



Figure 9: Product dimensions.

Feature	Detail
Brand	GTMEDIA
Model Number	GTMEDIA GT COMBO
Color	Orange
Connectivity Technology	Bluetooth, Ethernet, Wi-Fi (implied by online apps)
Tuner Types	DVB-S/S2/S2X, DVB-T/T2, DVB-C
Video Decoding	4K Ultra HD, H.265 HEVC 10-bit, YUV422
Processor	Dual-core MIPS75Kf
RAM	2GB
ROM (Storage)	16GB
HDMI Ports	1 (HDMI 2.0)
USB Ports	1 x USB 3.0, 1 x USB 2.0
Audio Output Mode	Stereo, S/PDIF

Feature	Detail
Supported Audio Formats	Dolby Digital, DTS, AAC, MP3, PCM
Special Features	CA Card Slot, PVR, Bluetooth Voice Remote, Custom Wallpaper, Online Apps (YouTube)
Dimensions (Approx.)	124mm x 124mm x 36mm (4.88in x 4.69in x 1.42in)

## 10. WARRANTY AND SUPPORT



Your GT MEDIA GT Combo receiver comes with a product warranty. Please refer to the included warranty card for specific terms and conditions, including warranty period and coverage details.

For technical support, troubleshooting assistance beyond this manual, or warranty claims, please contact GT MEDIA customer service through their official website or the contact information provided on your warranty card. Ensure you have your product model number and purchase details ready when contacting support.

*Note: Software updates may be released periodically. Check the official GT MEDIA website for the latest firmware and support resources.*

© 2023 GTMEDIA. All rights reserved.

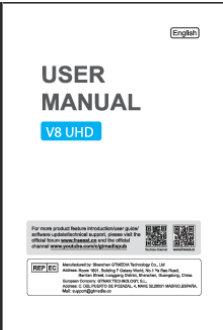
### Related Documents

	<p><a href="#">GTMEDIA V8 UHD Satellite Receiver User Manual</a></p> <p>Comprehensive user manual for the GTMEDIA V8 UHD satellite receiver, covering safety instructions, features, front panel and connection details, remote control functions, USB upgrade procedures, and troubleshooting tips.</p>
	<p><a href="#">GTMEDIA V8 X Satellite Receiver User Manual</a></p> <p>Comprehensive user manual for the GTMEDIA V8 X satellite receiver, covering safety instructions, features, front panel, remote control, startup, factory settings, and troubleshooting.</p>
	<p><a href="#">GTMEDIA V8X Satellite Receiver User Manual</a></p> <p>Comprehensive user manual for the GTMEDIA V8X satellite receiver, covering setup, features, remote control operation, safety guidelines, and troubleshooting.</p>

