

## Riloer H846251MG

# Riloer 12/24V Car Air Diesel Heater LCD Switch and Remote Control User Manual

Model: H846251MG

## 1. INTRODUCTION

Thank you for choosing the Riloer 12/24V Car Air Diesel Heater LCD Switch and Remote Control. This product is designed to provide convenient and efficient control over your diesel air parking heater. It is compatible with most 12V/24V diesel heaters used in cars, trucks, RVs, and other engineering vehicles. This manual provides essential information for proper installation, operation, and maintenance to ensure safe and effective use.

## 2. PRODUCT OVERVIEW AND FEATURES

The Riloer LCD Switch and Remote Control system offers advanced functionality for managing your diesel heater. Key features include:

- **Timing Function:** Schedule heater operation for convenience.
- **Oil Quantity Display:** Monitor fuel levels directly on the LCD screen.
- **Plateau Adaptive Function:** Ensures optimal performance in high-altitude environments.
- **Remote Fuel Control:** Manual fuel filling mode to prevent unexpected shutdowns due to low fuel.
- **Remote Control:** Operate the heater from a distance of up to 15 meters.
- **Durable Construction:** Made from environmentally friendly materials for long-lasting use.



*Image 1: Riloeer 12/24V Car Air Diesel Heater LCD Switch and Remote Control. This image shows the blue LCD monitor switch and the red remote control, with a vehicle in the background, illustrating its application.*

### **3. PACKAGE CONTENTS**

The package includes the following components:

- 1 x LCD Monitor Switch
- 1 x LCD Remote Control



- ◆ 1 x LCD Monitor Switch
- ◆ 1 x LCD Remote Control

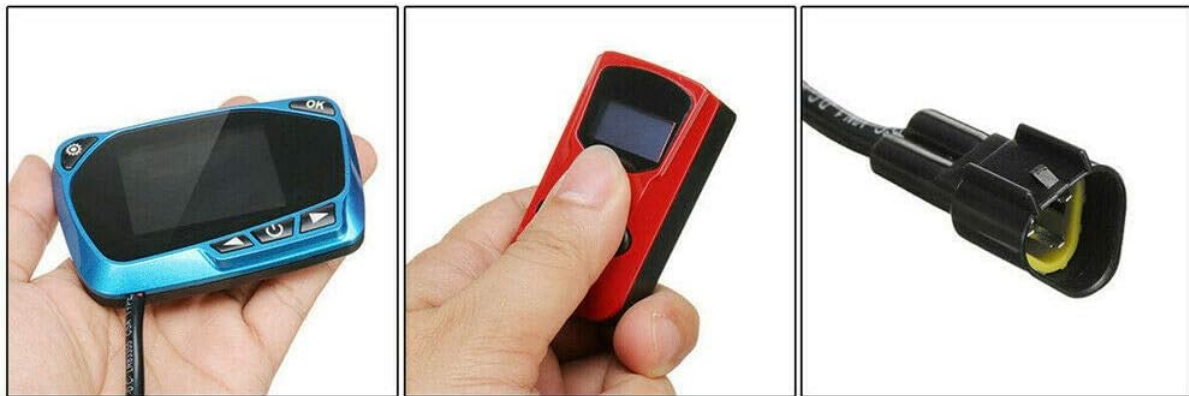

Image 2: Package contents showing one LCD Monitor Switch and one LCD Remote Control.

#### 4. SPECIFICATIONS

|                                    |   |
|------------------------------------|---|
| <b>Condition</b>                   | New   |
| <b>Color</b>                       | Red + Blue (for remote and switch respectively) |
| <b>Voltage</b>                     | 12V/24V   |
| <b>Remote Control Power Supply</b> | 2 x AAA Battery (Not Included)                  |
| <b>Remote Control Size (L*W*H)</b> | 60 x 36 x 20 mm                                 |
| <b>Monitor Switch Size (L*W*H)</b> | 95 x 63 x 15 mm                                 |
| <b>Item Weight</b>                 | 118 g   |
| <b>Manufacturer Part Number</b>    | H846251MG                                       |



Image 3: Detailed dimensions of the LCD monitor switch and the remote control.

## 5. SETUP AND INSTALLATION

Follow these steps to set up your Riloeer LCD Switch and Remote Control:

1. **Power Supply:** Ensure your diesel heater system operates on either 12V or 24V, as this unit is compatible with both.
2. **Remote Control Batteries:** Open the battery compartment of the remote control and insert 2 x AAA batteries (not included), observing correct polarity.
3. **Connect the LCD Monitor Switch:** Simply plug the LCD monitor switch's connector into the corresponding port on your diesel air parking heater. Ensure a secure connection.
4. **Remote Control Matching:** To pair the remote control with the LCD monitor switch, follow these steps:

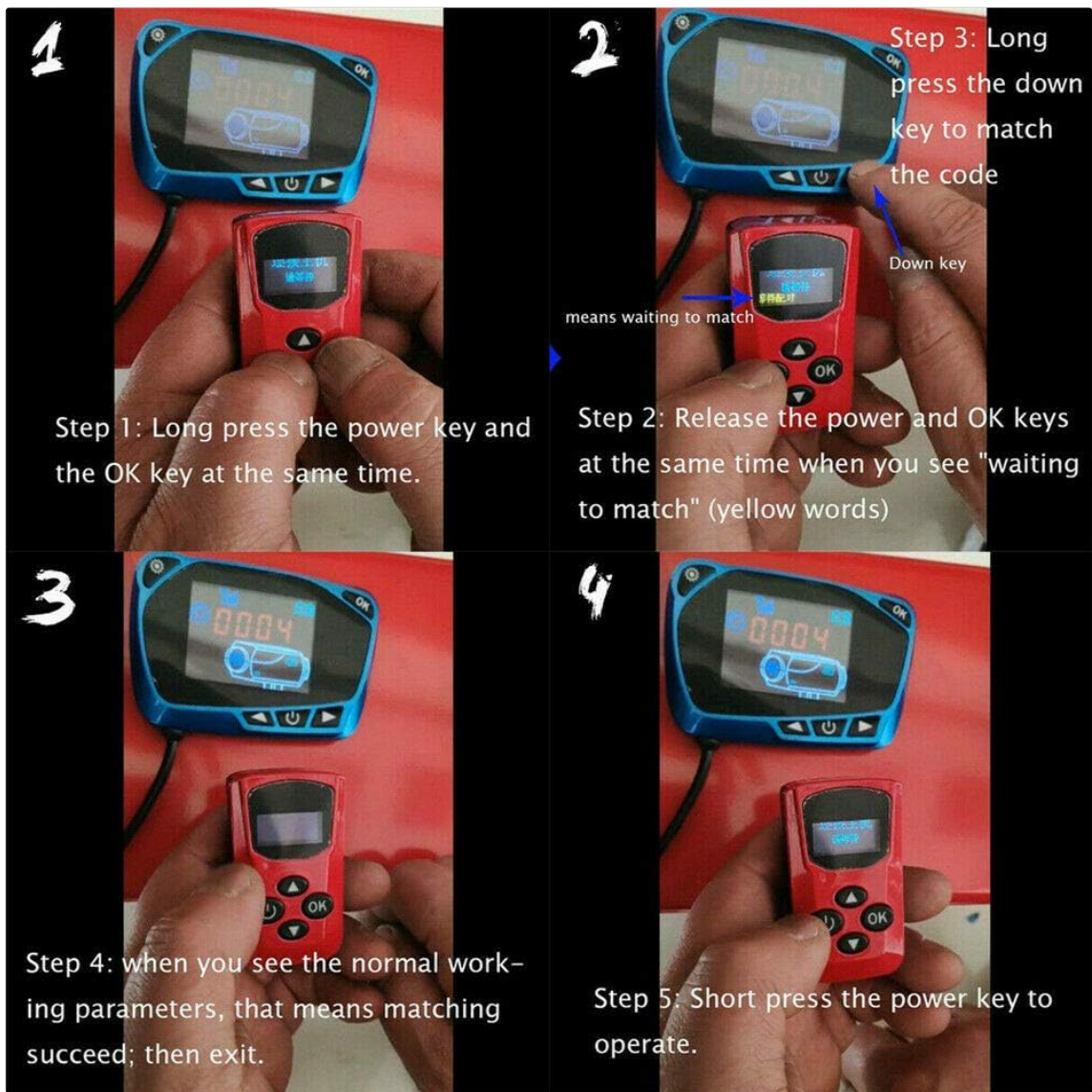

Image 4: Step-by-step guide for pairing the remote control with the LCD monitor switch.

- **Step 1:** Long press the power key and the OK key on the remote control simultaneously.
- **Step 2:** Release the power and OK keys when you see "waiting to match" (yellow words) on the remote's screen.
- **Step 3:** Long press the down key on the remote to match the code.
- **Step 4:** When you see the normal working parameters displayed, the matching is successful.
- **Step 5:** Short press the power key to operate.



*Image 5: Close-up view of the connector for the Rilber LCD Monitor Switch.*

## 6. OPERATING INSTRUCTIONS

Once installed and paired, operate your diesel heater using the LCD monitor switch or the remote control:

- **Power On/Off:** Use the designated power button on the LCD switch or remote control to turn the heater on or off.
- **Setting Temperature:** Use the up/down arrow buttons on the LCD switch or remote to adjust the desired temperature.
- **Setting Timer:** Access the timing function through the menu on the LCD switch to set specific operating durations.
- **Oil Quantity Display:** The LCD screen will show the current oil quantity, allowing you to monitor fuel levels.
- **Remote Fuel Control:** If your heater supports it, activate the remote fuel filling manual mode via the

remote control to manually manage fuel supply.



Image 6: Close-up view of the buttons and display on the Riloer LCD Monitor Switch.

Your browser does not support the video tag.

Video 1: This video demonstrates the features and operation of a universal diesel air heater controller, similar to the Riloer LCD Switch and Remote Control, highlighting its compatibility and ease of use.

## 7. MAINTENANCE

To ensure the longevity and optimal performance of your Riloer LCD Switch and Remote Control, consider the following maintenance tips:

- **Cleaning:** Regularly wipe the LCD screen and buttons with a soft, dry cloth. Avoid using abrasive cleaners or solvents.
- **Battery Replacement:** Replace the AAA batteries in the remote control when the display becomes dim or the remote's range decreases.
- **Connection Check:** Periodically inspect the cable and connector for any signs of wear or damage. Ensure the connection remains secure.
- **Storage:** When not in use for extended periods, store the unit in a dry, cool place away from direct sunlight and extreme temperatures.

## 8. TROUBLESHOOTING

If you encounter issues with your Riloer LCD Switch and Remote Control, try the following troubleshooting steps:

- **No Power/Display:**
  - Check the main power supply to your diesel heater.
  - Ensure the LCD monitor switch is securely plugged into the heater.
  - For the remote control, replace the AAA batteries.
- **Remote Not Responding:**
  - Ensure the remote control batteries are fresh and correctly inserted.
  - Re-attempt the remote control matching process as described in Section 5.
  - Ensure there are no obstructions between the remote and the LCD switch.
- **Incorrect Readings (e.g., Oil Quantity):**
  - Verify that the diesel heater itself is functioning correctly and its sensors are clean.
  - Ensure all connections are firm.

If problems persist after attempting these steps, please contact customer support.

## 9. WARRANTY INFORMATION

Specific warranty details for the Riloer 12/24V Car Air Diesel Heater LCD Switch and Remote Control are typically provided at the point of purchase or within separate documentation. Please refer to your purchase receipt or contact the seller for information regarding warranty coverage, duration, and terms. Keep your proof of purchase for any warranty claims.

## 10. SUPPORT

For further assistance, technical support, or inquiries not covered in this manual, please contact the retailer or manufacturer directly. Have your product model number (H846251MG) and purchase information ready when contacting support.