

## Ballu Apollo

# BALLU Apollo Portable Convection Panel Space Heater Instruction Manual

Model: Apollo

## INTRODUCTION

---

This manual provides essential information for the safe and efficient operation of your BALLU Apollo Portable Convection Panel Space Heater. Please read all instructions carefully before use and retain this manual for future reference.



*Image: The BALLU Apollo Portable Convection Panel Space Heater, showcasing its sleek white design and freestanding feet.*

## SETUP AND INSTALLATION

---

The BALLU Apollo heater offers versatile installation options: freestanding or wall-mounted. No additional tools are required for assembly.

### Freestanding Setup

1. Carefully remove the heater from its packaging.
2. Attach the provided caster wheels to the base of the heater. Ensure they are securely fastened.
3. Place the heater on a stable, level surface, ensuring adequate clearance from walls and flammable materials.

## Wall Mount Installation

1. Remove the caster wheels if they are already attached.
2. Identify a suitable wall location. The wall must be heat-resistant and capable of supporting the heater's weight.
3. Use the provided wall-mounting brackets and hardware to secure the heater to the wall. Follow the detailed instructions in the included wall-mount guide for proper installation.

*Video: Demonstrates the assembly of the freestanding feet and highlights the wall-mounting bracket on the rear of the heater.*

## OPERATING INSTRUCTIONS

---

The BALLU Apollo heater features a TFT Digital Display control panel for easy operation.

# Advanced digital control system



TFT color screen



Touch control



7d\*24h  
Customized program



Open window detection



Precision thermostat



3 modes



**\*Turn on the screen:  
Please press and hold the power icon  
for 2 seconds**

Image: Close-up of the heater's TFT Digital Display control panel, showing temperature, mode, and power buttons.

## Control Panel Overview

- **Power Button:** Press and hold for 2 seconds to turn the unit on or off.
- **Temperature Adjustment:** Use the arrow buttons to set the desired temperature between 41°F and 95°F.
- **Mode Selection:** Cycle through available modes: Comfort, Eco, and Anti-frost.
- **Timer Function:** Program the heater to operate for specific durations or at scheduled times (7 days, 24 hours).
- **Child Lock:** Activate to prevent accidental changes to settings.
- **Open Window Detection:** The heater automatically adjusts temperature if a sudden drop is detected, optimizing energy use.

## Heating Efficiency and Comfort

The Apollo heater utilizes a patented hedgehog heating element for 100% conversion of electrical energy to thermal energy, resulting in rapid heating (within 30 seconds) and even room temperature distribution. It operates silently, without consuming oxygen or moisture, which helps maintain comfortable air quality.

# Higher Heating Efficiency

36% larger than traditional heating fins, our Patented hedgehog fins are extended to heat the whole room faster.

**30s**

Fast and gentle heating

**15%**

Energy Saving

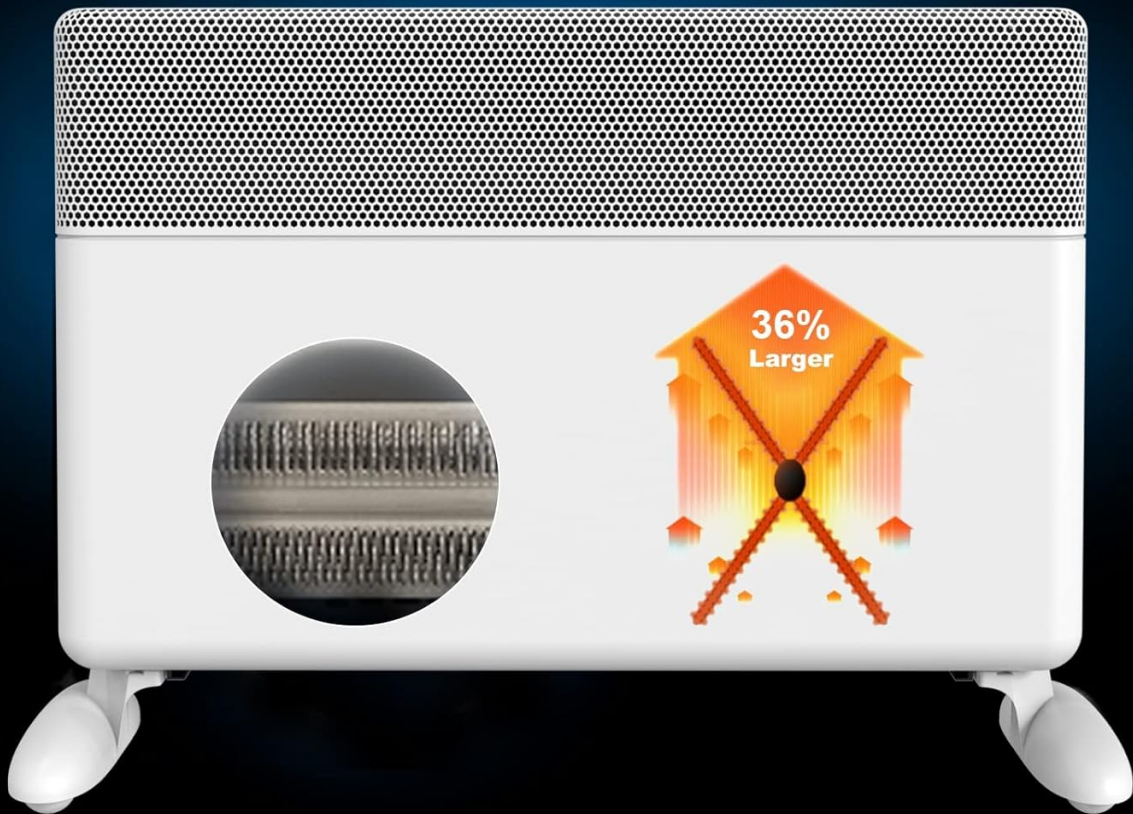

*Image: Diagram illustrating the heater's high heating efficiency and rapid warm-up time.*



# Full room heats up quickly

Aerodynamic design enhances natural convection



\*The first use is recommended to set the maximum temperature (96°F) and power (1500W) working for at least 1 hour.(150 sq ft heating time)



Larger Heating Area  
 $\leq 300\text{sq ft}$

*Image: Illustration showing how the BALLU Apollo heater effectively warms a room up to 300 sq ft through natural convection.*

# Silent and Comfortable



**Doesn't dry the skin**



**No fan, No wind**



**Super Quiet,  $\leq 25\text{db}$**



**No Dazzling Light**



*Image: Depiction of the heater's silent operation, emphasizing no fan, no dry air, and no dazzling light for a comfortable environment.*

## SAFETY FEATURES

Your BALLU Apollo heater is equipped with multiple safety mechanisms to ensure secure operation:

- **Tip-Over Protection:** Automatically shuts off the unit if it is accidentally knocked over.
- **Overheat Protection:** The heater will power down if internal components reach an unsafe temperature.
- **Child Lock:** Prevents unauthorized access to the control panel settings.
- **V0 Flame-Retardant Materials:** Constructed with high-quality, flame-retardant power cord and plug.

# Multiple Safety Protection

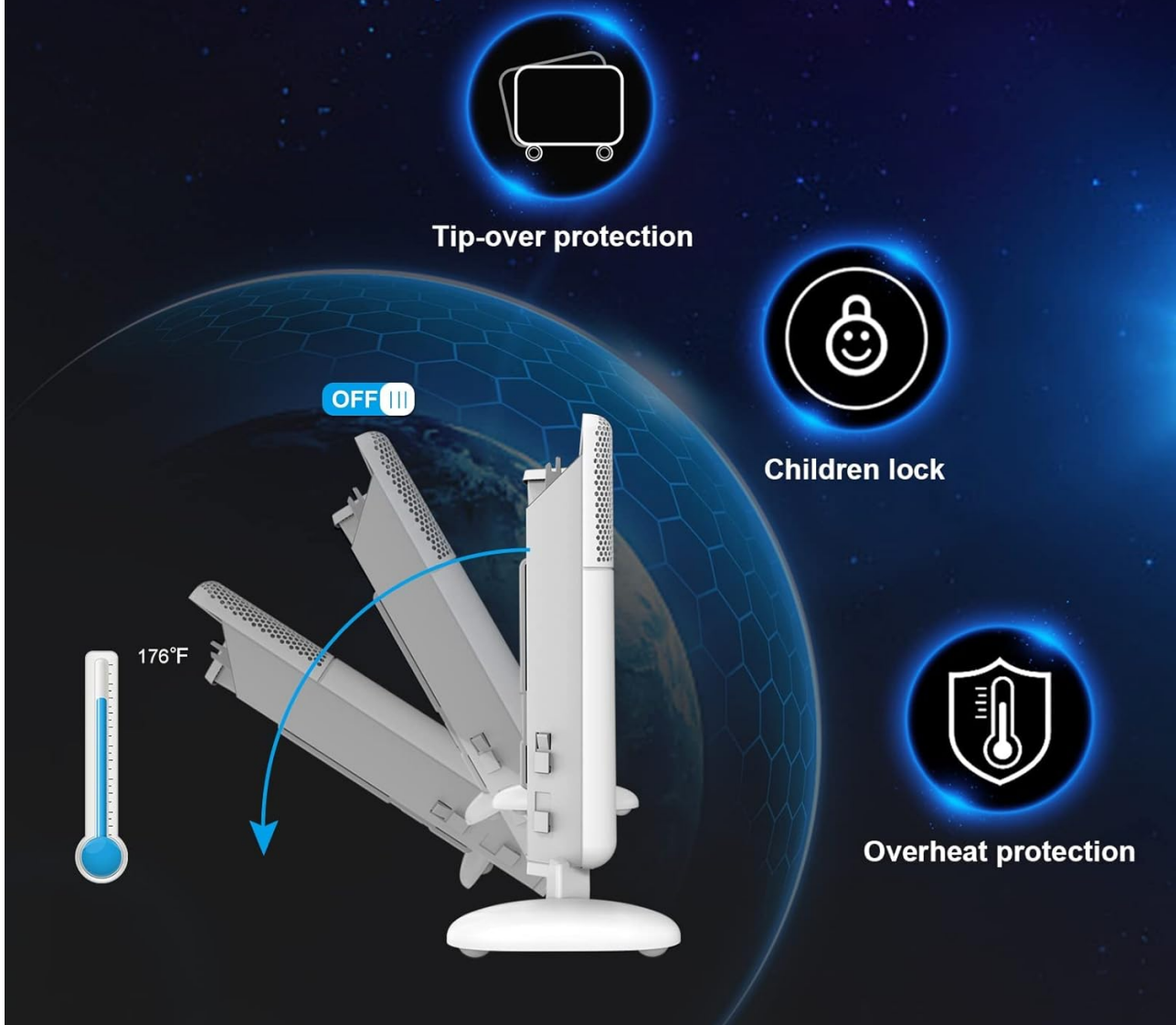

Image: Icons representing the heater's safety features: Tip-over protection, Child lock, and Overheat protection.

## MAINTENANCE

To ensure optimal performance and longevity of your heater, follow these maintenance guidelines:

- Always unplug the heater and allow it to cool completely before cleaning.
- Wipe the exterior surfaces with a soft, damp cloth. Do not use abrasive cleaners or solvents.
- Ensure the air intake and exhaust grilles are free from dust and debris. Use a vacuum cleaner with a brush attachment to gently clean these areas.
- Do not immerse the heater in water or any other liquid.
- Store the heater in a cool, dry place when not in use.

## TROUBLESHOOTING

If you encounter issues with your BALLU Apollo heater, please refer to the following common solutions:

- **Heater does not turn on:** Ensure the power cord is securely plugged into a functional outlet. Check if the



main power switch (if applicable) is in the 'ON' position. Verify that the child lock is not activated.

- **No heat output:** Confirm the desired temperature setting is higher than the current room temperature. Check the selected operating mode.
- **Heater shuts off unexpectedly:** This may indicate activation of the overheat or tip-over protection. Ensure the heater is on a stable surface and not obstructed. Allow the unit to cool down before restarting.
- **Display shows an error or locked symbol:** Consult the detailed troubleshooting section in the full user manual or contact customer support for assistance.

## SPECIFICATIONS

Feature	Detail
Brand	Ballu
Model	Apollo
Special Feature	Energy Efficient, Noiseless, Portable
Color	White
Form Factor	Pedestal
Indoor/Outdoor Usage	Indoor
Mounting Type	Wall Mount
Room Type	Bedroom, Home Office, Study Room
Heating Coverage	300 square feet
Burner Type	Radiant
Heat Output	1500 Watts
Product Dimensions	25.2 x 4 x 15.9 inches
Item Weight	17.56 pounds
Date First Available	September 17, 2021

## WARRANTY AND SUPPORT

For warranty information, technical support, or service inquiries, please refer to the contact details provided with your product packaging or visit the official Ballu website. Keep your purchase receipt as proof of purchase.