

Manuals+

[Q & A](#) | [Deep Search](#) | [Upload](#)

[manuals.plus](#) /

› [Waytronic](#) /

› [Waytronic Wireless WiFi Smart Door and Window Sensor Alarm User Manual](#)

Waytronic WIFI Alarm

Waytronic Wireless WiFi Smart Door and Window Sensor Alarm User Manual

Model: WIFI Alarm

1. INTRODUCTION

The Waytronic Wireless WiFi Smart Door and Window Sensor Alarm is designed to enhance your home security by providing real-time monitoring of your doors and windows. This smart sensor integrates with the Tuya APP and is compatible with Alexa and Google Assistant, offering instant notifications to your smartphone when a door or window is opened or closed. It helps you stay informed about activity in your home, shop, or office, ensuring peace of mind whether you are present or away.

2. PRODUCT OVERVIEW

The Waytronic Smart Door and Window Sensor consists of two main components: the main sensor unit and a magnetic strip. These components work together to detect the open/close status of doors and windows. The device features an LED indicator and a network key for setup.



Image: The Waytronic Smart Door and Window Sensor, highlighting its compatibility with Amazon Alexa, Google Assistant, and Tuya Smart Life applications for smart home integration.



Image: A detailed diagram illustrating the dimensions (72mm x 30mm x 19mm for the main unit, 45.5mm x 14mm for the magnet) and key product information such as operating voltage, battery life, current, alarm output, and working environment.

3. SETUP

3.1 Battery Installation

The sensor requires two AAA batteries (not included). To install:

1. Gently open the back cover of the main sensor unit.
2. Insert two AAA batteries, ensuring correct polarity (+/-).
3. Close the back cover securely.

3.2 App Download

To control and monitor your sensor, download the 'Tuya Smart' or 'Smart Life' application on your smartphone.

- **Method 1:** Scan the QR code provided in the product packaging or the setup video to download the 'Tuya Smart' or 'Smart Life' app.
- **Method 2:** Search for 'Tuya Smart' or 'Smart Life' in your device's application store (Google Play for Android, App Store for iOS) and download.

3.3 Network Configuration

After installing the batteries and downloading the app, you need to connect the sensor to your Wi-Fi network. The device supports 2.4GHz Wi-Fi only (5GHz is not supported).

Video: This video demonstrates the appearance introduction, battery installation, app download via QR codes, and both Wi-Fi fast connection and hotspot distribution network setup methods for the Waytronic Smart Door and Window Sensor.

Method 1: Wi-Fi Quick Connect (EZ Mode)

1. Open the 'Tuya Smart' or 'Smart Life' app and tap 'Add Device'.
2. Select 'Sensor' from the categories, then choose 'Contact Sensor (Wi-Fi)'.
3. Enter your 2.4GHz Wi-Fi network name and password.
4. Use the provided SIM ejector tool or a similar thin object to short press the network key on the sensor. The LED light will flash once.
5. Long press the network key for 5 seconds until the LED light flashes quickly. If it is not flashing quickly, press and hold for another 5 seconds.
6. In the app, confirm that the indicator is blinking rapidly and proceed to add the device.

Method 2: Hotspot Distribution Network (AP Mode)

If Wi-Fi Quick Connect fails, use the Hotspot Distribution Network method.

1. In the app's 'Add Device' screen, select 'AP Mode' (usually found in the top right corner or by switching modes).
2. Long press the network key on the sensor for 5 seconds until the LED light flashes slowly. If it is not flashing slowly, press and hold for another 5 seconds.
3. In the app, confirm that the indicator is blinking slowly.
4. The app will instruct you to connect to the device's hotspot. Go to your phone's Wi-Fi settings and connect to a network starting with 'SmartLife-XXXX' or 'SL-XXXX'.
5. Return to the app to complete the device addition.

4. INSTALLATION

The sensor is designed for easy installation using 3M adhesive tape.

1. Clean the surface where you intend to install the sensor and magnet. Ensure it is dry and free of dust.
2. Peel off the protective film from the 3M adhesive tape on the back of both the main sensor unit and the magnetic strip.
3. Attach the main sensor unit to the door or window frame.
4. Attach the magnetic strip to the door or window itself, ensuring it is installed on the same horizontal plane as the main sensor unit.

- The alignment marks (arrows) on both components should be opposite each other. The distance between the two components should be as close as possible, ideally within 1-2 cm, and should not interfere with the opening or closing of the door or window.

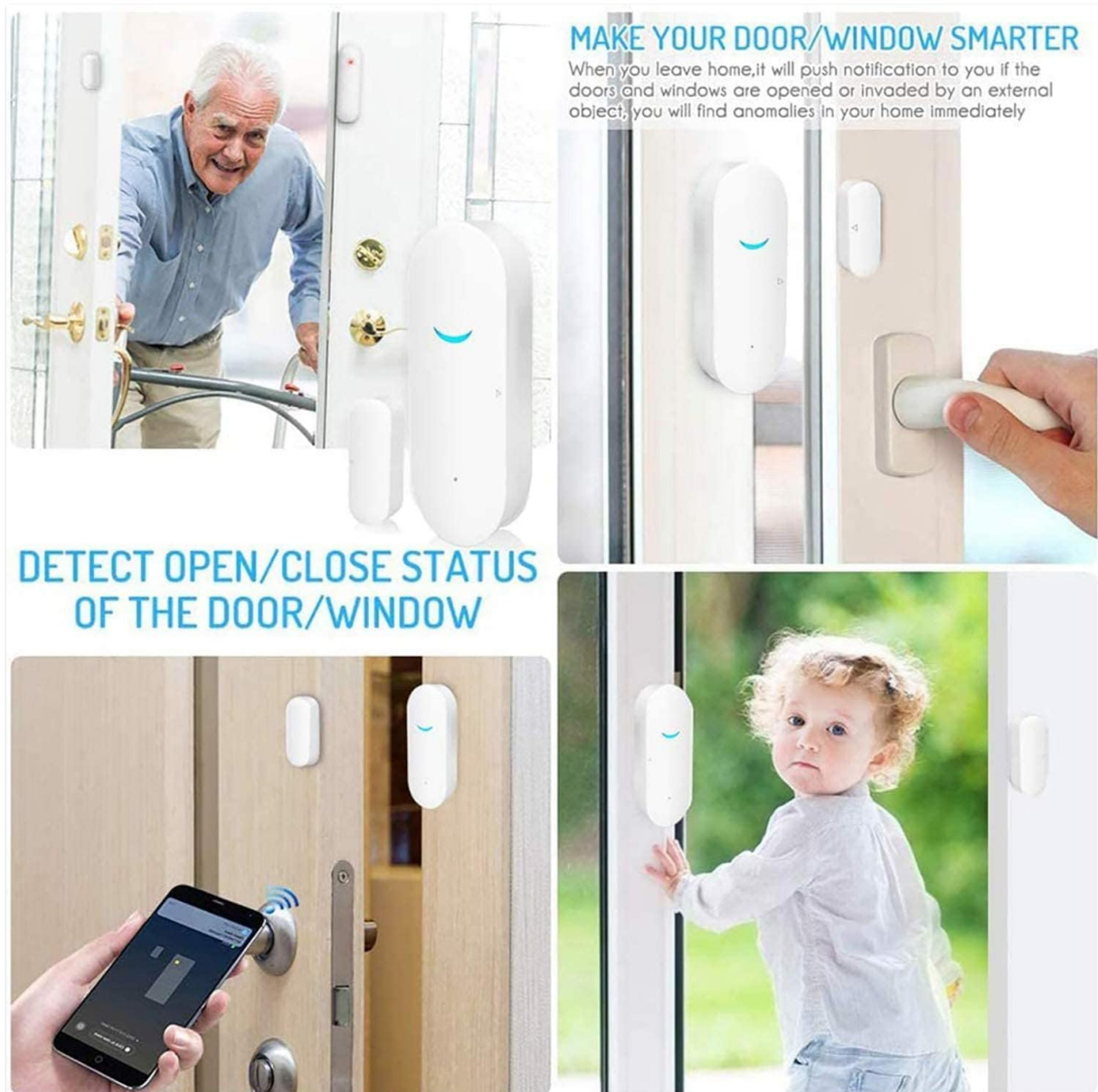

Image: Examples of the sensor installed on different types of doors and windows, demonstrating its versatility in monitoring entry points and child safety.

5. OPERATION

5.1 Real-time Notifications

Once installed and connected, the sensor will send instant notifications to your smartphone whenever the monitored door or window is opened or closed. This feature provides immediate alerts for security breaches or to track activity within your home.

Receive Alarms Remotely

When the door/window is opened illegally, the sensor will send out a real-time alarm, and the user can remotely receive the alarm reminder in their mobile phone.



Image: The sensor detecting an open window, triggering an immediate alarm notification on a smartphone, illustrating its real-time security alert capability.

5.2 Smart Linkage (Group Control)

The sensor supports intelligent linkage with other smart home devices. For example, you can configure it so that when a door or window is opened, a connected smart light automatically turns on or off, enhancing convenience and security.



Image: An illustration of the sensor's 'Intelligent Linkage' feature, demonstrating how opening a door can automatically trigger a smart light to turn on or off through group control.

5.3 Low Power Warning

The sensor is designed to notify you when its battery level is low. You will receive automatic push messages through the app, reminding you to change the batteries to ensure continuous operation and security.



Image: The sensor's battery compartment, illustrating the use of two AAA batteries and highlighting an approximate 300-day standby time, ensuring long-lasting performance.

6. SPECIFICATIONS

Feature	Specification
Voltage	3 Volts
Control Method	App
Mounting Type	Adhesive Mount
Sensor Technology	Contact Sensor
Item Weight	3.52 ounces
Product Dimensions	2.83 x 0.75 x 1.18 inches
Batteries	2 AAA batteries required (not included)
Material	Plastic
Installation Method	Glue
Usage	Door Window Sensor, Home Security Alarm
Included Components	Detector
Power Source	Battery Powered
Compatible Devices	Home Security System, Smartphone

7. TROUBLESHOOTING

- **Q: Does the door sensor support Alexa/Google voice control?**

A: The sensor supports connection with Alexa and Google Assistant for push notifications when opening and closing, but it does not support voice control commands.

- **Q: Why can't the device connect to Wi-Fi?**

A: Check the following:

- Ensure your Wi-Fi network is 2.4GHz; 5G networks are not supported. Confirm your router settings.
- Make sure the door sensor is within good Wi-Fi signal range. A weak signal may prevent connection.
- During setup, use the SIM ejector tool to short press the network key, then continue to poke for 3-5 seconds until the green light flashes continuously for fast connect mode, or slowly for hotspot mode.
- The app requires your Wi-Fi account and password to be consistent with your phone's Wi-Fi connection.

- **Q: Why am I not receiving app notifications?**

A: Consider these points:

- Ensure the installation distance between the door sensor and the magnetic strip is within the recommended 1-2 cm.
- In the app, navigate to 'My Device' -> 'Settings' and ensure sound and light alarms, along with app notification permissions, are enabled.
- It is recommended to keep the app open or running in the background to receive alarm messages promptly.

8. MAINTENANCE

To ensure optimal performance and longevity of your Waytronic Smart Door and Window Sensor, follow these maintenance guidelines:

- **Battery Replacement:** Replace the two AAA batteries when you receive a low power warning notification from the app. Always use fresh, high-quality batteries.
- **Cleaning:** Periodically wipe the sensor and magnet with a soft, dry cloth to remove dust and debris. Avoid using harsh chemicals or abrasive cleaners.
- **Adhesive Check:** Regularly check the adhesive tape to ensure the sensor and magnet remain firmly attached to the surface. Reapply or replace the adhesive if it shows signs of weakening.
- **Connectivity:** Ensure your Wi-Fi router is functioning correctly and the sensor remains within its effective range for consistent connectivity.

9. WARRANTY AND SUPPORT

For warranty information, technical support, or any product-related inquiries, please refer to the contact details provided with your purchase or visit the official Waytronic website. Our customer service team is available to assist you with any questions or issues you may encounter.