

## NIDAGE 002

# NIDAGE 50FT Dual Lens Sewer Inspection Camera Borescope User Manual

Model: 002

## 1. INTRODUCTION AND OVERVIEW

This NIDAGE 50FT Dual Lens Sewer Inspection Camera Borescope is a professional tool designed for detailed visual inspection in hard-to-reach areas. Equipped with an upgraded 5-inch IPS screen and 1080P dual lenses, it provides clear, real-time images and videos, making inspection tasks easier and more efficient. Its robust design and versatile features make it ideal for various applications, including home drain pipe inspection, automotive maintenance, HVAC fixes, and general nondestructive testing.



Image 1.1: The NIDAGE 50FT Dual Lens Sewer Inspection Camera Borescope, showing the handheld monitor unit and the coiled semi-rigid cable with the camera head.

## 2. PRODUCT FEATURES

- **Upgraded 5-inch IPS HD Display:** Features a 5-inch IPS color screen that offers 7.5 times clearer images than standard screens, providing a wide 178° viewing angle with high-definition resolution for enhanced viewing details.
- **Dual Lens 3-in-1 Snake Camera:** Supports three observation modes: front view (1.18-5.9 inches focal length), side view (0.78-3.93 inches focal length), and a split-screen dual view, allowing simultaneous observation from both lenses.
- **1080P Dual Lens & Wide Application:** Captures crisp pictures and fluent videos with a high frame rate CMOS chip, minimizing image delay. Suitable for automotive, home, HVAC, and industrial inspections.
- **Easy to Use & Practical Design:** Instant power-on operation. Includes a one-key 180° image rotation for optimal viewing. The IP67 waterproof lens is equipped with 7 dimmable LED lights for clear visibility in dark or wet environments.
- **Helpful Accessories & High Quality:** Comes with hook and magnet accessories for retrieving small items. The 50-foot cable is made of semi-rigid material, ensuring durability and flexibility to reach various inspection points.
- **32GB TF Card Included:** A free 32GB TF card is provided, capable of storing over 10,000 pictures and videos for later review or sharing.

UPGRADED

## 5 INCHES IPS HD DISPLAY

7.5 Times Sharper Images Compared to  
4.3 inches Display



5" SCREEN



TRUE COLOR



178°VIEWING ANGLE

Image 2.1: Detail of the 5-inch IPS HD display, emphasizing its clarity and 178-degree viewing angle.



# 3 Viewing Modes

One Button Switch to Dual Cameray



Image 2.2: Visual representation of the borescope's three viewing modes: front, side, and dual split-screen, with details on focal lengths.

# 1080P DUAL LENS

## ENDOSCOPE CAMERA

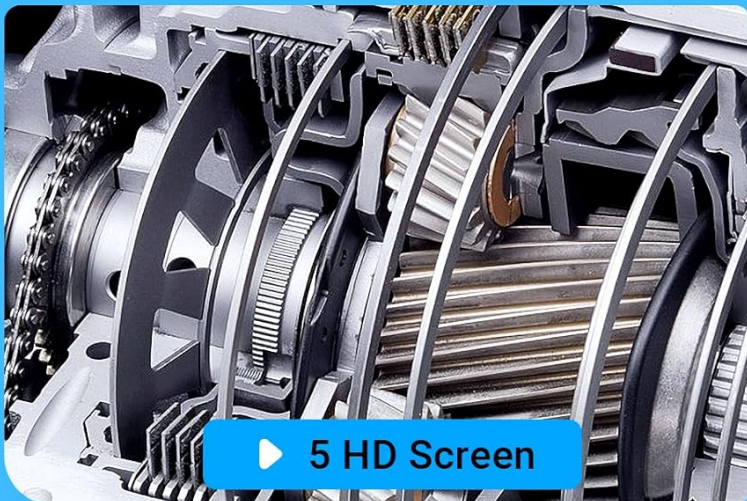

▶ 5 HD Screen

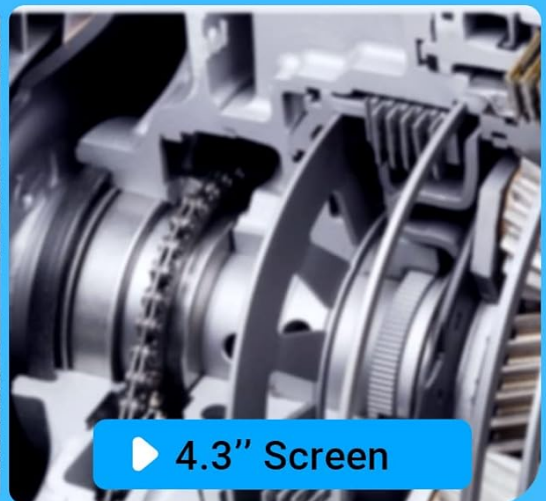

▶ 4.3" Screen

Image 2.3: Detailed diagram of the 1080P dual lens system within the camera head.

### 3. PACKAGE CONTENTS

Upon opening your NIDAGE Borescope package, please verify that all the following items are included:

- Dual Lens Inspection Camera (with built-in 32GB TF card)
- Portable Toolbox
- User Manual (this document)
- Type-C Charging Cable
- Accessories Kit (includes hooks and magnet)

### 4. SETUP

#### 4.1 Charging the Device

Before first use, fully charge the borescope. Connect the provided Type-C charging cable to the device's charging

port and plug the other end into a standard USB power adapter (not included). The charging indicator light will show the charging status. A full charge typically takes 3-4 hours and provides several hours of operation.

## 4.2 Inserting the TF Card

The device comes with a 32GB TF card pre-installed. If you need to remove or reinsert it, locate the TF card slot on the side of the monitor unit. Gently push the card until it clicks into place. To remove, push again to release.

## 4.3 Attaching Accessories

The accessories kit includes a hook and a magnet. These can be attached to the camera head for specific tasks, such as retrieving dropped items. Carefully screw the desired accessory onto the threaded tip of the camera head.

# 5. OPERATING INSTRUCTIONS

## 5.1 Power On/Off

To power on the device, press and hold the power button (usually marked with a power symbol) until the screen illuminates. To power off, press and hold the power button again until the screen turns off.

## 5.2 Screen Orientation (180° Rotation)

If the image on the screen appears upside down or at an awkward angle, press the 180° rotation button (often indicated by a circular arrow) to flip the image for better observation.

## 5.3 Switching Lenses (Front/Side/Dual View)

The borescope features a dual-lens system. Use the dedicated lens switch button (often marked with a camera icon or 'M') to cycle through the viewing modes:

- **Front View:** Displays the image from the forward-facing camera.
- **Side View:** Displays the image from the side-facing camera.
- **Dual View (Split Screen):** Displays both front and side camera views simultaneously on a split screen.



Image 5.1: Illustration of the front and side camera lenses and their specifications.

## 5.4 Adjusting LED Lights

The camera head is equipped with 7 dimmable LED lights. Use the light adjustment button (often marked with a light bulb icon) to increase or decrease the brightness, ensuring optimal illumination in various inspection environments.





Image 5.2: The 7 adjustable LED lights on the camera head and the integrated flashlight on the main unit.

## 5.5 Capturing Images and Videos

To capture an image, press the photo button (usually marked with a camera icon). To record a video, press the video button (usually marked with a video camera icon); press it again to stop recording. All captured media will be saved to the installed 32GB TF card.

## 5.6 Applications

The NIDAGE borescope is suitable for a wide range of applications, including but not limited to:

- Industrial Pipeline Inspection
- Home Pipeline and Drain Inspection
- Automotive Engine Inspection
- Wall Cavity Inspection
- Sewer Pipeline Inspection
- Outdoor Exploration and Inspection

The easiest way to  
find the trouble

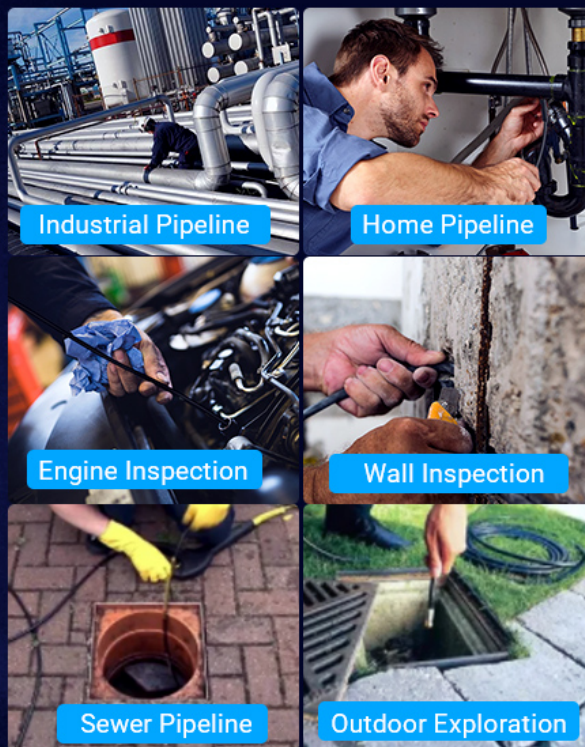

Image 5.3: Various practical applications of the NIDAGE borescope.



 **IP67**

Image 5.4: The borescope being used for drain inspection, highlighting its IP67 waterproof capability.

## 6. MAINTENANCE

- **Cleaning the Lens:** After each use, especially in dirty or wet environments, gently wipe the camera lens with a soft, dry cloth. For stubborn dirt, use a lens cleaning solution designed for optical devices.
- **Cable Care:** When coiling the cable, avoid sharp bends or kinks that could damage the internal wiring. Store the cable neatly in the provided toolbox.
- **Battery Care:** To prolong battery life, avoid fully discharging the device frequently. If storing for an extended period, charge the battery to about 50% and recharge every few months.
- **Storage:** Store the borescope and its accessories in the portable toolbox in a cool, dry place, away from direct sunlight and extreme temperatures.

## 7. TROUBLESHOOTING

Problem	Possible Cause	Solution
Device does not power on.	Low battery.	Charge the device fully using the provided Type-C cable.
Image is blurry or unclear.	Dirty lens; incorrect focal distance.	Clean the camera lens. Ensure the object is within the specified focal range for the active lens (front: 1.18-5.9in; side: 0.78-3.93in).
No image on screen.	Cable not properly connected; camera malfunction.	Ensure the camera cable is securely connected to the monitor unit. If the issue persists, contact customer support.
LED lights are not working or too dim/bright.	Brightness setting; low battery.	Adjust the LED brightness using the light adjustment button. Charge the device if the battery is low.
Cannot save photos/videos.	TF card full or not inserted correctly; card error.	Check if the 32GB TF card is properly inserted. Delete unnecessary files to free up space or try formatting the card (this will erase all data).
Cable is difficult to maneuver.	Complex bends; insufficient rigidity for application.	The semi-rigid cable is designed to hold its shape. For very tight or long bends, gentle manipulation and patience are required. Consider using a guide wire if applicable to your inspection scenario.

## 8. SPECIFICATIONS

Feature	Specification
Screen Size	5-inch IPS Color Screen
Video Capture Resolution	1080p
Camera Type	Dual Lens (Front & Side)
Front Camera Focal Length	1.18 - 5.9 inches
Side Camera Focal Length	0.78 - 3.93 inches
Cable Length	50 feet
Cable Type	Semi-Rigid
Water Resistance Level	IP67 (Camera Probe)
LED Lights	7 Dimmable LEDs on Camera Head
Storage Media	TF Card (32GB included)
Batteries	1 Lithium Polymer battery (included)
Item Weight	2.2 pounds
Package Dimensions	11.1 x 7.83 x 3.9 inches

Feature	Specification
Model Number	002
Manufacturer	TELESION

## 9. WARRANTY AND SUPPORT



NIDAGE provides a worry-free one-year warranty for this product. We are committed to ensuring your satisfaction with our inspection camera. If you encounter any issues or have questions regarding the product, please do not hesitate to contact our friendly customer service team.

**Customer Support Email:** [kekaika@thebest4.com](mailto:kekaika@thebest4.com)

Please provide your product model number (002) and a detailed description of the issue when contacting support for faster assistance.

© 2024 NIDAGE. All rights reserved.

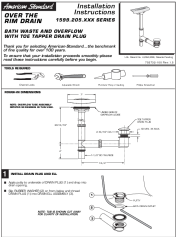
### Related Documents - 002

	<p><a href="#">NIDAGE WiFi Endoscope Camera User Manual: Setup, Operation, and Troubleshooting</a></p> <p>Comprehensive user manual for the NIDAGE WiFi Endoscope Camera (Model AW655). Learn how to connect, operate, and troubleshoot your endoscope for various inspection tasks. Includes safety guidelines and FCC compliance information.</p>
	<p><a href="#">American Standard 1599.205.XXX Series Over-the-Rim Drain Installation Instructions</a></p> <p>Comprehensive installation guide for the American Standard 1599.205.XXX Series Over-the-Rim Bath Waste and Overflow with Toe Tapper Drain Plug. Features include required tools, rough-in dimensions, step-by-step assembly, and part identification for a successful bathroom fixture installation.</p>
	<p><a href="#">Manuel d'Utilisation Moteur Polini EP-3+</a></p> <p>Guide complet pour l'utilisation, l'installation, l'entretien et le dépannage du système moteur Polini EP-3+ pour vélos électriques.</p>





[Polini E-P3+ E-bike Motor System User's Manual](#)

Comprehensive user's manual for the Polini E-P3+ electric bike motor system, covering installation, operation, safety, maintenance, and troubleshooting. Learn how to maximize your e-bike experience with Polini.

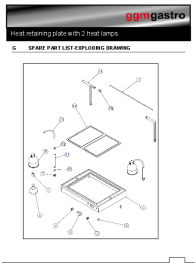

[ggmgastro Heat Retaining Plate with 2 Heat Lamps Spare Parts List](#)

Detailed spare parts list and exploded view diagram for the ggmgastro heat retaining plate with 2 heat lamps (Model WPE2). Includes product codes for each component.