

## Daytech DS17

# Daytech Wireless Door Chime System DS17 User Manual

Model: DS17

## INTRODUCTION

The Daytech Wireless Door Chime System, Model DS17, provides a reliable alert solution for various applications. This system is designed to notify you when a door or window is opened, enhancing security and convenience for homes, businesses, and caregiving environments. It is particularly useful for monitoring entry points, deterring potential intruders, and assisting with the supervision of children or elderly individuals.

# Door Chime for Business/Store/Office

## No more missing customers



**Business**



**Office**



**Patient medical supervision**

Image: The Daytech door chime system in a business setting, alerting staff to customer entry.

# Door and Window Alarms for Home

## Protect your family's personal and property safety



Image: Illustrations showing the door chime system used for child safety, intruder deterrence, and monitoring elderly individuals.

## PACKAGE CONTENTS

Your Daytech Wireless Door Chime System (Model DS17) package includes:

- 2 x Plug-in Receivers
- 4 x Door/Window Sensors (each consisting of a main unit and a magnetic strip)
- Mounting hardware (adhesive tape)
- User Manual (this document)



Image: A visual representation of the two plug-in receivers and four door/window sensors included in the package.

## PRODUCT OVERVIEW

---

### Key Features:

- **Extended Range:** Operates wirelessly up to 800 feet (240 meters) in open areas.
- **Customizable Alerts:** Choose from 20 distinct ringtones.
- **Adjustable Volume:** 5 volume levels, ranging from 0 dB (mute) to 110 dB.
- **Visual Indicator:** Receiver features an LED indicator and a small night light for visual alerts.
- **Durable Sensors:** IP44 waterproof rating for outdoor use and enhanced durability.
- **Long-lasting Sensor Battery:** Sensors are designed for up to 100,000 uses, providing 3-5 years of battery life.
- **Expandable System:** Supports multiple receivers and sensors for comprehensive coverage.





Image: A diagram illustrating the 800ft wireless signal transmission range of the system within a multi-story building.



Image: A close-up of the door sensor, highlighting its IP44 waterproof rating and operational temperature range of -4°F (-20°C) to 140°F (60°C).

# New Upgrade Door Sensor Battery



Up to  
**100,000** uses



**IP44**  
waterproof

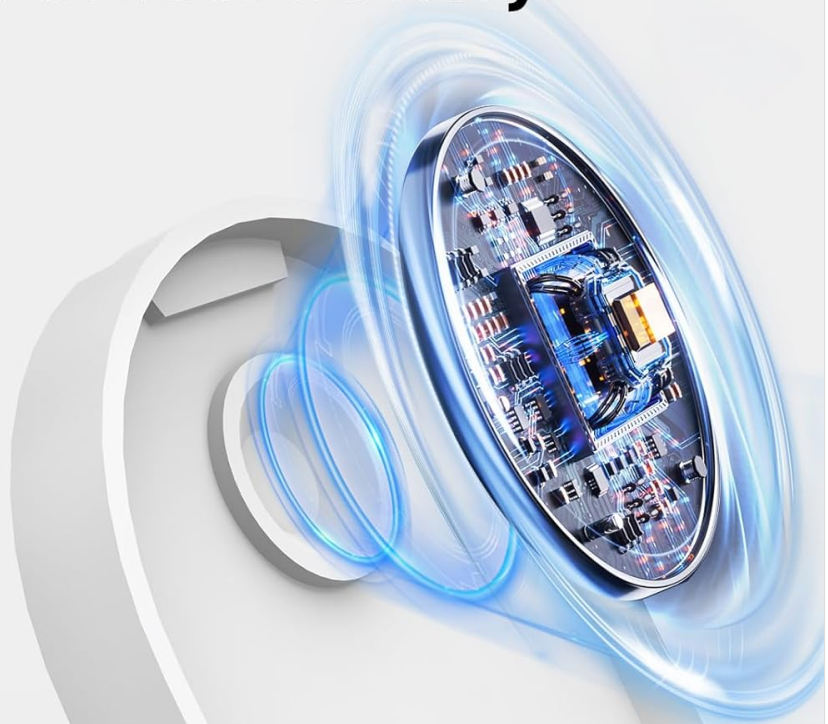

## Working Temperature:



-4°F(-20°C)

140°F(60°C)

## Battery Life:



3 years

5 years

Image: An infographic detailing the upgraded door sensor battery, offering up to 100,000 uses and a 3-5 year lifespan, alongside its IP44 waterproof rating.

## SETUP INSTRUCTIONS

The sensors and receivers are pre-paired at the factory for your convenience. Follow these steps for installation and initial setup:

### 1. Install the Receivers:

1. Plug each receiver into a standard electrical outlet in your desired location. Ensure the outlet is within the 800ft operating range of your sensors.

# Loud Alert Sound

## 5 Adjustable Volume Levels



Plug to Use



20 Ringtones



0-110dB Alarm



LED Indicator

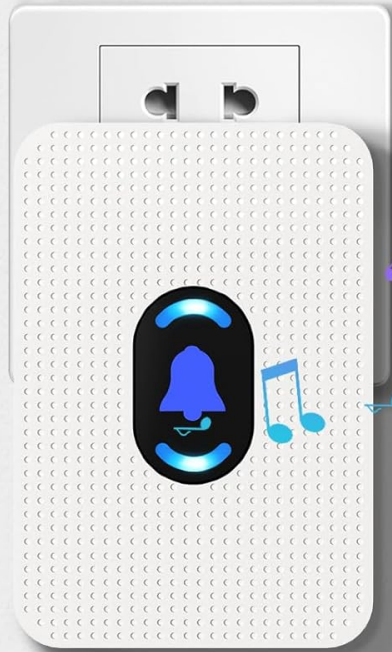

0dB



30dB



60dB

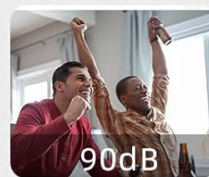

90dB



110dB

Image: The plug-in receiver connected to a wall outlet, illustrating its adjustable volume levels and multiple ringtone options.

## 2. Mount the Sensors:

1. Identify the desired location for each sensor (e.g., door, window, drawer, cabinet).
2. Clean the surface thoroughly where the sensor will be mounted.
3. Peel off the protective film from the double-sided adhesive tape on the back of both the main sensor unit and the magnetic strip.
4. Attach the main sensor unit to the fixed frame of the door/window and the magnetic strip to the moving part (door/window itself).
5. Ensure the main sensor unit and the magnetic strip are aligned and placed within 0.6 inches (1.5 cm) of each other when the door/window is closed. The red indicator light on the sensor should face the magnetic strip.



# Where Can You Install



Image: Visual examples demonstrating suitable installation locations for the sensors, including doors, windows, drawers, and cabinets.



# Easy to install and use

## Mounting door sensor--- Using the adhesive tape



## Battery Replacement--- Using the screwdriver



 Battery type: CR2450

Image: A step-by-step visual guide on how to mount the door sensor using the provided adhesive tape.

### 3. Pairing Additional Sensors or Changing Chimes (if needed):

If you need to pair new sensors or change the chime for a specific sensor, follow these steps:

1. **Select Melody:** Press the "Forward" or "Backward" button on the receiver to cycle through the 20 available melodies until you find your preferred one.
2. **Enter Pairing Mode:** Long press the Volume Control button on the receiver for 5-7 seconds until the LED blinks rapidly and you hear a "ding" sound. The receiver is now in pairing mode.
3. **Activate Sensor:** Quickly separate the two parts of the door sensor (main unit and magnetic strip) to activate the transmitter and send a signal to the receiver.
4. **Confirmation:** Upon successful pairing, the receiver will sound the selected melody, indicating that the sensor is now linked.

# How to pair and select music?

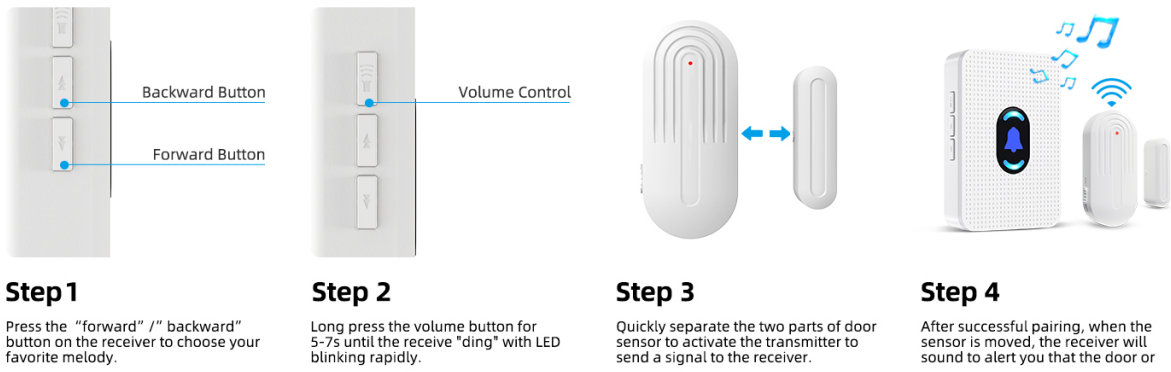

Image: A visual guide detailing the four steps to pair a sensor with a receiver and select a specific melody.

## OPERATING INSTRUCTIONS

### 1. Adjusting Volume:

The receiver has dedicated volume buttons (usually indicated by '+' and '-' symbols or similar icons on the side). Press these buttons to cycle through the 5 available volume levels, including a mute option (0 dB) up to 110 dB.

### 2. Changing Ringtones:

Use the "Forward" and "Backward" buttons on the receiver to select from the 20 different melodies. Each press will advance or go back one melody.

### 3. Receiving Alerts:

When a paired door/window sensor detects an opening (i.e., the main unit and magnetic strip separate), it will send a signal to the receiver. The receiver will then play the selected chime and its LED indicator will flash, providing both audible and visual alerts.

## MAINTENANCE

### 1. Sensor Battery Replacement:

The door sensors are powered by a CR2450 lithium battery. When the sensor's performance degrades or it stops transmitting signals, the battery may need replacement.

1. Carefully open the sensor casing using a small screwdriver.
2. Remove the old CR2450 battery.
3. Insert a new CR2450 battery, ensuring correct polarity.
4. Close the sensor casing securely.

# Easy to install and use

## Mounting door sensor--- Using the adhesive tape



## Battery Replacement--- Using the screwdriver

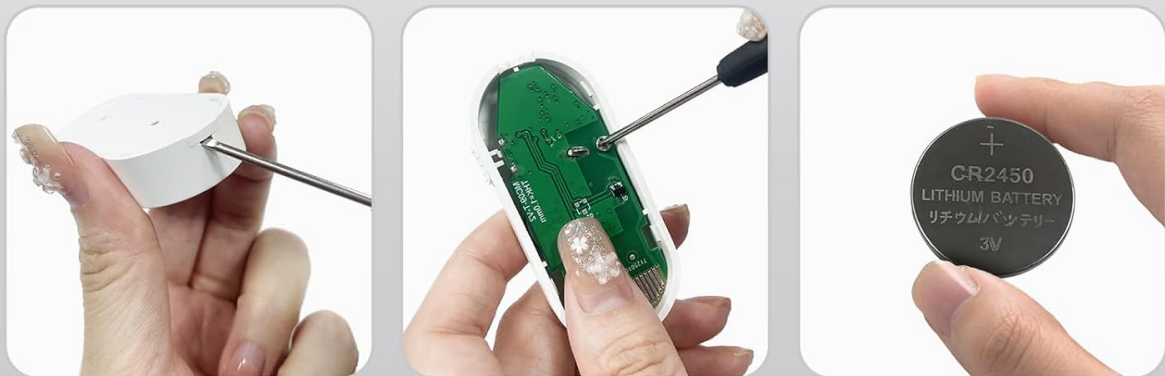

 Battery type: CR2450

Image: A visual guide demonstrating how to open the sensor, replace the CR2450 battery, and reassemble.

## 2. Cleaning:

Wipe the receivers and sensors with a soft, dry cloth. Avoid using abrasive cleaners or solvents, as these can damage the product's finish or internal components.

## TROUBLESHOOTING

### • No Alert from Receiver:

- Ensure the receiver is properly plugged into a working electrical outlet.
- Check if the receiver's volume is set to an audible level (not mute).
- Verify that the sensor's battery is not depleted. Replace if necessary (CR2450).
- Confirm the sensor and receiver are within the effective operating range (up to 800ft). Obstacles like thick walls or metal structures can reduce range.
- Re-pair the sensor with the receiver following the "Pairing Additional Sensors" steps.

### • Sensor Not Triggering:

- Ensure the main sensor unit and magnetic strip are installed correctly and are less than 0.6 inches (1.5 cm) apart when the door/window is closed.
- Check the sensor battery.
- Test the sensor by manually separating the two parts to see if the red indicator light flashes.

- **False Alarms:**

- Ensure the sensor components are securely mounted and do not shift.
- Verify the gap between the sensor and magnetic strip is appropriate when closed.

## SPECIFICATIONS





Brand	Daytech
Model Number	DS17
UPC	794304663084
Power Source (Receiver)	AC Plug-in (260 Volts - <i>Note: Please verify local voltage compatibility</i> )
Power Source (Sensor)	CR2450 Battery (Included)
Control Method	Touch Buttons
Noise Level	0-110 Decibels
Mounting Type	Adhesive Door Mount
Maximum Wireless Range	800 feet (240 meters)
Sensor Technology	Contact Sensor
Sensor Waterproof Rating	IP44
Operating Temperature	-4°F to 140°F (-20°C to 60°C)
Item Weight	12 ounces (total package)
Package Dimensions	4.8 x 4.13 x 3.5 inches

## WARRANTY AND SUPPORT

For warranty information or technical support, please contact Daytech customer service. Refer to the product packaging or the official Daytech website for the most current contact details.

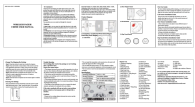
**Website:** [www.daytech.com](http://www.daytech.com)



	<a href="#">Daytech Wireless Chime/Pager User Manual - INST-EN-CC01-T-20230214</a> Comprehensive user manual for the Daytech Wireless Chime/Pager (INST-EN-CC01-T-20230214), covering features, specifications, installation, operation, troubleshooting, and maintenance.
	<a href="#">Daytech LC01 Wireless Pager/Chime System User Manual</a> Comprehensive user manual for the Daytech LC01 Wireless Pager and Chime system, covering features, product diagrams, installation guides, operation instructions, troubleshooting, specifications, and ringtone list.
	<a href="#">Multifunctional Pager Operation Instruction and User Guide</a> Comprehensive user manual for the Multifunctional Pager, detailing its appearance, power-on procedures, pairing with the SOS button, mobile app connectivity (Tuya Smart/Smart Life), app operations including alarm settings and device management, installation guidance, specifications, troubleshooting Q&A, and after-sales service information.
	<a href="#">WT07-US Two Way Radio Operating Instructions</a> Operating instructions for the WT07-US two way radio, covering basic operation, key functions, voice annunciation, low battery warnings, and advanced features like VOX and Scrambler/Compandor.
	<a href="#">Wireless Outdoor Siren User Manual - Daytech Electronics</a> User manual for the Daytech Wireless Outdoor Siren with 120dB sound and flash. Includes setup instructions, pairing guide, and technical specifications.
	<a href="#">BT-DB19 Transmitter Operating Manual</a> This manual provides operating instructions for the BT-DB19 Transmitter, including product overview, features, technical specifications, and battery replacement.

Documents - Daytech – DS17

[pdf] User Manual Diagram

LC01US DS17 1121 DS17 Door Chime you for purchasing a DAYTECH Chime! offers wide range of pairing has been reset Then can follow the STEP 1~STEP 3 to pair again C18ldHO14TL m media amazon images I |||

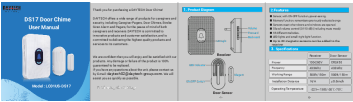

**DS17** Door Chime User Manual Model : LC01US-**DS17** Thank you for purchasing a DAYTECH Door Chime DAYTECH offers a wide range of products for caregivers and security, including Caregiver Pagers, Door Chimes, Strobe Siren Alarm and Pagers, for the peace of mind of both caregivers and receivers.DAYTECH ...  
lang:en score:33 filesize: 6.86 M page\_count: 2 document date: 2023-11-30

