

[Manuals.plus](#) /

› [TSA Universal](#) /

› TSA Universal Travel Power Adapter for Turkey (Model B09FDDR739) - Instruction Manual

TSA Universal B09FDDR739

TSA Universal Travel Power Adapter for Turkey (Model B09FDDR739)

Instruction Manual

INTRODUCTION

This manual provides essential instructions for the safe and effective use of your TSA Universal Travel Power Adapter. This adapter is designed to allow North American electrical plugs to connect to Type C outlets commonly found in Turkey. It is suitable for charging and powering modern dual-voltage electronic devices.



Image: A set of six blue TSA Universal travel power adapters, ready for use.

PRODUCT FEATURES

- **Compatibility:** Specifically designed for use in Turkey with Type C electrical outlets.
- **Construction:** Features reinforced prongs, durable fireproof ABS plastic, and copper components.
- **Rating:** Rated for 125V/250V and 6A.
- **Design:** Compact and lightweight for easy portability.
- **Usage:** Compatible with most portable electronic devices, including phones, tablets, and e-readers.

SETUP AND CONNECTION

Follow these steps to properly connect your devices using the travel adapter:

1. **Verify Device Voltage:** Ensure your electronic device is dual-voltage (100-240V) or compatible with 220V, which is the standard voltage in Turkey. This adapter does not convert voltage.
2. **Connect Device to Adapter:** Insert your North American electrical plug firmly into the front receptacle of the TSA Universal travel adapter.
3. **Connect Adapter to Outlet:** Insert the adapter, with your device connected, into a Type C wall outlet in Turkey. Ensure a secure fit.



Image: A North American plug and the TSA Universal adapter, demonstrating the connection method.

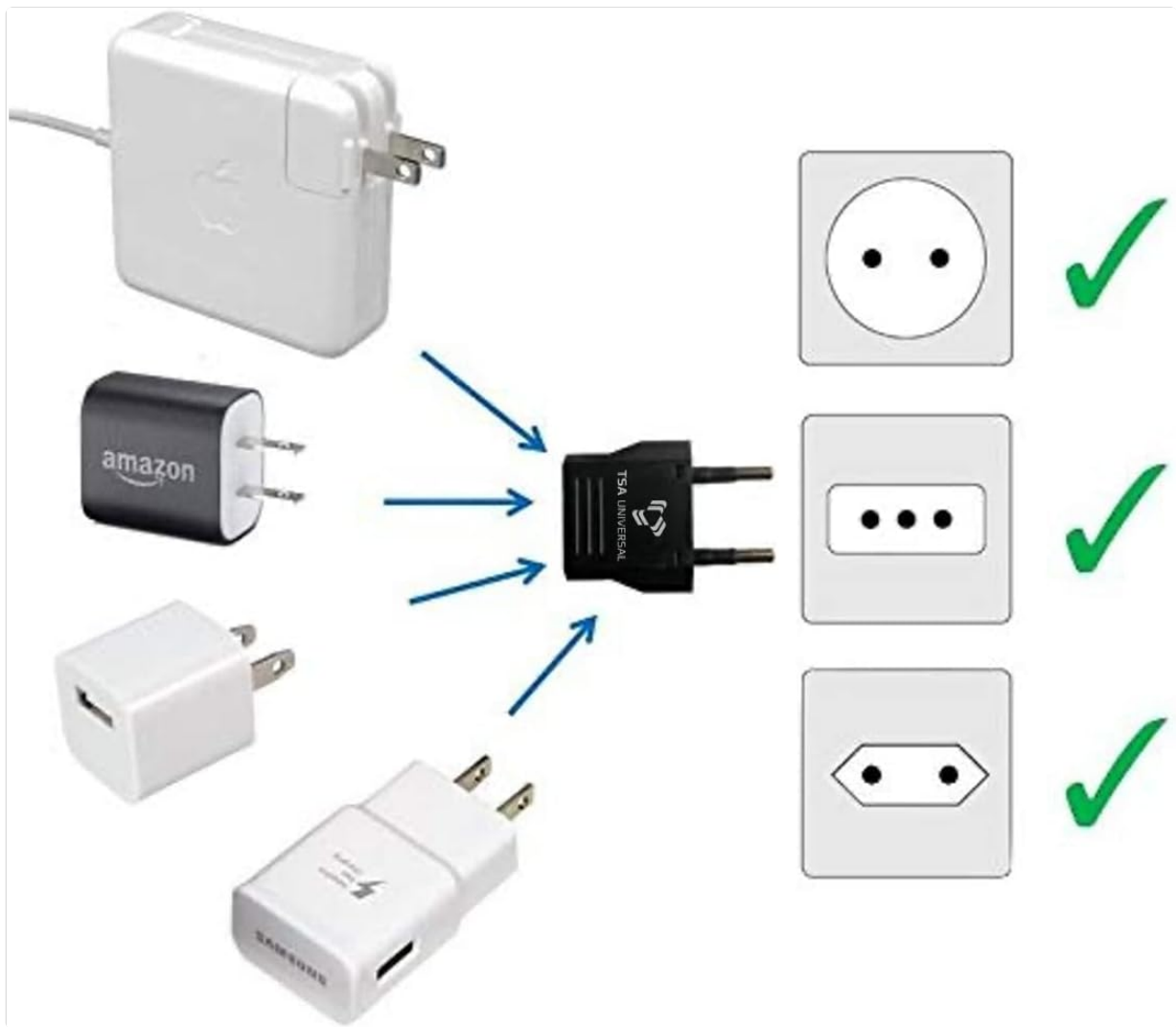

Image: Illustration of common North American device chargers connecting to the adapter, which then plugs into compatible European outlets.

OPERATING INSTRUCTIONS

Once connected, your device should begin charging or operating normally. The adapter facilitates the physical connection between different plug types. It does not alter the electrical voltage.

For optimal performance and safety:

- Always ensure the adapter is fully inserted into the wall outlet and your device's plug is fully inserted into the adapter.
- Avoid using the adapter in damp or wet conditions.
- Do not force the adapter into an incompatible outlet.



Image: The compact adapter fits easily into a travel bag alongside other essentials.

SAFETY INFORMATION AND WARNINGS

WARNING: This adapter does NOT convert voltage.

It is crucial to understand that this product is a plug adapter only. It does not convert electrical voltage. You must ensure that your electronic devices are compatible with the local voltage (220V in Turkey) or are dual-voltage (100-240V) before use.

- **Voltage Compatibility:** Use only with modern (dual-voltage) small electronics.
- **Incompatible Devices:** Do NOT use with high-power, heat-producing devices such as irons, hair dryers, curling irons, lamps, or other appliances that are not dual-voltage. Using incompatible devices can cause damage to the device, the adapter, or pose a fire hazard.
- **Proper Outlets:** Use only in properly wired sockets.
- **Children:** Keep out of reach of children.

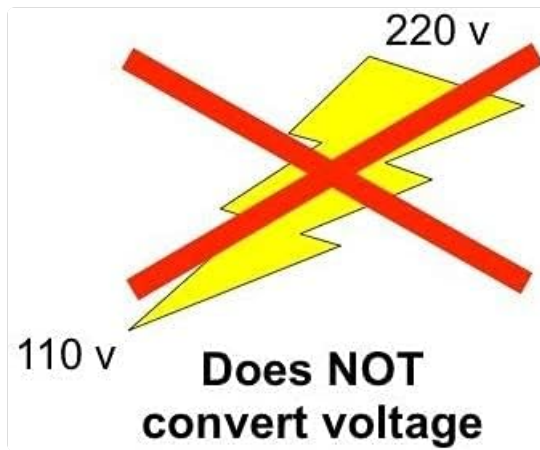

Image: Visual warning indicating that the adapter does not convert voltage.

SPECIFICATIONS

Plug Type	Type C (19 x 4.0 mm 2-pin)
Material	Fireproof ABS, Copper
Rated Voltage / Current	125V/250V 6A
Item Weight	1.8 ounces
Dimensions	4 x 3 x 0.25 inches (Package)
Model Number (ASIN)	B09FDDR739
UPC	678247244152

TROUBLESHOOTING

- **Device Not Charging:**
 - Ensure your device is dual-voltage or compatible with 220V.
 - Check that both the device plug and the adapter are fully and securely inserted.
 - Verify the wall outlet is functional.
- **Loose Connection:**
 - Ensure the adapter is firmly seated in the wall outlet.
 - Ensure your device's plug is fully inserted into the adapter.
- **Sparking When Plugging In:**
 - A small spark can sometimes occur when connecting electrical devices due to inrush current. If sparking is excessive, persistent, or accompanied by smoke or burning smell, immediately discontinue use and consult a qualified electrician.

MAINTENANCE

The TSA Universal Travel Power Adapter requires minimal maintenance. Keep the adapter clean and dry. Do not attempt to disassemble or repair the adapter yourself. If the adapter is damaged, discontinue use and replace it.

WARRANTY AND SUPPORT

This TSA Universal Travel Power Adapter comes with a **Lifetime Warranty**, ensuring its functionality in all modern Turkish outlets. For support or warranty claims, please contact the manufacturer, Vericonic LLC. TSA Universal is a brand of Vericonic LLC, a USA-based veteran-owned business.