

## Tenda MX6

# Tenda Nova MX6 AX1800 Whole Home Mesh WiFi 6 System Instruction Manual

## 1. INTRODUCTION

This manual provides detailed instructions for setting up, operating, and maintaining your Tenda Nova MX6 AX1800 Whole Home Mesh WiFi 6 System. This system is designed to provide extensive and stable Wi-Fi coverage throughout your home, eliminating dead zones and supporting numerous connected devices with high-speed Wi-Fi 6 technology.

## 2. PACKAGE CONTENTS

Please verify that all items are present in your package:

- Customer manual
- MX6 Mesh x 3 units
- Power adapter x 3
- RJ45 Gigabit Ethernet cable x 1

## 3. PRODUCT OVERVIEW

The Tenda Nova MX6 units are compact, white, and designed for discreet placement. Each unit features multiple Gigabit Ethernet ports for wired connections and internal antennas for optimal wireless performance.



Figure 1: Three Tenda Nova MX6 mesh units, showcasing their design and compact form factor.



Figure 2: Rear view of a Tenda Nova MX6 unit, highlighting the three Gigabit Ethernet ports for wired connections.

## 4. KEY FEATURES

- **Super-Fast Wi-Fi 6 Mesh:** The MX6 system utilizes dual-band Wi-Fi 6 (802.11ax) for speeds up to 1775Mbps, enhanced by a 1.5GHz Quad-Core Broadcom high-performance processor for a responsive and stable distributed mesh network.



Figure 3: The 1.5GHz Quad-Core Broadcom CPU ensures powerful processing and ultra-low latency for the mesh system.

- **Extensive Coverage:** Provides up to 6,000 sq.ft. of whole-home coverage, effectively eliminating Wi-Fi dead zones and offering a faster, more stable Wi-Fi mesh network.

# Secure Wi-Fi Mesh Network

WPA3—New Level of Cyber Security



Figure 4: A set of three Nova units can cover up to 6,000 sq.ft., providing comprehensive Wi-Fi throughout a home.

- **Seamless Roaming:** All units work together under a single network name and password, ensuring that Wi-Fi enabled devices automatically connect to the strongest access point node as you move around your home.



## Get the best Wi-Fi all around your home

A set of 3 Nova units can cover up to 6,000 sq.ft

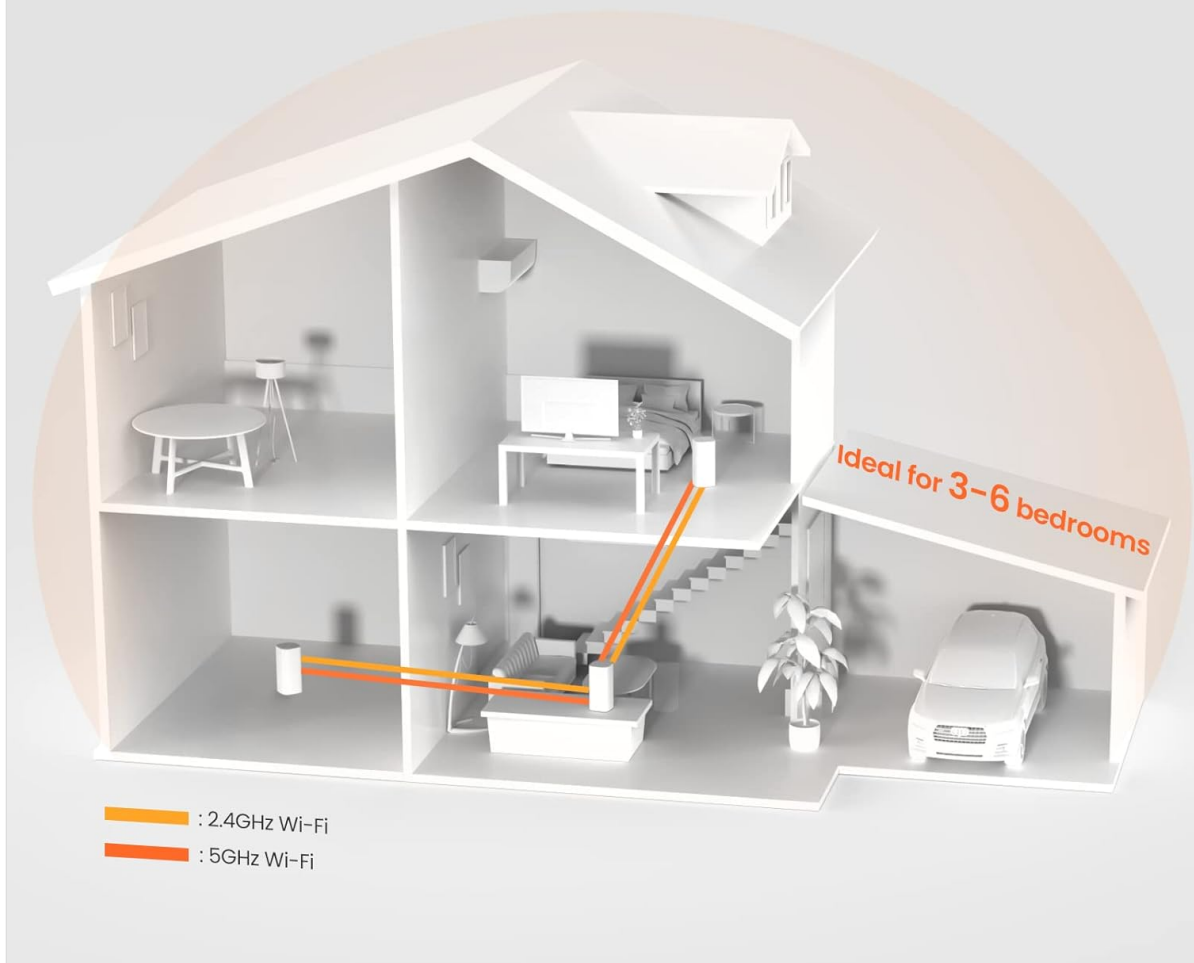

Figure 5: Seamless roaming ensures uninterrupted connectivity as users move between different areas of the home.

- **High Capacity & Flexibility:** Powered by MU-MIMO and OFDMA technology, the AX1800 Dual Band Nova Mesh Wi-Fi system supports over 160 devices with a lag-free experience.

## Supports over 160 connected devices

Enjoy a faster and smoother experience of multiplayer online games and Ultra HD videos.

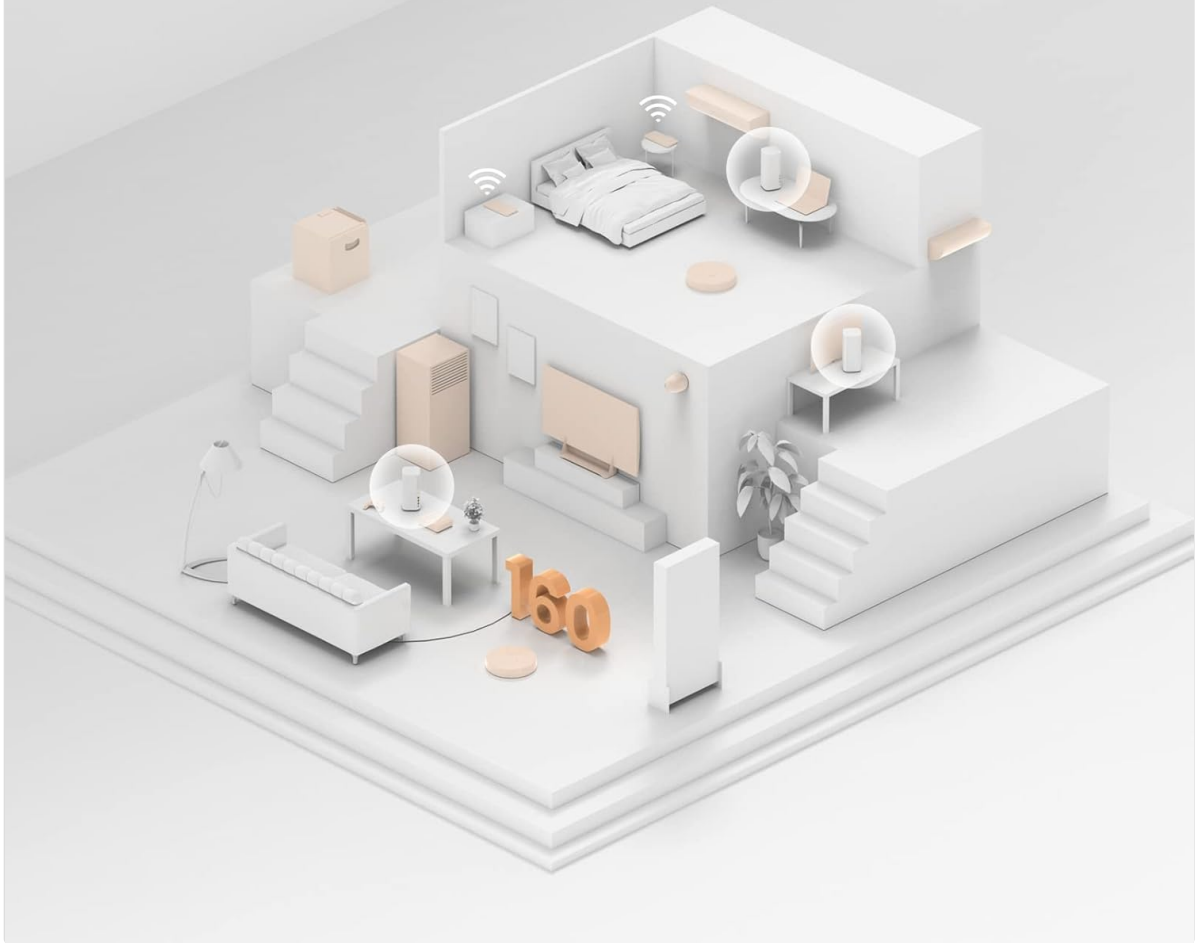

Figure 6: The system supports over 160 connected devices, providing a faster and smoother experience for various online activities.

- **Secure Wi-Fi Mesh Network:** Utilizes WPA3 encryption to protect your network and connected devices from unauthorized access. A guest network feature is available for visitors, safeguarding your privacy.

## Whole Home Seamless Roaming

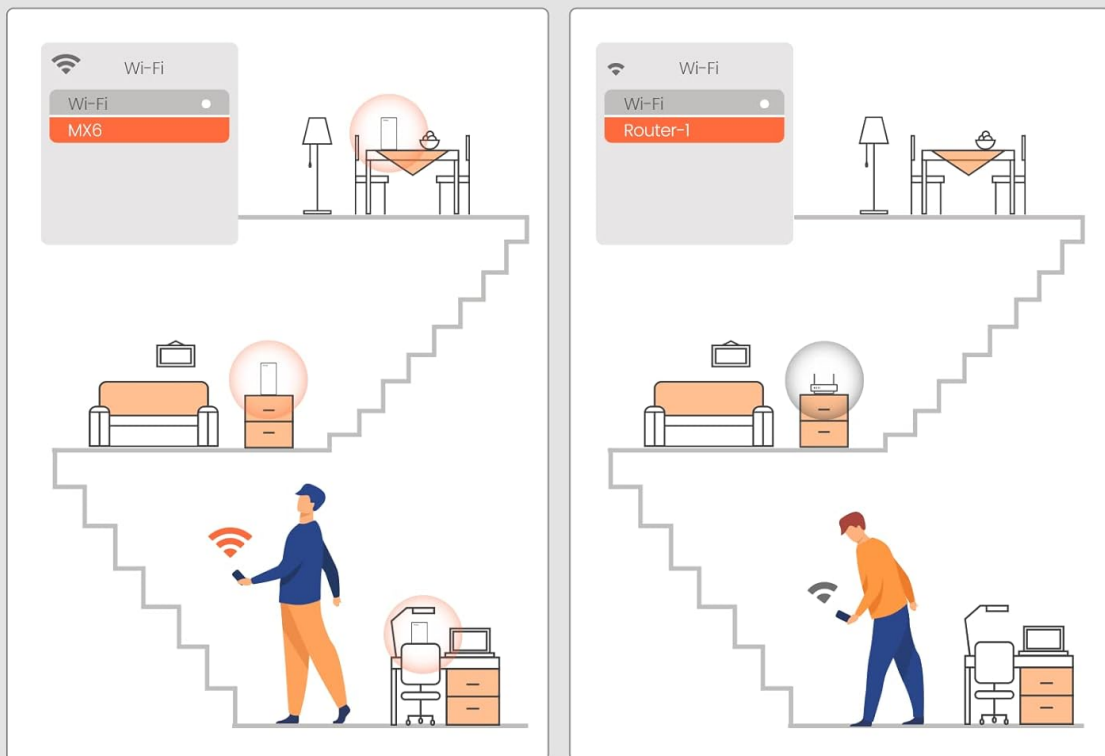

Figure 7: WPA3 provides a new level of cyber security for your mesh network, protecting your data and devices.

## 5. SETUP

Setting up your Tenda Nova MX6 system is designed to be quick and straightforward:

1. **Download the Tenda Wi-Fi App:** Search for 'Tenda Wi-Fi' in your mobile app store and install it.
2. **Connect the Main Unit:** Connect one MX6 unit to your modem using the provided Ethernet cable. Power on the unit.
3. **Initial Configuration:** Follow the on-screen instructions in the Tenda Wi-Fi App to set up your primary mesh unit and create your Wi-Fi network.
4. **Add Additional Units:** Place the other MX6 units in desired locations within your home. Power them on. They will automatically connect to the main unit to form a seamless mesh network. A new node can also be added to existing Nova networks with the push of the Mesh button.



# Easy setup in minutes with the Web GUI & Tenda Wi-Fi APP

Remote control your Nova units at anytime, anywhere



Figure 8: Easy setup and remote management are available through the Tenda Wi-Fi App or Web GUI.

Video 1: An official product video demonstrating the features and setup of the Tenda Nova MX6 Wi-Fi 6 Mesh Whole Home WiFi System.

## 6. OPERATING THE MESH SYSTEM

### 6.1 Seamless Roaming

The Tenda Nova MX6 system ensures that your devices automatically switch to the strongest Wi-Fi signal as you move around your home, providing a continuous and stable connection without manual intervention.

### 6.2 Parental Controls

Manage your children's online time and supervise content through the Tenda Wi-Fi App or Web GUI. This feature allows you to set schedules for internet access and filter inappropriate content.

### 6.3 Guest Network

Create a separate guest network for visitors. This isolates your main network, enhancing security and privacy. You can easily set up guest access, online period time, and speed limits via the smartphone app.

## 6.4 Amazon Alexa Integration

The Tenda Nova MX6 system is compatible with Amazon Alexa, allowing you to control certain network functions using voice commands. For example, you can ask Alexa to turn on or off the guest network.



Figure 9: The Tenda Nova MX6 works with Amazon Alexa, enabling voice control for network features like parental controls.

## 7. MAINTENANCE

### 7.1 Firmware Upgrade

Regularly check for and install firmware upgrades through the Tenda Wi-Fi App or Web GUI to ensure optimal performance, security, and access to new features.

### 7.2 Auto System Maintenance

The system includes an auto system maintenance feature to help keep your network running smoothly. Refer to the app settings for configuration options.

## 8. TROUBLESHOOTING

If you encounter any issues with your Tenda Nova MX6 system, consider the following basic troubleshooting steps:

- **No Internet Connection:** Verify that your modem is working correctly and that the main MX6 unit is properly connected to it. Check the status indicator lights on the MX6 units.
- **Weak Signal or Dead Zones:** Ensure that the MX6 units are placed optimally, avoiding obstructions and maintaining a reasonable distance from each other. Adding more units may be necessary for very large homes.
- **Device Connectivity Issues:** Restart the problematic device and try reconnecting to the Wi-Fi network. Ensure the device's Wi-Fi adapter supports Wi-Fi 6 for optimal performance.
- **App or Web GUI Access:** If you cannot access the Tenda Wi-Fi App or Web GUI, ensure your device is connected to the Nova MX6 network and try restarting the app or browser.

For more complex issues or persistent problems, please contact Tenda's professional support team.

## 9. SPECIFICATIONS

Feature	Specification
Wireless Type	802.11ax (Wi-Fi 6)
Brand	Tenda
Model Number	MX6
Item Weight	4.11 pounds
Item Dimensions LxWxH	3.35 x 0.01 inches
Color	White
Special Feature	WPS
Frequency Band Class	Dual-Band
Compatible Devices	All WiFi Enabled Devices
Recommended Uses For Product	Home
Connectivity Technology	Ethernet, Wi-Fi 6
Antenna Type	Internal

## 10. WARRANTY AND SUPPORT

Tenda offers a 3-year warranty for its mesh Wi-Fi products. For any technical issues or inquiries, please feel free to contact Tenda's professional support team via the Amazon Message Center. A satisfactory solution is promised.

