

[Manuals.plus](#) /

› [Aqualin](#) /

› Aqualin DIY Micro Drip Irrigation Kit User Manual

Aqualin Aqualin

Aqualin DIY Micro Drip Irrigation Kit

USER MANUAL

Introduction

The Aqualin DIY Micro Drip Irrigation Kit is designed to provide automated watering for up to 10 indoor potted plants. This system offers customizable frequency and duration settings, ensuring your plants receive optimal hydration. Its rechargeable lithium-ion battery and USB charging capability make it an environmentally friendly and versatile solution for plant care, suitable for various water sources like bottles or tanks.

Safety Information

Please read and understand all safety instructions before operating this device. Improper use may result in damage to the product or surrounding property.

- Ensure the device is placed on a stable surface to prevent tipping.
- Do not submerge the main controller unit in water.
- Use only the provided USB charging cable for recharging the battery.
- Keep out of reach of children and pets.
- Disconnect power before performing any maintenance or cleaning.

Product Overview and Components

Familiarize yourself with the components included in your Aqualin DIY Micro Drip Irrigation Kit:

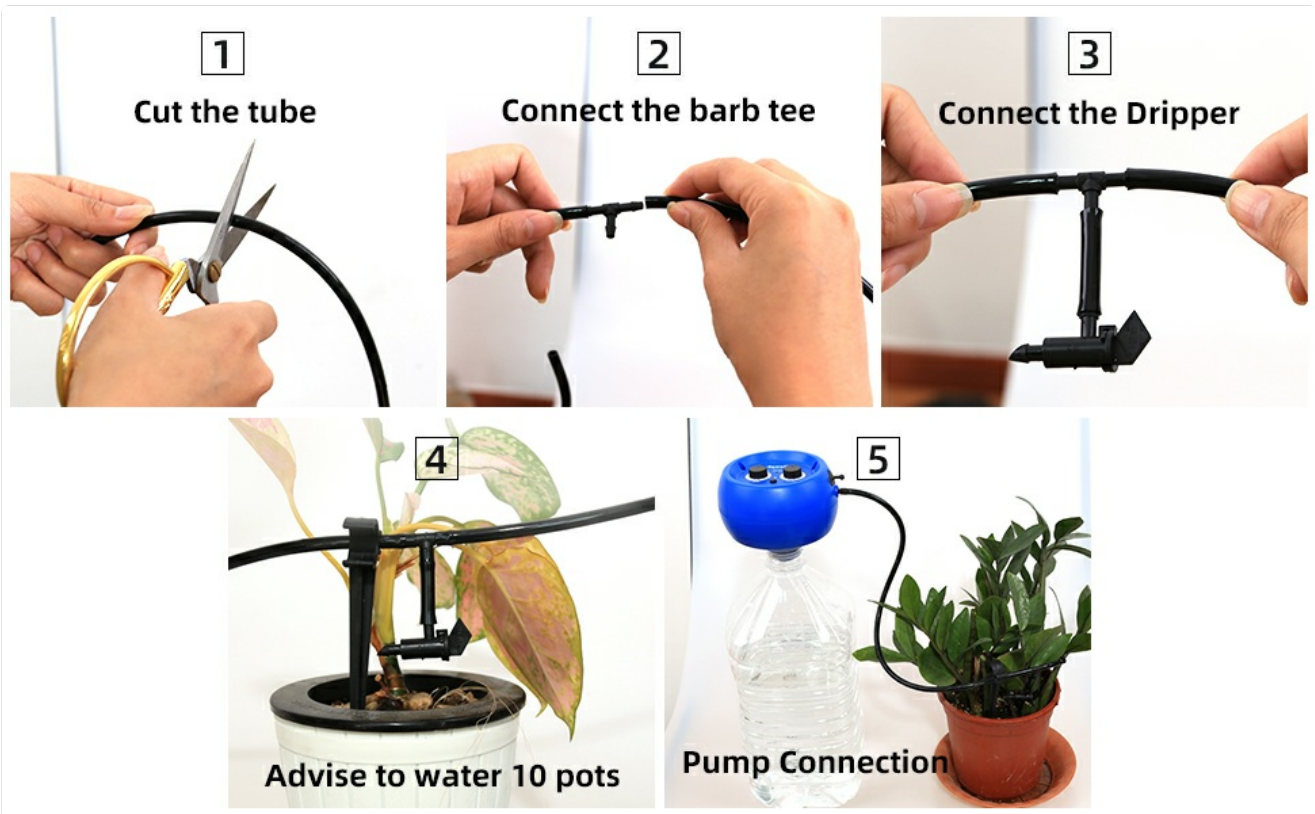

Image: All components of the Aqualin DIY Micro Drip Irrigation Kit, including the controller, tubing, drippers, and accessories.

- **Controller Unit:** The main device with frequency and duration dials.
- **USB Charging Cable:** For recharging the internal battery.
- **10m PVC Hose:** Main tubing for water distribution.
- **Drippers (10x):** Adjustable emitters for individual plants.
- **Barb Tees (10x):** Connectors for splitting the main hose to drippers.
- **Tube Holder Stakes (10x):** To secure drippers in plant pots.
- **End Plugs (2x):** To seal the ends of the drip lines.
- **Adapter Converter:** For connecting the controller to various water sources.
- **Hook:** For hanging the controller if using a bucket as a water source.

Setup Instructions

Follow these steps to set up your drip irrigation system:

1. **Prepare the Tubing:** Cut the 10m PVC hose into appropriate lengths for each plant, ensuring enough length to reach from the controller to each pot.
2. **Connect Barb Tees:** Insert a barb tee into the cut ends of the main tubing where you want to branch off to a plant.
3. **Attach Drippers:** Connect one end of a shorter piece of tubing to the barb tee and the other end to a dripper.
4. **Position Drippers:** Place the dripper into the soil of each potted plant, securing it with a tube holder stake. The system is designed to water up to 10 pots.
5. **Connect Controller to Water Source:**
 - **For Bottles:** Screw the controller directly onto the neck of a suitable water bottle (large or small).

- **For Buckets/Tanks:** Use the provided hook to hang the controller on the rim of a bucket or tank, ensuring the intake hose is submerged.

PRODUCT PARTS



1 x Adapter Converter



1x USB Charging Line



1 x Controller



2 x End Plug



10 x Dripper



1 x 10m PVC Hose



10 x Barb Tee



10 x Tube Holder Stake



1x Hook

Image: Visual guide for cutting tubing, connecting barb tees, attaching drippers, and connecting the pump to a water source.



Fit for big bottles



Fit for small bottles



Fit for ordinary buckets



Image: Examples of connecting the controller to large bottles, small bottles, and ordinary buckets.

Operating Instructions

The Aqualin controller allows you to customize watering schedules:

1. **Set Frequency:** Use the 'Frequency' dial to select how often the system waters. Options include every 1, 3, 6, 12, 24, 48 hours, or every 3, 4, 5, 6, 7 days.
2. **Set Duration:** Use the 'Duration' dial to select how long the system waters during each cycle. Options include 0.5, 1, 3, 5, 6, 7, 8, 10, 12, 15 minutes.
3. **Manual Watering:** A manual function is available for immediate watering outside of the set schedule. Refer to the controller for the specific button or action.
4. **Charging:** The built-in Lithium-ion battery is rechargeable via the USB cable. Connect the cable to the controller and a standard USB power source (e.g., phone charger, computer USB port). The battery indicator light will show charging status.

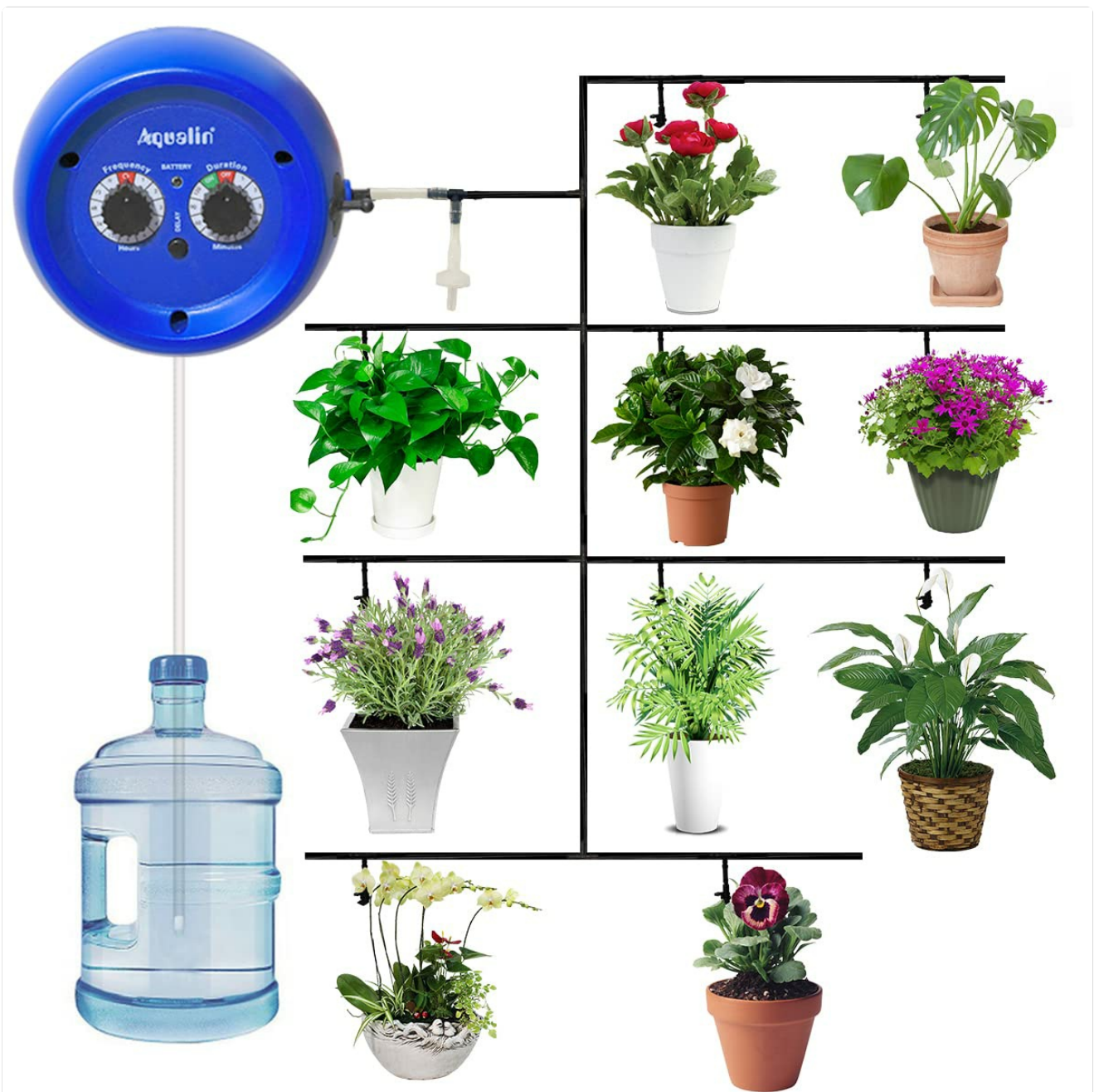

Image: The Aqualin controller connected to a water reservoir, providing irrigation to multiple indoor potted plants.

Maintenance

Regular maintenance ensures optimal performance and longevity of your irrigation kit:

- **Clean Drippers:** Periodically check drippers for clogs from sediment or mineral buildup. Clean them by flushing with water or gently removing any obstructions.
- **Inspect Tubing:** Check the tubing for kinks, leaks, or damage. Replace any compromised sections to maintain consistent water flow.
- **Water Source Cleanliness:** Ensure your water source (bottle, tank, bucket) is clean to prevent debris from entering the system.
- **Battery Care:** Recharge the battery regularly, especially if the system will be idle for an extended period. Avoid fully draining the battery frequently to prolong its lifespan.
- **Storage:** When not in use, clean all components, dry them thoroughly, and store the kit in a cool, dry place away from direct sunlight.

Troubleshooting

If you encounter issues with your Aqualin Drip Irrigation Kit, refer to the following common problems and solutions:

Problem	Possible Cause	Solution
No water flow or weak flow	Clogged drippers/tubing, low water level, weak pump, battery low.	Clean drippers/tubing. Refill water source. Recharge battery. Ensure pump intake is fully submerged.
System not turning on	Battery depleted, power button not pressed.	Recharge the battery. Press the power button firmly.
Inconsistent watering	Air in the lines, uneven tubing layout, drippers not properly installed.	Bleed air from the system. Ensure tubing is laid out without significant elevation changes between drippers. Re-seat drippers.
Battery not holding charge	Aging battery, improper charging.	Ensure proper charging practices. If battery life significantly degrades, consider contacting support for replacement options.

Specifications

Feature	Detail
Brand	Aqualin
Model Name	Aqualin DIY Micro Drip Irrigation Kit
Item Model Number	Aqualin (22079)

Feature	Detail
Material	Plastic
Flow Rate	100-300 ml/min
Frequency Settings	1, 3, 6, 12, 24, 48 Hours; 3, 4, 5, 6, 7 Days
Run Time Settings	0.5, 1, 3, 5, 6, 7, 8, 10, 12, 15 Minutes
Power Source	Rechargeable Lithium-ion Battery (USB Charged)
Max Potted Plants Supported	10
Package Dimensions	20.4 x 20.2 x 9.5 cm
Item Weight	740 g

Warranty and Support

This product is manufactured by Aqualin. For any questions, technical assistance, or warranty claims, please contact the seller or manufacturer directly through your purchase platform. Keep your proof of purchase for any support inquiries.