



Manuals.plus /

› **TIMEMORE** /

› TIMEMORE Chestnut C2 MAX Manual Coffee Grinder User Manual

## TIMEMORE C2 MAX

# TIMEMORE Chestnut C2 MAX Manual Coffee Grinder User Manual

Model: C2 MAX

## INTRODUCTION

---

The TIMEMORE Chestnut C2 MAX Manual Coffee Grinder is designed for coffee enthusiasts seeking precision and portability. Featuring a durable CNC stainless steel conical burr, this grinder ensures consistent grind particles for various brewing methods. Its enlarged body can accommodate up to 30g of coffee beans, making it suitable for single servings or small batches. The grinder's design prioritizes ease of use, labor-saving operation, and simple maintenance, making it an excellent choice for home, office, or travel.



**SUS420**  
STAINLESS STEEL



**Easy to clean**



**No odor**

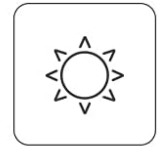

**No fever**

Image: The TIMEMORE Chestnut C2 MAX Manual Coffee Grinder, highlighting its SUS420 stainless steel burr and features like easy cleaning and no odor.

## PRODUCT COMPONENTS

- Grinder Body (Upper and Lower Sections)
- Hand Crank Handle
- Stainless Steel Conical Burr Set
- Grind Adjustment Dial
- Lid

# Steps For Usage



1 Pull out the container.



2

Set up coarseness by turning the scale at the bottom of the body and fasten Body with the container.

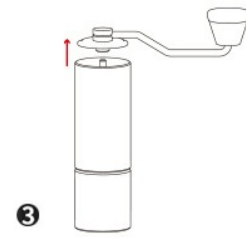

3

Fasten body with the container and open the lid.

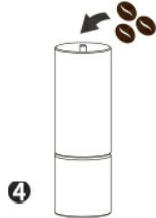

4

Pour the coffee beans from the top of grinder (less than 30g).

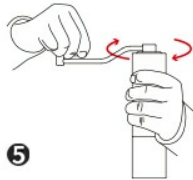

5

Hold the body and rotate the handle.



6

Pull out the container and pour the ground coffee after grind is finished.

Image: Detailed view of the grinder's internal components, including the conical burr and adjustment mechanism.

## SETUP AND ASSEMBLY

1. **Disassemble:** Gently pull out the bottom container from the main grinder body.
2. **Adjust Coarseness:** Locate the grind adjustment dial at the bottom of the main body. Turn the dial clockwise for a finer grind and counter-clockwise for a coarser grind. The grinder offers approximately 36 levels of adjustment.
3. **Reassemble:** Fasten the bottom container back onto the main body. Open the lid at the top of the grinder.

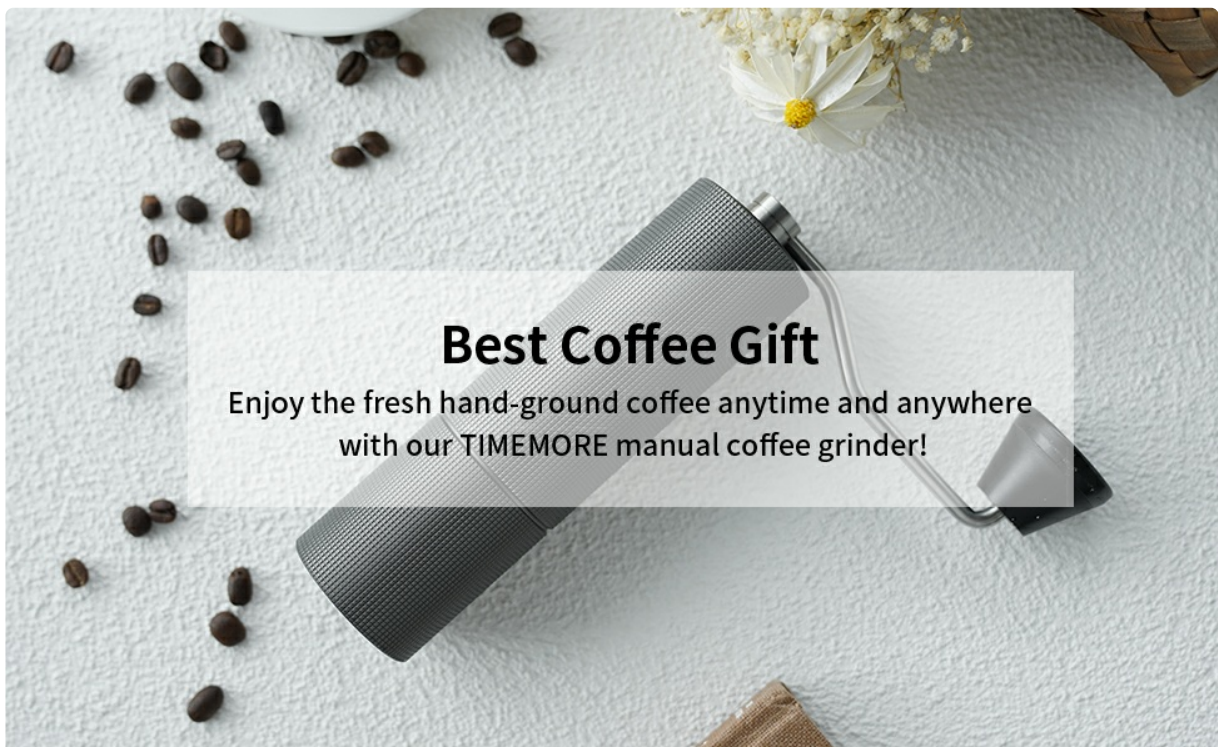

Image: A close-up view of the grind adjustment mechanism, showing the fine and coarse indicators.

Your browser does not support the video tag.

Video: This video demonstrates the assembly, grind adjustment, and grinding process of the TIMEMORE C2 MAX Manual Coffee Grinder, followed by a pour-over coffee preparation.

## OPERATING INSTRUCTIONS

1. **Load Beans:** Pour up to 30g of whole coffee beans into the top of the grinder.
2. **Attach Handle:** Place the hand crank handle onto the shaft at the top of the grinder.
3. **Grind:** Hold the grinder body firmly and rotate the handle clockwise to begin grinding. The built-in bearing ensures a smooth and labor-saving grinding experience.
4. **Collect Grounds:** Once grinding is complete, pull out the bottom container to access your freshly ground coffee.



Image: A visual guide illustrating the six steps for using the TIMEMORE Chestnut C2 MAX Manual Coffee Grinder, from disassembly to collecting grounds.

Your browser does not support the video tag.

Video: This official TIMEMORE video demonstrates the process of adjusting the grind size and manually grinding coffee beans with the C2 MAX grinder.

## MAINTENANCE AND CLEANING

To ensure the longevity and optimal performance of your TIMEMORE Chestnut C2 MAX grinder, regular cleaning is recommended. The grinder is designed for easy disassembly to facilitate cleaning.

- **Disassembly:** Separate the main body from the collection container. The internal burr assembly can be carefully removed for thorough cleaning.
- **Cleaning Method:** Use a brush (often included with the grinder) or an air blower to remove any residual coffee grounds from the burrs and internal components.
- **Important:** Do not wash the grinder with water. Water can cause rust and damage to the metal components, especially the burrs.

- **Reassembly:** Reassemble the components in reverse order, ensuring all parts are securely fitted.



No washing



Brush clean



Air blower clean

Image: A visual guide demonstrating recommended cleaning methods (brush, air blower) and explicitly advising against washing with water.

## TROUBLESHOOTING

- **Inconsistent Grind:** Ensure the grind adjustment dial is securely set and has not shifted during grinding. Check for any debris obstructing the burrs.
- **Difficulty Grinding:** If the grinder feels unusually stiff, check if the burrs are clogged with coffee oils or fine particles. Disassemble and clean thoroughly. Ensure the handle is properly attached.
- **Grinder Not Assembling Correctly:** Verify that all components are aligned properly and that no foreign objects are preventing full assembly.

## SPECIFICATIONS

| Feature                | Detail  |
|------------------------|---|
| Brand                  | TIMEMORE  |
| Model                  | Chestnut C2 MAX                                 |
| Color                  | White   |
| Material               | Aluminum, Stainless Steel (Burr)                |
| Item Weight            | 15.2 ounces (approx. 430g)                      |
| Capacity               | 30g Coffee Beans                                |
| Burr Type              | CNC Stainless Steel Conical Burr                |
| Grind Adjustment       | Approx. 36 levels                               |
| Dimensions (L x W x H) | 6.26"L x 2.05"W x 6.77"H (159mm x 52mm x 172mm) |

## WARRANTY AND SUPPORT

TIMEMORE is committed to providing quality products and customer satisfaction. If you have any questions regarding your Chestnut C2 MAX Manual Coffee Grinder, please refer to the included user manual for detailed information. For further assistance, TIMEMORE offers 24-hour customer service and a professional technology team ready to help. Please contact the seller or TIMEMORE directly for warranty

claims or technical support.