



Manuals.plus /

› COMOMY /

› COMOMY Auto Close Baby Gate with Cat Door (Model BG-01W) Instruction Manual

COMOMY BG-01W

COMOMY Auto Close Baby Gate with Cat Door (Model BG-01W)

Instruction Manual

1. INTRODUCTION

Thank you for choosing the COMOMY Auto Close Baby Gate with Cat Door. This manual provides essential information for the safe and correct installation, operation, and maintenance of your new gate. Please read all instructions carefully before assembly and use, and retain this manual for future reference.

This gate is designed to provide a secure barrier for children and pets in various home openings, including doorways and stairs. It features an auto-close mechanism, a double-locking system, and a convenient cat door.



Image 1.1: The COMOMY Auto Close Baby Gate with Cat Door in a home setting, separating a cat and a dog.

2. SAFETY INFORMATION

WARNING: Failure to follow these warnings and instructions could result in serious injury or death.

- Always install and use the gate as instructed.
- This safety barrier is for domestic use only.
- This safety barrier is suitable for use with children from 6 to 24 months.
- Never use this gate to keep a child from accessing a swimming pool.
- Regularly check that the safety barrier is correctly installed and secure.
- Do not use the safety barrier if any components are damaged or missing.
- The safety barrier must be fitted between rigid surfaces such as walls or door frames.
- For stairway installation, the gate MUST be hardware mounted. Contact customer support for special accessories if needed.
- Never climb over the gate.
- Do not allow children to swing on the gate.

- Keep children away from the gate during installation.
- The small pet door is designed for small pets only. Ensure children cannot pass through it.
- Always ensure the gate is securely latched after passing through.

3. PACKAGE CONTENTS

Please verify that all components are present before beginning installation:

- Main Gate Frame (with pre-installed zip tie)
- Extension Pieces (5.5" and 2.8" - quantity may vary based on chosen width)
- 4x Pressure Bolts
- 4x Wall Cups
- 4x Dry Wall Anchors (for hardware mounting)
- 4x Screws (for hardware mounting)
- 2x Y-Spindle Rods (for round/rhombic/square columns, optional)
- 1x Wrench
- Extra Retaining Ties (for re-installation if needed)

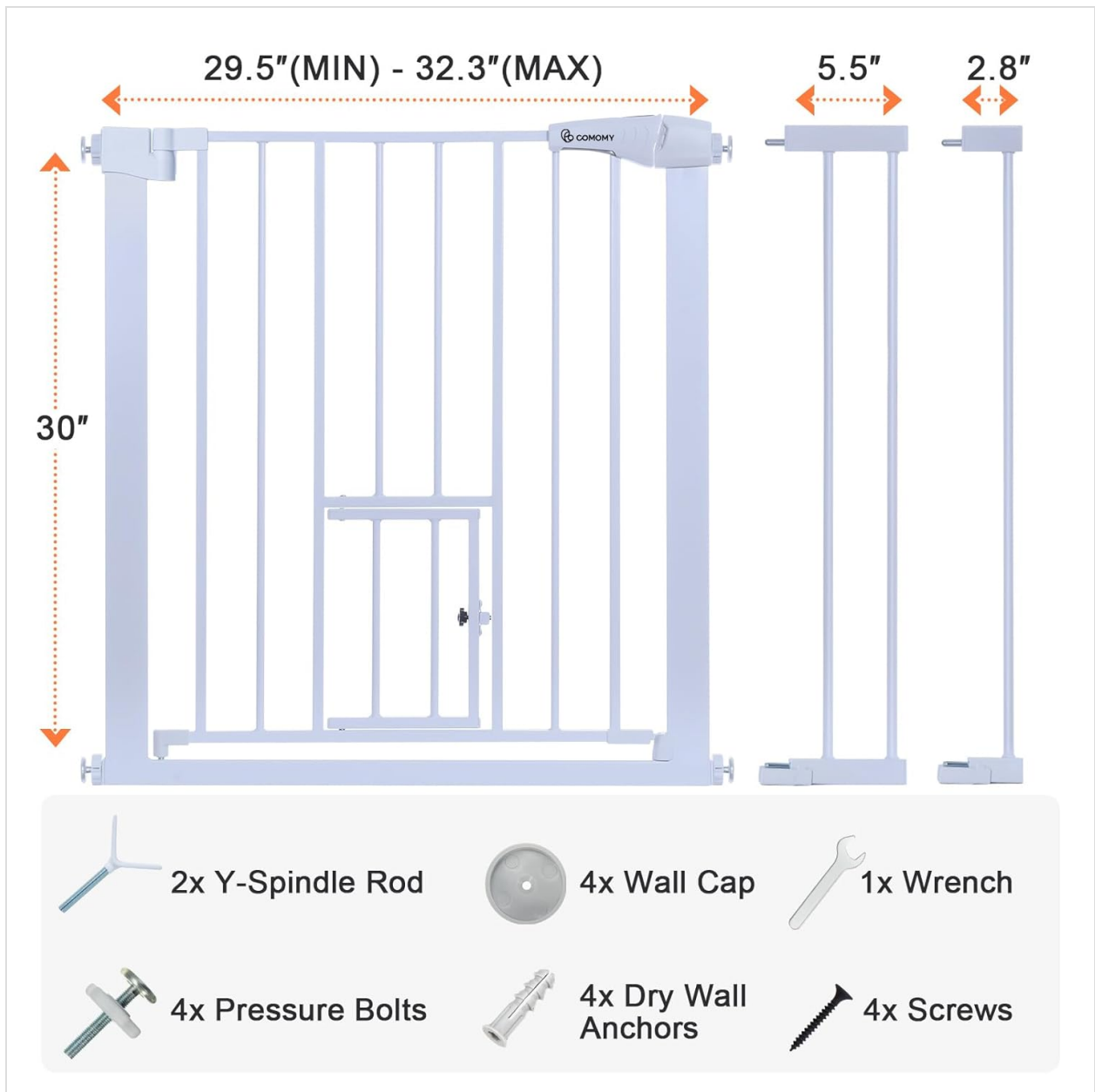

Image 3.1: Included components for the COMOMY Baby Gate.

4. PRODUCT DIMENSIONS AND FEATURES

4.1 Dimensions

- **Gate Height:** 30 inches (76 cm)
- **Adjustable Width:** Fits openings from 29.5 inches (75 cm) to 40.5 inches (103 cm)
- **Cat Door Dimensions:** Approximately 7.6 inches (19 cm) wide x 10.1 inches (25.6 cm) high

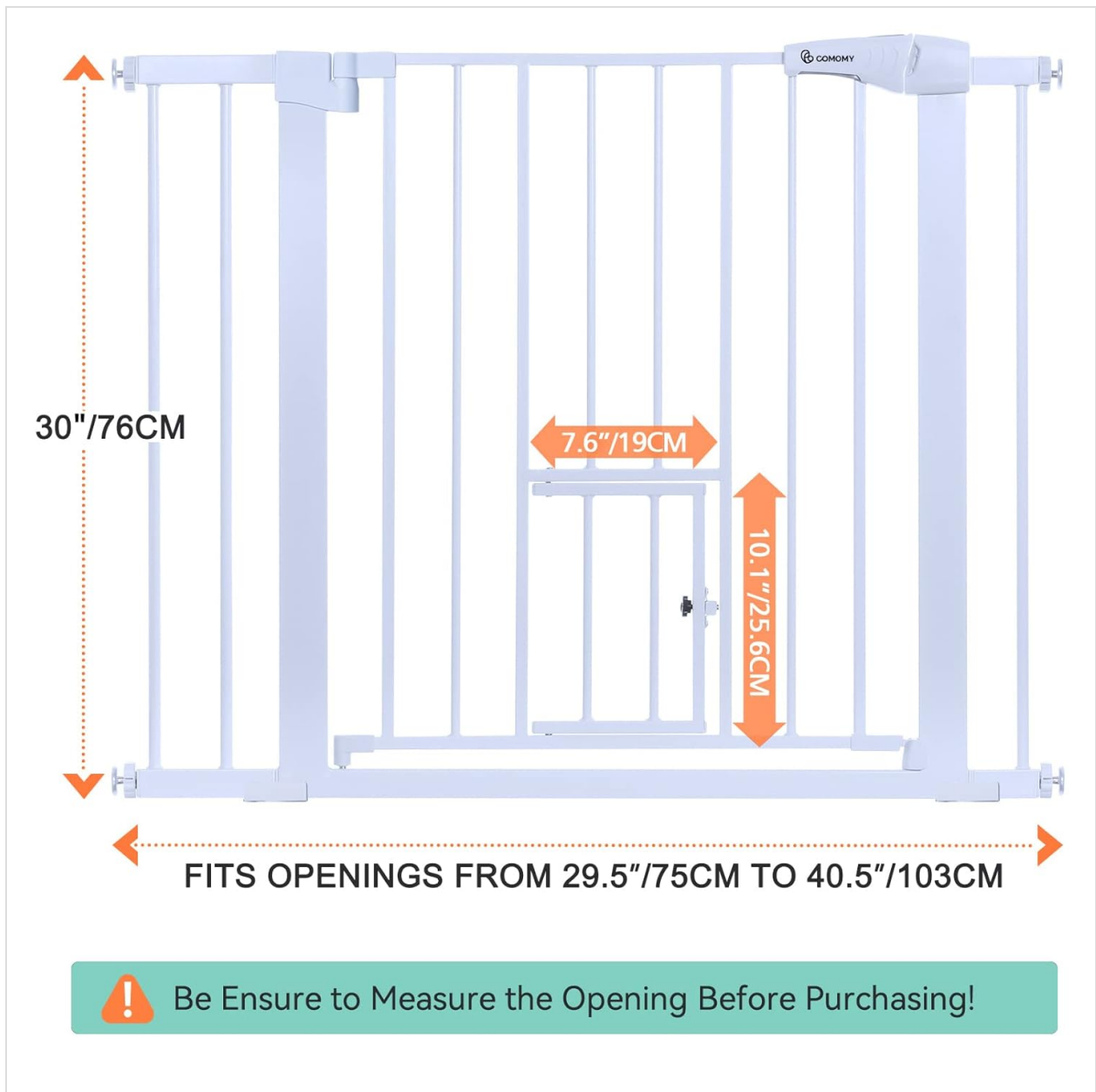

Image 4.1: Detailed dimensions of the COMOMY Baby Gate and its cat door.

4.2 Key Features

- **Auto-Close Function:** The gate automatically closes when opened less than 90 degrees.
- **Dual-Direction Opening:** Gate swings open in both directions (180 degrees).
- **Stay-Open Feature:** Gate remains open at a 90-degree angle for convenient passage.
- **Double-Locking System:** Provides enhanced security for children.
- **Integrated Cat Door:** Allows small pets to pass through while restricting larger animals or children. Includes a locking feature for the cat door.
- **Durable Construction:** Heavy-duty steel frame designed for stability.
- **Versatile Mounting:** Supports both pressure-mounted and hardware-mounted installations.



Image 4.2: The 40.5" safety gate featuring a dedicated door for small pets.

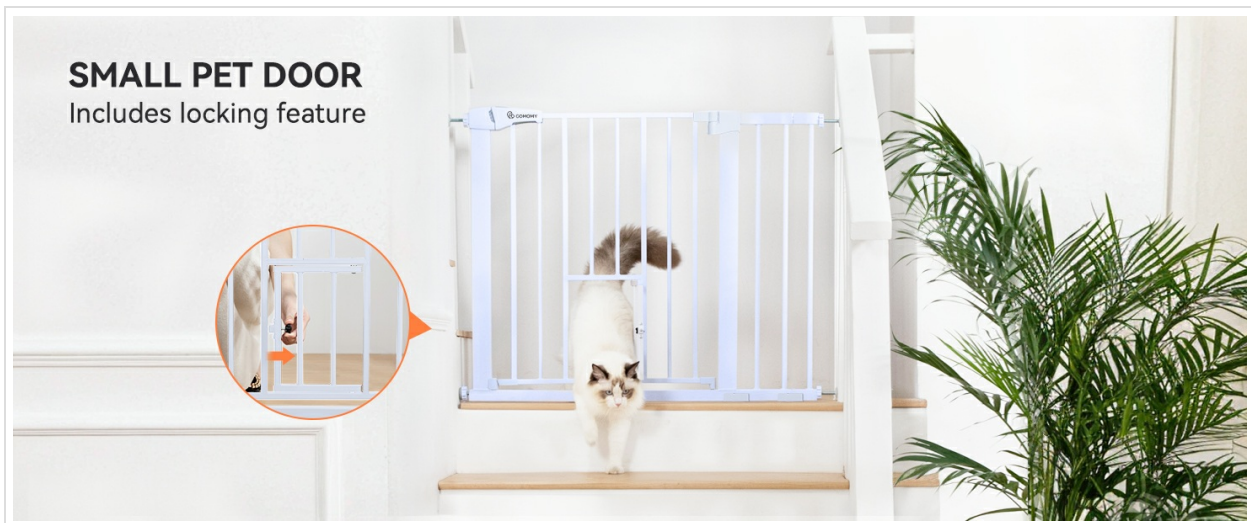

Image 4.3: The small pet door includes a locking feature for controlled access.

5. SETUP AND INSTALLATION

5.1 Before Installation

- **Measure Your Opening:** Before purchasing and installing, accurately measure the width of your doorway or stair opening. The gate fits openings from 29.5" to 40.5". Select appropriate extension pieces if your opening is wider than the main gate frame.
- **Initial Gap:** It is normal to observe a gap at the handle area of the gate before installation. This is not a defect and will close once the gate is properly installed and tightened.
- **DO NOT Cut the Retaining Tie:** The gate comes with a retaining tie (zip tie) holding the main frame together. DO NOT cut this tie until the installation is complete and the gate is securely mounted.



Image 5.1: Measure your opening carefully to ensure proper fit and select necessary extensions.

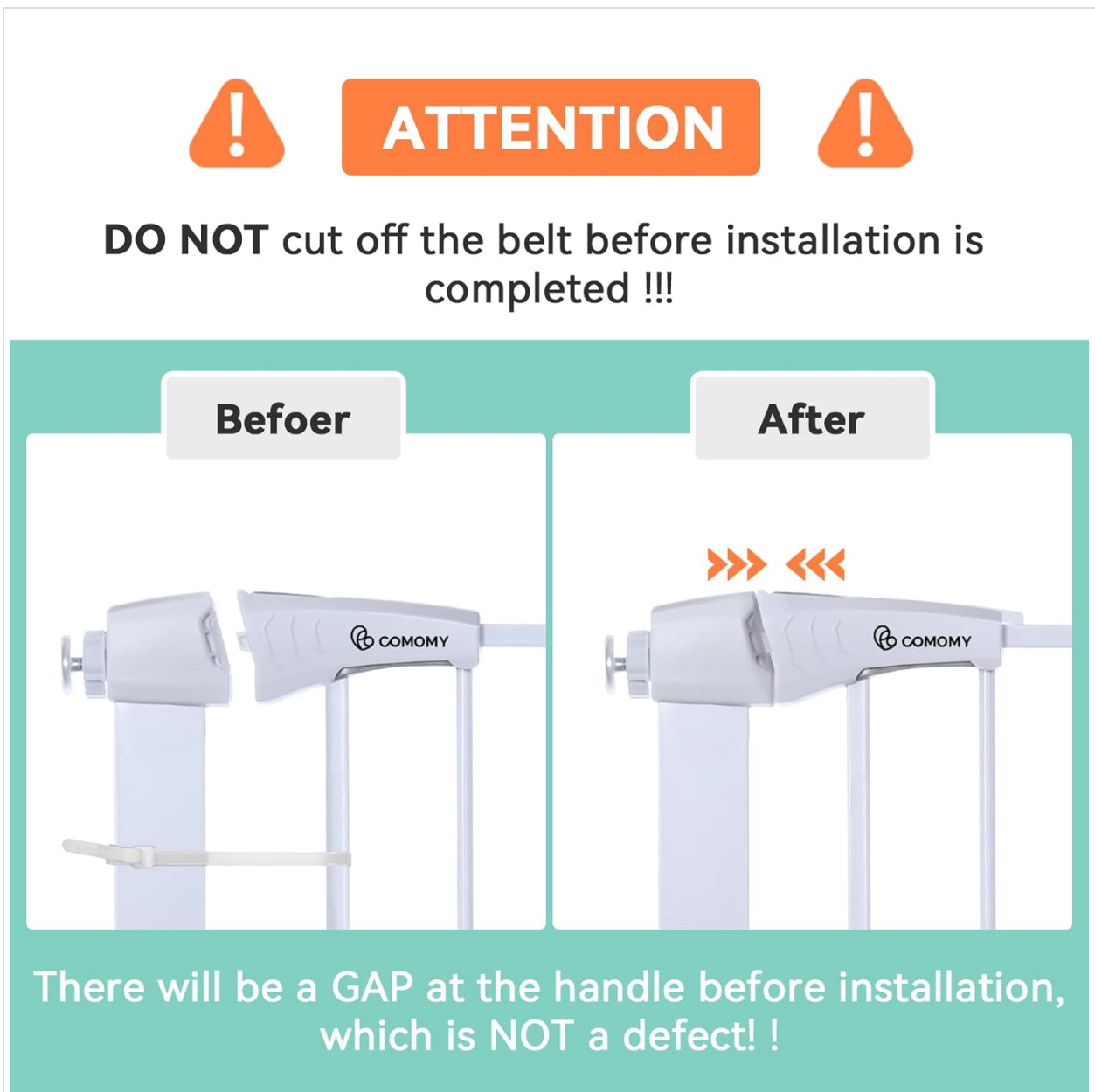

Image 5.2: Important warning regarding the retaining tie and the normal pre-installation gap.

5.2 Pressure Mounted Installation (Doorways, Hallways)

This method requires no drilling and is suitable for most standard openings.

1. Assemble the gate frame with any necessary extension pieces by sliding them into the main gate.
2. Insert the four pressure bolts into the holes at each corner of the gate frame.
3. Place the gate in the desired opening. Ensure the bottom bar is flush with the floor and the gate is centered.
4. Begin rotating the adjustment wheels on each pressure bolt to extend them until they make contact with the wall or door frame.
5. Continue tightening the pressure bolts evenly, alternating between all four corners, until the gate is firmly secured and the gap at the handle is closed. Use the provided wrench for extra leverage if needed.
6. Once the gate is stable and secure, cut and remove the retaining tie.
7. Test the gate's stability and ensure the locking mechanism functions correctly.

5.3 Hardware Mounted Installation (Stairs)

For installation at the top or bottom of stairs, hardware mounting is required for maximum safety.

1. Follow steps 1-3 from the pressure-mounted installation.
2. Mark the positions for the wall cups on the wall or banister where the pressure bolts will rest.
3. Drill pilot holes at the marked positions. If installing into drywall, insert the dry wall anchors.
4. Secure the wall cups to the wall/banister using the provided screws.
5. Place the gate so the pressure bolts align with the installed wall cups.
6. Tighten the pressure bolts evenly until the gate is firmly secured within the wall cups and the gap at the handle is closed.
7. Once the gate is stable and secure, cut and remove the retaining tie.
8. Test the gate's stability and ensure the locking mechanism functions correctly.



Image 5.3: Visual guide for pressure-mounted installation.

5.4 Using Y-Spindle Rods (Optional)

If installing the gate against round, rhombic, or square columns (e.g., stair banisters), replace two of the standard pressure bolts with the Y-spindle rods. These rods are designed to provide a secure fit around non-flat surfaces. Follow the same tightening procedure as with standard pressure bolts.

Y-Shape Pressure Bolt can be used in multiple handrails



Rhombic Column



Round Column



Square Column

Image 5.4: Y-Spindle Rods for various column types.

6. OPERATING INSTRUCTIONS

6.1 Opening the Main Gate

The gate features a double-locking system for enhanced safety. To open:

1. Press the button located on the top of the handle.
2. While holding the button, lift the gate handle slightly.
3. Pull or push the gate open in the desired direction.

Easy One-Hand Operation

Press the Button and Lift to Open,
Double Locking System.



Image 6.1: Easy one-hand operation of the main gate.

6.2 Auto-Close and Stay-Open Features

- **Auto-Close:** If the gate is opened less than 90 degrees, it will automatically swing shut and latch securely.
- **Stay-Open:** If the gate is opened to a full 90-degree angle, it will remain open, allowing for free passage. To close, simply push the gate gently until it swings past the 90-degree mark, and it will auto-close.

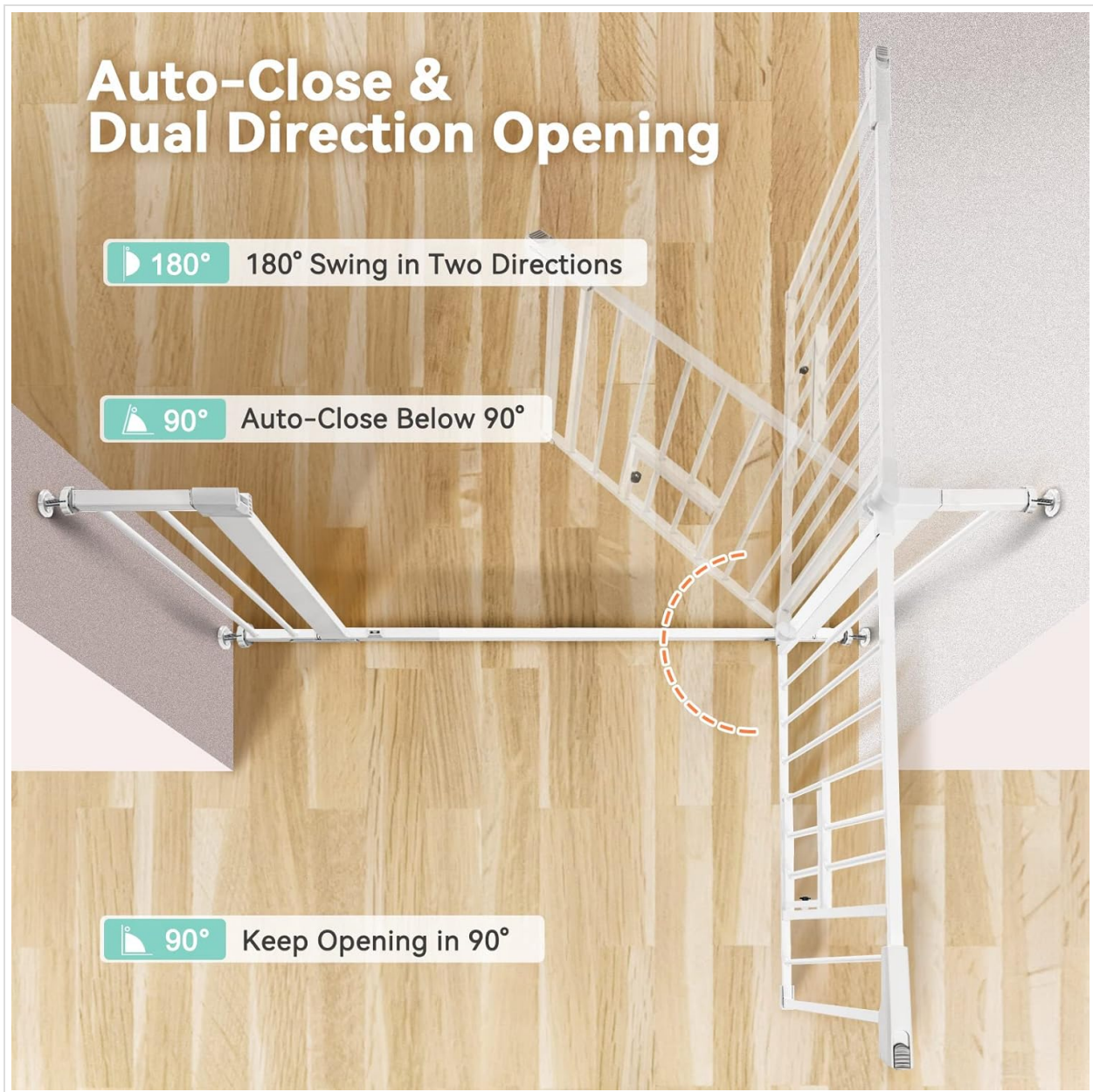

Image 6.2: Auto-close and 90-degree stay-open functionality.

6.3 Operating the Cat Door

The small cat door can be opened or closed as needed:

- To open, slide the small latch on the cat door upwards.
- To close and secure, slide the latch downwards until it clicks into place.

7. MAINTENANCE

Regular maintenance ensures the longevity and proper function of your gate.

- **Cleaning:** Wipe the gate regularly with a damp cloth and mild soap. Avoid abrasive cleaners or harsh chemicals, as these can damage the finish.
- **Inspection:** Periodically check all parts for wear, damage, or loose connections. Ensure all pressure bolts are tight and the gate remains securely mounted.
- **Lubrication:** If the gate hinges become stiff, apply a small amount of silicone-based lubricant to the hinge points.

- **Storage:** If storing the gate, ensure it is clean and dry. Store in a cool, dry place away from direct sunlight.

8. TROUBLESHOOTING

- **Gate does not close properly:** Ensure the gate is installed squarely in the opening and the pressure bolts are tightened evenly. The gap at the handle should be minimal or closed when properly installed.
- **Gate feels loose:** Re-tighten all four pressure bolts evenly until the gate is secure. If hardware mounted, check that the wall cups are firmly attached.
- **Gap at the handle before installation:** This is normal. The gap will close as the pressure bolts are tightened during installation. Do not cut the retaining tie until installation is complete.
- **Gate is difficult to open/close:** Check for any obstructions. Ensure the hinges are clean and consider applying a small amount of lubricant if needed.
- **Gate does not fit opening:** Double-check your measurements against the gate's adjustable width (29.5"-40.5"). Ensure you are using the correct combination of extension pieces.

9. SPECIFICATIONS

Brand	COMOMY
Model Number	BG-01W
Mounting Type	Pressure Mounted / Hardware Mounted
Material Type	Metal
Product Dimensions (Max)	40.5 inches (W) x 30 inches (H)
Item Weight	12.54 pounds (5.7 kg)
Color	White
UPC	810139100157

10. WARRANTY AND SUPPORT

For warranty information or technical support, please contact COMOMY customer service through the retailer where the product was purchased or visit the official COMOMY website. Please have your model number (BG-01W) and purchase date available when contacting support.