

Manuals+

[Q & A](#) | [Deep Search](#) | [Upload](#)

manuals.plus /

- › [Parblo](#) /
- › [Parblo Intangbo S Graphic Drawing Tablet User Manual](#)

Parblo Intangbo S

Parblo Intangbo S Graphic Drawing Tablet User Manual

This manual provides detailed instructions for the setup, operation, and maintenance of your Parblo Intangbo S Graphic Drawing Tablet.

1. PRODUCT OVERVIEW



Image: The Parblo Intangbo S Graphic Drawing Tablet in lilac purple, shown with its battery-free stylus and a container of replacement nibs.

The Parblo Intangbo S Graphic Drawing Tablet is designed for digital art, graphic design, and online teaching. It features a 7 x 4 inch active drawing area, 8192 levels of pressure sensitivity, and a battery-free stylus for a natural and responsive creative experience.

1.1. Package Contents

Verify that all items are present in your package:

- Parblo Intangbo S Graphic Drawing Tablet
- Battery-Free Stylus (P08)
- Pen Holder
- 8 Replacement Pen Nibs
- Nib Removal Tool
- USB-C Cable
- USB to Type-C Adapter
- USB to Micro USB Adapter
- Drawing Glove
- Cleaning Cloth
- Quick Start Guide
- Warranty Card



Image: The complete package contents, including the tablet, stylus, pen holder, replacement nibs, USB-C cable, USB adapters, drawing glove, cleaning cloth, quick start guide, and warranty card.

2. SETUP

2.1. Driver Installation

1. **Download Driver:** Visit the official Parblo website to download the latest driver for your operating system.
2. **Remove Other Drivers:** Before installing the Parblo driver, ensure all other tablet drivers are uninstalled from your computer to prevent conflicts.
3. **Install Driver:** Follow the on-screen instructions to install the Parblo driver.
4. **Restart Computer:** After installation, restart your computer to complete the setup.

2.2. Connecting the Tablet

The Parblo Intangbo S Graphic Drawing Tablet supports connection to computers (Windows/Mac) and Android devices.

2.2.1. Connecting to a Computer

Connect the tablet to your computer using the provided USB-C cable. Ensure the cable is securely plugged into both the tablet and a USB port on your computer.

2.2.2. Connecting to an Android Device

For Android devices, use the provided USB to Type-C or USB to Micro USB adapter (OTG connector) to connect the tablet via the USB-C cable. Ensure your Android device supports OTG functionality.

• How to Connect Drawing Tablet to Android?



• How to connect Drawing Tablet to Computer?

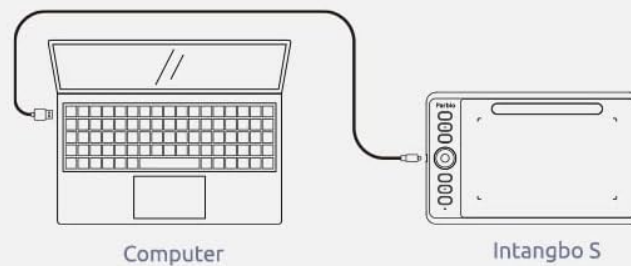

Easy to Set up!

STEP1: Download driver from Parblo website

STEP2: Move other tablet drivers from your computer and install Parblo driver

STEP3: Connect Parblo Tablet to your computer to complete settings

We provide 2x OTG connectors for Android users, which is very easy to use.

Image: A diagram illustrating the connection of the Parblo Intangbo S tablet to a computer via USB, and to Android phones/tablets using an OTG adapter.

3. OPERATING THE TABLET

3.1. Stylus Usage (P08 Battery-Free Pen)

The P08 stylus is battery-free, eliminating the need for charging. It features 8192 levels of pressure sensitivity and $\pm 60^\circ$ tilt function for a natural drawing experience.

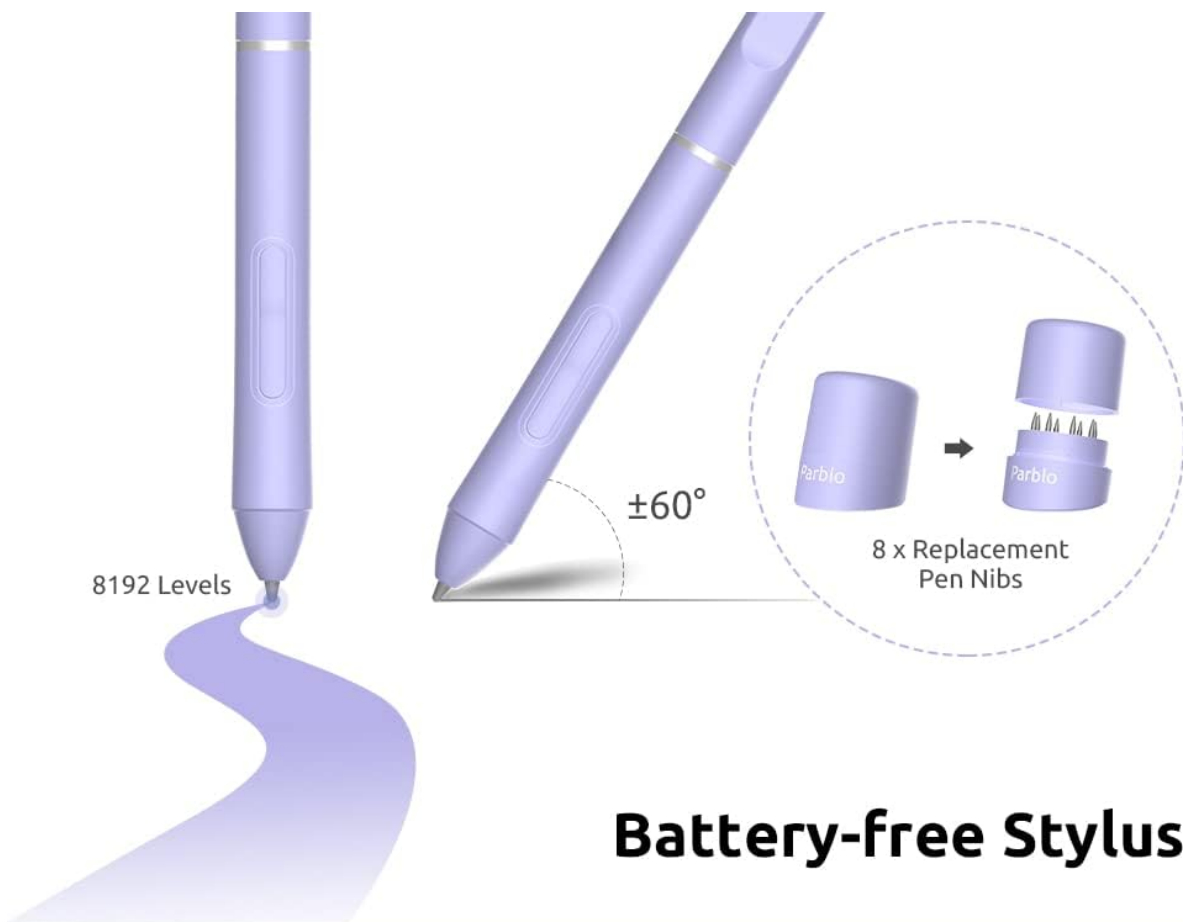

Image: The battery-free stylus, highlighting its 8192 pressure sensitivity levels, $\pm 60^\circ$ tilt function, and the included 8 replacement pen nibs with a removal tool.

To replace a nib, use the nib removal tool to gently pull out the old nib, then insert a new one firmly.

3.2. Customizable Express Keys and Dial Ring

The tablet features 6 customizable express keys and 1 dial ring. These can be programmed through the driver software to perform various functions, such as zoom, undo, brush size adjustment, or canvas rotation.

6 Customizable Express Keys and 1 Round Key

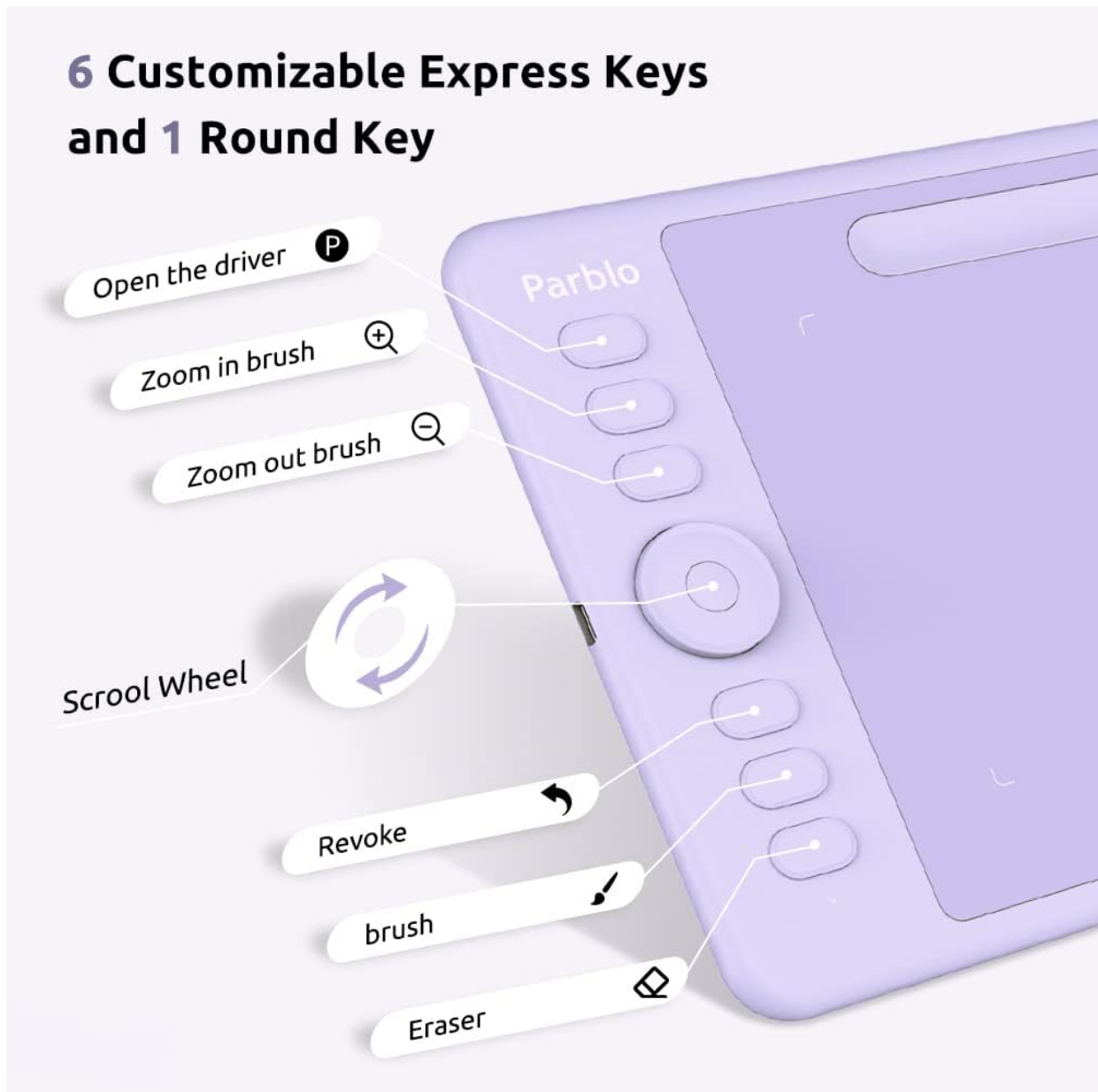

Image: A visual representation of the tablet's 6 customizable express keys and the central dial ring, with examples of functions like opening the driver, zoom in/out, scroll wheel, revoke, brush, and eraser.

The ergonomic design and ability to rotate the tablet (90°, 180°, or 270°) accommodate both left and right-handed users and various working preferences.

3.3. Software Compatibility

The Parblo Intangbo S Graphic Drawing Tablet is compatible with major graphics software, including but not limited to:

- Adobe Photoshop
- Adobe Illustrator
- Corel Painter
- Manga Studio
- Clip Studio Paint
- ZBrush
- SAI

Drawing Software

Photoshop, Illustrator, Corel Painter, Manga Studio, Clip Studio, Zbrush and More



Image: A collage of logos for popular drawing and design software, such as Photoshop, Illustrator, CorelDRAW, Clip Studio Paint, and others, demonstrating the tablet's wide compatibility.

3.4. Multi-Device Compatibility

The tablet supports Windows 7/8/10, Mac OS 10.11-10.15, and Android devices 6.0 or above.

Multi-device Compatibility

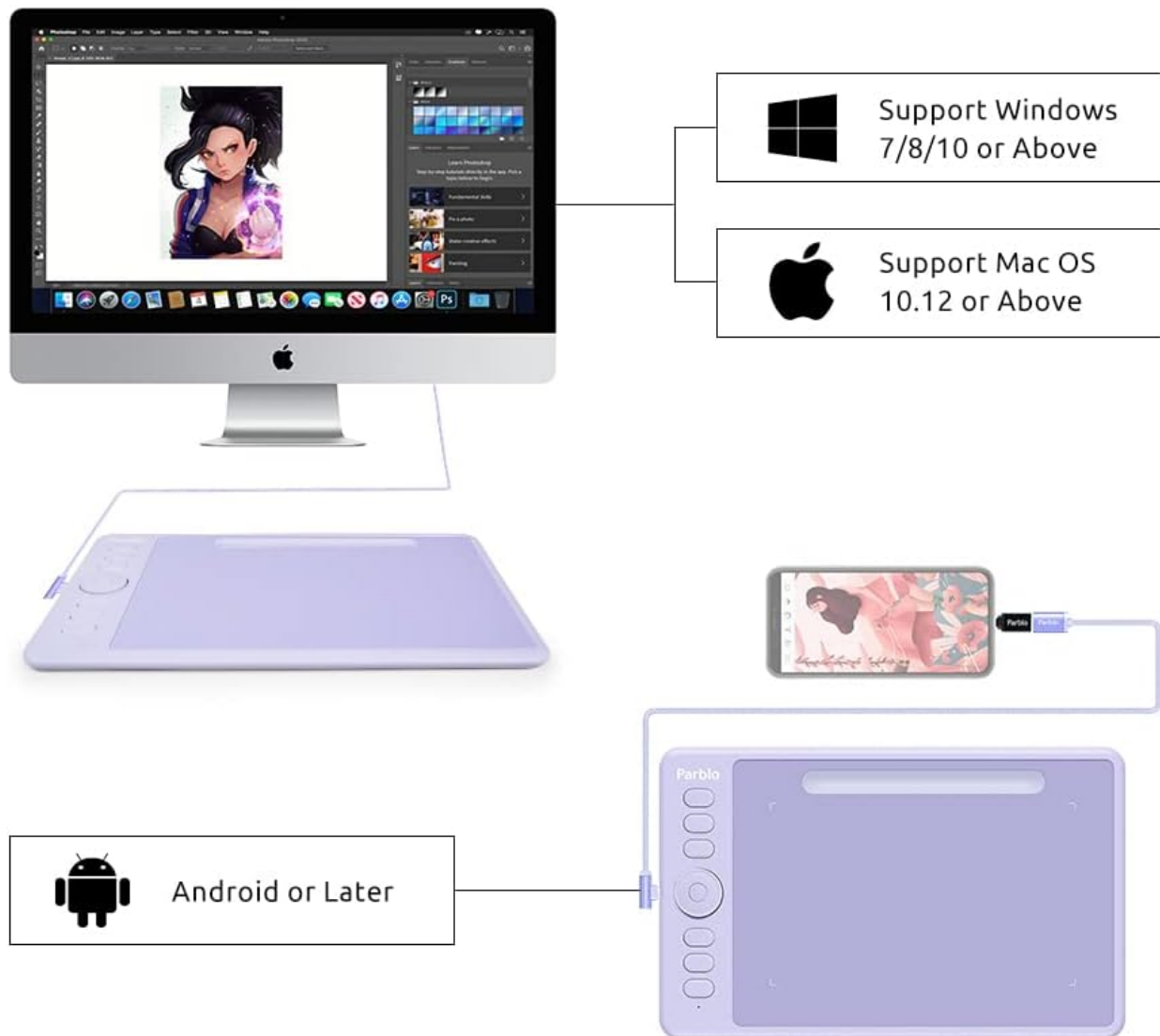

Image: A diagram illustrating the Parblo tablet's compatibility with different operating systems, showing connections to a Mac desktop and an Android smartphone.

3.5. Video Demonstration

Watch this video for a demonstration of the Parblo Intangbo M Drawing Tablet's features and usage.

Your browser does not support the video tag.

Video: An official product video from Parblo (Kuayee) demonstrating the features and functionality of the Parblo Intangbo M Drawing Tablet, including its design and how it can be used for various creative tasks.

4. MAINTENANCE

Proper maintenance ensures the longevity and optimal performance of your Parblo Intangbo S Graphic Drawing Tablet.

- **Cleaning:** Use the provided cleaning cloth or a soft, dry cloth to wipe the tablet surface and stylus. Avoid abrasive cleaners or solvents.
- **Storage:** Store the tablet in a dry, dust-free environment when not in use. Avoid extreme temperatures.
- **Stylus Nibs:** Regularly check the stylus nib for wear. Replace worn-out nibs promptly using the provided nib removal tool and spare nibs.

- **Cable Care:** Handle the USB-C cable and adapters carefully. Avoid bending or twisting them excessively to prevent damage.

5. TROUBLESHOOTING

If you encounter issues with your Parblo Intangbo S Graphic Drawing Tablet, refer to the following common solutions:

| Problem | Possible Solution |
|--|--|
| Tablet not responding / Pen not drawing | <ul style="list-style-type: none">• Ensure the USB-C cable is securely connected to both the tablet and your computer/Android device.• Verify that the tablet driver is correctly installed. Uninstall any conflicting tablet drivers and reinstall the Parblo driver.• Restart your computer.• Test the tablet on a different USB port or computer.• Check if the stylus nib is worn out and replace it if necessary. |
| Pressure sensitivity not working | <ul style="list-style-type: none">• Ensure the driver is installed and functioning correctly. Check the driver settings for pressure sensitivity options.• Verify that the drawing software you are using supports pressure sensitivity and that it is enabled in the software's settings.• Restart the drawing software or your computer. |
| Express keys or dial ring not functioning | <ul style="list-style-type: none">• Open the Parblo driver software and check if the keys and dial ring are properly configured.• Ensure the driver is running in the background.• Restart your computer. |
| Tablet not recognized by Android device | <ul style="list-style-type: none">• Ensure your Android device supports OTG (On-The-Go) functionality.• Use the correct OTG adapter (USB to Type-C or USB to Micro USB).• Try a different OTG adapter or USB cable.• Some Android devices may require enabling OTG in their settings. |

6. SPECIFICATIONS

| Feature | Detail |
|--------------------------------|---------------------|
| Product Dimensions | 7 x 7 x 0.04 inches |
| Item Weight | 1.79 pounds |
| Active Area | 7 x 4 inches |
| Connectivity Technology | USB |

| Feature | Detail |
|--------------------------------|--|
| Pressure Sensitivity | 8192 Levels |
| Pen Resolution | 5080 LPI |
| Tilt Function | ±60° |
| Operating System Compatibility | Windows 7/8/10, Mac OS 10.11-10.15, Android 6.0 or above |
| Stylus Type | Battery-Free (P08) |
| Customizable Keys | 6 Express Keys + 1 Dial Ring |

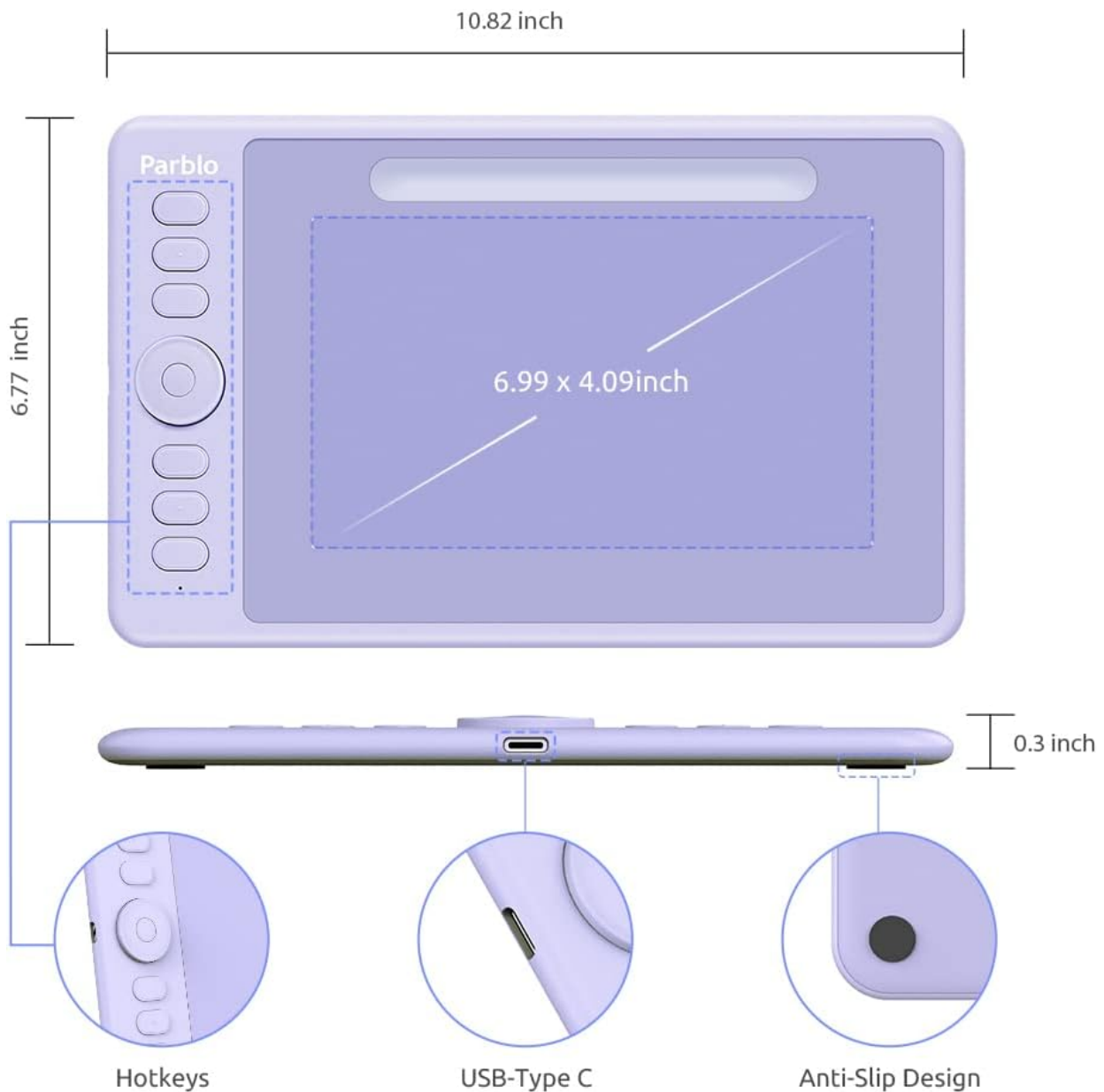

Image: A technical diagram displaying the overall dimensions of the tablet (10.82 inches x 6.77 inches x 0.3 inches) and highlighting features like hotkeys, USB-Type C port, and anti-slip design.

7. WARRANTY AND SUPPORT







For warranty information and technical support, please refer to the Warranty Card included in your package or visit the official Parblo website. You can also contact Parblo customer service for assistance with product registration, troubleshooting, and service requests.

Online Resources:

- Official Parblo Website: [www.parblo.com](#) (Note: This is a placeholder URL, please refer to your product documentation for the exact website.)
- Customer Support Email: support@parblo.com (Note: This is a placeholder email, please refer to your product documentation for the exact contact information.)

© 2023 Parblo. All rights reserved.

Related Documents - Intangbo S

| | |
|---|--|
|  | <p>Parblo Intangbo Drawing Tablet - Quick Start Guide</p> <p>Get started quickly with the Parblo Intangbo drawing tablet. This guide covers overview, package contents, connection methods, precautions, driver installation, and client support for Windows and Mac.</p> |
|  | <p>Parblo Intangbo Quick Start Guide - Setup, Connection, and Driver Installation</p> <p>Comprehensive quick start guide for the Parblo Intangbo graphic drawing tablet, detailing setup, connection methods for computers and Android devices, driver installation for Windows and Mac, and customer support resources.</p> |
|  | <p>Parblo Coast12 Pro Graphic Drawing Monitor User Manual</p> <p>Comprehensive user manual for the Parblo Coast12 Pro graphic drawing monitor, detailing setup, connection methods, driver installation for Windows and Mac, driver functions including pen settings, pressure adjustment, coordinate modes, area settings, key and rotation customization, configuration management, and troubleshooting.</p> |
|  | <p>Intangbo X7 Graphics Tablet User Manual Parblo</p> <p>User manual for the Intangbo X7 graphics tablet by Parblo, detailing setup, connection methods for various devices, driver installation, software usage, and troubleshooting.</p> |
|  | <p>Parblo A640 V2 Graphics Tablet User Manual</p> <p>Comprehensive user manual for the Parblo A640 V2 graphics tablet, detailing setup, features, usage, and troubleshooting for digital artists.</p> |
|  | <p>Parblo A610Pro Graphics Tablet User Manual</p> <p>Comprehensive user manual for the Parblo A610Pro Graphics Tablet, covering setup, driver installation, customization, and troubleshooting for digital artists and designers.</p> |

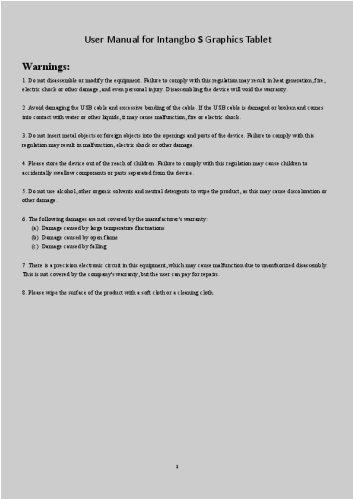

[pdf] User Manual Warranty

Administrator User Manual for Intangbo S Graphics Tablet WarningsHow to Connect the Your Computer

The tablet supports connection with a computer and an Android device factory default is C1nkm6aCFjSm media amazon images I C1nkm6aCFjS |||

User Manual for **Intangbo S** Graphics Tablet Warnings: 1. Do not disassemble or modify the equipment. Failure to comply with this regulation may result in heat generation, fire, electric shock or other damage, and even personal injury. Disassembling the device will void the warranty. 2 .Avoid damaging...
lang:en score:45 filesize: 5.25 M page_count: 52 document date: 2021-09-09

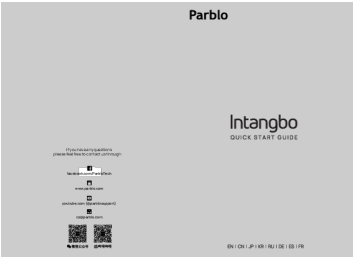

Parblo Intangbo Drawing Tablet - Quick Start Guide

Get started quickly with the Parblo Intangbo drawing tablet. This guide covers overview, package contents, connection methods, precautions, driver installation, and client support for Windows and Mac.
lang:i-klnglon score:27 filesize: 11.48 M page_count: 18 document date: 2025-10-13