

Vesta Atlanta 30SS

Vesta Augusta 30-Inch Under Cabinet Range Hood User Manual

Model: Atlanta 30SS

INTRODUCTION

Thank you for choosing the Vesta Augusta 30-inch Under Cabinet Range Hood. This manual provides essential information for the safe installation, operation, and maintenance of your new appliance. Please read these instructions thoroughly before installation and use, and retain them for future reference.

SAFETY INFORMATION

To reduce the risk of fire, electric shock, or injury, observe the following:

- Install this range hood in accordance with all specified instructions.
- Ensure the electrical supply matches the voltage rating on the range hood.
- Always disconnect power before servicing or cleaning the unit.
- This unit is intended for residential use only.
- Do not operate any fan with a damaged cord or plug. Discard fan or return to an authorized service facility for examination and/or repair.
- Never leave surface units unattended at high settings. Boilovers cause smoking and greasy spillovers that may ignite.
- Clean grease filters frequently. Grease should not be allowed to accumulate on fan or filter.
- Use appropriate ductwork and ensure proper venting to the outside.

PRODUCT OVERVIEW

The Vesta Augusta range hood is designed to efficiently remove smoke, grease, and odors from your kitchen.

It features durable stainless steel construction and user-friendly mechanical controls.

Key Features:

- **Powerful Suction:** Up to 850 CFM at the highest speed. Selectable levels include 490 CFM (Level 1), 670 CFM (Level 2), and 850 CFM (Level 3).
- **Mechanical Buttons:** Five easy-to-operate mechanical buttons for speed control and lighting.
- **Easy to Clean:** Equipped with two baffle filters and one oil tray for simplified maintenance. Filters are dishwasher safe.
- **Ventilation:** Features a 6-inch round top vent outlet, compatible with most standard kitchen pipes.
- **LED Lighting:** Integrated LED lights illuminate your cooking area.
- **Quiet Operation:** Operates at approximately 60 decibels at its highest speed.

Components:

- Range Hood Unit
- Baffle Filters (2 pieces)
- Oil Tray (1 piece)
- User Manual
- Installation Hardware



Figure 1: Front view of the Vesta Augusta 30-inch Under Cabinet Range Hood.



Figure 2: Angled view of the range hood, highlighting the control panel and baffle filters.



Figure 3: Detailed view of the mechanical control buttons for fan speed and lighting.



65 DB At Highest Speed 

When operating at highest speed, the machine's loudness is at 65 db which is roughly the level of your bathroom fan. Who says cooking is boring? Enjoy your favorite music or broadcast while you make your delicious food



Figure 4: Comparison illustrating the efficiency and durability of Vesta baffle filters.

SETUP AND INSTALLATION

This range hood is designed for under cabinet mounting and requires a 6-inch round top vent outlet for exhaust. Professional installation is recommended.

Pre-Installation Checklist:

- Verify that the cabinet space is adequate for the 29.7-inch width and 20-inch depth of the unit.
- Ensure a 6-inch round duct opening is available or can be created in the cabinet above the installation area.
- Confirm that the electrical supply (110 Volts) is accessible and meets local codes.
- Gather necessary tools: drill, screwdriver, measuring tape, level, duct tape, safety glasses, gloves.

Installation Steps:

1. **Prepare the Cabinet:** Measure and mark the location for the range hood. Cut out the necessary opening

for the 6-inch round top vent and the electrical wiring access.

2. **Mount the Hood:** Secure the range hood to the underside of the cabinet using the provided mounting hardware. Ensure the unit is level and firmly attached.
3. **Connect Ductwork:** Attach the 6-inch round duct to the range hood's top vent outlet. Seal all duct connections with appropriate duct tape to prevent air leaks.
4. **Electrical Connection:** Connect the range hood to the household electrical supply. Ensure all connections are secure and comply with local electrical codes.
5. **Install Filters and Oil Tray:** Insert the baffle filters and the oil tray into their designated slots.



Figure 5: Top view of the range hood, illustrating the 6-inch round vent outlet.

DISHWASHER FRIENDLY
Reusable Baffle Filters

A composite image illustrating the installation of reusable baffle filters. On the left is a photograph of an open dishwasher with its racks pulled out. On the right is a blue line-art diagram. The diagram shows a top-down view of the dishwasher's filter area, with arrows pointing to a mesh filter tray. Below this, two individual baffle filters are shown, and an arrow points to a final view of the filters installed in the dishwasher's filter compartment.



DISHWASHER FRIENDLY
Reusable Baffle Filters

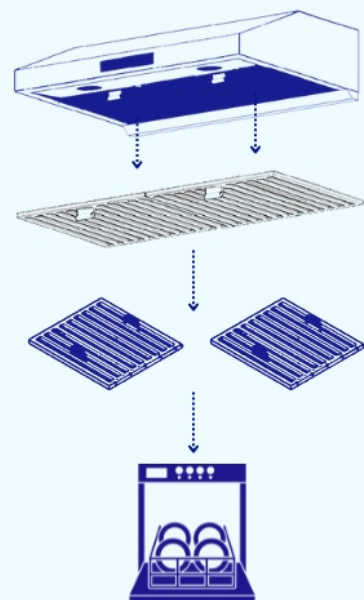

OPERATING INSTRUCTIONS

The Vesta Augusta range hood features intuitive mechanical buttons for easy control.

Fan Operation:

- **Power Button:** Press to turn the fan on or off.
- **Speed Selection:** Use the speed buttons to cycle through the three fan speeds:
 - **Level 1 (Low):** 490 CFM, suitable for light cooking.
 - **Level 2 (Medium):** 670 CFM, for moderate cooking.
 - **Level 3 (High):** 850 CFM, for heavy cooking or strong odors.
- **Auto Fan Shut-Off:** This feature automatically turns off the fan after a set period (refer to the control panel for specific timer settings).

Lighting Operation:

- **Light Button:** Press to turn the LED lights on or off.
-

MAINTENANCE

Regular maintenance ensures optimal performance and longevity of your range hood.

Cleaning Baffle Filters:

The baffle filters should be cleaned regularly, approximately every 6 months, or more frequently depending on cooking habits. The filter wash indicator will alert you when cleaning is due.

1. Turn off the range hood and disconnect power.
2. Remove the baffle filters by pulling the release latches.
3. Place the filters in a dishwasher for cleaning or wash them by hand with hot, soapy water.
4. Allow filters to dry completely before re-installing.

Long Stainless Steel Oil Tray

Excessive Oil Catcher



Figure 7: Baffle filters are dishwasher friendly for easy cleaning.

Cleaning the Oil Tray:

The built-in oil collector (oil tray) catches excessive oil and should be emptied and cleaned regularly.

1. Turn off the range hood and disconnect power.
2. Carefully slide out the oil tray from its position.
3. Empty the collected oil and wash the tray with hot, soapy water.
4. Dry thoroughly and re-insert the oil tray.



Vesta Simple Kitchen Solutions
UNDER CABINET RANGE HOOD



3-speed Settings



850 CFM



Reusable Baffle Filters



Classic Button Control



65 DB Quiet-level



Double Motors
Double Clean - Oil Tray

Figure 8: The long stainless steel oil tray collects excess grease.

Exterior Cleaning:

Wipe the exterior stainless steel surfaces with a soft cloth and a non-abrasive stainless steel cleaner. Avoid harsh chemicals or abrasive pads.

TROUBLESHOOTING

Refer to the following table for common issues and their solutions.

Problem	Possible Cause	Solution
Fan does not turn on	No power supply; Fan switch off; Motor malfunction	Check circuit breaker/fuse; Ensure power cord is plugged in; Press power button; Contact customer support if motor is faulty.
Poor suction	Clogged filters; Restricted ductwork; Incorrect fan speed	Clean or replace baffle filters; Check ductwork for obstructions or kinks; Select a higher fan speed.
Excessive noise	Loose parts; Improper installation; Motor issue	Check for loose screws or components; Ensure proper installation; Contact customer support if motor is noisy.
Lights not working	Bulb failure; Loose connection; Light switch off	Check if LED lights are properly seated; Ensure light button is pressed; Contact customer support for replacement if needed.

SPECIFICATIONS

Feature	Specification
Brand	Vesta
Model Number	Atlanta 30SS
Product Dimensions (D x W x H)	20" x 29.7" x 6.2"
Color	Stainless Steel
Air Flow Capacity	850 Cubic Feet Per Minute (CFM)
Noise Level	60 Decibels (at highest speed)
Mounting Type	Under Cabinet Mount
Controls Type	Push Button (Mechanical)
Voltage	110 Volts

Feature	Specification
Number of Speeds	3 selectable levels (technical specification lists 6 speeds)
Light Source	LED
Wattage	80 watts
Filter Type	Baffle
Ventilation Type	Exhaust
Special Features	Auto Fan Shut-Off, Built-In Oil Collector, Filter Wash Indicator, LED Lighting, Timer
Included Components	Baffle Filters, Oil Tray
Certification	cETL

WARRANTY AND SUPPORT

The Vesta Augusta range hood comes with the following warranty:

- **Limited Factory Warranty:** One (1) year from the date of purchase.
- **Motor Warranty:** Lifetime limited warranty on the motor.

For warranty claims, technical assistance, or replacement parts, please contact Vesta customer support. Ensure you have your model number (Atlanta 30SS) and proof of purchase available.

Contact Information: Please refer to the Vesta official website or your purchase documentation for the most current customer support contact details.
