

[Manuals.plus](#) /

> [Miele](#) /

> Miele CM 5510 Silence Automatic Coffee Machine - User Manual

Miele CM 5510 Silence

Miele CM 5510 Silence Automatic Coffee Machine - User Manual

Model: CM 5510 Silence AluSilver Metallic Finish

PRODUCT OVERVIEW

The Miele CM 5510 Silence Automatic Coffee Machine is designed to deliver a premium coffee experience with ease and efficiency. Featuring the AromaticSystem for intense coffee aroma, OneTouch for Two preparation for simultaneous brewing, and customizable connoisseur profiles, this machine caters to individual preferences. Its quiet conical grinder and convenient cleaning programs ensure a seamless and enjoyable operation.



Miele

Willkommen

^ OK

v ↶



Miele

Figure 1: Front view of the Miele CM 5510 Silence Automatic Coffee Machine in AluSilver Metallic Finish.

SETUP AND INITIAL USE

Before first use, ensure all packaging materials are removed. Place the machine on a stable, level surface. Fill the water tank and bean container as described below.

1. Water Tank

The water tank is located on the left side of the machine. Open the lid, remove the tank, fill it with fresh water, and reinsert it securely. The water tank has a capacity of 1.3 liters.



Figure 2: Side view illustrating the location of the water tank and overall dimensions.

2. Bean Container

The bean container is located at the top rear of the machine. Open the lid and fill with whole coffee beans. The bean container has a capacity of 7 oz. It is recommended to use non-flavored beans to prevent damage to the grinder.



Figure 3: Detailed view of the coffee bean container and grinder mechanism.

The machine also features a separate drawer for ground coffee, allowing for single servings of pre-ground coffee.

OPERATING INSTRUCTIONS

The Miele CM 5510 Silence offers a variety of beverage options and customizable settings for your perfect cup.

1. Selecting a Beverage

Use the DirectSensor display and touch controls to navigate through the menu. You can select from Ristretto, Espresso, Coffee,

Long coffee, Cappuccino, Latte Macchiato, Hot milk, Milk froth, Caffè Latte, and Hot water. The machine also has a coffee pot function to prepare up to 8 cups at a time (coffee pot sold separately).



Figure 4: The intuitive DirectSensor control panel for beverage selection.

2. OneTouch for Two

This feature allows you to prepare two servings of any specialty drink simultaneously with a single touch of a button.



Figure 5: The OneTouch for Two function in action, brewing two beverages.

3. Milk Frothing

The integrated milk frother automatically prepares creamy milk froth for cappuccinos, lattes, and other milk-based beverages. Simply connect the milk pipework to a container of milk.

Your browser does not support the video tag.

Video 1: Demonstration of the Miele CM 5510 Silence Automatic Coffee Maker & Espresso Machine, including milk frothing capabilities.

4. Individual Profile Settings

The machine allows you to save your favorite drink settings in one of two connoisseur profiles. This includes grind level, water temperature, amount of coffee, water, milk, milk froth, pre-brew settings, and more.

MAINTENANCE AND CLEANING

Regular cleaning ensures optimal performance and longevity of your Miele coffee machine. The machine features convenient cleaning programs and easily removable components.

1. Automatic Rinsing Functions

The machine performs automatic rinsing of the milk line with water from the water container. This helps maintain hygiene and prevents blockages.



Figure 6: The automatic rinsing function for the milk pipework.

2. Removable Brew Unit

The brew unit is easily removable for manual cleaning. Rinse it under running water weekly to prevent mold and ensure fresh coffee.

Your browser does not support the video tag.

Video 2: Guide on easy brew unit removal for cleaning.

3. Drip Tray and Coffee Grounds Container

The drip tray and coffee grounds container are easily accessible and should be emptied regularly. The machine will notify you when the drip tray needs emptying. Both are designed for ComfortClean, meaning they are dishwasher-safe.

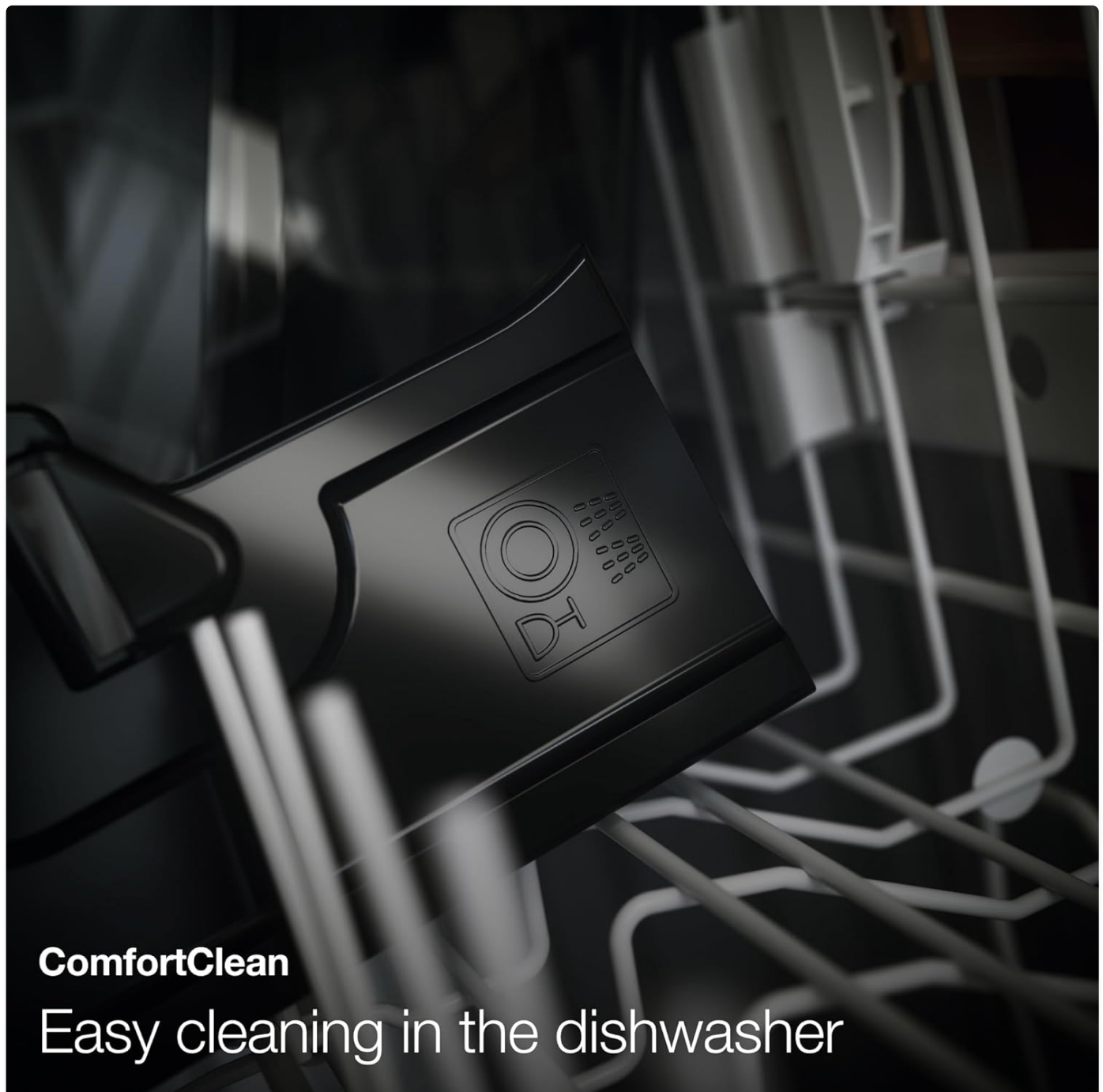

Figure 7: ComfortClean feature, showing the drip tray being placed in a dishwasher.

4. Descaling

The machine features manual descaling. Follow the on-screen prompts for the descaling process. Descaling tablets are included with the machine.

The programmable water hardness setting helps optimize descaling intervals.

TROUBLESHOOTING

If you encounter issues with your Miele CM 5510 Silence, refer to the common solutions below. For persistent problems, consult the full user manual or Miele support.

- **Milk Frother Sputtering:** Ensure the milk pipework is clean and properly connected. Use fresh, cold milk. If using

alternative milks, note that some may not froth as effectively as dairy milk.

- **"Empty Drip Tray" Message:** This indicates the drip tray is full. Remove, empty, and clean the drip tray and coffee grounds container.
- **No Coffee Dispensing:** Check if the water tank is filled and correctly inserted. Ensure the bean container has enough beans or that ground coffee is properly loaded if using that option. Verify the brew unit is correctly seated.
- **Machine Not Turning On:** Check if the power cord is securely plugged into a working outlet.

SPECIFICATIONS

Feature	Detail
Brand	Miele
Model Name	CM 5510 Silence
Model Number	11861030
Color	AluSilver Metallic Finish
Product Dimensions	9.5"D x 18.1"W x 14.2"H
Item Weight	21 pounds
Water Tank Capacity	1.3 liters
Bean Container Capacity	7 oz
Voltage	120.0 V
Operation Mode	Fully Automatic
Special Features	Silence Feature, ComfortClean, Coffee Pot Function, OneTouch for Two Preparation, Individual Language Selection

WARRANTY AND SUPPORT

For detailed warranty information and customer support, please refer to the official Miele website or the comprehensive user manual provided with your product.

[Official User Manual \(PDF\): Download Here](#)

[Miele Official Store: Visit Store](#)