

MiBOXER C8

MiBOXER C8 8-Slot Smart Battery Charger User Manual

Model: C8 | Brand: MiBOXER

1. PRODUCT OVERVIEW

The MiBOXER C8 is an advanced 8-slot smart battery charger designed for a wide range of rechargeable cylindrical batteries. It features an automatic LCD screen that displays charging information and offers multiple safety protections. This charger is constructed from durable, flame-retardant materials for enhanced safety and longevity.

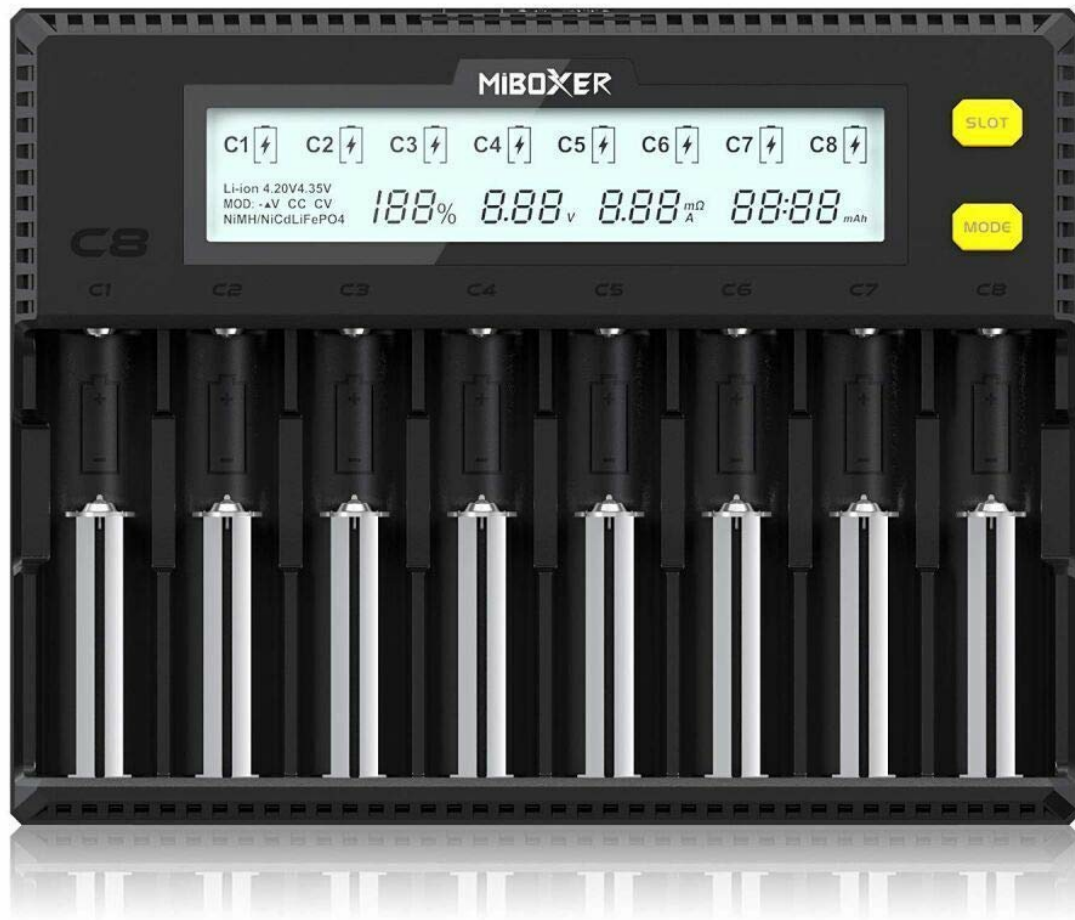

Image 1.1: The MiBOXER C8 charger with different battery types, highlighting its 3-year warranty.

Key Features:

- **8 Independent Charging Slots:** Allows simultaneous charging of up to eight batteries of different types and sizes without interference.
- **Wide Compatibility:** Supports Li-ion (4.20V/4.35V), IMR, INR, ICR, LiFePO4 (3.60V), Ni-MH, and Ni-Cd (1.48V) batteries, including sizes like 10340, 18650, 21700, AA, AAA, C, and more.
- **Multi-function LCD Display:** Provides real-time information on voltage, current, charging time, mode, battery type, internal resistance, and charged capacity. The backlight turns off after one minute of inactivity.
- **Automatic Detection:** Automatically identifies battery type and charging status.
- **Adjustable Charging Current:** Single-channel charging current can be manually adjusted up to 1.5A.
- **Safety Protections:** Includes automatic charging stop upon full charge, reverse polarity protection, short circuit protection, and overheat protection. Displays an error code for damaged or short-circuited batteries.
- **Durable Construction:** Made from flame-retardant PC+ABS material, resistant to heat, wear, low temperatures, and shock.



Image 1.2: Overview of the MiBOXER C8's safety features, including auto repair, short circuit protection, overheat protection, auto current selection, and capacity measurement.

2. PACKAGE CONTENTS

Before using the charger, please verify that all items are present in the package:

- 1 x MiBOXER C8 8-Slot Smart Battery Charger
- 1 x Power Supply Unit (EU Standard Plug)
- 1 x User Manual (this document)

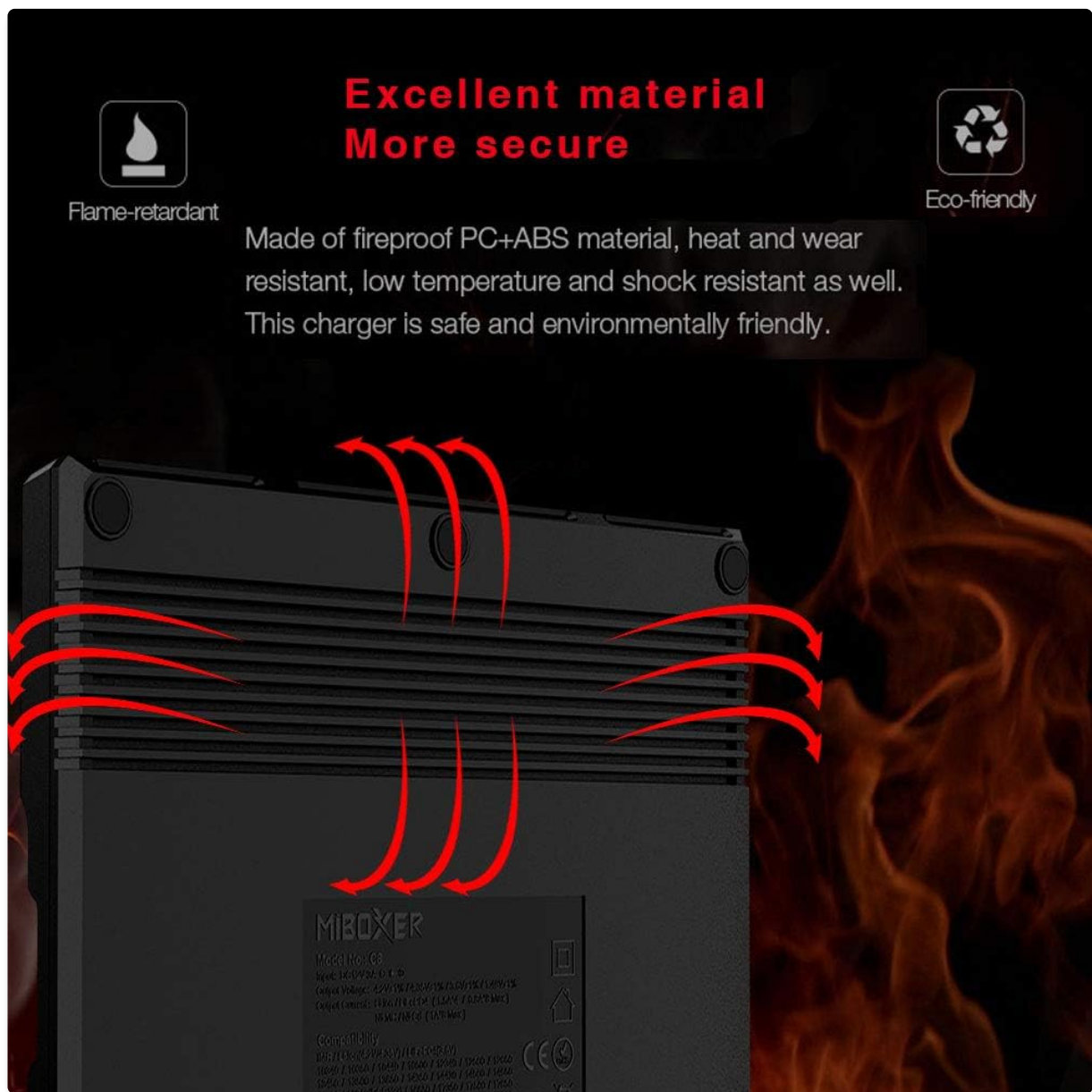

Image 2.1: The package includes the C8 smart charger, a power adapter, and the user manual.

3. SETUP INSTRUCTIONS

1. **Connect Power:** Plug the provided power supply unit into a suitable wall outlet. Connect the DC output plug (5.5*2.1 mm) to the DC12V 3A input port on the back of the MiBOXER C8 charger.
2. **Initial Display:** Upon connecting power, the LCD screen will illuminate, indicating the charger is ready for use.
3. **Optional Car Charging:** The charger supports DC12V car charger input. A car charger cable is not included and must be prepared separately if this function is desired.



Image 3.1: The MiBOXER C8 charger supports DC12V car charger input for on-the-go charging (car charger not included).

4. OPERATING INSTRUCTIONS

1. **Insert Batteries:** Carefully insert one or more rechargeable batteries into the charging slots. Ensure correct polarity by aligning the positive (+) and negative (-) ends of the battery with the markings on the charger. The high-precision sliding pole holder in each slot is designed for easy battery insertion and removal.
2. **Automatic Detection:** The charger will automatically detect the battery type (Li-ion, Ni-MH, etc.) and begin charging. The LCD screen will display relevant information for each slot.
3. **Manual Mode Selection (if needed):** For Li-ion (4.35V) and LiFePO4 batteries, manual selection of the battery type is required. Use the 'MODE' button to cycle through the available battery types until the correct one is selected for the inserted battery.
4. **Adjust Charging Current:** The charging current for a single channel can be manually adjusted up to 1.5A. Refer to the battery's specifications for its recommended charging current.
5. **Monitor Charging Progress:** The LCD screen provides real-time updates on charging status, including voltage, current, charging time, and charged capacity.
6. **Charging Completion:** The charger will automatically stop charging when the battery is fully charged.

The LCD screen will indicate 'FULL' or similar.

7. **Remove Batteries:** Once charging is complete, carefully remove the batteries from the slots.



Image 4.1: The LCD display shows charging parameters, and the 'SLOT' and 'MODE' buttons allow for control and information display.

Wide Compatible, Convenient Choice

Li-ion (4.2V/4.35V) / LiFePO4 (3.6V)

10340 10350 10440 10500 12340 12500 12650 13450 13500 13650 14350 14430
14500 14650 16500 16650 17350 17500 17650 17670 18350 18490 18500 **18650**
18700 20700 **21700** 22500 22650 25500 26500 26650 16340(RCR123)

Ni-MH / Ni-Cd (1.48V)

A / AA / AAA / AAAA / C / SC



Image 4.2: The charger is compatible with a wide range of Li-ion, LiFePO4, Ni-MH, and Ni-Cd battery sizes.

5. MAINTENANCE AND SAFETY

Maintenance:

- **Cleaning:** Disconnect the charger from power before cleaning. Use a soft, dry cloth to wipe the surface. Do not use abrasive cleaners or solvents.
- **Storage:** Store the charger in a cool, dry place away from direct sunlight and extreme temperatures when not in use.
- **Inspection:** Periodically inspect the power cable and charger for any signs of damage. Do not use if damaged.

Safety Precautions:

- Use only the provided power adapter or a compatible DC12V 3A adapter.
- Do not attempt to charge non-rechargeable batteries. This can lead to explosion, rupture, or leakage, causing property damage and personal injury.
- Ensure correct battery polarity when inserting batteries.
- Do not disassemble, modify, or short-circuit the charger.

- Keep the charger away from water, moisture, and high humidity.
- Avoid operating the charger near flammable materials.
- The charger is designed with excellent heat dissipation. Ensure proper ventilation during operation.



Image 5.1: The charger features flame-retardant PC+ABS material and a design for efficient heat dissipation, enhancing safety.

6. TROUBLESHOOTING

- **Charger not turning on:** Ensure the power adapter is securely connected to both the charger and the power outlet. Check if the power outlet is functional.
- **Battery not charging / Error displayed:**
 - Verify that the battery is inserted with correct polarity.
 - Check if the battery is damaged or short-circuited. The LCD screen will display an error code in such cases.
 - For Li-ion (4.35V) and LiFePO4 batteries, ensure the correct battery type is manually selected using the 'MODE' button.
 - Ensure the battery is rechargeable.
- **LCD backlight turns off:** This is normal behavior. The backlight automatically turns off after one minute of inactivity to save power. Press any button to reactivate it.

- **Slow charging:** Ensure the charging current is set appropriately for the battery type. Some batteries may have lower maximum charging rates.

7. SPECIFICATIONS

Feature	Specification
Model Number	C8
Input Voltage	DC 12V 3A
Output Voltage	4.35V \pm 1% / 4.20V \pm 1% / 3.60V \pm 1% / 1.48V \pm 1%
Output Current (Li-ion/LiFePO4)	Max. 1.5A \times 4 slots / 0.8A \times 8 slots
Output Current (Ni-MH/Ni-Cd)	Max. 1A \times 8 slots
Supported Battery Types	Li-ion, IMR, INR, ICR, LiFePO4, Ni-MH, Ni-Cd
Supported Battery Sizes	10340, 10350, 10440, 10500, 12340, 12500, 12650, 13450, 13500, 13650, 14350, 14430, 14500, 14650, 16340 (RCR123), 16500, 16650, 17350, 17500, 17650, 17670, 18350, 18490, 18500, 18650, 18700, 20700, 21700, 22500, 22650, 25500, 26500, 26650, AA, AAA, AAAA, C, SC
Product Dimensions (L \times W \times H)	18.3 cm \times 14 cm \times 3.3 cm (approx. 7.2 in \times 5.5 in \times 1.3 in)
Item Weight	360 grams
Certifications	CE, FCC, RoHS

8. WARRANTY AND SUPPORT

Warranty:

The MiBOXER C8 Smart Battery Charger comes with a **3-year warranty** from the date of purchase. This warranty covers manufacturing defects and malfunctions under normal use. Please retain your proof of purchase for warranty claims.

Customer Support:

For technical assistance, troubleshooting, or warranty inquiries, please contact your retailer or the MiBOXER customer support team. Refer to the contact information provided on the product packaging or

the official MiBOXER website.