

[Manuals.plus](#) /

> [FDGAO](#) /

> FDGAO 20W Max Wireless Charging Pad User Manual

FDGAO B424

FDGAO 20W Max Wireless Charging Pad User Manual

Model: B424

INTRODUCTION

Thank you for choosing the FDGAO 20W Max Wireless Charging Pad. This device provides fast and convenient wireless charging for a wide range of compatible smartphones and earbuds. Please read this manual carefully before use to ensure optimal performance and safety.

PACKAGE CONTENTS

- 1 x wireless Charging Pad
- 1 x 3.3ft USB-A to USB-C Charging Cable
- 1 x User Manual

Note: An AC adapter is not included and must be purchased separately. For optimal fast charging, a QC 3.0 compatible power adapter is recommended.

PRODUCT FEATURES

- **20W Max Fast Wireless Charging:** Supports high-speed charging for compatible devices, up to 1.8X faster than standard wireless chargers.
- **Extensive Compatibility:** Compatible with iPhone 16/15/14/13/12/11/X series, AirPods, Samsung Galaxy S25/S24/S23/S20, Note series, LG/Sony, Nokia/Google, and other Qi-enabled devices.
- **Case-Friendly Charging:** Inductive charging directly through protective cases up to 6mm (0.23 inches) thick. (Note: Not compatible with cases containing magnetic or metal attachments).
- **Slim and Portable Design:** Just 6mm (0.23 inches) super slim, lightweight, and compact with non-slip rubber, making it ideal for travel or office use.
- **Smart Indicator Light:** Displays charging status. Green light for 20 seconds upon power-on (then off if no device), weak blue light flashes slowly during charging until fully charged, designed not to affect sleep.
- **Comprehensive Safety:** Features a ten-safety protection system to prevent short circuit, overcharge, overvoltage, and other issues.

1. Connect the Charger:

Connect the provided USB-A to USB-C charging cable to the wireless charging pad's USB-C port.



Image: The FDGAO wireless charging pad connected to its USB-C cable, ready for power connection.

2. Connect to Power Source:

Plug the USB-A end of the cable into a compatible power adapter (e.g., a QC 3.0 wall charger, not included) and then plug the adapter into a power outlet.



Image: A diagram illustrating the recommendation of a QC 3.0 output adapter for optimal performance, contrasting it with a standard iPhone stock charger which is not recommended.

3. Power On Indicator:

When powered on, the indicator light on the charging pad will turn green for approximately 20 seconds. If no device is detected within this time, the light will automatically turn off, indicating standby mode.



Image: The FDGAO wireless charging pad displaying a green indicator light, signifying it is powered on and in standby mode.

OPERATING INSTRUCTIONS

1. Place Your Device:

Place your Qi-enabled smartphone or earbuds directly onto the center of the charging pad. Ensure the device is properly aligned for optimal charging.

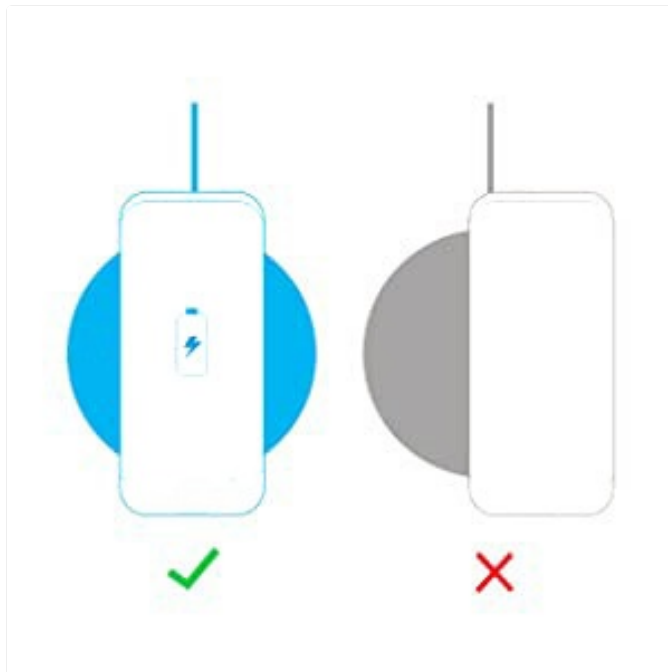

Image: A diagram illustrating the correct placement of a phone centrally on the charging pad (green check) versus incorrect off-center placement (red cross).

2. **Charging Indicator:**

When your device is correctly placed and charging, the indicator light will flash slowly in blue. This weak blue light is designed not to disturb your sleep.

Charging indicator

Automatic switching to the slow protection mode when Mobile phone is fully charged



Image: Two smartphones are shown charging on separate FDGAO wireless pads, with their screens indicating charging progress and the pads emitting a blue charging light.

3. Full Charge Protection:

Once your device is fully charged, the charging pad will automatically switch to a slow protection mode to prevent overcharging and protect your device's battery life.

4. Case Compatibility:

The charger supports inductive charging directly through protective cases up to 6mm (0.23 inches) thick. However, cases with magnetic or metal attachments, or credit cards placed between the phone and charger, will prevent charging and should be removed.



Image: A diagram showing the wireless charger's compatibility with phone cases up to 6mm thick, explicitly excluding metal cases, cases with metal rings, credit cards, or magnetic pads.

MAINTENANCE

- Keep the charging pad away from water, moisture, and other liquids.
- Do not attempt to disassemble, repair, or modify the product yourself.
- Avoid exposing the charger to direct sunlight, extreme heat, or very cold temperatures.
- Clean the surface of the charging pad with a soft, dry cloth. Do not use harsh chemicals or abrasive materials.

TROUBLESHOOTING

Problem	Possible Cause	Solution
Device not charging or charging intermittently.	<p>Device not centered on the charging pad.</p> <p>Device is not Qi-compatible.</p> <p>Phone case is too thick or contains metal/magnets.</p> <p>Power adapter is not sufficient (e.g., not QC 3.0).</p> <p>Charging cable is faulty or not properly connected.</p>	<p>Re-position your device to the exact center of the charging pad.</p> <p>Verify that your device supports Qi wireless charging.</p> <p>Remove any phone cases thicker than 6mm, or those with metal/magnetic elements.</p> <p>Use a QC 3.0 (or higher) compatible power adapter for optimal performance.</p> <p>Ensure the USB cable is securely connected to both the charger and the power adapter. Try a different cable if necessary.</p>
Charging is slow.	<p>Power adapter does not support fast charging.</p> <p>Device does not support fast wireless charging.</p> <p>Too many background applications running on the device.</p>	<p>Use a QC 3.0 (or higher) compatible power adapter.</p> <p>Confirm your device's fast wireless charging capabilities.</p> <p>Close unnecessary applications running in the background on your device.</p>

Problem	Possible Cause	Solution
Indicator light is not working.	Charger is not receiving power. Faulty charging pad.	Check if the power outlet is working and all connections are secure. Contact customer support if the issue persists after checking power and connections.
Device or charger gets hot during charging.	Normal heat generation during wireless charging. Poor device alignment. Environmental temperature is too high.	Slight warmth is normal. If excessively hot, discontinue use. Ensure proper alignment of the device on the pad. Charge in a well-ventilated area away from direct heat sources.

SPECIFICATIONS

- **Model:** B424
- **Input Voltage:** 120 Volts (requires compatible AC adapter)
- **Output Power:** 20W Max (actual output depends on device and adapter)
- **Product Dimensions:** 3.94 x 3.94 x 0.24 inches (approximately 100mm x 100mm x 6.5mm)
- **Item Weight:** 3.53 ounces (approximately 100 grams)
- **Connectivity Technology:** Wireless (Qi Standard)
- **Connector Type:** USB Type C
- **Cable Length:** 3.3 feet (USB-A to USB-C)
- **Color:** 20W-Mirror White
- **Manufacturer:** FDGAO



Image: A diagram illustrating the ultra-thin design and precise dimensions of the FDGAO wireless charging pad.

WARRANTY AND SUPPORT

FDGAO is committed to providing quality products and excellent customer service. This product comes with 24-hour customer service. For any product-related inquiries, technical support, or warranty claims, please contact our support team through the retailer's platform where you purchased the product.

You can also visit the official FDGAO Store for more information and support:

[Visit the FDGAO Store on Amazon](#)

IMPORTANT SAFETY INFORMATION

To ensure safe and efficient operation of your wireless charging pad, please observe the following safety guidelines:

- Do not place any metal objects, magnetic cards, or credit cards on the charging pad during use, as this can interfere with charging and potentially damage the device or the charger.

- Avoid exposing the charger to direct sunlight, high temperatures (e.g., inside a hot car), or very cold environments.
- Do not drop, impact, or throw the device, as this can cause internal damage.
- Keep the charging pad out of reach of children and pets.
- If the charger emits smoke, unusual odors, or makes abnormal noises, immediately unplug it from the power source and discontinue use.
- Ensure proper ventilation around the charging pad during use.

Actively protect your safety

ten safety protection system to avoid short circuit
Overcharge and overvoltage



Temperature protection



Short circuit protection



Reset protection



Input overvoltage protection



Input anti-reverse protection



output overcurrent protection



output overvoltage protection



Battery overcharge protection



overcurrent protection

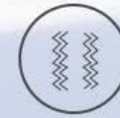

Magnetic field protection



Image: A visual representation of the ten safety protection systems integrated into the FDGAO wireless charger, including temperature, short circuit, reset, input overvoltage, input anti-reverse, output overcurrent, output overvoltage, battery overcharge, overcurrent, and magnetic field protection.