

Manuals.plus /

› Kircuit /

› Kircuit 5V AC/DC Adapter Instruction Manual for Hyper Tough Flashlights and Work Lights

Kircuit PA-65W

Kircuit 5V AC/DC Adapter Instruction Manual

Model: PA-65W

1. INTRODUCTION

Thank you for choosing the Kircuit 5V AC/DC Adapter. This power charger is designed to provide reliable and efficient power to compatible devices, specifically Hyper Tough 800 Lumens Task 800L 20633 Rechargeable LED Flashlights, and 9978, 9977, 1000, 1200 Lumen Work Lights with Lithium-Ion Batteries. It serves as an ideal replacement or travel backup power solution.



Image 1.1: The Kircuit 5V AC/DC Adapter with its integrated micro USB cable, ready for use.

2. SAFETY INFORMATION

Your safety is paramount. Please read and adhere to the following safety guidelines:

- **Indoor Use Only:** This adapter is designed for indoor use. Do not expose it to rain, moisture, or extreme temperatures.
- **Proper Voltage:** Ensure the wall outlet voltage matches the adapter's input specifications (100V-240V AC).
- **Avoid Overloading:** Do not overload the power outlet or extension cords.
- **Handle with Care:** Do not drop, disassemble, or attempt to repair the adapter. Refer to qualified service personnel for any issues.
- **Unplug When Not In Use:** Disconnect the adapter from the power outlet when not in use for extended periods.
- **Built-in Protections:** This adapter features built-in safety protections including:
 - Short Circuit Protection
 - Excess Voltage Protection
 - Over Temperature Protection
 - Overcurrent Protection

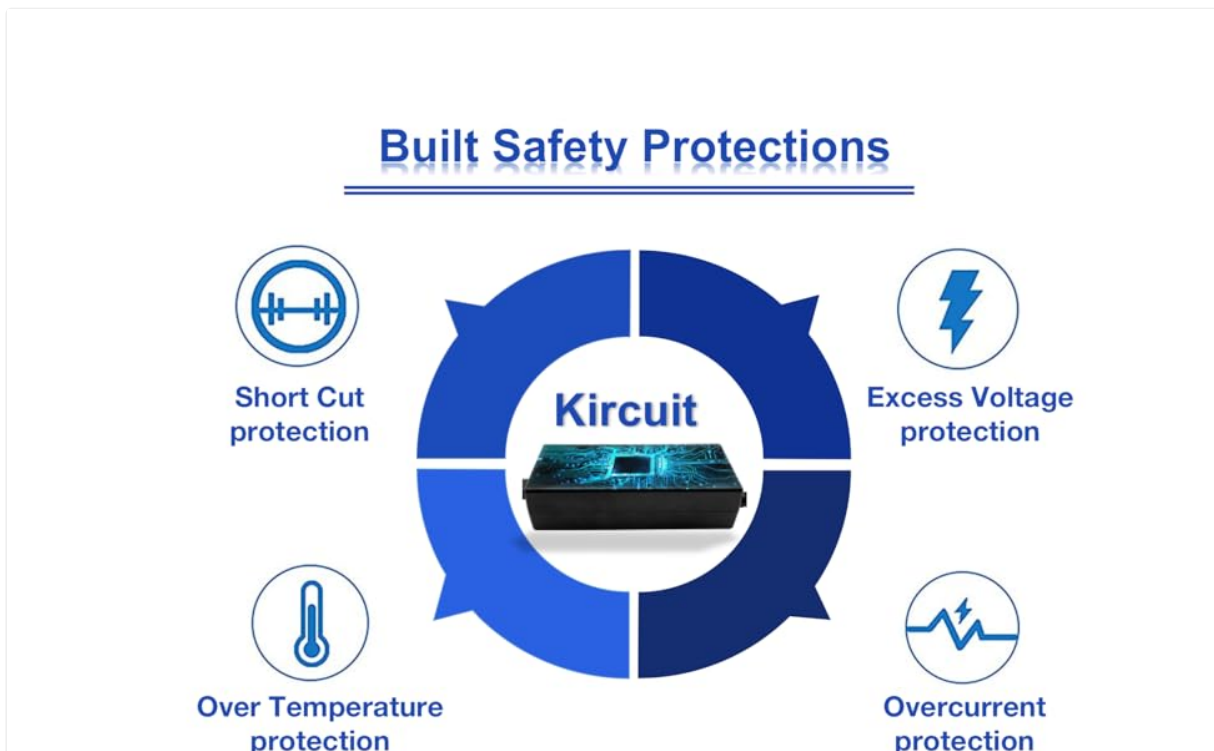

Image 2.1: Illustration of the multiple safety protections integrated into the Kircuit adapter design.

3. SETUP

Setting up your Kircuit AC/DC Adapter is straightforward:

1. **Identify Compatible Device:** Ensure your device requires a 5V DC input and has a micro USB charging port. This adapter is specifically designed for Hyper Tough rechargeable LED flashlights and work lights.
2. **Connect to Device:** Insert the micro USB connector of the adapter cable firmly into the charging port of your Hyper Tough flashlight or work light.
3. **Plug into Power Outlet:** Insert the adapter's two-prong plug into a standard 100V-240V AC wall power outlet.
4. **Verify Connection:** Confirm that the adapter is securely plugged into both the device and the wall outlet.

The device's charging indicator (if available) should activate.



Image 3.1: The Kircuit adapter connected to a power strip, demonstrating a typical setup for charging.

4. OPERATING

Once properly connected, the Kircuit AC/DC Adapter will begin charging your device. The adapter provides a stable 5V DC output at 1A, optimized for rapid and safe charging of compatible Hyper Tough devices.

- The adapter automatically regulates power delivery to prevent overcharging, thanks to its integrated Charger IC.
- Charging times may vary depending on the device's battery capacity and current charge level.
- Always ensure the adapter is placed in a well-ventilated area during operation to prevent heat buildup.

5. MAINTENANCE

To ensure the longevity and optimal performance of your Kircuit AC/DC Adapter, follow these maintenance tips:

- **Cleaning:** Use a soft, dry cloth to wipe the adapter. Do not use liquid cleaners or abrasive materials.
- **Storage:** Store the adapter in a cool, dry place away from direct sunlight and extreme temperatures when not in use.

- **Cable Care:** Avoid bending or crimping the cable excessively, especially near the connectors. The power cable is made of high-quality materials with a thick insulation layer to protect against wear and tear.
- **Plug Integrity:** The plugs are designed for a secure and stable connection and can handle electrical loads without overheating. Ensure they remain clean and free of debris.

Durable design

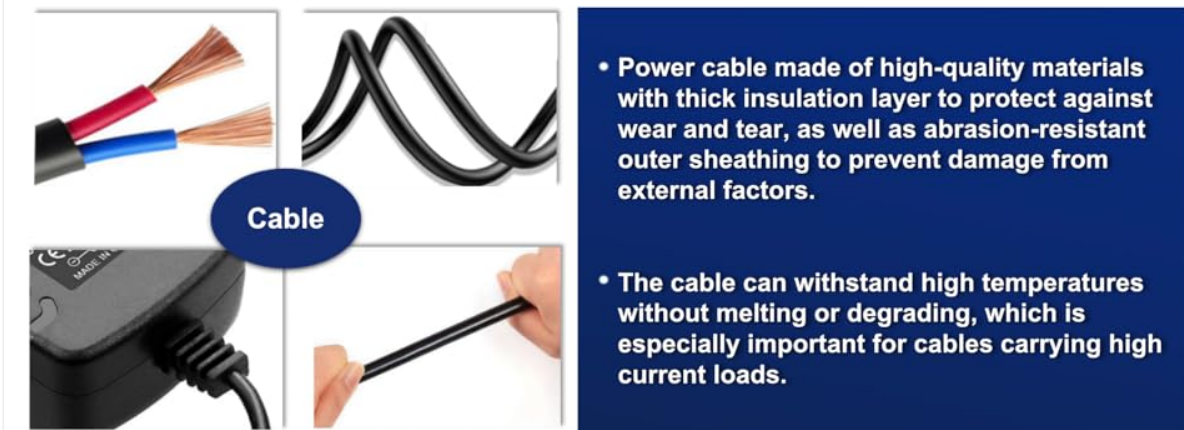

Image 5.1: Details on the durable design of the power cable, highlighting its high-quality materials and resistance to wear and high temperatures.

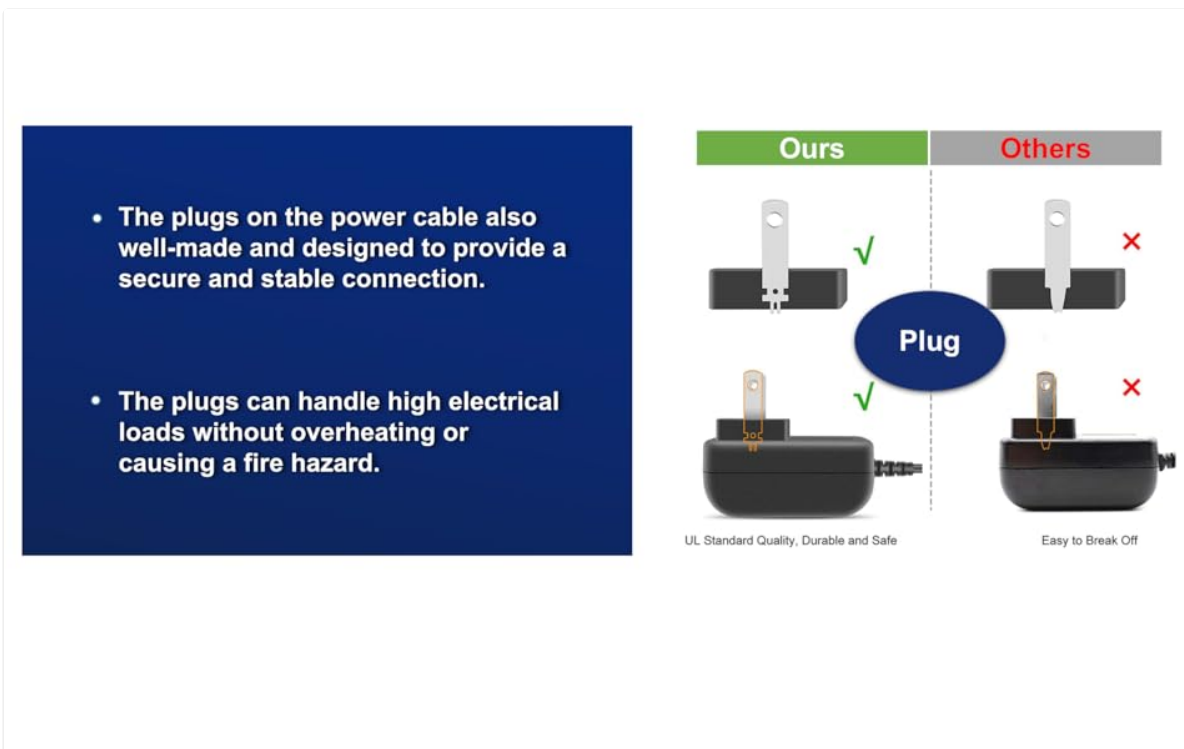

Image 5.2: Illustration emphasizing the robust and secure design of the adapter's plug, meeting UL standards for quality and safety.

6. TROUBLESHOOTING

If you encounter issues with your Kircuit AC/DC Adapter, please refer to the following common problems and

solutions:

Problem	Possible Cause	Solution
Device not charging	Loose connection No power from outlet Incompatible device Damaged adapter/cable	Ensure all connections are firm. Test the outlet with another device. Verify device compatibility (5V DC, micro USB). Inspect adapter and cable for visible damage. If damaged, discontinue use and replace.
Adapter feels hot	Normal operation (slight warmth) Poor ventilation Overload/Faulty device	A slight warmth is normal. Ensure adequate ventilation around the adapter. Unplug immediately if excessively hot. Do not use if it smells or smokes.

If the problem persists after attempting these solutions, please contact customer support.

7. SPECIFICATIONS

Technical specifications for the Kircuit 5V AC/DC Adapter:

- **Model Number:** PA-65W
- **Input:** 100V-240V AC, 50/60Hz, 0.3A
- **Output:** 5V DC, 1A
- **Connector Type:** Micro USB
- **Manufacturer:** Shenzhen Waweis Technology Co., Ltd
- **ASIN:** B09BC3DY5M



Image 7.1: A detailed view of the adapter's label, displaying its input and output electrical specifications.

8. WARRANTY AND SUPPORT

Kircuit stands behind the quality of its products.

- **Warranty:** This product typically comes with a 3-year warranty from the date of purchase, covering manufacturing defects. Please retain your proof of purchase for warranty claims.
- **Customer Support:** For any questions, technical assistance, or warranty inquiries, please contact the seller or manufacturer directly through the platform where the product was purchased.



Image 8.1: The Kirrcuit adapter packaging, indicating a 3-year warranty period.