

tectake 404147

tectake 4-Tier Industrial Design Ladder Shelf

INSTRUCTION MANUAL

Introduction

This manual provides detailed instructions for the assembly, operation, and maintenance of your tectake 4-Tier Industrial Design Ladder Shelf, Model 404147. Please read these instructions carefully before assembly and use to ensure safe and correct installation.

Safety Information

- Ensure all components are securely fastened during assembly.
- Do not exceed the maximum weight capacity of 15 kg per shelf, or 60 kg total.
- Utilize the included anti-tipping protection to secure the shelf to a wall, especially in households with children or pets.
- Place the shelf on a stable, level surface. Adjust the feet as necessary to ensure stability.

Setup and Assembly

The tectake ladder shelf is designed for quick and easy assembly by one person. Please ensure all parts are present before beginning.

Package Contents:

- 4-Tier Ladder Shelf components
- Assembly hardware (screws, bolts, Allen key)
- Anti-tipping protection kit

Assembly Steps:

1. **Unpack Components:** Carefully remove all parts from the packaging and verify against the parts list (not provided in detail, but implied).
2. **Assemble Frame:** Connect the metal frame sections using the provided hardware. Ensure all connections are finger-tight at this stage.

3. **Attach Shelves:** Secure each wooden shelf to the frame. The shelves vary in depth; ensure they are placed in the correct order from largest at the bottom to smallest at the top.
4. **Tighten All Fasteners:** Once all components are in place, fully tighten all screws and bolts. Do not overtighten.
5. **Install Adjustable Feet:** Screw the adjustable feet into the bottom of the frame. Adjust them to ensure the shelf stands level and stable on your floor.
6. **Secure Anti-Tipping Protection:** Attach the anti-tipping device to the top rear of the shelf and secure it to a wall stud or appropriate anchor point.

tectake
home

AFMETINGEN

Totale afmetingen

57,5 x 35,5 x 139 cm

Afstand tussen de niveaus

32,5 cm

Afstand onderste plank tot vloer

21 cm

Verstelbaarheid voetjes

1,5 cm

Afmetingen zijn bij benadering

TECHNISCHE DETAILS

Draagkracht 60 kg

Draagkracht per vak 15 kg

Gewicht ca. 11,5 kg

Materiaal MDF-plaat,
gepoedercoat staal, polyethyleen

INHOUD

Ladderkast

Montagemateriaal

Montagehandleiding

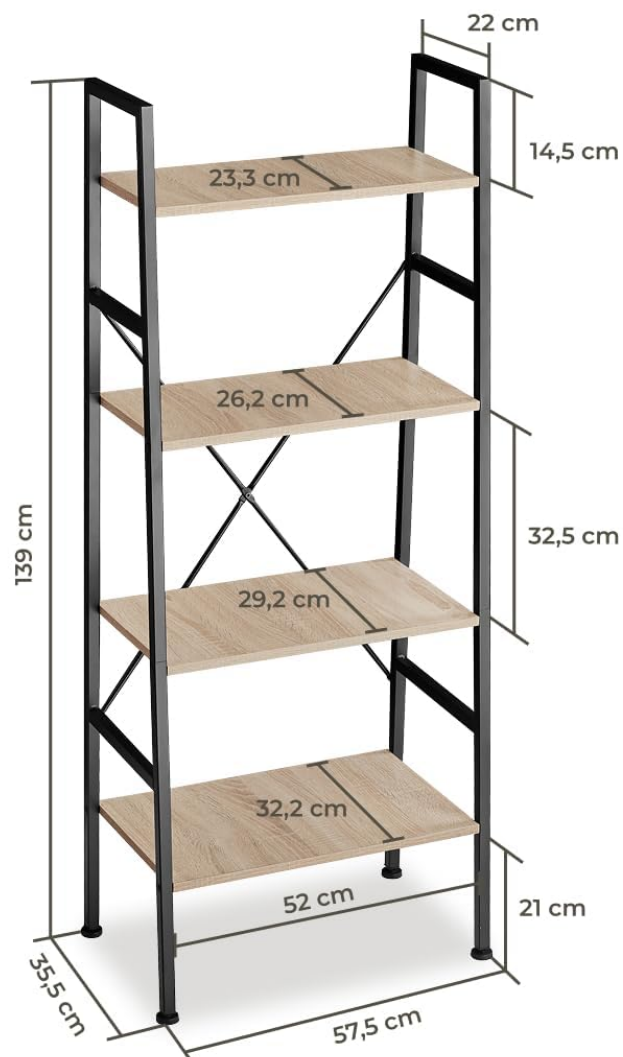

Figure 1: Dimensional overview of the tectake 4-Tier Ladder Shelf. Total dimensions are approximately 57.5 x 35.5 x 139 cm (W x D x H). Shelf depths range from 32.2 cm (bottom) to 23.3 cm (top).

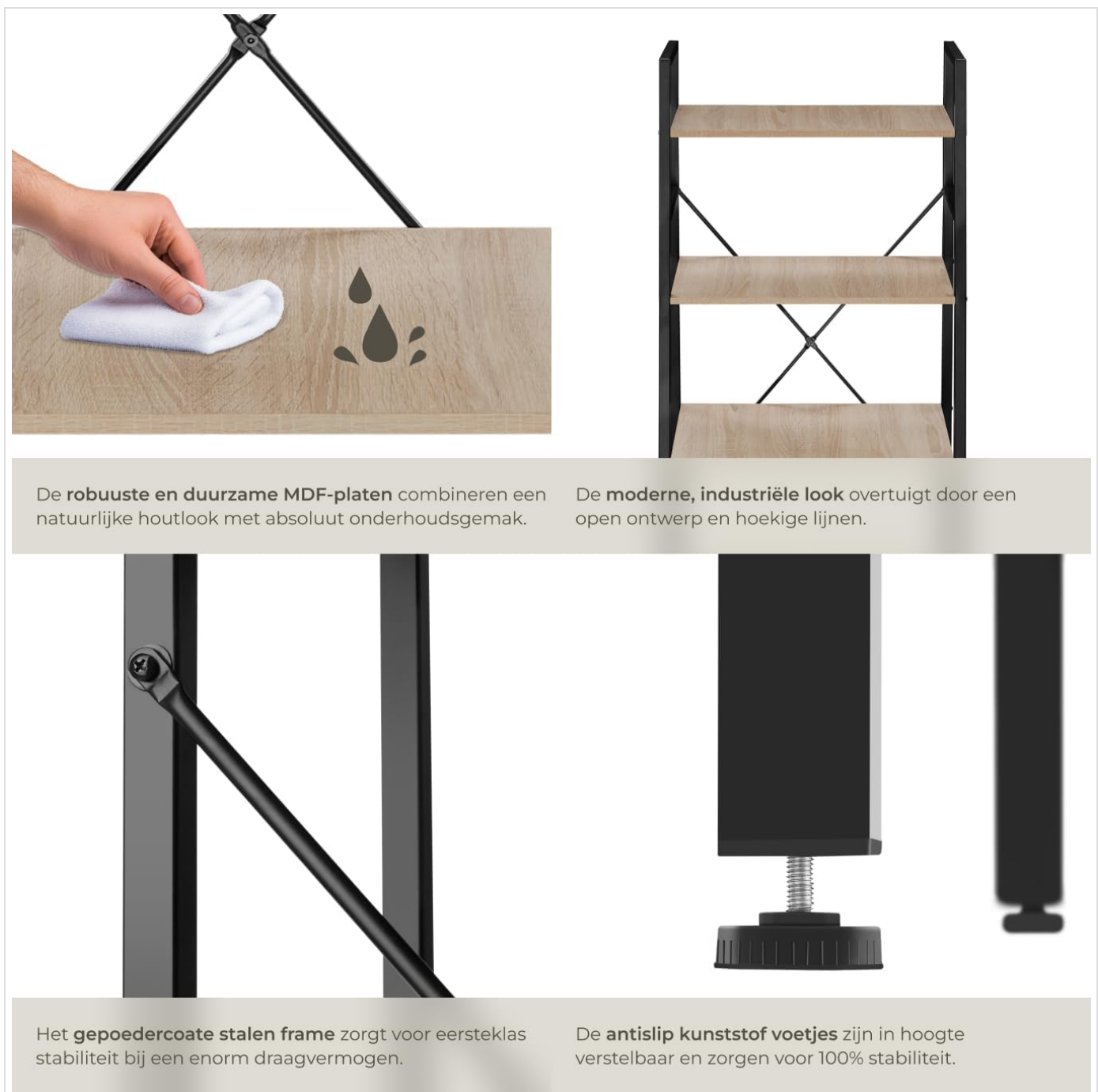

Figure 2: Detail of the adjustable foot, which allows for leveling on uneven surfaces.

Operation and Usage

The tectake ladder shelf is designed for displaying decorative items, books, and other household goods. Its industrial design complements various interior styles.

- Distribute weight evenly across the shelves.
- Do not place excessively heavy items on the top shelves to maintain stability.
- The shelf is suitable for use in living rooms, bedrooms, kitchens, and offices.

tectake home



Stoere industriële stijl
in een eenvoudig ontwerp
met heldere lijnen



5 stevige planken
met oppervlakken in zeer
hoogwaardige houtlook



Massief stalen frame
met poedercoating,
extreem duurzaam



Grote belastbaarheid
van in totaal 60 kg;
15 kg per plank



100% stabiliteit
vloerbeschermende en
hoogteverstelbare voetjes



Anti-kantelbeveiliging
voor hoge stabiliteit, zelfs
bij volledige belading



Eenvoudige montage
zeer eenvoudige opbouw
binnen enkele minuten



Gemakkelijk reinigen
gewoon met een vochtige
doek



Figure 3: Example of the ladder shelf in use, showcasing its capacity for various items in a living room setting.

Maintenance

This shelf is constructed from easy-care materials, ensuring long-lasting durability with minimal effort.

- **Cleaning:** Wipe surfaces with a soft, damp cloth. Avoid abrasive cleaners or harsh chemicals that could damage the finish.
- **Inspection:** Periodically check all screws and fasteners to ensure they remain tight. Retighten if necessary.
- **Adjustable Feet:** Re-adjust the feet if the shelf becomes unstable due to floor changes or movement.

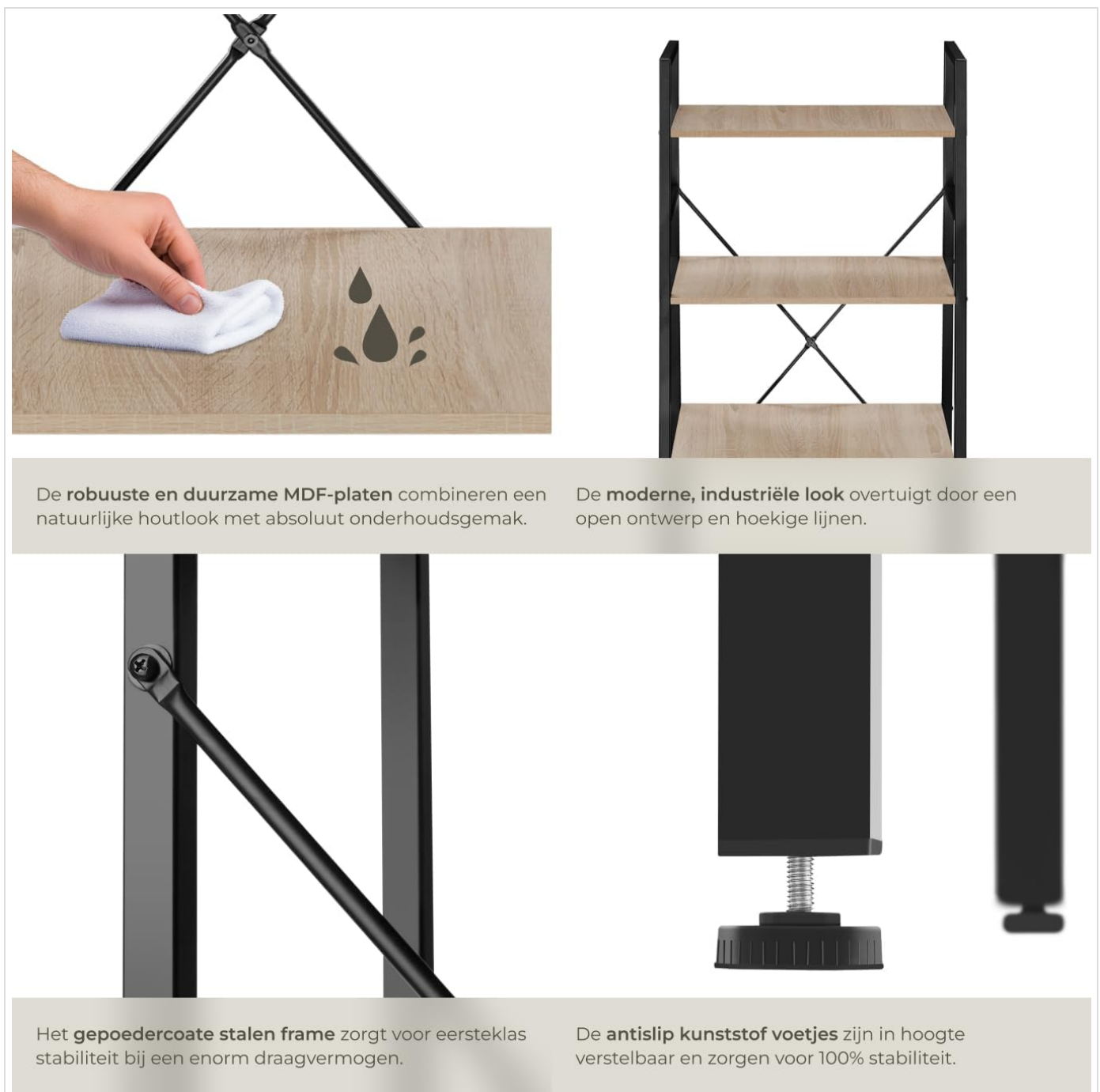

Figure 4: The robust MDF panels are designed for easy maintenance. A damp cloth is sufficient for cleaning the surfaces.

Troubleshooting

Problem	Possible Cause	Solution
Shelf is wobbly or unstable.	Uneven floor; loose fasteners; incorrect assembly.	Adjust the leveling feet. Ensure all screws are tightened. Verify assembly steps.
Parts do not align during assembly.	Incorrect orientation of parts; manufacturing tolerance.	Double-check part orientation against diagrams. Loosen adjacent fasteners slightly to allow for adjustment, then retighten.
Shelf appears tilted.	Uneven floor; adjustable feet not properly set.	Adjust the individual leveling feet until the shelf is level.

Specifications

Model Number:	404147
Brand:	tectake
Overall Dimensions (W x D x H):	57.5 x 35.5 x 139 cm (approximately)
Shelf Dimensions (W x D x H):	Top Shelf: 52 x 23.3 x 1.5 cm Third Shelf: 52 x 26.2 x 1.5 cm Second Shelf: 52 x 29.2 x 1.5 cm Bottom Shelf: 52 x 32.2 x 1.5 cm
Distance Between Shelves:	Approximately 32.5 cm
Distance from Floor to Bottom Shelf:	Approximately 21 cm
Adjustable Foot Height:	Approximately 1.5 cm
Maximum Load Capacity:	60 kg total (15 kg per shelf)
Weight:	Approximately 11.3 kg
Materials:	MDF board, powder-coated steel, polyethylene