

ASDNN B09B7JCRSD

ASDNN Solar Outdoor Wall Lamp User Manual

Model: B09B7JCRSD

1. INTRODUCTION

Thank you for choosing the ASDNN Solar Outdoor Wall Lamp. This manual provides important information regarding the installation, operation, and maintenance of your new solar-powered wall light. Please read this manual thoroughly before installation and keep it for future reference.

This solar wall lamp is designed for outdoor use, featuring an intelligent sensor, IP44 waterproof rating, and energy-efficient LED lighting. It is ideal for illuminating courtyards, gardens, villa entrances, and other outdoor spaces.

2. PRODUCT FEATURES

- **Efficient Solar Charging:** Equipped with high-efficiency amorphous silicon solar panels (0.5W) for automatic charging during daylight hours, promoting environmental protection and energy saving.
- **Intelligent Light Control & Motion Sensor:** The lamp automatically turns off when sufficient ambient light is detected and turns on automatically in darkness. It also features a human body intelligent sensor, activating the light when motion is detected.
- **Durable & Waterproof Design:** Constructed from high-quality ABS plastic, this lamp boasts an IP44 waterproof rating, making it suitable for outdoor use in various weather conditions, including rain. It is strong, wear-resistant, and resistant to rust.
- **Bright LED Illumination:** Utilizes 2 pieces of 0.5W high-brightness LED lamp beads for effective lighting.
- **Long Operating Time:** After more than 7 hours of charging, the fully powered lamp can provide 10-14 hours of illumination.
- **Easy Installation:** Designed for straightforward installation without complex procedures.

3. TECHNICAL SPECIFICATIONS

Specification	Detail
Model	ASDNN Solar Outdoor Wall Lamp (ASIN: B09B7JCRSD)
Material	ABS Plastic, Iron
Color	Black
Light Source	2 x 0.5W LED High Brightness Lamp Beads
Solar Panel	Amorphous Silicon Solar Panel, 0.5W
Battery	Aluminum Iron Phosphate Rechargeable Battery 3.2V 600mAh
Protection Level	IP44 Waterproof
Dimensions (Approx.)	278mm (Height) x 200mm (Width)
Charging Time	> 7 hours (direct sunlight)
Operating Time	10-14 hours (fully charged)
Average Service Life	100,000 hours
Mounting Type	Wall Mount

Note: The "Control Method: App", "Controller Type: Remote Control", and "Switch Type: Touch" listed in some product specifications appear to be generic and do not apply to this specific solar wall lamp based on its description. This lamp operates via intelligent light control and a human body sensor.

4. PACKAGE CONTENTS

Please check the package carefully to ensure all items are present and in good condition.

- 1 x ASDNN Solar Outdoor Wall Lamp
- 1 x Light Source (pre-installed)
- Mounting Hardware (screws, wall anchors) - *Implied by "Easy installation" and typical for wall mounts.*

5. SAFETY INFORMATION

- Ensure the installation surface is sturdy enough to support the lamp.
- Do not attempt to disassemble or modify the product, as this may void the warranty and cause damage.
- Keep the solar panel clean to ensure optimal charging efficiency.
- Avoid placing the lamp in areas with constant shade, as this will reduce charging performance.
- This product is designed for outdoor use and is IP44 waterproof. However, avoid submerging it in water.
- Keep out of reach of children.

6. SETUP AND INSTALLATION

Follow these steps for proper installation of your solar outdoor wall lamp:

1. **Choose an Optimal Location:** Select a location that receives direct sunlight for at least 6-8 hours a day to ensure the solar panel can fully charge the battery. Avoid areas under eaves, trees, or other obstructions that might cast shadows.
2. **Mark Drilling Points:** Hold the lamp against the desired wall surface and mark the positions for the mounting screws. Ensure the lamp is level.
3. **Drill Holes:** Use an appropriate drill bit to drill holes at the marked positions. Insert wall anchors into the drilled holes if necessary (for masonry or drywall).
4. **Mount the Lamp:** Align the lamp's mounting holes with the drilled holes and secure it to the wall using the provided screws. Ensure it is firmly attached.
5. **Initial Charge:** Allow the lamp to charge in direct sunlight for a full day (at least 7 hours) before its first use to ensure the battery is adequately charged.

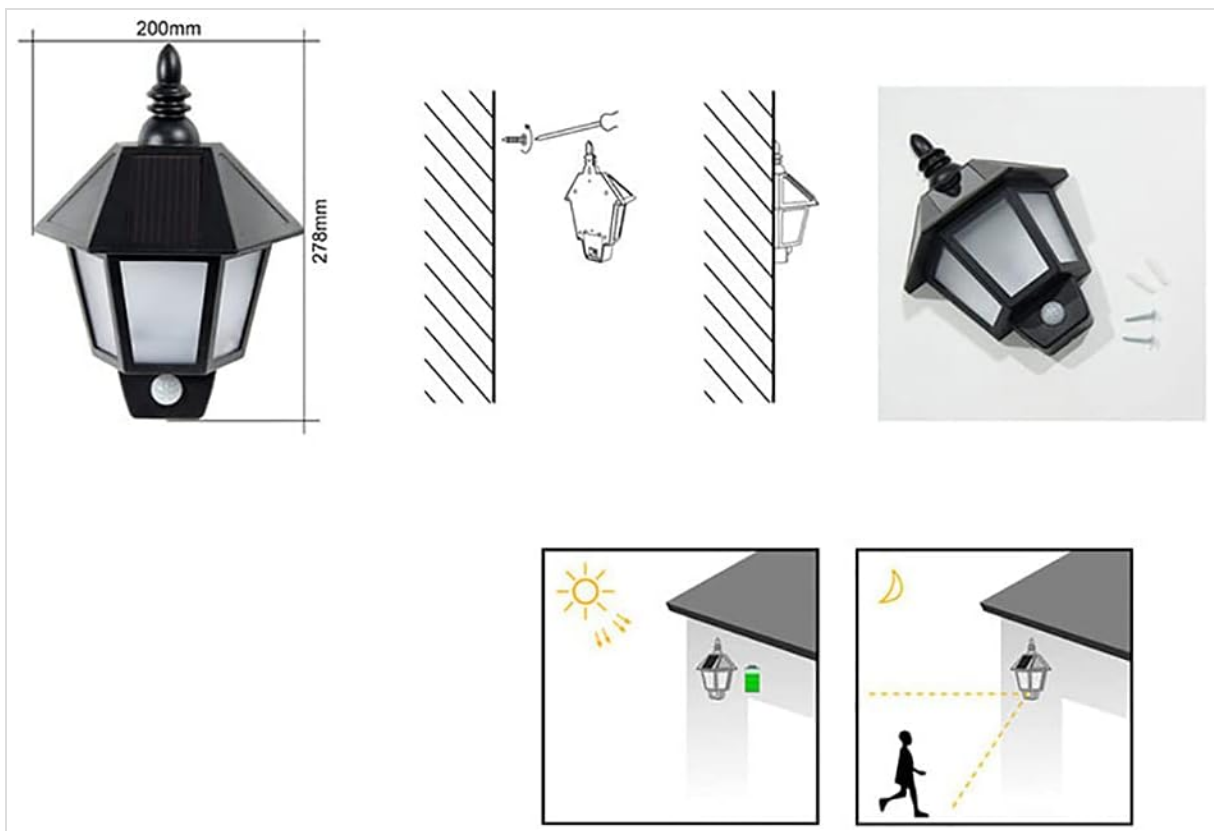

Figure 1: Installation diagram illustrating the steps for mounting the solar wall lamp. It shows marking points, drilling, and securing the lamp to a wall.



Figure 2: Product dimensions. The lamp measures approximately 275mm in height and 200mm in width.

7. OPERATING INSTRUCTIONS

The ASDNN Solar Outdoor Wall Lamp operates automatically based on ambient light and motion detection.

- **Automatic Charging:** During the day, the solar panel on top of the lamp will absorb sunlight and convert it into electrical energy, storing it in the internal rechargeable battery.
- **Automatic Illumination (Dusk to Dawn):** As dusk approaches and ambient light levels decrease, the intelligent light sensor will detect the darkness and automatically turn on the LED light.
- **Motion Sensor Activation:** When the lamp is on (during dark hours), the integrated human body intelligent sensor will detect motion within its range, causing the light to illuminate. After a period of no motion, the light will turn off until motion is detected again.
- **Automatic Shut-off (Daylight):** At dawn, when sufficient ambient light is detected, the intelligent light sensor will automatically turn off the LED light and resume charging.



Figure 3: The solar wall lamp in operation, showcasing its illuminated state and the integrated motion sensor.



Figure 4: Close-up view of the solar panel, responsible for charging the lamp during the day.

8. MAINTENANCE

- **Clean the Solar Panel:** Regularly wipe the solar panel with a soft, damp cloth to remove dust, dirt, leaves, or snow. A clean panel ensures maximum sunlight absorption and charging efficiency.
- **Inspect for Damage:** Periodically check the lamp for any physical damage, loose connections, or signs of wear.
- **Battery Replacement:** The internal rechargeable battery has a long service life. If the lamp's performance significantly degrades over time (e.g., shorter illumination duration), the battery may need replacement. This should ideally be done by a qualified technician or by contacting customer support.
- **Storage:** If storing the lamp for an extended period, ensure it is fully charged and store it in a cool, dry place.

9. TROUBLESHOOTING

Problem	Possible Cause	Solution
Lamp does not turn on at night.	<ul style="list-style-type: none"> ◦ Insufficient sunlight for charging. ◦ Solar panel is dirty or obstructed. ◦ Lamp is installed in a shaded area. ◦ Battery is depleted or faulty. 	<ul style="list-style-type: none"> ◦ Ensure the lamp receives at least 6-8 hours of direct sunlight daily. ◦ Clean the solar panel surface. ◦ Relocate the lamp to a sunnier spot. ◦ Allow several days of full charging. If problem persists, contact customer support.
Lamp stays on during the day.	<ul style="list-style-type: none"> ◦ Light sensor is obstructed or faulty. ◦ Lamp is installed in a very dark area, even during the day. 	<ul style="list-style-type: none"> ◦ Check for any obstructions covering the light sensor. ◦ Ensure the lamp is exposed to sufficient ambient light during the day.
Light is dim or flickers.	<ul style="list-style-type: none"> ◦ Insufficient battery charge. ◦ Aging battery. 	<ul style="list-style-type: none"> ◦ Ensure adequate sunlight exposure for charging. ◦ If the lamp is old, the battery may need replacement. Contact customer support.
Motion sensor not working.	<ul style="list-style-type: none"> ◦ Sensor is obstructed. ◦ Sensor range is too far or too close. ◦ Faulty sensor. 	<ul style="list-style-type: none"> ◦ Clear any obstructions from the sensor lens. ◦ Ensure motion occurs within the effective range of the sensor. ◦ Contact customer support if the sensor remains unresponsive.



Figure 5: The lamp's IP44 waterproof rating, indicating its resistance to splashing water.

10. WARRANTY AND CUSTOMER SUPPORT

ASDNN products are manufactured to high-quality standards. If you encounter any issues or have questions regarding your Solar Outdoor Wall Lamp, please contact our customer support team. For assistance, please refer to the contact information provided with your purchase or visit the official ASDNN website. Our team is committed to providing support and will respond to inquiries within 24 hours. Please retain your proof of purchase for any warranty claims.