



[Manuals.plus](#) /

> [BANDAI SPIRITS](#) /

> Bandai Hobby - AMAIM: Warrior at The Borderline - 01 MAILeS KENBU, Bandai Spirits HG 1/72 Model Kit User Manual

BANDAI SPIRITS 2572078

MAILeS KENBU HG 1/72 Model Kit User Manual

Model: 2572078 | Brand: BANDAI SPIRITS

INTRODUCTION

This manual provides detailed instructions for the assembly, handling, and maintenance of your Bandai Spirits HG 1/72 MAILeS KENBU model kit. The MAILeS KENBU unit, from AMAIM: Warrior at The Borderline, features a design developed with functional aspects in mind, allowing for a wide range of dynamic poses.

SAFETY INFORMATION

Warning: This product contains small parts which may pose a choking hazard. Keep out of reach of small children. Recommended age for assembly is 15 years and up.

PACKAGE CONTENTS

Verify that all components are present before beginning assembly.

- MAILeS KENBU HG 1/72 Model Kit parts
- Portable 2.36" Autocannon x1
- Super-heated Vibrating Straight Sword x1
- Shield dagger x1
- Weapon rack x1
- Hand parts: Open hands (left and right), Weapon holding hands (left and right), Gun holding hand (right)
- Unfinished State recreation parts x1
- Stickers x1



Figure 1: The product box for the MAILeS KENBU model kit, showing the assembled model and accessories.

ASSEMBLY (SETUP)

Assembly of this model kit requires precision and attention to detail. Basic hobby tools such as plastic nippers and a hobby knife are recommended for optimal results. Follow the included graphical instructions for step-by-step guidance.

General Assembly Steps:

1. **Part Preparation:** Carefully cut each part from its runner using plastic nippers. Trim any excess plastic (nubs) with a hobby knife for a clean finish.
2. **Torso Assembly:** Begin by assembling the core torso unit, ensuring all internal mechanisms and joints are correctly aligned.
3. **Head Assembly:** Construct the head unit, paying close attention to the intricate camera details.
4. **Arm Assembly:** Assemble the arm sections, incorporating the unique cantilever structure that allows for deep bending and natural weapon handling.
5. **Leg Assembly:** Construct the leg units, ensuring proper articulation for dynamic posing.
6. **Weapon Assembly:** Assemble the Portable 2.36" Autocannon and Super-heated Vibrating Straight Sword.
7. **Final Assembly:** Attach the assembled head, arms, and legs to the torso. Secure weapons and accessories as desired.
8. **Sticker Application:** Apply the included stickers according to the instruction manual for enhanced detail.



Figure 2: The MAiLeS KENBU model kit fully assembled, showcasing its detailed design.

FEATURES

The MAiLeS KENBU model kit incorporates several design elements for enhanced realism and poseability:

- **Cantilever Arm Structure:** The upper arm and forearm sections are connected with a unique cantilever structure, enabling deep arm bends. This design facilitates natural weapon handling, allowing the unit to retrieve equipment from its back with realistic motion.
- **Detailed Camera Design:** Three cameras are designed on each side of the head. The lower surface features a concave

design for upward vision, the upper surface for downward vision, and a triangular surface at the corner of the eye for capturing front images. These details are faithfully recreated in 1/72 scale.

- **Unfinished State Recreation:** Includes parts to recreate the unit's 'Unfinished State', which can be attached to the shoulder and left arm.
- **Extensive Articulation:** The model boasts a wide range of articulation points, allowing for dynamic and expressive posing.

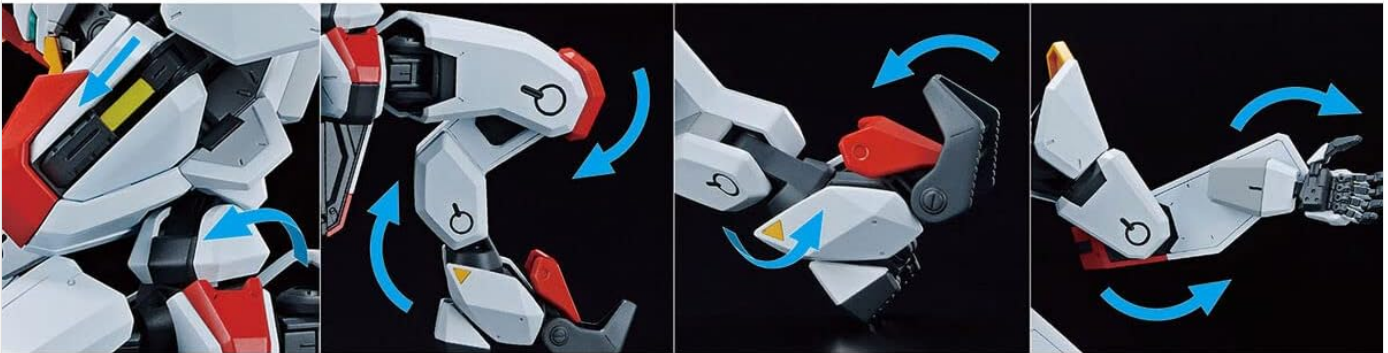

©2021 SUNRISE BEYOND INC.

Figure 3: Illustration of the arm's articulation, demonstrating the deep bending capability provided by the cantilever structure.

POSING AND DISPLAY (OPERATING)

The MAILeS KENBU model is designed for extensive poseability. Gently manipulate the joints to achieve desired stances. Avoid excessive force to prevent damage.

- **Weapon Handling:** Utilize the weapon holding hands to equip the Portable 2.36" Autocannon and Super-heated Vibrating Straight Sword. The arm's cantilever structure allows for realistic weapon drawing and wielding poses.
- **Dynamic Poses:** The model can achieve various dynamic poses, such as kneeling, running, or combat stances.
- **Action Base Compatibility:** For aerial or more complex dynamic poses, an action base (sold separately) can be used to support the model.

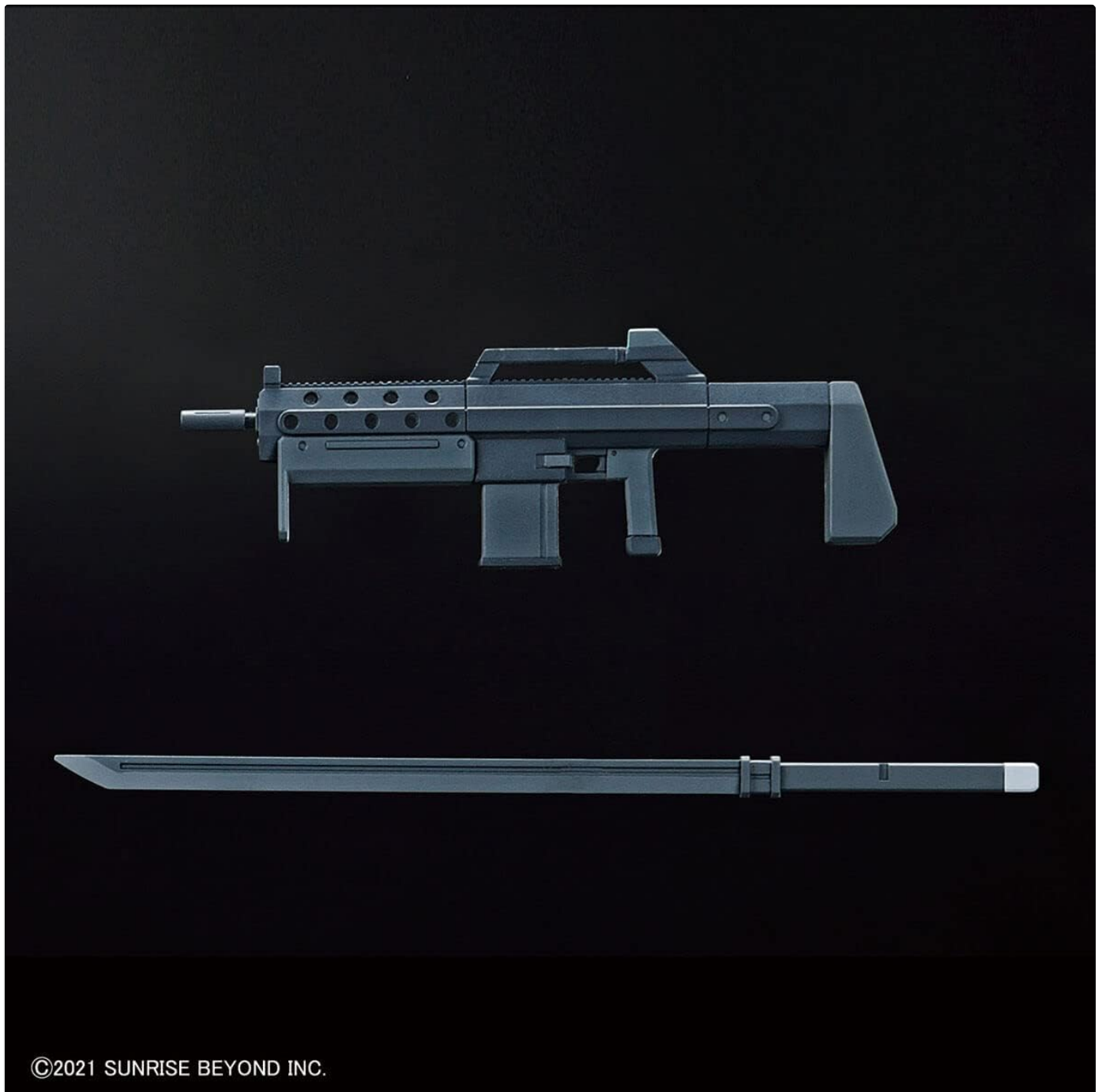

Figure 4: MAiLeS KENBU in a dynamic pose with its sword.



©2021 SUNRISE BEYOND INC.

Figure 5: MAiLeS KENBU in a kneeling position, equipped with the autocannon.



©2021 SUNRISE BEYOND INC.

Figure 6: The Portable 2.36" Autocannon and Super-heated Vibrating Straight Sword.

CARE AND MAINTENANCE

Proper care will ensure the longevity and appearance of your model kit.

- **Cleaning:** Dust the model regularly with a soft brush or a can of compressed air. Avoid using harsh chemicals or abrasive materials.
- **Handling:** Always handle the model by its main body parts. Avoid gripping small, delicate components or accessories too tightly.
- **Storage:** Store the model in a cool, dry place away from direct sunlight, which can cause plastic discoloration or warping.
- **Joint Maintenance:** If joints become loose over time, a small amount of clear nail polish or hobby-specific joint tightener can be applied to the ball joints and allowed to dry to restore friction.

TROUBLESHOOTING

Common issues encountered during model kit assembly and display:

- **Parts Not Fitting:** Ensure parts are correctly oriented and that any excess plastic (nubs) has been fully removed. Do not force parts together.
- **Missing Parts:** Double-check the runners and packaging. If a part is genuinely missing, refer to the support information below.
- **Loose Joints:** As mentioned in maintenance, apply a thin coat of clear nail polish or joint tightener to the male end of the joint and allow it to dry completely before reassembling.
- **Stickers Not Adhering:** Ensure the surface is clean and dry before applying stickers. Use tweezers for precise placement.

SPECIFICATIONS

Attribute	Detail
Brand	BANDAI SPIRITS
Model Name	Bandai Hobby HG - 01 Mailes Kenbu [AMAIM: Warrior at the Borderline]
Item Model Number	2572078
Scale	1/72
Material	Plastic
Color	Multi
Item Dimensions (L x W x H)	2.2 x 4.5 x 10.5 inches
Item Weight	12.3 ounces
Number of Pieces	1 (referring to the complete model kit)
Manufacturer Recommended Age	15 years and up
Date First Available	October 12, 2021

SUPPORT AND WARRANTY

For product support assistance within the United States, purchasers of officially licensed Bandai products distributed by Bluefin are entitled to support. The product box will feature a Bluefin / Bandai Namco warning label as proof of an officially licensed product. Please retain your proof of purchase.

For further inquiries or assistance, please contact the authorized distributor or refer to the contact information provided on the product packaging.