

WOODBIDGE BTA1536

WOODBIDGE BTA1536 Freestanding Bathtub User Manual

Model: BTA1536

1. INTRODUCTION

Thank you for choosing the WOODBRIDGE BTA1536 Freestanding Bathtub. This manual provides essential information for the safe installation, operation, and maintenance of your new bathtub. Please read all instructions carefully before installation and retain this manual for future reference.

2. IMPORTANT SAFETY INFORMATION

WARNING: Risk of personal injury. Please observe the following precautions:

- Installation must be performed by a qualified and licensed professional.
- Ensure the floor structure can support the weight of the bathtub when filled with water and occupied.
- Do not use abrasive cleaners or tools that could damage the acrylic surface.
- Always test water temperature before entering the bathtub to prevent scalding.
- Children and individuals with limited physical capabilities should be supervised when using the bathtub.
- The bathtub features an anti-slip bottom design to meet ASTM standards and enhance user safety.

3. PACKAGE CONTENTS

Your WOODBRIDGE BTA1536 Freestanding Bathtub package includes:

- Freestanding Bathtub (1 unit)
- Drain and Overflow Cover (1 set)
- Installation Manual for Bathtub and Drain Kit (1 copy)

Please inspect all components for damage or missing parts before installation. Contact customer support immediately if any items are missing or damaged.

4. PRODUCT SPECIFICATIONS

Feature	Detail
---------	--------

Feature	Detail
Model Number	BTA1536
Exterior Dimensions (L x W x H)	59" x 29-3/4" x 22-1/2"
Basin Seating Dimensions (L x W)	41" x 18"
Water Depth	17-3/4"
Material	100% high gloss white LUCITE acrylic, reinforced with ASHLAND resin & fiberglass
Bearing Capacity	Up to 1000 LBS (with stainless steel bracket)
Insulation	Double Walled reinforce design for maximum insulation
Drain System	Fully integrated sealed overflow and drain system
Bottom Design	Anti-slip (meets ASTM standards)
Installation Type	Freestanding
Item Weight	142 pounds
Certifications	CSA B45.5-17/IAPMO Z124-2017, Massachusetts Plumbing & Gas Code approved

WOODBIDGE®

B1536/BTA1536

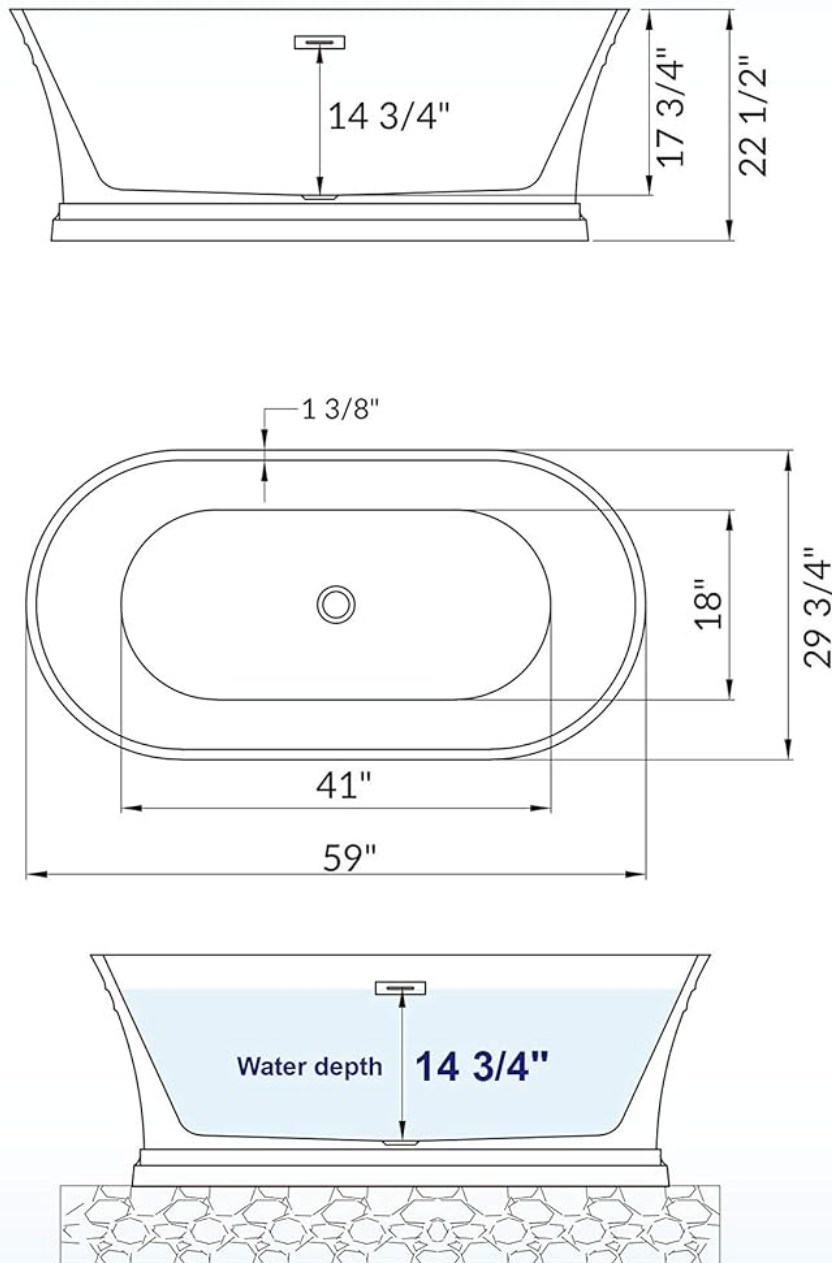

IMPORTANT INFORMATION

- Measurements are $\pm 1/2"$ and subject to change without notice
- Specifications & Configurations are subject to change without notice
- Please measure tub on-site before installation
- Please note that installer(s) must be certified or warranty will be voided
- Measurements herein supersede all others published prior to publication date shown below
- Before ordering or installing, please consider future access to equipment

www.woodbridgebath.com

Figure 1: Detailed dimensions of the WOODBRIDGE BTA1536 Freestanding Bathtub.

5. INSTALLATION

Proper installation is crucial for the performance and longevity of your bathtub. It is highly recommended that installation be performed by a licensed professional.

5.1 Pre-Installation Checklist

- Verify all package contents are present and undamaged.
- Ensure the installation area is clean, level, and has adequate structural support.
- Confirm plumbing connections (hot/cold water supply and drain) are correctly positioned according to local codes.
- Review local plumbing codes and regulations.

5.2 Drain and Overflow Finish Options

The BTA1536 bathtub offers various drain and overflow finish options to match your bathroom decor. Ensure you have the correct finish for your installation.

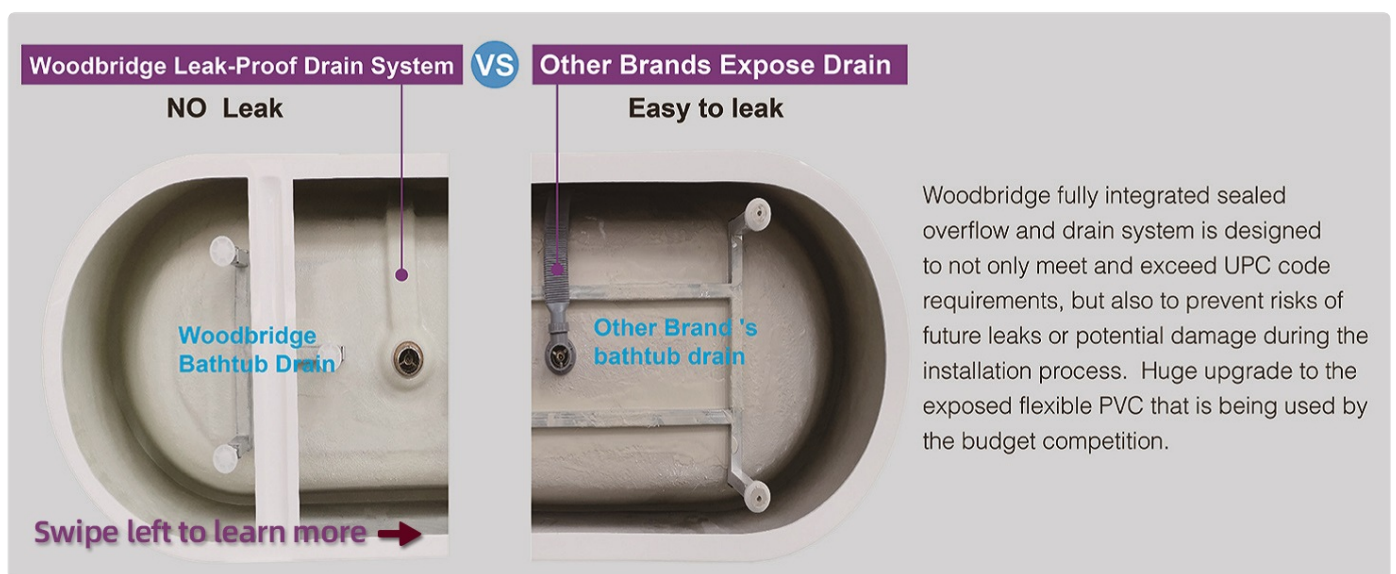

Figure 2: Available drain and overflow finish options. Each bathtub comes with one finish only.

5.3 Installation Video Guide

For a visual guide on the installation process, please refer to the official WOODBRIDGE installation video below. This video demonstrates the general installation steps for freestanding bathtubs.

Video 1: General installation guide for WOODBRIDGE freestanding bathtubs. This video covers steps for both underfloor access and slab floor installations.

5.4 Step-by-Step Installation Overview

1. **Prepare the Area:** Position the bathtub in its desired location. Mark the outline of the tub on the floor with an erasable pencil.
2. **Overflow Trim Installation:** Apply clear silicone caulking to the tub overflow trim piece. Hold it in place and confirm it is inserted flat and level. Secure with blue painter's tape until cured (24 hours).
3. **Drain Assembly:** Fill the grooved gasket with silicone and install it with the groove and silicone facing up. Tighten the drain nut in place, ensuring it is snug but not overtightened.
4. **Leveling the Bathtub:** Use a 24-inch level to adjust the bathtub legs. Leave a 1/8" to 1/4" gap between the rim of the tub and the level. Loosen the nuts, adjust the legs, and then tighten the nuts to secure the legs in place.
5. **Connect to Drainage System:** Attach your flanged tail piece (provided by installer) to the tub drain and tighten.

Connect the tub's drain to the floor drain system.

6. **Leak Testing:** Push the pop-up drain into a closed position. Fill the bathtub with cold water above the overflow level. Check for any leaks around the drain and pipe connections.
7. **Final Placement:** Apply silicone caulking to the base rim of the tub and carefully lower the tub into its final position, ensuring it aligns with the marked outline and the drain connection.

6. OPERATING INSTRUCTIONS

6.1 Filling the Bathtub

1. Ensure the drain stopper is in the closed position.
2. Turn on the water supply to the desired temperature and fill the bathtub.
3. Do not overfill the bathtub. The integrated overflow system will prevent excessive water levels.

6.2 Draining the Bathtub

1. To drain the bathtub, open the drain stopper.
2. Ensure the water drains completely after each use.

7. MAINTENANCE AND CLEANING

To maintain the pristine condition of your WOODBRIDGE BTA1536 bathtub, follow these guidelines:

- **Regular Cleaning:** Clean the bathtub regularly with a soft cloth and a non-abrasive cleaner. Avoid harsh chemicals, abrasive pads, or scouring powders as they can damage the acrylic surface.
- **Stain Removal:** For stubborn stains, use a mild household cleaner specifically designed for acrylic surfaces. Always test the cleaner on an inconspicuous area first.
- **Preventing Scratches:** Avoid dropping sharp or heavy objects into the tub. Do not use the tub as a cutting surface.
- **Water Spots:** Wipe down the tub after each use to prevent water spots and mineral buildup.
- **Drain Maintenance:** Periodically remove and clean the drain stopper to prevent clogs.



Figure 3: The WOODBRIDGE fully integrated sealed overflow and drain system is designed to prevent leaks.

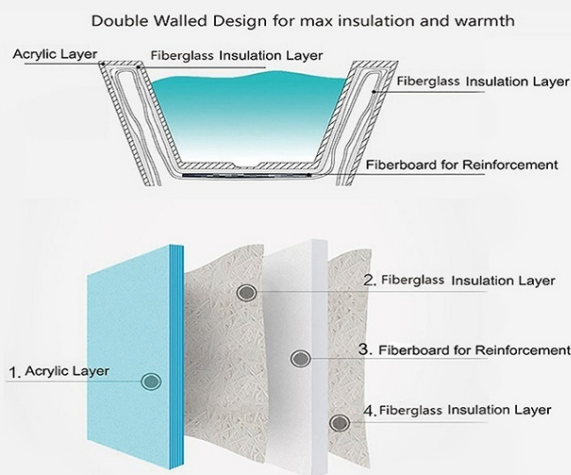

Most Durable Acrylic Tub on the market

WOODBIDGE Lucite acrylic tubs are reinforced further in a number of ways. Firstly, two layers of lucite acrylic material is used. Secondly there is a layer of 3-4 mm thick resin fibreglass mix to help keep the tub rigid.

Figure 4: The non-slip bottom design provides added safety during bathing.

8. TROUBLESHOOTING

Problem	Possible Cause	Solution
Water leaks from drain/overflow.	Loose connections, improper sealing.	Check all drain and overflow connections for tightness. Reapply silicone sealant if necessary. Ensure gaskets are correctly seated.
Bathtub is not level.	Adjustable legs are not properly set.	Adjust the leveling feet on the bottom of the tub until the tub is stable and level. Refer to installation steps.
Slow draining.	Drain clog or obstruction.	Remove the drain stopper and clear any hair or debris. Use a non-corrosive drain cleaner if needed.
Surface scratches.	Abrasive cleaning or impact.	Minor scratches on acrylic can often be buffed out with a fine-grit polishing compound designed for acrylic. Consult a professional for deeper scratches.

9. WARRANTY INFORMATION

WOODBIDGE warrants a 1-Year limited warranty to be free of defects in material and workmanship. This warranty covers manufacturing defects under normal use and service. Please retain your proof of purchase for warranty claims.

10. CUSTOMER SUPPORT

For any sales, product-oriented queries, installation assistance, or replacement parts, please contact the WOODBRIDGE US-based product support team. Our friendly team is ready to assist you.



Figure 5: Contact our US-based support team for assistance.

You can also visit the official WOODBRIDGE Store for more information and products:[WOODBRIDGE Store](#)