

Okin JLDQ.11.156.333P

Okin Model JLDQ-11 & JLDQ.11.156.333P Power Recliner Lift Chair Motor Instruction Manual

Model: JLDQ.11.156.333P

1. INTRODUCTION

This manual provides essential information for the safe and effective installation, operation, and maintenance of your Okin Model JLDQ-11 & JLDQ.11.156.333P Power Recliner Lift Chair Motor. Please read these instructions thoroughly before proceeding with installation or use.

2. PRODUCT OVERVIEW

The Okin JLDQ.11.156.333P is a replacement actuator motor designed for power recliners and lift chairs. It is an original Okin JLDQ motor, suitable for replacing existing JLDQ.11.156.333P units.

Key Features:

- **Motor Type:** Linear actuator for recliner mechanisms.
- **Components:** Consists of one motor and three distinct connectors.
- **Appearance:** Black (PA) housing with a silver-white (aluminum) shaft.
- **Stroke:** 333mm.
- **Minimum Dimensions (Shrink):** 156mm.
- **Maximum Dimensions (Extended):** 489mm.
- **Load Capacity:** Push force: 650N, Pull force: 650N (approximately 146 lbs).
- **Operation Frequency:** On 1 minute / Off 8 minutes.
- **Speed:** 29VDC SMPS, 7 seconds without load.



Figure 1: The Okin JLDQ.11.156.333P power recliner motor, showing its main body and connected cables.

Product Features

Made of:

1 motor and 3 connectors

Appearance:

black (PA), silver white
(aluminum)

Stroke: 333 mm

Minimum dimension:

156 mm

Maximum dimension:

489 mm



*Easy to install and
quiet in operation*

Figure 2: Graphic illustrating key product features including dimensions and components.

3. SPECIFICATIONS

Attribute	Detail
Brand	Okin
Model Number	JLDQ.11.156.333P
Color	Black
Stroke	333mm
Minimum Dimensions (Shrink)	156mm
Maximum Dimensions (Extended)	489mm
Load Capacity (Push/Pull)	650N (approx. 146 lbs)
Operation Frequency	On 1 min / Off 8 min
Power Supply Speed	29VDC SMPS, 7 sec without load

Item Weight	5.5 pounds
Product Dimensions	22 x 6.7 x 3.5 inches



Figure 3: Detailed view of the motor's identification label, showing model number, voltage, and certifications.

4. SAFETY INFORMATION

Important Safety Precautions:

- **Weight Capacity:** This product has a maximum weight capacity of approximately 146 lbs (650N). Exceeding this weight capacity may result in reduced product performance or potential safety risks.
- **Stable Surface:** Always ensure the chair is used on a stable, hard floor surface.
- **Design Limits:** Do not subject the motor or chair to forces exceeding its design limits.
- **Electrical Safety:** Ensure all electrical connections are secure and conform to local electrical codes. Disconnect power before performing any maintenance or installation.
- **Children and Pets:** Keep children and pets away from moving parts during operation.

5. INSTALLATION

This motor is designed as a direct replacement for Okin Model JLDQ.11.156.333P. Compatibility with other models or brands is not guaranteed due to variations in frame requirements, minimum install dimensions,

stroke, and plug types. Verify your existing motor's brand and model number before installation.

Installation Steps:

1. **Preparation:** Disconnect the recliner from its power source. Position the recliner to access the motor area safely.
2. **Identify Connections:** The motor set includes three types of connectors:
 - A 5-pin round plug for the switch hand control.
 - A 2-pin square plug with a clip for the power supply.
 - A 2-pin socket for a slaved motor (if applicable).
3. **Remove Old Motor:** Carefully detach the old motor from the recliner frame. Retain all existing mounting hardware (bolts, nuts, pins) as this replacement motor does not typically include them.
4. **Mount New Motor:** Align the new Okin JLDQ.11.156.333P motor with the mounting points on the recliner frame. Secure it using the retained hardware. Ensure the motor is firmly attached and moves freely without obstruction.
5. **Connect Wiring:** Connect the 5-pin round plug to the hand control, the 2-pin square plug to the power supply, and the 2-pin socket to any slaved motor if your recliner uses one. Ensure all connections are snug.
6. **Test Operation:** Once installed and wired, reconnect the recliner to power. Test the motor's function using the hand control to ensure smooth and complete extension and retraction.

Note: If you are comfortable with basic mechanical tasks and have a socket wrench set and hex keys, you should be able to perform this installation. If unsure, consult a professional.

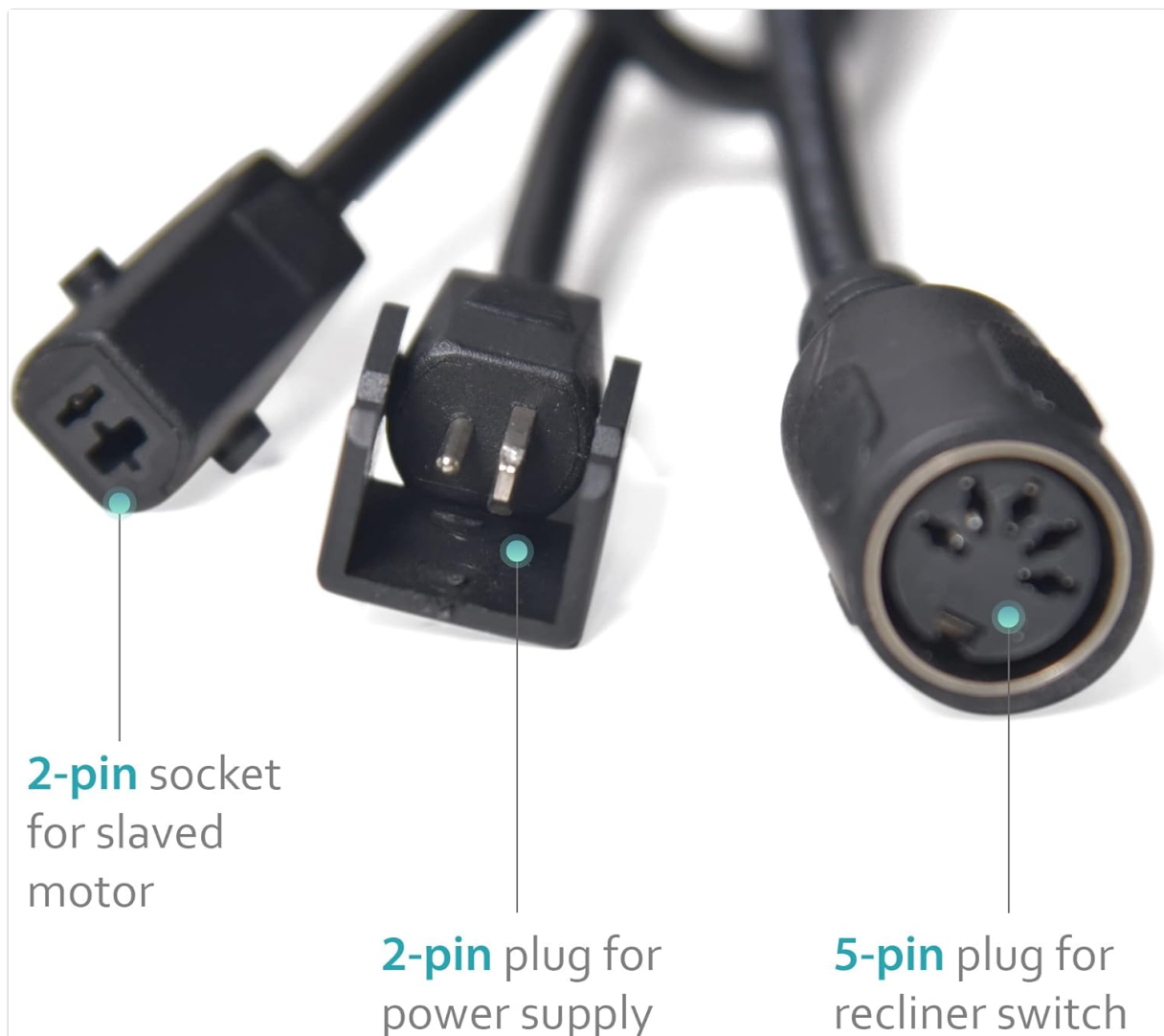

Figure 4: Detailed view of the motor's three connectors: 2-pin socket for slaved motor, 2-pin plug for power supply, and 5-pin plug for recliner switch.



Figure 5: The Okin JLDQ.11.156.333P motor with its linear actuator rod in the extended position.



Figure 6: The Okin JLDQ.11.156.333P motor with its linear actuator rod in the retracted position.

6. OPERATION

Once correctly installed, the Okin JLDQ.11.156.333P motor operates in conjunction with your recliner's existing hand control. Pressing the appropriate buttons on the hand control will activate the motor, causing the recliner mechanism to extend or retract.

- Ensure the recliner is connected to a functional power outlet.
- Use the hand control to adjust the recliner to your desired position.
- Avoid continuous operation for more than 1 minute to prevent overheating. Allow an 8-minute rest period between extended uses.

7. MAINTENANCE

Regular maintenance helps ensure the longevity and optimal performance of your Okin recliner motor.

- **Cleaning:** The motor housing can be spot cleaned with a dry or slightly damp cloth. Avoid using harsh chemicals or excessive moisture.
- **Inspection:** Periodically inspect the motor and its connections for any signs of wear, damage, or loose wiring.
- **Lubrication:** The internal components of the motor are factory-lubricated and generally do not require additional lubrication. If unusual noises occur, consult a professional.
- **Environmental Conditions:** Ensure the motor is used in an indoor environment, as specified by the manufacturer.

8. TROUBLESHOOTING

If your recliner motor is not functioning as expected, perform the following basic troubleshooting steps:

1. **Check Power Supply:** Ensure the recliner is properly plugged into a working electrical outlet. Verify that the power supply unit (transformer) is receiving power and its indicator light (if present) is on.
2. **Inspect Hand Control:** Test the hand control for responsiveness. Sometimes, a faulty hand control can prevent the motor from operating.
3. **Examine Connections:** Check all motor connections (5-pin for hand control, 2-pin for power, 2-pin for slaved motor) to ensure they are securely seated and not damaged.
4. **Motor Compatibility:** Confirm that the installed motor is indeed the correct Okin JLDQ.11.156.333P model, especially if it's a recent replacement. Incompatible motors will not function correctly.
5. **Obstructions:** Look for any physical obstructions preventing the recliner mechanism or motor rod from moving freely.



If these steps do not resolve the issue, it may indicate a more complex problem with the motor or electrical system. In such cases, it is recommended to contact a qualified technician or the manufacturer's support.



9. WARRANTY AND SUPPORT

For warranty information or technical support regarding your Okin JLDQ.11.156.333P Power Recliner Lift Chair Motor, please refer to the documentation provided at the time of purchase or contact Okin customer service directly. Ensure you have your model number (JLDQ.11.156.333P) and any purchase details available when seeking support.

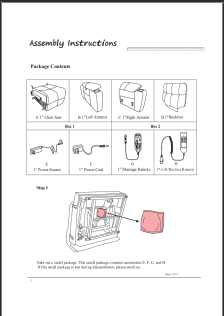
You can find more information about Okin products and support on their official channels or through authorized distributors.

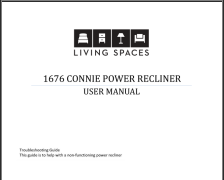
Related Documents - JLDQ.11.156.333P

 <p>The image shows the first page of assembly instructions for the YB2213 Power Lift Recliner Chair. It includes a 'Package Contents' list with items like 1x Chair Base, 1x Left Motor, 1x Right Motor, 1x Hand Control, 1x Power Cord, 1x Remote Control, and 1x Slaved Motor. Below this is 'Step 1' showing the chair base with a red motor being attached.</p>	<p>Assembly Instructions for YB2213 Power Lift Recliner Chair</p> <p>Step-by-step assembly guide for the YB2213 power lift recliner chair, including package contents, connection steps, and wiring instructions for power and remotes. Features heat and massage functions.</p>
 <p>The image shows the title page of the 'Lift Chair Series 9191 User Manual'. It includes a table of contents with sections like Introduction, Safety, Operation, Troubleshooting, and Index.</p>	<p>Lift Chair Series 9191 User Manual</p> <p>User manual for the Lift Chair Series 9191, providing instructions on assembly, operation, safety warnings, and troubleshooting.</p>
 <p>The image shows the title page of the '1676 Connie Power Recliner User Manual and Troubleshooting Guide Living Spaces'. It includes a table of contents with sections like Introduction, Safety, Operation, Troubleshooting, and Index.</p>	<p>1676 Connie Power Recliner User Manual and Troubleshooting Guide Living Spaces</p> <p>Comprehensive user manual and troubleshooting guide for the Living Spaces 1676 Connie Power Recliner. Includes component details, common issues, diagnostic steps, and solutions for power recliner malfunctions. Features part numbers and manufacturer information.</p>

<div><div></div><div>LIVING SPACES</div><div>1955 THORP LIFT CHAIR</div><div>USER MANUAL</div><div><small>Troubleshooting Guide This guide is to help with a non-functioning power recliner</small></div></div>	<p>1955 Thorp Lift Chair User Manual and Troubleshooting Guide</p> <p>Comprehensive user manual and troubleshooting guide for the Living Spaces 1955 Thorp Lift Chair, covering components, hand wand functions, motor issues, heat function, and general troubleshooting.</p>
<div><div></div><div>LIVING SPACES</div><div>1676 CONNIE POWER RECLINER</div><div>USER MANUAL</div><div><small>Troubleshooting Guide This guide is to help with a non-functioning power recliner</small></div></div>	<p>Living Spaces 1676 Connie Power Recliner User Manual and Troubleshooting Guide</p> <p>Comprehensive user manual and troubleshooting guide for the Living Spaces 1676 Connie Power Recliner, covering components, common issues, and solutions.</p>
<div><div></div><div>LIVING SPACES</div><div>1664 CICI POWER RECLINER</div><div>USER MANUAL</div><div><small>Troubleshooting Guide This guide is to help with a non-functioning power recliner</small></div></div>	<p>1664 CICI POWER RECLINER User Manual & Troubleshooting Guide</p> <p>Comprehensive user manual and troubleshooting guide for the Living Spaces 1664 CICI Power Recliner, covering components, common issues, and solutions.</p>