

EVGA 10G-P5-3897-KL

EVGA GeForce RTX 3080 FTW3 Ultra Gaming Graphics Card Instruction Manual

Model: 10G-P5-3897-KL

1. INTRODUCTION

This manual provides essential information for the installation, operation, and maintenance of your EVGA GeForce RTX 3080 FTW3 Ultra Gaming graphics card. Please read this manual thoroughly before installation to ensure proper setup and optimal performance.



Image: The EVGA GeForce RTX 3080 FTW3 Ultra Gaming graphics card alongside its retail packaging.

2. PRODUCT FEATURES

- **Real Boost Clock:** 1800 MHz for enhanced performance.
- **Memory Detail:** 10240 MB GDDR6X for high-speed data processing.
- **Real-Time RAY TRACING:** Experience cutting-edge, hyper-realistic graphics in supported games.
- **iCX3 Technology:** Advanced interactive cooling system with multiple thermal sensors and micro-control processors for optimized fan speed and temperature management.
- **ARGB LED:** Customizable RGB lighting for aesthetic personalization.
- **Metal Backplate:** Provides structural rigidity and aids in heat dissipation.



Image: The EVGA GeForce RTX 3080 FTW3 Ultra Gaming graphics card showcasing its customizable ARGB LED lighting.

3. SETUP AND INSTALLATION

3.1. What's in the Box

- EVGA GeForce RTX 3080 FTW3 Ultra Gaming Graphics Card
- Installation Guide
- Retention Bracket (for select chassis to prevent GPU sag)



GEFORCE® GTX GEFORCE® RTX

Installation Guide

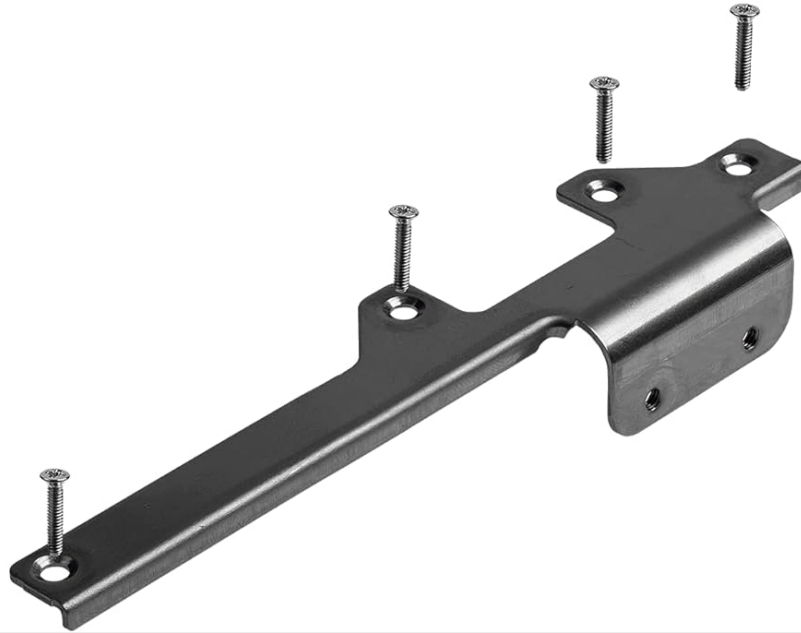

Image: The EVGA Installation Guide and the included retention bracket, designed to support the graphics card and prevent sag.

3.2. System Requirements

- PCI Express-compliant motherboard with one dual-width x16 graphics slot.
- Minimum 750W or greater power supply with three available 8-pin PCIe power connectors.
- Minimum 10GB system memory (RAM).
- Microsoft Windows 10 64-bit or Linux 64-bit operating system.
- Internet connection for driver installation and software updates.

3.3. Hardware Installation

1. **Prepare your System:** Power off your computer and disconnect all cables. Open your computer case.
2. **Locate PCIe Slot:** Identify an available PCI Express x16 slot on your motherboard.
3. **Remove Slot Covers:** Remove the two or three slot covers from the back of your computer case corresponding to the PCIe slot.
4. **Install Graphics Card:** Carefully align the graphics card with the PCIe slot and press down firmly until it is securely seated. Ensure the PCIe retention clip locks into place.
5. **Secure Card:** Use screws to secure the graphics card to the computer case.
6. **Connect Power:** Connect three 8-pin PCIe power connectors from your power supply to the graphics card. Ensure all connections are firm.

7. **Install Retention Bracket (Optional):** If your chassis supports it and you experience GPU sag, install the provided retention bracket as per the separate instructions.
8. **Close Case:** Close your computer case and reconnect all cables.

3.4. Software and Driver Installation

1. **Power On:** Turn on your computer.
2. **Install Drivers:** Download the latest graphics drivers from the official NVIDIA website ([nvidia.com/drivers](https://www.nvidia.com/drivers)) or the EVGA website ([evga.com/drivers](https://www.evga.com/drivers)). Follow the on-screen instructions for installation.
3. **Install EVGA Precision X1:** For advanced monitoring, overclocking, and ARGB LED control, download and install EVGA Precision X1 software from the EVGA website.

4. OPERATING YOUR GRAPHICS CARD

Your EVGA GeForce RTX 3080 FTW3 Ultra is designed for high-performance computing tasks, including:

- **Gaming:** Enjoy the latest titles with high frame rates and advanced graphics features like Ray Tracing.
- **Content Creation:** Accelerate video editing, 3D rendering, and graphic design workflows.
- **Streaming:** Utilize NVIDIA's NVENC encoder for efficient, high-quality game streaming with minimal performance impact.

Use EVGA Precision X1 to monitor GPU temperatures, adjust fan curves, and customize the ARGB LED lighting to match your system's aesthetic.

5. MAINTENANCE

- **Dust Removal:** Regularly clean dust from the graphics card fans and heatsink using compressed air. Ensure the system is powered off before cleaning.
- **Driver Updates:** Keep your graphics drivers updated to ensure optimal performance and compatibility with new games and applications.
- **Software Monitoring:** Use EVGA Precision X1 to monitor temperatures and fan speeds. Ensure fans are operating correctly and temperatures remain within safe limits during heavy loads.
- **System Airflow:** Maintain good airflow within your PC case to prevent heat buildup, which can affect GPU performance and longevity.

6. TROUBLESHOOTING

- **No Display/Black Screen:**
 - Ensure the graphics card is fully seated in the PCIe slot.
 - Verify all PCIe power connectors are securely attached.
 - Check that your monitor cable is connected to the graphics card, not the motherboard's integrated graphics port.
- **Performance Issues/Low FPS:**
 - Ensure the latest graphics drivers are installed.
 - Check GPU temperatures using monitoring software; overheating can cause performance throttling.
 - Verify your power supply meets the minimum wattage requirement (750W recommended).
 - Close unnecessary background applications.

- **Fan Noise/Ticking:**

- Inspect fans for any obstructions (e.g., loose cables).
- Adjust fan curves in EVGA Precision X1 to find a balance between cooling and noise.

- **GPU Sag:**

- Utilize the included retention bracket or a third-party GPU support bracket to prevent the card from bending under its own weight.

7. SPECIFICATIONS

Feature	Detail
Brand	EVGA
Model Number	10G-P5-3897-KL
Graphics Coprocessor	NVIDIA GeForce RTX 3080
Graphics Card RAM Size	10 GB GDDR6X
Memory Speed	19000 MHz
Real Boost Clock	1800 MHz
Max Screen Resolution	3840x2160
Video Output Interface	DisplayPort, HDMI
Item Weight	4.6 pounds
Product Dimensions	14.9 x 9.3 x 4.3 inches







8. WARRANTY AND SUPPORT

For warranty information and technical support, please refer to the official EVGA website or contact EVGA customer service directly. It is recommended to register your product upon purchase to facilitate any future support needs.

EVGA Support Website: [evga.com/support](https://www.evga.com/support)



Related Documents - 10G-P5-3897-KL

	<p>EVGA GeForce RTX 3080 Ti FTW3 Ultra Gaming Quick Start Guide and Warranty</p> <p>Quick start guide for the EVGA GeForce RTX 3080 Ti FTW3 Ultra Gaming (12G-P5-3967-KR), covering minimum system requirements, operating system compatibility, included equipment, and EVGA's limited warranty for Australia and New Zealand. Includes HDMI information and RoHS compliance details.</p>
	<p>EVGA GeForce RTX 2080 Ti KINGPIN Edition OC Guide: Overclocking, Performance, and Features</p> <p>Detailed overclocking guide for the EVGA GeForce RTX 2080 Ti KINGPIN Edition graphics card. Covers advanced power design, 12-layer PCB benefits, watercooling, performance benchmarks, EVGA Precision X1 software, and probe points for extreme overclocking.</p>
	<p>EVGA X58 FTW3 Motherboard Installation and Visual Guide</p> <p>A comprehensive visual guide for installing and setting up the EVGA X58 FTW3 motherboard, covering CPU, RAM, graphics card, power, and system startup. Includes component identification, package contents, and support information.</p>
	<p>EVGA Graphics Card User Guide - Installation, Setup, and Support</p> <p>Comprehensive user guide for EVGA graphics cards, covering installation, software setup, SLI configuration, troubleshooting, and support resources. Includes details on hardware installation, driver installation, multiple display setups, and compliance information.</p>
	<p>EVGA GeForce GTX 1080 Ti SC HYBRID Installation Guide</p> <p>This guide provides step-by-step instructions for installing the EVGA GeForce GTX 1080 Ti SC HYBRID Cooling Kit. It covers component identification, disassembly of the original graphics card cooler, and assembly of the new HYBRID module, including radiator mounting and cable connections. Important information regarding warranty and compatibility is also provided.</p>
	<p>EVGA Graphics Card User Guide: Installation, Setup, and Support</p> <p>Comprehensive user guide for EVGA graphics cards, covering installation, software setup, SLI configuration, troubleshooting, and support resources. Includes details on hardware installation, power requirements, and compliance information.</p>



Graphic Card Compatible List

ASUS	
ROG STRIX RTX3080-O 10G-WHITE-V2	REG-STRIX-RTX3080-O10G-V2-GAMING
ROG STRIX RTX3080-10G-WHITE-V2	REG-STRIX-RTX3080-O10G-V2-GAMING
ROG STRIX RTX3080-O 10G-V2-GAMING	TUF-RTX3080-O10G-V2-GAMING
ROG STRIX RTX3080-10G-V2-GAMING	TUF-RTX3080-O10G-V2-GAMING
ROG STRIX RTX3080-O 8G-V2-GAMING	DUAL-RTX3080-O8G-MINI-V2
ROG STRIX RTX3080-8G-WHITE-V2	DUAL-RTX3080-O8G-MINI-V2
ROG STRIX RTX3080-8G-WHITE-V2	RO-RTX3080-O8G-V2-GAMING
ROG STRIX RTX3080-8G-V2-GAMING	TUF Gaming GeForce RTX™ 3080 V2
ROG STRIX RTX3070-O 8G-WHITE-V2	DUAL-RTX3070-O8G-MINI-V2
ROG STRIX RTX3070-8G-WHITE-V2	DUAL-RTX3070-O8G-MINI-V2
ROG STRIX RTX3070-8G-V2-GAMING	RO-RTX3070-O8G-V2-Gaming
ROG STRIX RTX3070-O 8G-V2-GAMING	RO-RTX3070-O8G-V2-Gaming
ROG STRIX RTX3070-O 12G-GAMING	DUAL-RTX3070-O12G-V2
TUF-RTX3070-O8G-GAMING	TUF-RTX3070-O8G-V2-GAMING
TUF-RTX3070-12G-GAMING	DUAL-RTX3070-O12G-V2
TUF-RTX3070-8G-GAMING	TUF-RTX3070-O8G-GAMING
RO-RTX3060-12G	DUAL-RTX3060-O12G
RO-RTX3060-O12G-GAMING	DUAL-RTX3060-O12G
RO-RTX3060-12G-GAMING	DUAL-RTX3060-O12G
DUAL-RTX3060-O12G	RO-RTX3060-O12G-GAMING
DUAL-RTX3060-12G	RO-RTX3060-O12G-GAMING
TUF-RTX3060-12G	RO-RTX3060-RTX3070-8G-WHITE
TUF-RTX3060-12G-GAMING	RO-RTX3060-RTX3070-8G-WHITE
ROG STRIX RTX3060-12G-GAMING	RO-RTX3060-RTX3070-8G-WHITE
ROG STRIX RTX3060-O 12G-GAMING	RO-RTX3060-RTX3070-8G-WHITE
DUAL-RTX™ 3060Ti-8G-MINI	RO-RTX3060-RTX3070-8G-WHITE
DUAL-RTX™ 3060Ti-8G-MINI	RO-RTX3060-RTX3070-8G-WHITE
TUF-RTX3060-8G	RO-RTX3060-RTX3070-8G-WHITE
RTX3060-8G-EK	RTX3060-8G-EK
ROG STRIX GeForce RTX 3060-GUNDAMP EDITION	RO-RTX3060-RTX3070-8G-WHITE
ROG STRIX GeForce RTX 3060-GUNDAMP EDITION	RO-RTX3060-RTX3070-8G-WHITE
ROG STRIX RTX3060Ti-8G-GAMING	RO-RTX3060-RTX3070-8G-WHITE
ROG STRIX RTX3060-O 8G-GAMING	RO-RTX3060-RTX3070-8G-WHITE
TUF-RTX3060-8G-GAMING	RO-RTX3060-RTX3070-8G-WHITE
TUF-RTX3060-8G-GAMING	RO-RTX3060-RTX3070-8G-WHITE

[pdf]

iris zhang Graphic Card Compatible List BitFenix GPU Compatibility rog strix rtx3090 o24g gaming tuf

rtx3080 o10g dual rtx3070 8g 24g msi geforce rtx™ 3090 x trio LiveKernelEvent 141 dwm exe appcrash

Kernelbase.dll Page 2 PC Help Forum Well I just discovered something was thinking maybe need drivers

for my fans then looked into center of official source didn't find anything so started looking what there like

bitfenix 02 Chassis Micro ATX Prodigy M 2022 |||

Graphic Card Compatible List ROG-STRIX-RTX3080-O10G-WHITE-V2 ROG-STRIX-RTX3080-10G-WHITE-V2 ROG-STR ... R, 10GB GDDR6X, iCX3 Technology, ARGB

LED, Metal Backplate EVGA GeForce RTX 3080 FTW3 ULTRA GAMING, **10G-P5-**

3897-KL, 10GB GDDR6X, iCX3 Technology, ARGB LED, Metal Backplate, LHR

EVGA GeForce RTX 3080 F...

lang:tl score:21 filesize: 128.14 K page_count: 6 document date: 2021-08-13