

PENMAMA WL-0233

PENMAMA Window Locks Instruction Manual

Model: WL-0233

1. INTRODUCTION

Thank you for choosing PENMAMA Window Locks. This manual provides essential information for the safe and effective installation and use of your new window locks. Designed for vertical and horizontal sliding windows, these locks enhance security and child safety without requiring permanent modifications.

2. PRODUCT FEATURES

- **Durable Aluminum Construction:** Made from heavy-duty extruded aluminum alloy for long-lasting performance.
- **Rubber Cushioning:** Features soft rubber padding inside to prevent scratches and enhance grip on window frames.
- **Tool-Free Installation:** Clamps securely to window tracks using dual screws and an included hex key, requiring no drilling.
- **Adjustable Security:** Allows for full window closure or limited opening for ventilation while maintaining security.
- **Enhanced Safety:** Ideal for preventing accidental openings by children or pets, and deterring intruders.
- **Visible Key Handle:** Bright yellow key handles are easy to locate and use.

3. PACKAGE CONTENTS

- 4 x PENMAMA Window Locks (with built-in rubber pads)
- 4 x Yellow Hex Keys



Figure 1: Package Contents and Dimensions

4. COMPATIBILITY

PENMAMA Window Locks are designed for:

- Vertical sliding windows
- Horizontal sliding windows
- Sliding doors with flat tracks

Important: Not compatible with tracks over 0.67 inches (17mm) thick. Please measure your window or door track before purchase to ensure proper fit.

5. SAFETY INFORMATION

- Always ensure the locks are securely tightened to prevent accidental opening.
- Keep hex keys out of reach of children to maintain child safety features.
- Regularly check the tightness of the screws to ensure continued security.
- These locks are a deterrent and should be used in conjunction with other home security measures.

Sliding window locks



Let your children play happily.
keep your kid's and pet safety.

Figure 2: Enhancing Home Safety and Child Protection

6. SETUP & INSTALLATION

Installation of the PENMAMA Window Locks is tool-free and straightforward. Follow these steps:

1. **Prepare the Lock:** The lock comes with a removable rubber lining. Ensure it is properly seated inside the U-shaped channel of the lock to protect your window frame.
2. **Position the Lock:** Place the lock onto the window track at your desired position. This can be to fully secure the window when closed, or to limit its opening for ventilation.
3. **Tighten the Screws:** Insert the yellow hex key into the screws on the side of the lock. Turn clockwise to tighten the screws firmly against the window track. Ensure both screws are tightened evenly for maximum security.
4. **Verify Security:** After tightening, attempt to move the window. The lock should prevent any movement beyond the set position.



Figure 3: Easy Installation Steps

Installation Demonstration Video

Your browser does not support the video tag.

Video 1: Visual guide demonstrating the installation of the PENMAMA Window Lock on a sliding window.

Detailed Installation and Security Review

Your browser does not support the video tag.

Video 2: A comprehensive review including installation steps and a demonstration of the lock's security features.

7. OPERATION

To operate the PENMAMA Window Lock:

- **To Lock:** Position the window as desired (fully closed or partially open for ventilation). Place the lock on the track and use the hex key to tighten the two screws until the lock is firmly secured and the window cannot move.
- **To Unlock/Adjust:** Insert the hex key into the screws and turn counter-clockwise to loosen them. Once loosened, the lock can be removed or repositioned along the track.

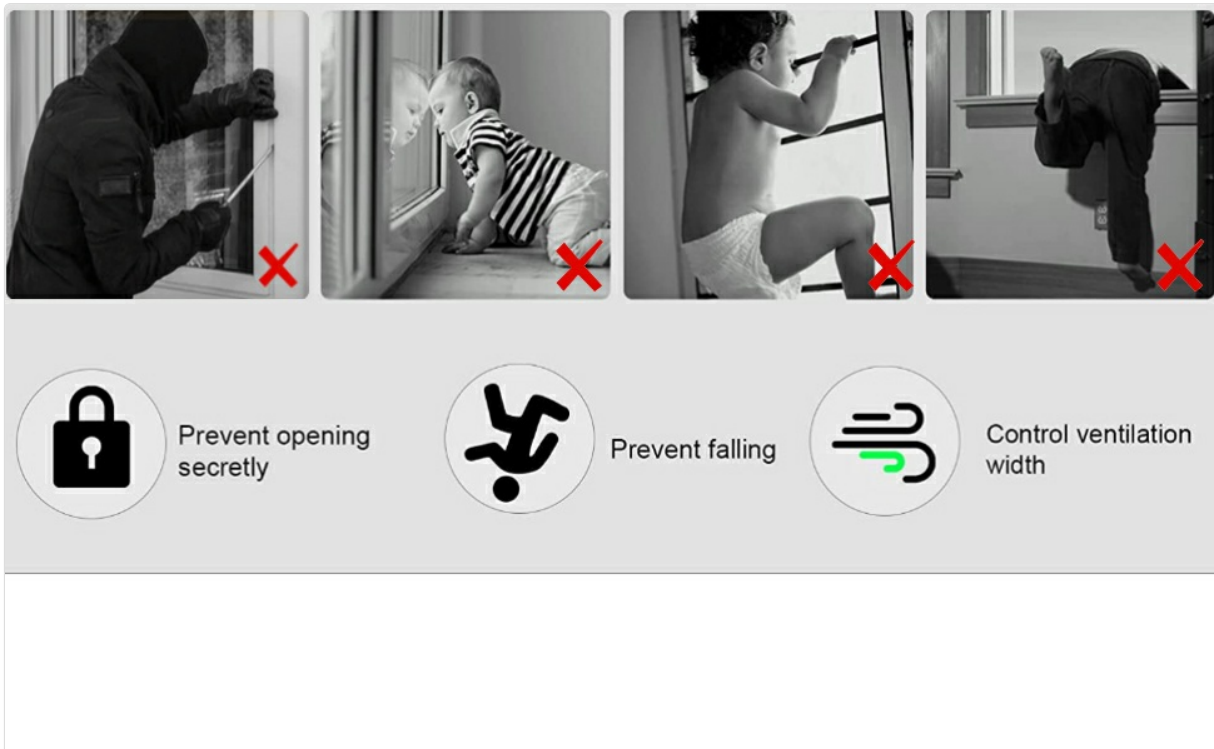

Figure 4: Securing the Window Lock

8. MAINTENANCE

- Clean the locks periodically with a soft, damp cloth to remove dust and grime. Avoid abrasive cleaners.
- Inspect the rubber cushioning for wear or damage. Replace if necessary to maintain optimal grip and frame protection.
- Ensure the screws are free from debris to allow for smooth tightening and loosening.

9. TROUBLESHOOTING

- **Lock does not fit the track:** Verify that your window or door track thickness is within the compatible range (under 0.67 inches). The lock is not suitable for wider tracks.
- **Lock slides on the track:** Ensure both screws are fully and evenly tightened. The rubber cushioning should provide sufficient friction. If the track is unusually smooth, consider adding a thin, non-slip material (not included) between the lock and the track, ensuring it does not interfere with window operation.
- **Screws are difficult to turn:** Check for any debris in the screw threads. Apply a small amount of silicone lubricant if necessary.

10. SPECIFICATIONS

Brand	PENMAMA
Model Name	WL-0233
Material	Aluminum Alloy
Color	Silver
Item Dimensions (L x W x H)	1.45 x 1.08 x 0.85 inches
Item Weight	8.4 ounces (for 4 sets)

Lock Type	Mortise Lock
Special Features	Rubber Cushioning, Durable Aluminum Alloy, Ventilation Security, Visible Key Handle

11. WARRANTY & SUPPORT

For any questions, concerns, or support regarding your PENMAMA Window Locks, please contact the manufacturer directly through your purchase platform or the official PENMAMA website. Please retain your proof of purchase for warranty claims, if applicable.